

Model D2259A Mobile Base Extension Kit Instruction Sheet



Phone #: (360) 734-3482 • Online Tech Support: tech-support@shopfox.biz • Web: www.shopfox.biz

Introduction

Your new Model D2259A Mobile Base Extension Kit (Figure 1) is designed to install onto either the Model D2260A/ D2057A mobile base to provide a stable support platform for a machine and an extension table unit.

Specifications

- Minimum Extension Length 28¹/₂"
- Maximum Extension Length 45³/₄"
- Maximum Leg Span 32"

Tools

- Tape Measure 1
- Hacksaw or Metal Cutting Bandsaw 1
- Wrenches or Sockets 13mm or 1/2" 2
- Wrenches or Sockets 14mm or 9/16" 2

Inventory (Figure 2)

| | Qty |
|--|-----|
| A. Base Side Rail with Mounting Bracket..... | 1 |
| B. Mounting Bracket..... | 1 |
| C. Leg Support Channel..... | 1 |
| D. Swivel Casters..... | 2 |
| E. Extension Bar..... | 1 |
| F. Hardware Bag (not shown) | |
| – Lock Nuts M8-1.25 (Mounting Brackets) | 4 |
| – Hex Bolts M8-1.25 x 16 (Casters, Brackets) | 14 |
| – Lock Washers 8mm (Casters, Bracket)..... | 10 |
| – Flat Washers 8mm (Casters, Bracket)..... | 10 |
| – Hex Nuts M8-1.25 (Casters)..... | 8 |
| – Knobs M12-1.75 (Support Channel) | 2 |
| – Feet (Support Channel)..... | 2 |

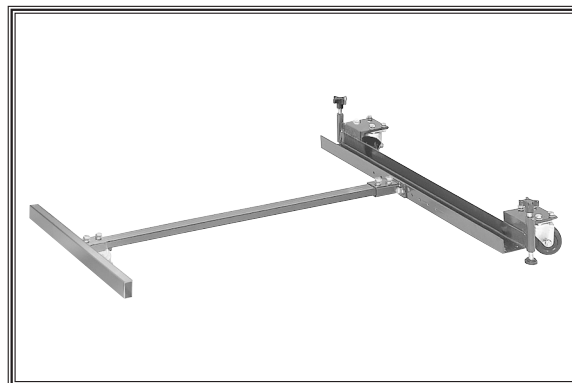

Figure 1. Model D2259A.

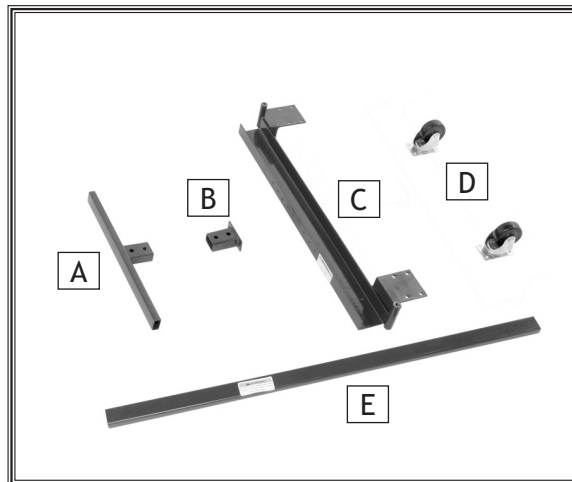

Figure 2. Inventory.

! WARNING

Do not use the Model D2259A until you have read and understood this instruction sheet and completed the entire assembly procedure. Serious personal injury may occur if you ignore this warning.

COPYRIGHT © JUNE, 2009 BY WOODSTOCK INTERNATIONAL, INC.

WARNING: NO PORTION OF THIS MANUAL MAY BE REPRODUCED IN ANY SHAPE OR FORM WITHOUT

#11864BL

THE WRITTEN APPROVAL OF WOODSTOCK INTERNATIONAL, INC.

Printed in China

Assembly

Follow the instructions that came with your Model D2260A/D2057A mobile base for preparing and assembling the mobile base.

To assemble the extension kit, do these steps:

1. After sliding a side rail into each of the four corner brackets that you laid out, determine which side you will install the extension kit onto.
2. Remove one of the side rails from the mobile base assembly and replace it with the base side rail with the rectangular mounting bracket (**Inventory Item A**).

Model D2260 Only: Cut off an equal amount from each side of the base side rail so it is the same length as the rail you removed.

3. Secure the base side rail to two corner brackets on the mobile base with (4) M8-1.25 x 16 hex bolts and 8mm lock nuts.
4. Mount the swivel casters to the corner brackets on the leg support channel using (8) M8-1.25 x 16 hex bolts, 8mm flat washers, 8mm lock washers, and M8-1.25 hex nuts, as shown in **Figure 3**.
5. Thread each of the knobs into the foot posts on the ends of the leg support channel, then insert a foot into the bottom of each foot post. The knob should pick up the magnetic shaft of the foot when it gets close.
6. Install the extension table onto the machine—if you have not already done so.
7. Place the support channel assembly under the extension table legs, making sure the swivel casters face out, then center the legs along the length of the support channel, as shown in **Figure 4**.

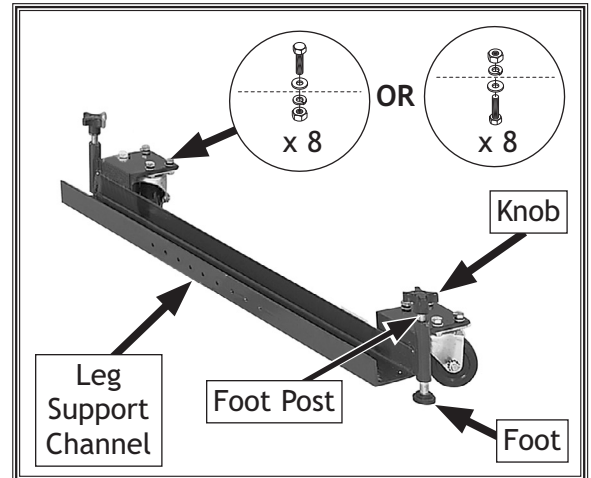

Figure 3. Casters and feet installed onto leg support channel.

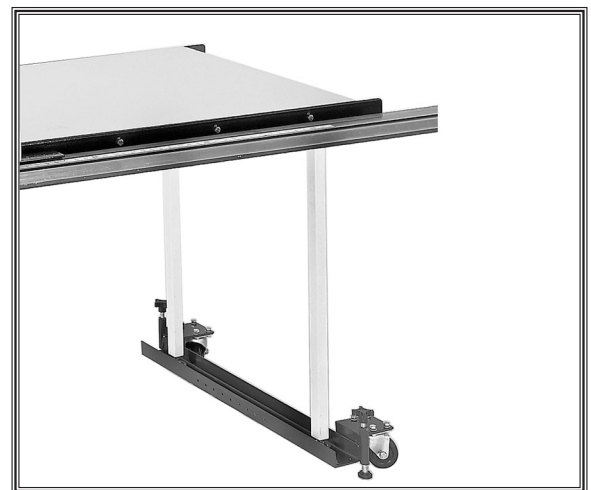

Figure 4. Extension table legs in channel.

8. Measure the distance between the outer edge of the side rail and the inside edge of the side channel, as shown in Figure 5.
9. Cut the extension bar to the length you measured in Step 8. Be careful not to cut the bar too short.
10. Place the mounting bracket over one end of the extension bar, then insert the opposite end of the bar into the bracket on the side rail on the mobile base.

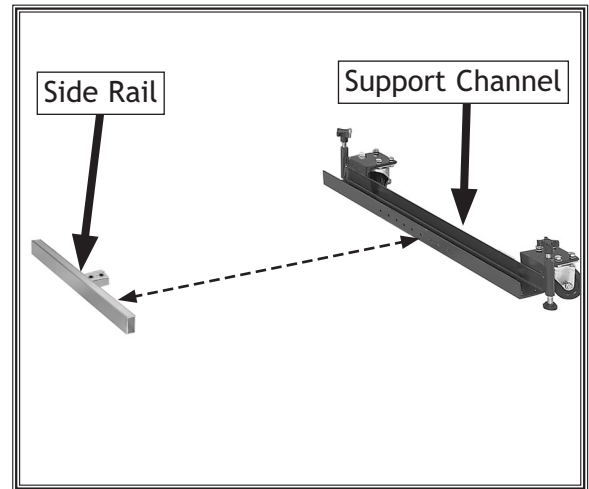

Figure 5. Measuring distance between side rail and support channel (mobile base and extension table not shown for clarity).

11. Lower the extension bar and align the bracket with the threaded holes on the side of the support channel, as shown in Figure 6.

Note: *It may be necessary to raise the support channel or reposition it side-to-side to align the bracket with the holes. It may help to place a wood shim between the floor and the support channel to raise the inner edge of the support channel.*

12. Secure the mounting bracket to the support channel using (2) M8-1.25 x 16 hex bolts, 8mm lock washers, and 8mm flat washers (see Figure 6).

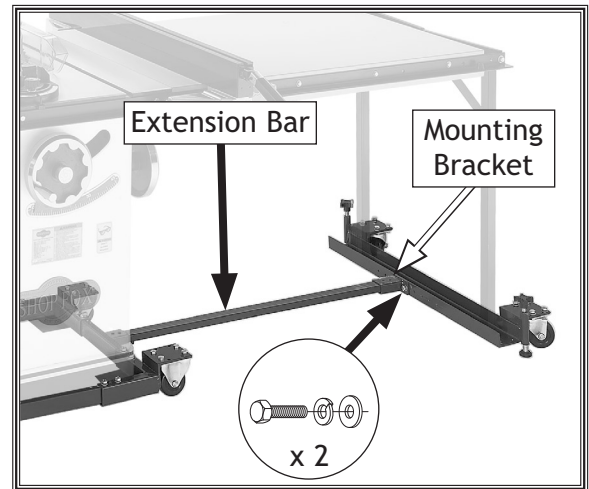

Figure 6. Extension bar attached.

13. Secure the extension bar to the support channel bracket and side rail bracket with (4) M8-1.25 x 16 hex bolts and 8mm lock nuts (see Figure 7).
14. Final tighten all bolts.
15. Check the extension table to make sure it is level with the machine table surface. It may be necessary to slightly adjust the leg length to assure the extension table legs sit firmly on the channel.

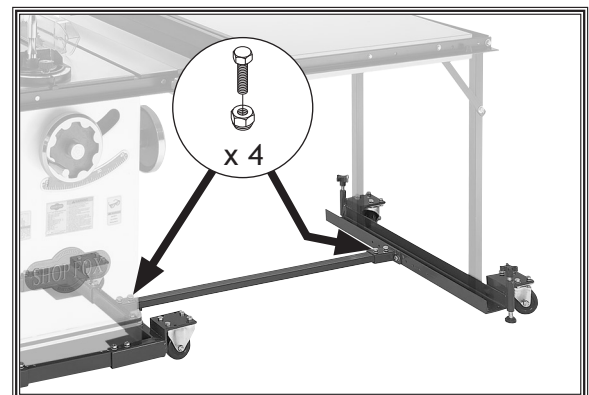
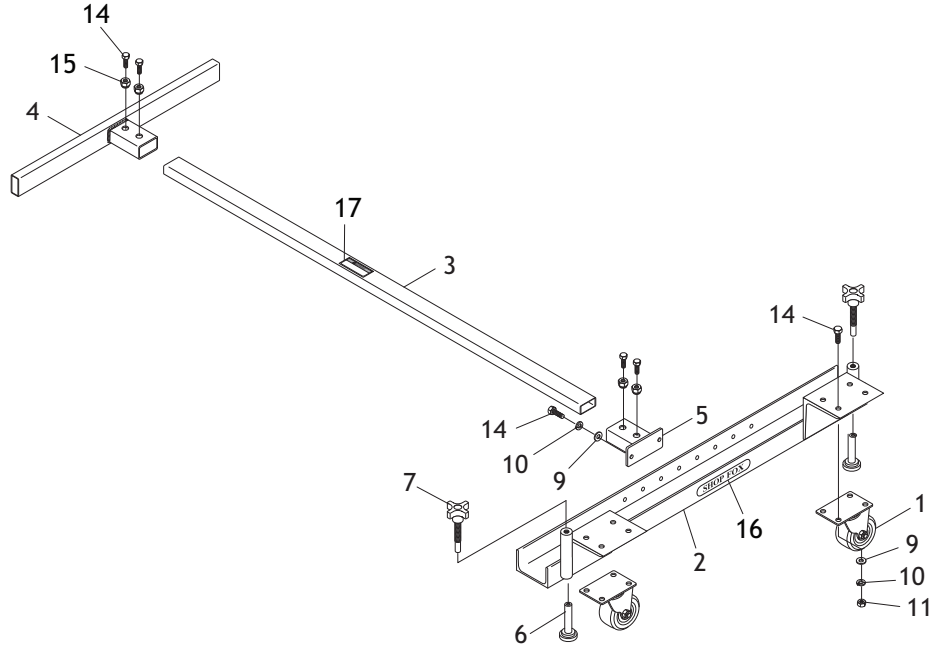

Figure 7. Extension bar secured to mobile base and support channel.

D2259A Parts



| REF | PART # | DESCRIPTION |
|-----|------------|------------------------------|
| 1 | XD2259A001 | SWIVEL CASTER |
| 2 | XD2259A002 | LEG SUPPORT CHANNEL |
| 3 | XD2259A003 | EXTENSION BAR |
| 4 | XD2259A004 | SIDE RAIL W/MOUNTING BRACKET |
| 5 | XD2259A005 | MOUNTING BRACKET |
| 6 | XD2058A008 | FOOT WITH MAGNET |
| 7 | XD2058A009 | KNOB M12-1.75 |

| REF | PART # | DESCRIPTION |
|-----|------------|----------------------------|
| 9 | XPW01M | FLAT WASHER 8MM |
| 10 | XPLW04M | LOCK WASHER 8MM |
| 11 | XPNO3M | HEX NUT M8-1.25 |
| 14 | XPB03M | HEX BOLT M8-1.25 X 16 |
| 15 | XPLN04M | LOCK NUT M8-1.25 |
| 16 | XD2271012 | SHOP FOX LOGO LABEL |
| 17 | XD2058A018 | TIGHTEN FEET WARNING LABEL |