



# Instruction Sheet

## Model W1721

### 79" Extension Rails

The Model W1721 79" Extension Rails increase the cutting capacity right of the blade to 50".

For best performance and safety, install the **SHOP FOX®** Model W1722 extension wing set or install an equivalent extension table.

#### To install the fence rails, do these steps:

1. Remove the fence, the standard rails, and the blade guard that came with the table saw, if they are installed.
2. In the front and back edge of the table, insert eight M6-1.0 x 30 T-bolts (four on each side) through the larger threaded holes, and install the flat washers and nuts on each bolt. See **Figure 1**.
3. Insert two  $\frac{5}{16}$ "-18 x  $\frac{3}{4}$ " T-bolts in the right table wing, and two into the edge of the left table wing, and install the flat washers and nuts on each bolt. See **Figure 1**.
4. Tighten all nuts until there is a gap of approximately  $\frac{3}{16}$ " to  $\frac{1}{4}$ " between the T-bolt and the table and wing edges.
5. Slide the extension rail over the T-bolts as shown in **Figure 1** until the rail is flush with the end edge of the left table wing.
6. Tighten all hex nuts.
7. On each leg flange fasten two  $\frac{5}{16}$ "-18 x  $\frac{3}{4}$ " T-bolts, flat washers, and the nuts; then slide the legs onto the rails as shown in **Figure 2**.
8. Tighten the hex nuts to secure the legs to the rails, and secure the rail end caps with the Phillips head screws.
9. Insert two  $\frac{5}{16}$ "-18 x  $\frac{3}{4}$ " T-bolts into the start switch mounting slot (see **Figure 1**), and position the start switch mounting bracket to the underside of the rail, and secure it with the washers and nuts.
10. Install fence, and adjust rails to fine-tune the mounting alignment of the rails and legs.

For questions please contact Woodstock International at 1-360-734-3482 or send e-mail to: [tech-support@shopfox.biz](mailto:tech-support@shopfox.biz).

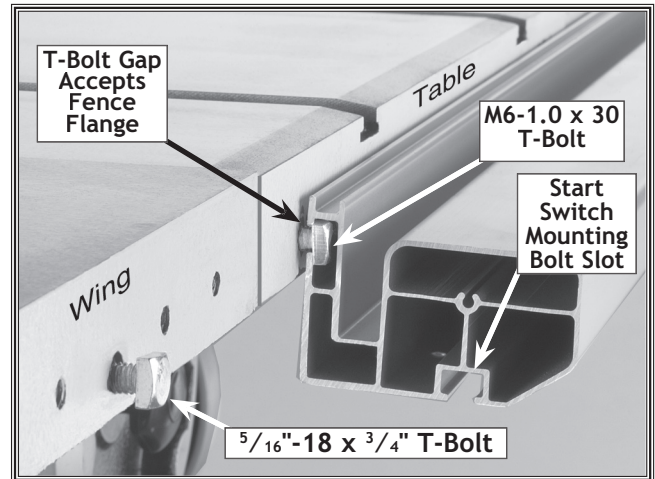

**Figure 1.** Front rail being slid onto T-bolts.



**Figure 2.** Sliding leg onto rail.

COPYRIGHT © APRIL 2004, BY WOODSTOCK INTERNATIONAL, INC.  
**WARNING: NO PORTION OF THIS DOCUMENT MAY BE REPRODUCED IN ANY SHAPE OR FORM WITHOUT THE WRITTEN APPROVAL OF WOODSTOCK INTERNATIONAL, INC.**  
PRINTED IN TAIWAN.

# W1721 Parts Diagram

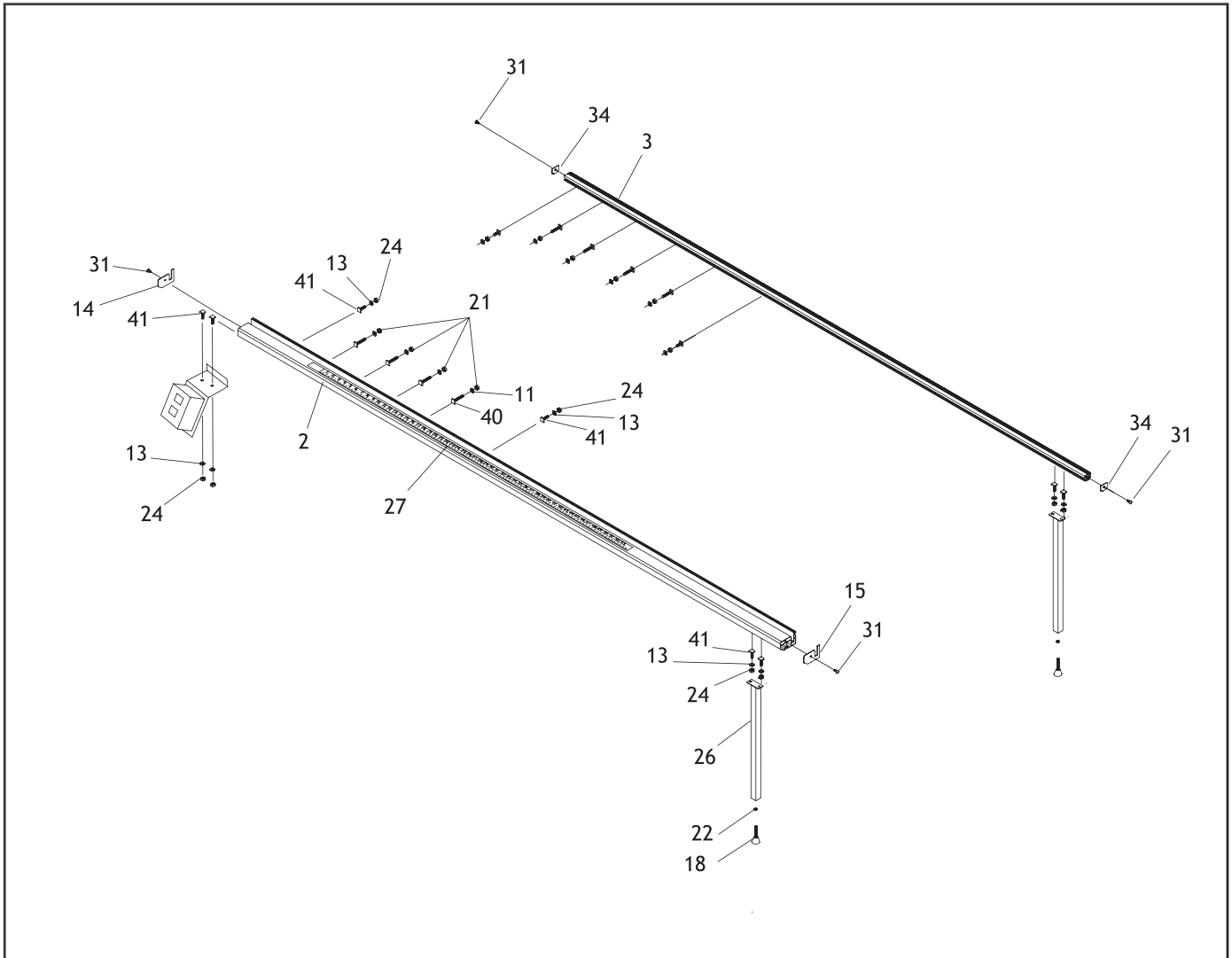

REF	PART #	DESCRIPTION
2	X1721002	ALUMINUM FRONT RAIL
3	X1721003	ALUMINUM REAR RAIL
11	XPW03M	FLAT WASHER 6MM
13	XPW07	FLAT WASHER 5/16"
14	X1721014	FRONT RAIL CAP (L)
15	X1721015	FRONT RAIL CAP (R)
18	X1721018	RUBBER FOOT BOLT 3/8"-16
21	XPN01M	HEX NUT M6-1.0
22	XPN08	HEX NUT 3/8"-16

REF	PART #	DESCRIPTION
23	XPN01M	HEX NUT M6-1.0
24	XPN02	HEX NUT 5/16"-18
26	X1721026	LEG (LONG)
27	X1721027	LENGTH SCALE 50"
31	XPHTEK7	SELF TAP SCREW #8 X 3/8"
34	X1721034	REAR RAIL CAP
40	X1721040	T-BOLT M6-1.0 x 30
41	X1721041	T-BOLT 5/16"-18 x 3/4"