



WORKSHOP STOOL
MODEL H6099
INSTRUCTION SHEET



COPYRIGHT © MAY, 2004 BY GRIZZLY INDUSTRIAL, INC.
**WARNING: NO PORTION OF THIS MANUAL MAY BE REPRODUCED IN ANY SHAPE
OR FORM WITHOUT THE WRITTEN APPROVAL OF GRIZZLY INDUSTRIAL, INC.**
#CA6262 PRINTED IN CHINA

PARTS INVENTORY

The Model H6099 was carefully packed when it left our warehouse. If you discover the stool is damaged after you have signed for delivery, *please call Customer Service immediately at (570) 546-9663 for advice.*

Save the containers and all packing materials for possible inspection by the carrier or its agent. *Otherwise, filing a freight claim can be difficult.*

When you are completely satisfied with the condition of your shipment, you should inventory the contents.

Figure 1 - Contents.

A.	Stool Top	1
B.	Stool Pad	1
C.	Stool Legs	4
D.	Round Brace	1
E.	Bolt Bag	1
	—M4 x 12 Tap Screws	8
	—M4-0.7 x 15 Phillips Head Screws	12
	—M4-0.7 x 35 Phillips Head Screw	1
	—M5-0.8 Lock Nuts	4
	—M5-0.8 x 45 Phillips Head Screws	4
	—M4 Flat Washer	1
	—Leg Holders	4
	—Plastic Cross Joint	1
	—Rubber Floor Guards	4

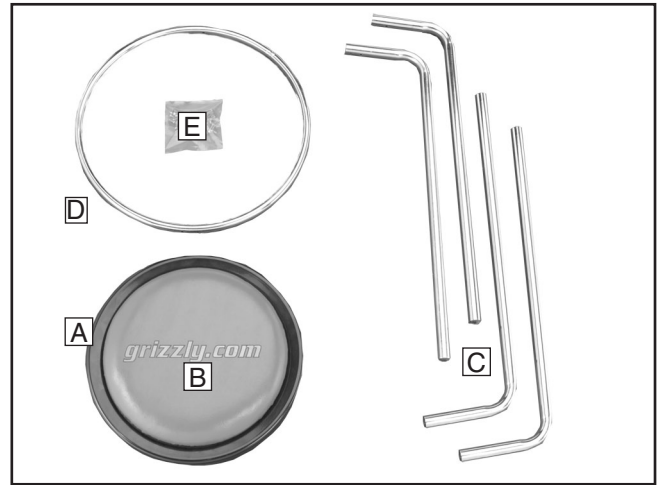

Figure 1. Model H6099 box contents.

WARNING

Children may climb into plastic bags and suffocate. Keep all plastic bags included in packaging out of the reach of children.

ASSEMBLY INSTRUCTIONS

Stool Assembly:

1. Slide a rubber floor guard onto the bottom end of each stool leg.
2. Slide the top of each stool leg onto the plastic cross joint and secure with the tap screws.
3. Place the round brace inside the stool legs and attach using the M5-0.8 x 45 Phillips head screws and lock nuts as shown in **Figure 2**.



Figure 2. Correctly installed round brace.

4. Secure the stool pad to the stool top with four M4-0.7 x 15 Phillips head screws.
5. Insert the M4-0.7 x 35 Phillips head screw and flat washer through the plastic cross joint and into the stool top.
6. Attach the assembled frame to the underside of the stool top and secure with the leg holders and eight M4-0.7 x 15 Phillips head screws as shown in **Figure 3**.



Figure 3. Installed stool pad and legs.

H6099 Parts Breakdown and List

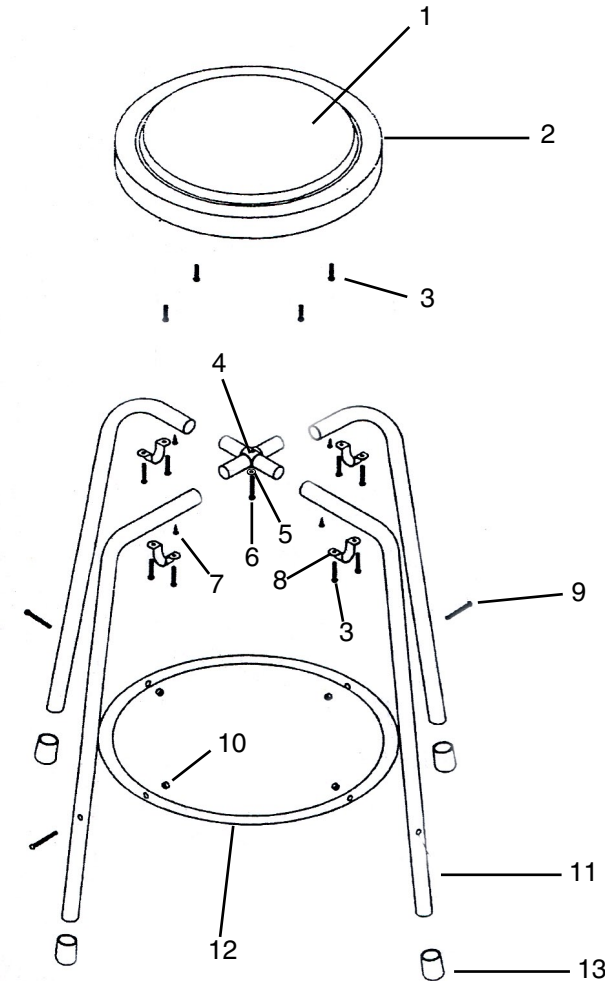

REF	PART#	DESCRIPTION
1	PH6099001	STOOL PAD
2	PH6099002	STOOL TOP
3	PS21M	PHLP HD SCR M4-.7 X 15
4	PH6099004	PLASTIC CROSS JOINT
5	PW05M	FLAT WASHER 4MM
6	PS25M	PHLP HD SCR M4-.7 X 35
7	PHTEK5M	TAP SCREW M4 X 12
8	PH6099008	LEG HOLDER
9	PS87M	PHLP HD SCR M5-.8 X 45
10	PLN02M	LOCK NUT M5-.8
11	PH6099011	STOOL LEG
12	PH6099012	ROUND BRACE
13	PH6099013	RUBBER FLOOR GUARD