



Load Leveler

1500 lb. Capacity

MODEL H6227

The load leveler is intended to balance an object when attached to a crane or hoist. Fine thread adjustment of the carriage allows quick balancing of off center loads and precise angle control.

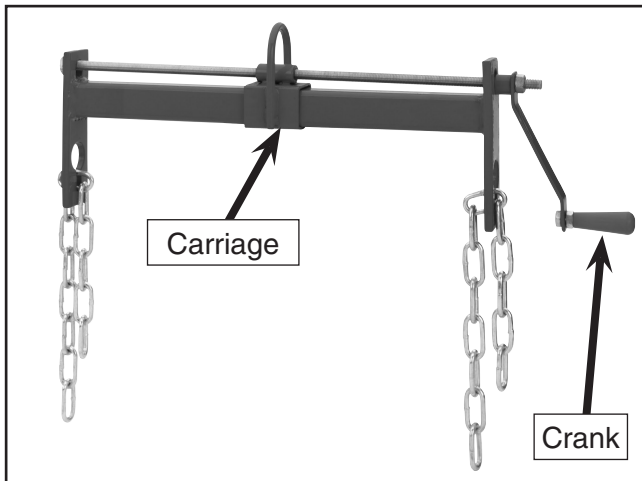

1500 lb. capacity load leveler.

WARNING

Failure to follow these instructions will result in serious personal injury.

1. DO NOT exceed the specified load capacity.
2. Make sure the chain attachment points on the item being lifted are capable of supporting the weight of the lifted item.
3. DO NOT place any part of your body under the lifted load.
4. Test and adjust the balance point before lifting the entire weight of the item.
5. Keep children and bystanders at a safe distance during use.

ASSEMBLY:

Refer to the parts breakdown on the back of the instruction sheet.

OPERATIONS:

1. Attach the loop on the carriage to the hook on a hoist or crane. Make sure all locking devices on the hoist or crane are in place and operational.
2. Move the load leveler into position over the object to be lifted. Position the load leveler so the crank will be accessible when the chains are attached to the object.
3. Adjust the chains to equal lengths to minimize the leveling necessary.
4. Attach the chains to the object. When possible, attach both ends of both chains to the object.
5. When only using one end of each chain, place a bolt with washers through a link in the slack end of the chain and secure it to the end under tension with a nut.
6. Raise the crane or hoist to take up the slack in the chains.
7. Make sure to detach all bolts and wires that may be holding the object in place.
8. Raise the object slightly with the crane or hoist and rotate the crank on the load leveler to adjust the balance of the object or achieve the desired angle.
9. Raise and move the object with the crane or hoist.

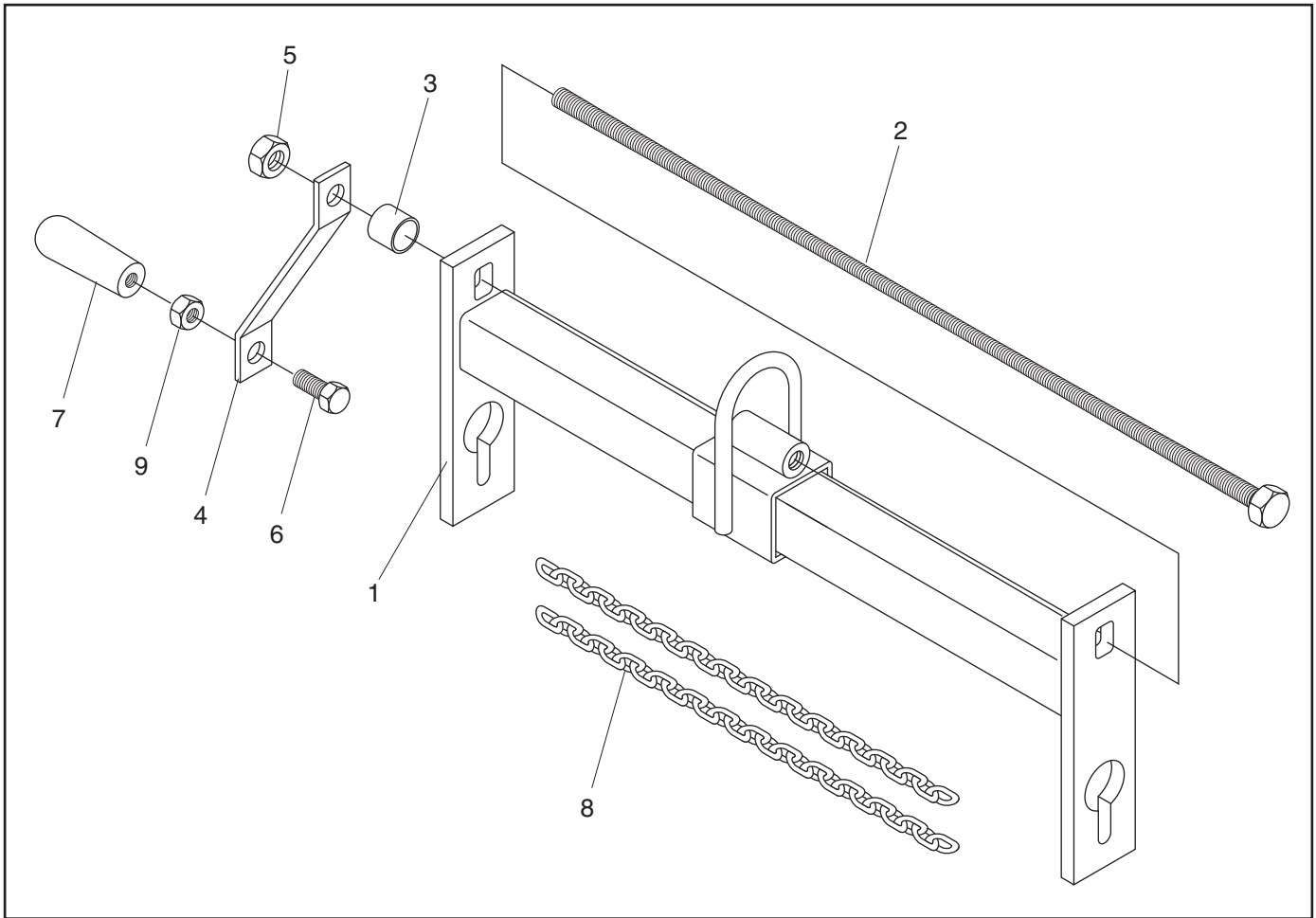

REF	PART #	DESCRIPTION
1	PH6227001	MAIN BODY
2	PH6227002	HEX BOLT M12-1.75 X 565
3	PH6227003	SPACER
4	PH6227004	CRANK ARM
5	PN09M	HEX NUT M12-1.75

REF	PART #	DESCRIPTION
6	PB01M	HEX BOLT M10-1.5 X 30
7	PH6227007	CRANK HANDLE
8	PH6227008	CHAIN 1/4 x 20
9	PN02M	HEX NUT M10-1.5

COPYRIGHT © AUGUST, 2004 BY GRIZZLY INDUSTRIAL, INC.
**WARNING: NO PORTION OF THIS MANUAL MAY BE REPRODUCED IN ANY SHAPE
 OR FORM WITHOUT THE WRITTEN APPROVAL OF GRIZZLY INDUSTRIAL, INC.**
 #EW6452 PRINTED IN CHINA