

# *Panther*™

*panthercarts.com*

## **MODEL H8011 ATV LIFT 1500 LB. CAPACITY INSTRUCTION SHEET**



COPYRIGHT © AUGUST, 2006 BY GRIZZLY INDUSTRIAL, INC.  
**WARNING: NO PORTION OF THIS MANUAL MAY BE REPRODUCED IN ANY SHAPE  
OR FORM WITHOUT THE WRITTEN APPROVAL OF GRIZZLY INDUSTRIAL, INC.**  
#TS8377 PRINTED IN CHINA

# **WARNING**

## **Safety Instructions for the ATV Lift**

- 1. READ THROUGH THIS ENTIRE INSTRUCTION SHEET BEFORE USING THE LIFT.** Failure to understand and follow all operational and safety instructions may result in death or serious injury.
- 2. TRAINED PERSONNEL ONLY.** This lift and its load represent serious crushing hazards and should be handled with respect and caution to lessen the possibility of injury. Keep all untrained persons and visitors away from the lift at all times. Do not allow anyone to sit or stand on the platform at any time. Stay clear of the lift when raising or lowering.
- 3. LIFT STABILITY.** Failure to maintain lift and load stability causes load to become unstable and may result in serious injury from loss of control. Use this lift on a stable and dry surface that is capable of sustaining the load. Get help with loading and unloading to maintain control of the load and do so only when the lift platform is fully lowered to the ground.
- 4. OPERATION SAFETY.** Center the load on the platform and secure it with appropriate strapping. Raise and lower the lift slowly and in a controlled fashion. Do not add any additional weight to the lift platform after it has been raised. **ALWAYS** engage the locking plate with the safety latches when the lift is in a raised position.
- 5. PERSONAL SAFETY APPAREL.** To assist in maintaining stable footing while loading or unloading the lift, wear non-skid footwear. Secure long hair, loose clothing and other personal items that may be caught in moving parts.
- 6. LIFT DESIGN LIMITS.** Exceeding the design limits of this lift will cause the lift to fail and may cause death or serious personal injury. Do not exceed the rated load capacity of 1500 lbs. for this lift. Refer to the weight specifications of the vehicle you intend to load. Do not make any modifications to any part of this lift. Do not use this lift for any purpose other than lifting ATV vehicles. **DO NOT** use this lift for motorcycles.
- 7. MOVING THE LIFT.** The lift must be fully lowered to the ground before moving it to avoid tipping hazards. Remove the leading plate and the hydraulic pump before moving the lift to avoid damaging these items. Get help in moving the main lift to avoid personal injury.
- 8. MAINTENANCE/SERVICE.** Keep the lift platform free from fluids and debris that may cause the load to slip. Problems concerned with any moving parts or accessories **MUST** be investigated and corrected. If at any time you are experiencing difficulties performing the intended operation, stop using the lift! Contact our Technical Support Department at (570) 546-9663.

### **WARNING**

Like all machines there is danger associated with this machine. Accidents are frequently caused by lack of familiarity or failure to pay attention. Use this machine with respect and caution to lessen the possibility of operator injury. If normal safety precautions are overlooked or ignored, serious personal injury may occur.

### **CAUTION**

No list of safety guidelines can be complete. Every shop environment is different. Always consider safety first, as it applies to your individual working conditions. Use this and other machinery with caution and respect. Failure to do so could result in serious personal injury, damage to equipment, or poor work results.

## Introduction

The Model H8011 ATV Lift features a low-profile, heavy-duty design that is easy to use, and will lift your ATV to an optimal working height. The dual function hydraulic pumping system can be operated manually or with an air compressor, and will reliably lift vehicles up to 1500 lbs.

## Inventory (Figure 1)

- A. Main Lift Assembly ..... 1
- B. Air/Manual Hydraulic Pump..... 1
- C. Leading Plate ..... 1

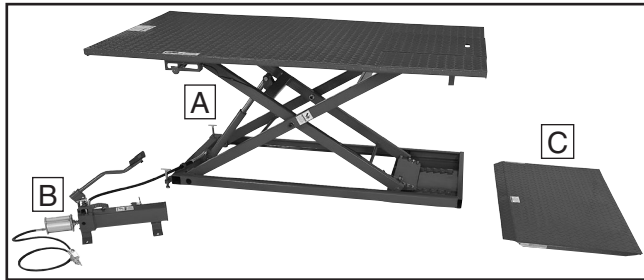

Figure 1. Model H8011 inventory.

## Specifications

Capacity.....	1500 lbs.
Length.....	78 <sup>3</sup> / <sub>4</sub> "
Width .....	47 <sup>1</sup> / <sub>4</sub> "
Maximum Lift Height.....	32 <sup>9</sup> / <sub>32</sub> "
Minimum Lift Height.....	7 <sup>5</sup> / <sub>32</sub> "
Air Inlet Fitting .....	1/4" NPT
Air Pressure Required.....	100-125 PSI

## Assembly Instructions

- Place the hydraulic pump by the side of the lift (see **Figure 1**).
- Attach the hydraulic hose connector at the end of the main lift assembly hose to the coupling on the hydraulic pump (see **Figure 2**).
- Connect the air valve to an air source that is rated between 100 and 125 PSI.
- Position the leading plate studs into the two corresponding holes at the rear of the platform.

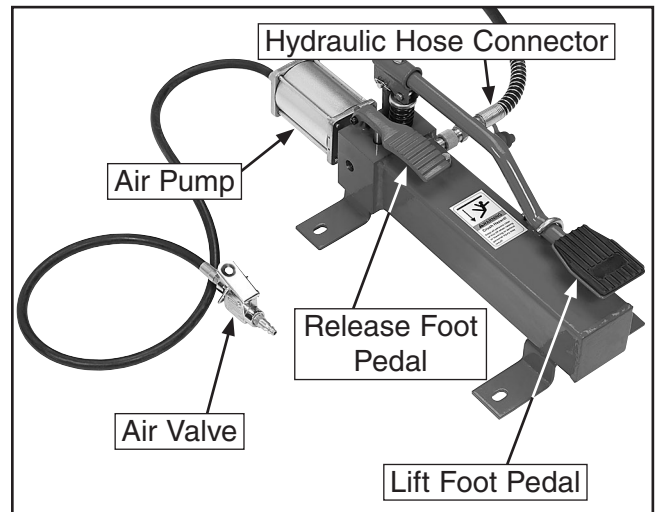

Figure 2. Air and hydraulic pump connections.

## Before First Use

To ensure proper operation before using the lift with a load, the air pump must be lubricated, the hydraulic fluid level checked, air bled from the hydraulic system, and the lift tested.

### To lubricate the air pump:

- Pour 1/3 oz. of good quality air tool lubricant into the 1/4" NPT air inlet fitting while squeezing the lever of the air valve (see **Figure 2**).
- To ensure an even distribution of the lubricant:
  - Connect the air inlet fitting to an air source rated between 100 and 125 PSI.
  - While pressing down on the release foot pedal (see **Figure 2**), squeeze the lever on the air valve for three seconds.

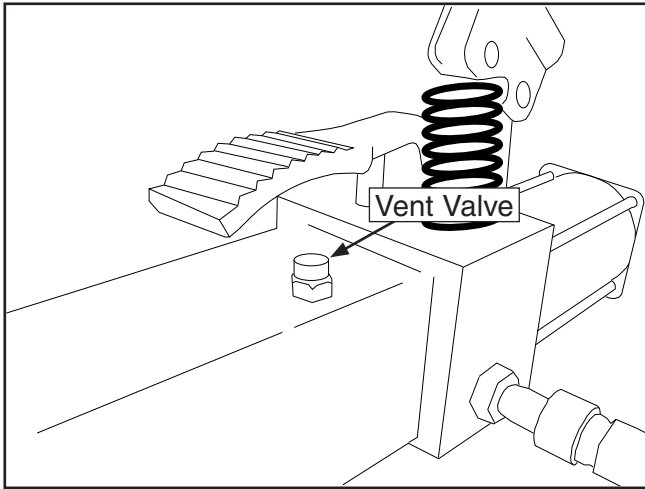

**Figure 3.** Location of vent valve on hydraulic pump.

#### To check the hydraulic fluid level:

1. To ensure that all of the hydraulic fluid from the ram is returned to the hydraulic pump reservoir, the lift must be fully lowered to the ground.
2. Remove the vent valve (see **Figure 3**).
3. Using a standard hydraulic oil, make sure the fluid level is  $\frac{1}{2}$ " from the top.
4. Replace the vent valve and tighten  $\frac{1}{2}$  turn past hand tightened.

**Note:** *When using the lift, rotate the top knob of the vent valve counterclockwise until it stops. This will allow the hydraulic pump reservoir to breath during lift use. Close the vent valve when not in use.*

#### To bleed the air from the hydraulic system:

1. Open the vent valve.
2. The lift must be fully lowered to force the fluid from the ram back into the hydraulic pump reservoir.
3. Fully depress the smaller release foot pedal and pump the larger lift pedal 20 times.
4. To allow the air to separate from the fluid and escape through the vent valve, leave the hydraulic pump inactive for at least one hour.

#### To test the hydraulic system:

1. Follow the procedures in the **Operation Instructions** section to raise and lower the lift **WITHOUT** a load.
2. Make sure that the lift moves evenly and that it remains at the working height after pumping is stopped. Strange operation or noises **MUST** be investigated and corrected before operating the lift further. For repairs or parts replacement, contact our Tech Support at (570) 546-9663.

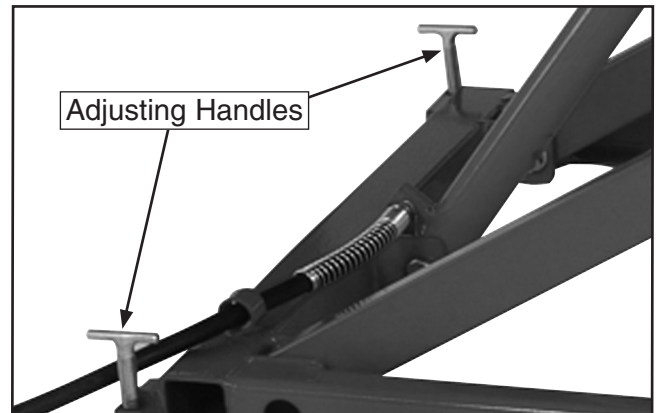

**Figure 4.** Location of adjusting handles.

## Operation Instructions

#### To raise the lift with a load:

1. Open the vent valve.
2. Position the lift on a flat, stable surface that is capable of sustaining the load.
3. Use the two adjusting handles (see **Figure 4**) to level the lift.
4. Push—**DO NOT** drive—the vehicle up the leading plate and onto the platform.
5. Center and secure the load to the platform with appropriate strapping.

*Continued on next page* →

## NOTICE

Remove the leading plate before raising the lift. The leading plate is not designed to be raised with the lift or act as a platform for the load. Failure to heed this warning may result in property damage.

5. Remove the leading plate **BEFORE** raising the lift.

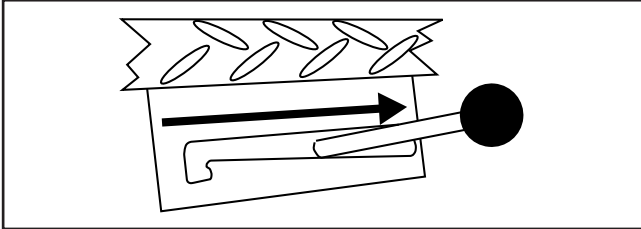

Figure 5. Safety lever to the right.

## WARNING

Move the safety lever to the right before raising the lift. This will ensure that the locking plate is lowered and engaged with the safety latches to prevent accidental lowering of the lift. Failure to carefully follow this procedure may result in death or serious injury.

6. Move the safety lever to the right as shown in **Figure 5**. This will lower the locking plate, engaging the safety latches as the lift is raised.
7. Connect the air valve to an air source rated between 100 and 125 PSI.
  - If an air source is not available, use the larger lift foot pedal on the hydraulic pump to lift the load.
8. Squeeze the lever on the air valve to raise the load to slightly above the desired working height.
9. Slowly lower the lift until the locking plate is fully engaged with the next lower safety latch to ensure that the lift will not unexpectedly drop.

## WARNING

Only load and unload the lift when it is fully lowered to the ground to ensure the load does not tip or fall from the lift. Failure to do so may result in serious injury and property damage.

To lower the lift and load:

1. Open the vent valve.
2. Remove all tools and other obstructions from under and near the lift, and make sure that all persons are clear of the lift.
3. Raise the lift slightly to disengage the locking plate from the safety latches.

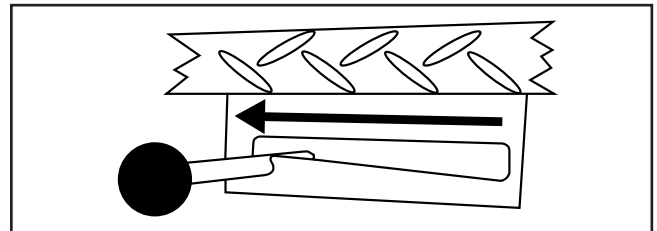

Figure 6. Safety lever to the left.

3. Move the safety lever to the left and down into the slot as shown in **Figure 6**, which will keep the locking plate from engaging the safety latches.
4. In a controlled fashion, press down on the smaller release foot pedal to lower the lift.

## NOTICE

Never store the lift in any position other than fully lowered. Otherwise, the ram will rust and become pitted overtime, leading to seal failures.

## Maintenance

Regular periodic maintenance on your Model H8011 ATV Lift will ensure its optimum performance. Make a habit of inspecting your lift each time you use it.

### Maintenance Procedures

- Clean all painted surfaces after each use. Do not allow surfaces to become slippery.
- Every 6–12 months, inspect the ram (refer to **Part 28, H8011 Parts Breakdown on Page 6**) and remove any signs of corrosion. Wipe a thin coat of a good quality hydraulic oil to protect the chrome surfaces of the ram.
- If the lift feels spongy while raising or the ram will not lift the load, bleed the air from the hydraulic pump as detailed in **Before First Use on Page 3**.
- Use a light machine oil to lubricate all pivot points of the lifting arms (refer to **Parts 5 & 27, H8011 Parts Breakdown on Page 6**) every 6–12 months, depending on frequency of use.
- The hydraulic pump and ram are sealed and pre-adjusted at the factory, and require no internal maintenance.

*If you need help with your new ATV lift, call our Tech Support at: (570)546-9663.*

# H8011 Parts Breakdown

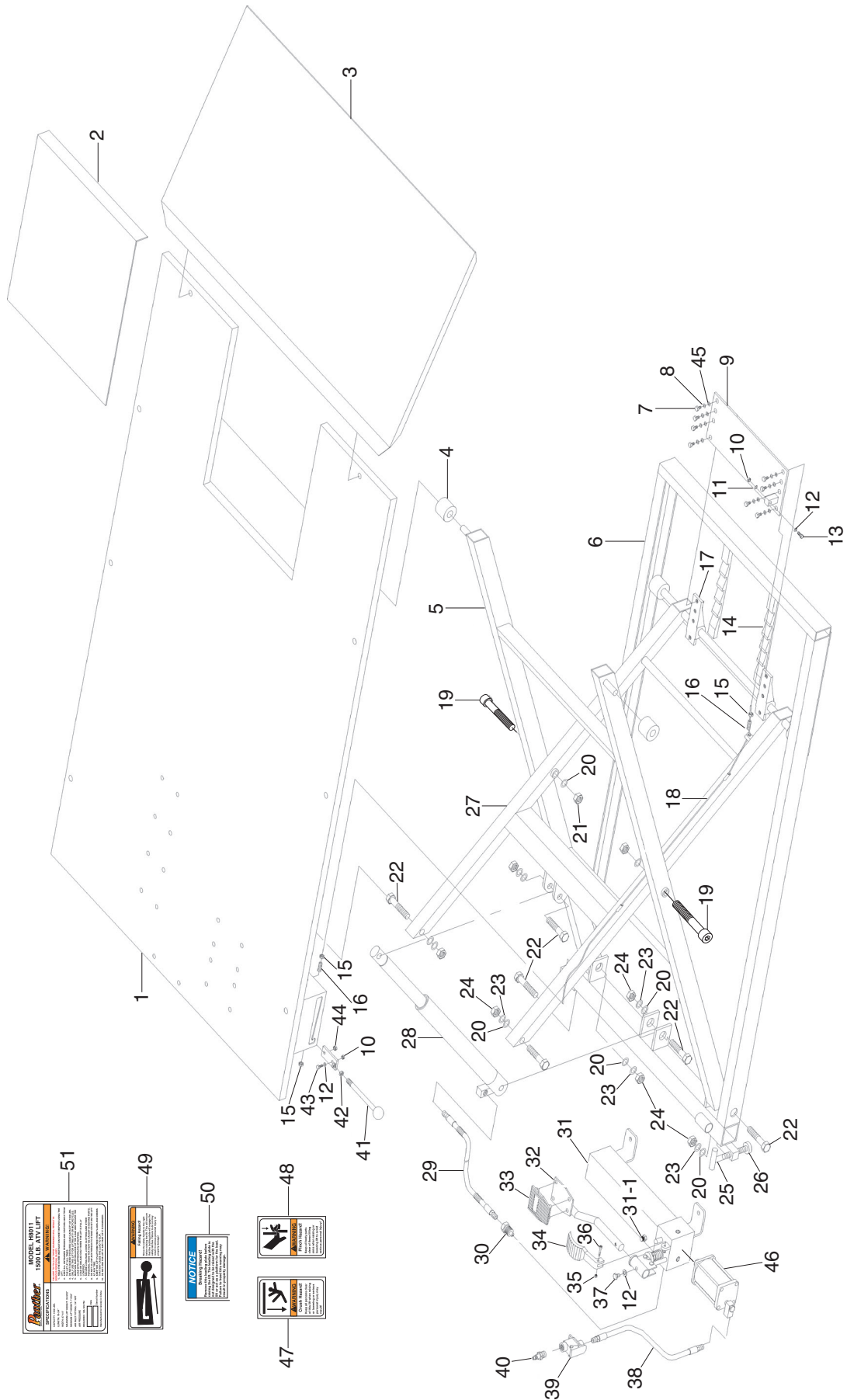

# H8011 Parts List

REF	PART #	DESCRIPTION
1	PH8011001	PLATFORM
2	PH8011002	SLIDING PLATE
3	PH8011003	LEADING PLATE
4	PH8011004	STEEL WHEEL
5	PH8011005	OUTSIDE LIFTING ARM
6	PH8011006	BASE
7	PB74M	HEX BOLT M10-1.5 X 20
8	PW04M	FLAT WASHER 10MM
9	PH8011009	LOCKING PLATE
10	PN03M	HEX NUT M8-1.25
11	PLW04M	LOCK WASHER 8MM
12	PW01M	FLAT WASHER 8MM
13	PH8011013	DRILLED HEX BOLT M8-1.25 X 30
14	PH8011014	SAFETY LATCH
15	PN02M	HEX NUT M10-1.5
16	PH8011016	HOLLOW SCREW M10-1.5 X 30
17	PH8011017	LOCKING PLATE BASE
18	PH8011018	SAFETY WIRE
19	PH8011019	CAP SCREW M16-2 X 140
20	PW08M	FLAT WASHER 16MM
21	PLN07M	LOCK NUT M16-2
22	PB133M	HEX BOLT M16-2 X 90
23	PLW10M	LOCK WASHER 16MM
24	PN13M	HEX NUT M16-2
25	PH8011025	ADJUSTING HANDLE
26	PH8011026	ROTATABLE FOOT

REF	PART #	DESCRIPTION
27	PH8011027	INSIDE LIFTING ARM
28	PH8011028	RAM
29	PH8011029	HYDRAULIC HOSE
30	PH8011030	HYDRAULIC HOSE COUPLER
31	PH8011031	HYDRAULIC PUMP
31-1	PH8011031-1	VENT VALVE
32	PH8011032	LIFT FOOT PEDAL
33	PH8011033	RUBBER PAD
34	PH8011034	RELEASE FOOT PEDAL
35	PLN03M	LOCK NUT M6-1
36	PSB07M	CAP SCREW M6-1 X 30
37	PB87M	HEX BOLT M8-1.25 X 15
38	PH8011038	AIR HOSE
39	PH8011039	AIR VALVE
40	PH8011040	QUICK COUPLER MALE 1/4 NPT
41	PH8011041	SAFETY LEVER
42	PN09M	HEX NUT M12-1.75
43	PH8011013	DRILLED HEX BOLT M8-1.25 X 30
44	PLN05M	LOCK NUT M10-1.5
45	PLW06M	LOCK WASHER 10MM
46	PH8011046	AIR PUMP
47	PH8011047	CRUSHING HAZARD LABEL
48	PH8011048	PINCH HAZARD LABEL
49	PH8011049	FALLING HAZARD LABEL
50	PH8011050	BREAKING HAZARD LABEL
51	PH8011051	MACHINE ID LABEL