



MODEL T10030 FOLDING ENGINE STAND INSTRUCTION SHEET

! WARNING

To reduce the risk of serious injury when using this engine stand:

1. **ALWAYS** stand behind the main upright post when mounting or turning an engine. Use both hands to maintain control when rotating the engine.
2. Only use this stand on hard level surfaces such as concrete or asphalt.
3. **DO NOT** overload this stand beyond the maximum capacity.
4. Use all four mounting arms when attaching an engine to the stand.
5. Keep fingers and hands away from pinch points when adjusting the engine and lowering the legs.
6. **DO NOT** work directly under a suspended engine.
7. Be sure the load is centered and secured.

Specifications

Maximum Load Capacity..... 2000 Lbs.
Unfolded Dimensions42³/₄" x 34³/₄" x 34¹/₄"
Folded Dimensions.....18¹/₂" x 20⁷/₈" x 34¹/₂"
Rotation360°

Assembly

Refer to the **Parts Breakdown** located on the back of this page for assembly.

If you need help with the Model T10030, call our Technical Support line at: (570) 546-9663.

Mounting An Engine

1. Purchase four grade-8 bolts that match the thread diameter and pitch of the mounting holes in your engine block. These bolts must not be any shorter than 3¹/₂".

2. Using an engine hoist, move the engine next to the engine stand, and adjust the turning plate and mounting arms to properly fit and support the engine block, making sure to replace the ring grip lock pin.
3. Using the bolts from **Step 1**, attach the engine to the mounting arms and tightly thread the bolts into the engine block. When the engine is securely mounted and stable, slowly remove the engine hoist.

Maintenance

When the stand is not in use, fold the legs up by removing the cotter pins from the eyebolt clevis pins. Remove the eyebolt clevis pins and fold the legs upwards until they clear the second placement hole, then re-insert the eyebolt clevis pins and cotter pins, as shown in **Figure 1**.

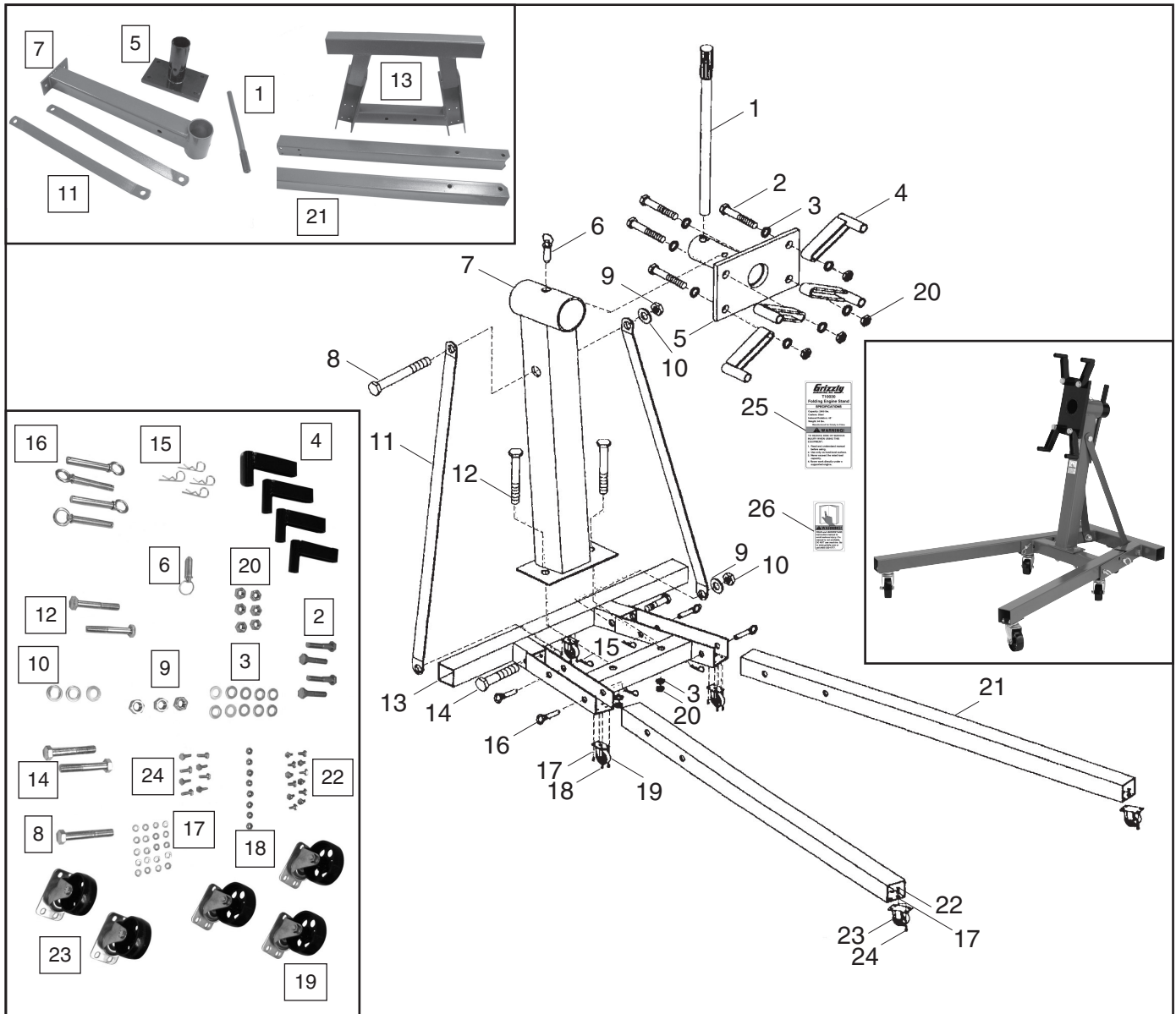

Figure 1. T10030 with legs folded.

! CAUTION

Check the stand for loose or damaged bolts before each use. Do not expose the stand to rain or other liquids.

T10030 Parts Breakdown and List



REF	PART #	DESCRIPTION
1	T10030001	HANDLE
2	PB168M	HEX BOLT M14-2 X 65
3	PW10M	FLAT WASHER 14MM
4	T10030004	MOUNTING ARM
5	T10030005	TURNING PLATE
6	T10030006	RING GRIP LOCK PIN
7	T10030007	MAIN POST
8	PB138M	HEX BOLT M16-2 X 100
9	PN13M	HEX NUT M16-2
10	PW08M	FLAT WASHER 16MM
11	T10030011	POST SUPPORT
12	PB169M	HEX BOLT M14-2 X 85
13	T10030013	BASE FRAME

REF	PART #	DESCRIPTION
14	PB133M	HEX BOLT M16-2 X 90
15	T10030015	HAIRPIN COTTER PIN
16	T10030016	EYEBOLT CLEVIS PIN
17	PLW04M	LOCK WASHER 8MM
18	PN03M	HEX NUT M8-1.25
19	T10030019	CASTER 3.5"
20	PN32M	HEX NUT M14-2
21	T10030021	LEG
22	PB06M	HEX BOLT M8-1.25 X 12
23	T10030023	CASTER 3"
24	PB09M	HEX BOLT M8-1.25 X 20
25	T10030025	MACHINE ID LABEL
26	T10030026	READ MANUAL LABEL

COPYRIGHT © OCTOBER, 2007 BY GRIZZLY INDUSTRIAL, INC.
WARNING: NO PORTION OF THIS MANUAL MAY BE REPRODUCED IN ANY SHAPE OR FORM WITHOUT THE WRITTEN APPROVAL OF GRIZZLY INDUSTRIAL, INC.
 #JM10082 PRINTED IN CHINA