



# MODEL T10433 17 GALLON OIL DRAIN CART WITH PUMP INSTRUCTIONS

For questions or help with this product contact Tech Support at (570) 546-9663 or techsupport@grizzly.com

## Introduction

The Model T10433 oil drain cart catches up to 17 gallons of waste oil or coolant drained from vehicles or pumped from tanks. The cart is equipped with four swivel casters, a manual transfer pump, towing handle, and sides that are designed to virtually eliminate oil spillage when being moved.

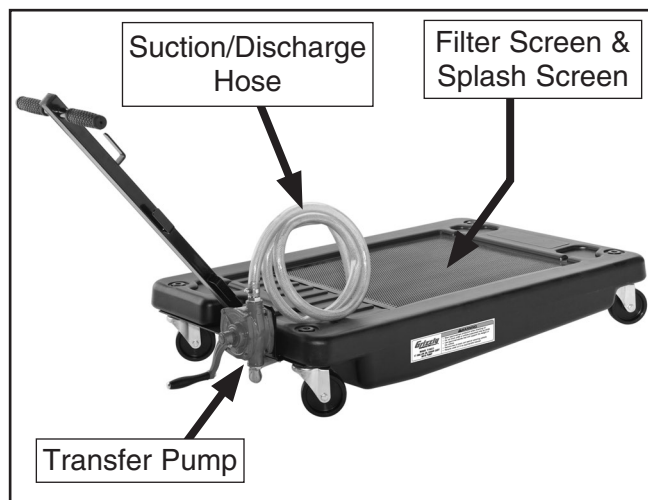

Figure 1. Model T10433.

## Specifications

Tank Construction .. Heat-Resistant Polyethylene  
Pump Type ..... Hand-Crank/Vane  
Size ..... 29½" Wide x 49" Long x 7¾" Tall  
Suction/Discharge Hose Size..... ¾" ID x 6-ft  
Caster Size ..... 4"  
Weight .....25 lbs

## **!WARNING**

**READ and UNDERSTAND these instructions before using the drain cart, or severe injury or death may result.**

## Setup & Use

To drain the cart, rotate the transfer pump handle clockwise and fluid will pour out of the suction/discharge hose. To draw fluid in through the suction/discharge hose and fill the cart, rotate the pump handle counterclockwise.

### For typical use:

1. Prepare the vehicle or machinery for safe service, and allow the fluid to cool to a safe temperature.
2. Put on safety goggles and heat/oil resistant gloves, and roll the cart under the vehicle or position the cart next to the tank to be drained.

**Tip:** To prevent the fluid from running down your arm when removing a drain plug, tie a rag around your wrist.

3. Position yourself away from the direction of anticipated oil flow. Then loosen and remove the drain plug and drain the fluid.
4. To remove fluid from a tank without a drain plug, insert the suction/discharge hose through the filler port, and rotate the transfer pump handle counterclockwise.
5. Pull the drain cart to the waste drum, insert the suction/discharge hose into the drum, and rotate the transfer pump handle clockwise until the cart is empty.
6. Wipe out the drain cart with rags and discard the waste liquid according to EPA and OSHA requirements.

COPYRIGHT © JUNE, 2011 BY GRIZZLY INDUSTRIAL, INC.

**WARNING: NO PORTION OF THIS MANUAL MAY BE REPRODUCED IN ANY SHAPE OR FORM WITHOUT THE WRITTEN APPROVAL OF GRIZZLY INDUSTRIAL, INC.**

#CR14192 PRINTED IN CHINA

## Safety

### **!WARNING**

No list of safety guidelines can be complete. Every working environment is different. Always consider safety first, as it applies to your current situation. Use this drain cart with caution and respect. Failure to do so could result in death, serious personal injury, or cart damage.

**PREVENTING GENERAL INJURIES.** Only use the drain cart on a level floor. Frequently inspect for damage or leaks, and repair as required. Never drain an engine when it is running. Never allow any persons to be in vehicle when draining the oil.

**PREVENTING CRUSHING INJURIES.** Park the vehicle on level ground with the ignition key removed and the parking brake set. Never work under any vehicle that is supported by a single jack. Always use wheel chocks and a secondary support system.

**PREVENTING SLIPS, TRIPS, AND FALLS.** Immediately wipe up oil spills. Never leave the cart partially under the step of a truck, or obstruct walkways. Never leave the handle or hose resting on the floor. When not in use, stow the handle and hose on top of the cart.

**PREVENTING SCALDING INJURIES.** Wear safety goggles, heat and oil resistant gloves, and take great care when working around a hot engine. Never drain oil immediately after an engine has been running, or while it is still hot. Do not rely on feeling oil pan surface as a means to gauge when the oil is cool enough to drain. The oil inside the oil pan will be much hotter than the temperature felt on the oil pan exterior.

**PREVENTING INJURIES FROM MISUSE.** Never use the drain cart as a parts dolly, disassembly workbench, or as a makeshift solvent tank. Do not allow anyone to play or ride on the cart.

**OIL DISPOSAL.** Follow all EPA and OSHA oil disposal requirements.

**PREVENTING FIRE.** Never drain gasoline or any other liquid with a high flash point that may combust from static electricity. Waste oil can also contain enough unburned fuel where it can ignite from a stray spark or open flame. Never leave the cart filled with oil for an extended period of time, or leave oil soaked rags on the cart. Keep the cart wiped clean, out of direct sunlight, and away from all ignition hazards.

## Parts Breakdown and List

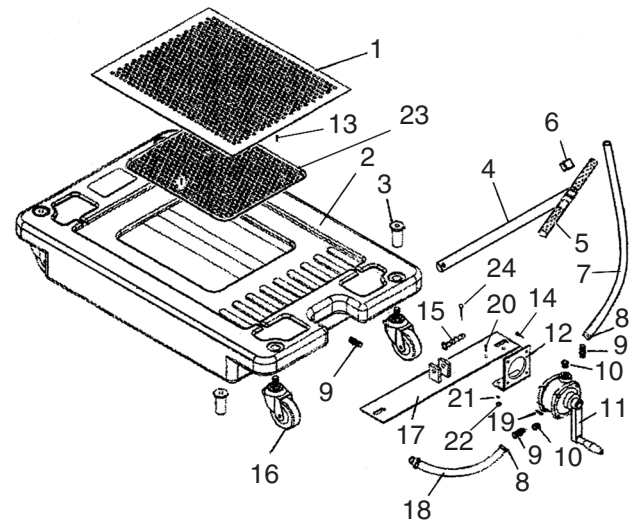

REF	PART #	DESCRIPTION
1	N/A	FILTER SCREEN
2	N/A	RESERVOIR
3	N/A	BARREL NUT
4	N/A	T-HANDLE ASSEMBLY
5	N/A	RUBBER HAND GRIP
6	N/A	PLUG
7	N/A	DISCHARGE HOSE 3/4" X 72"
8	N/A	HOSE CLAMP 1"
9	N/A	PUSH-ON FITTING
10	N/A	ELBOW FITTING 90°
11	N/A	TRANSFER PUMP ASSEMBLY
12	PS17	PHLP HD SCR 8-32 X 1/2
13	N/A	PUMP MOUNTING BRACKET
14	PCAP02M	CAP SCREW M6-1 X 20
15	N/A	COTTER PIN 2 X 25
16	N/A	SWIVEL CASTER 4"
17	N/A	AXLE PLATE
18	N/A	SUCTION HOSE 3/4" X 15"
19	PCAP02M	CAP SCREW M6-1 X 20
20	PB18M	HEX BOLT M6-1 X 15
21	N/A	6MM FLAT WASHER
22	N/A	HEX NUT M6-1
23	N/A	SPLASH SCREEN

*Parts breakdown provided for reference only.  
Not all parts shown are available for purchase.*

