

# WOOD LATHE COPY ATTACHMENT

## MODEL G2891

### PARTS LIST

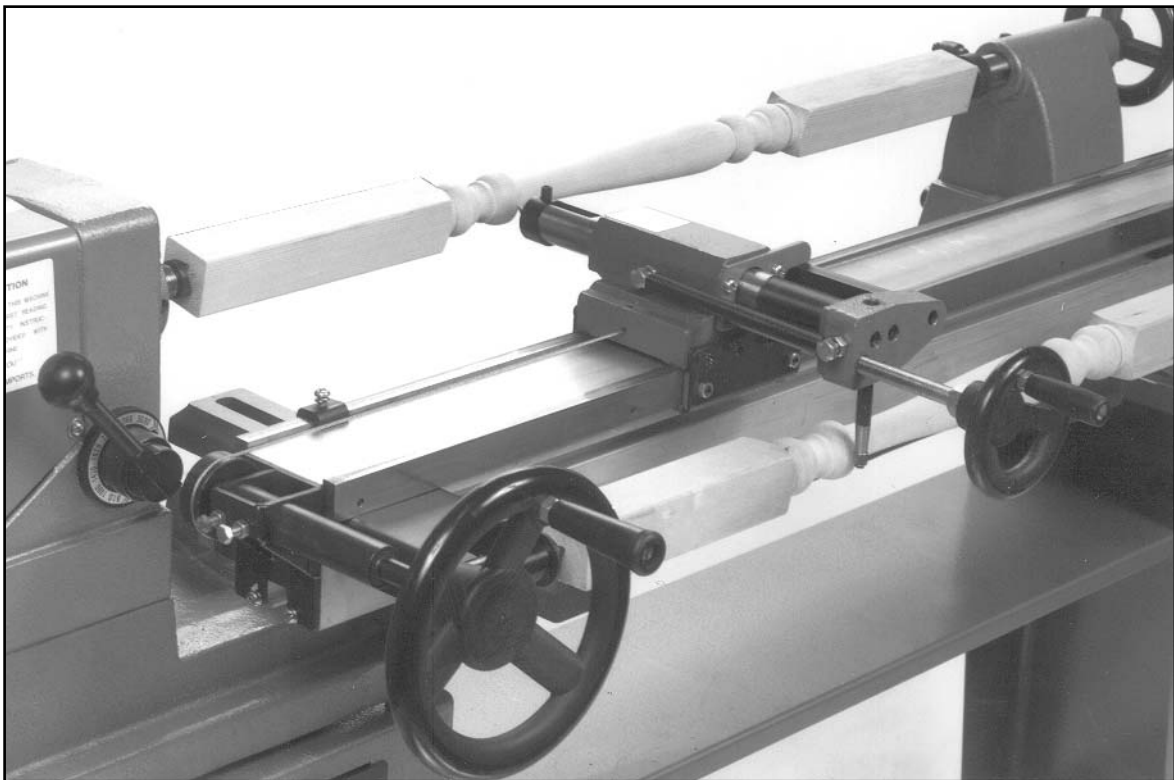

COPYRIGHT © 1993 BY GRIZZLY INDUSTRIAL, INC.

**WARNING: NO PORTION OF THIS MANUAL MAY BE REPRODUCED IN ANY SHAPE OR FORM WITHOUT THE WRITTEN APPROVAL OF GRIZZLY INDUSTRIAL, INC.**

REVISED APRIL, 1999. PRINTED IN U.S.A.

#### **PARTS LIST DISCLAIMER**

THIS PARTS LIST AND DRAWINGS REPRESENT THE CONFIGURATION OF THE MACHINE AS IT IS CURRENTLY BEING SHIPPED. THE MACHINE CONFIGURATION CAN CHANGE AS PRODUCT IMPROVEMENTS ARE INCORPORATED. IF YOU OWN AN EARLIER VERSION OF THE MACHINE, THIS PARTS LIST MAY NOT DEPICT YOUR MACHINE EXACTLY. CONTACT CUSTOMER SERVICE IF YOU HAVE ANY QUESTIONS ABOUT PART DIFFERENCES. PREVIOUS PARTS LIST VERSIONS ARE NOT AVAILABLE ONLINE.

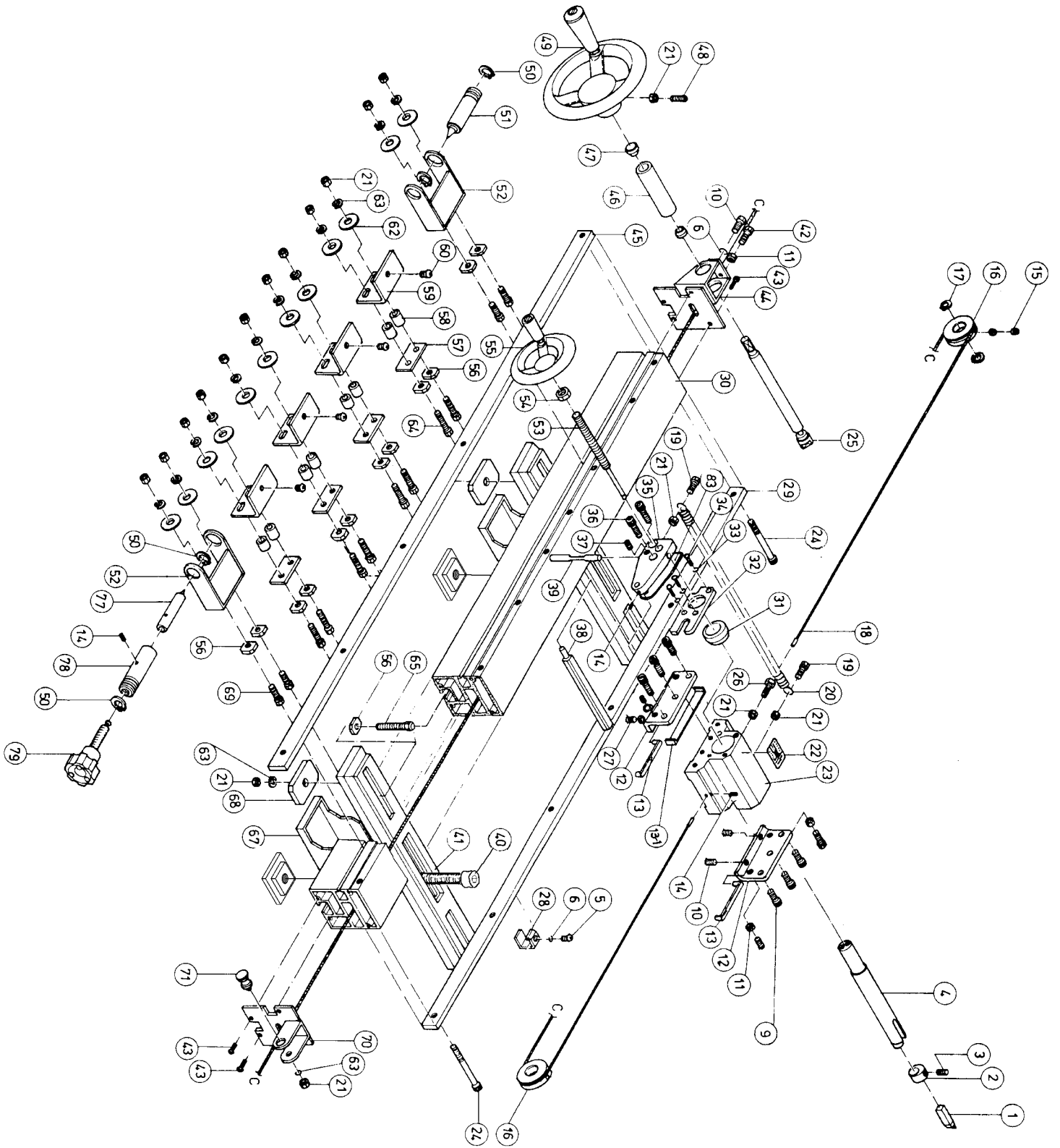

# G2891 PARTS LIST

Ref. #	Part #	Description	Ref. #	Part #	Description
001	P2891001	Cutting Tool	038	PSS03M	Setscrew M6-1.0 x 8
002	P2891002	Cutting Tool Collar	039	P2891038	Spindle Rod
003	PSS21M	Setscrew M8-1.25 x 25	040	P2891039	Stylus
004	P2891004	Arbor	041	PSB27	Cap Screw 5/8"-11x 2 1/2"
005	PS14M	Phillips® M6-1.0 x 12	042	P2891041	Support Bracket
006	PLW04M	Lock Washer 8mm	043	PB08M	Hex Bolt M6-1.0 x 20
009	PSB26M	Cap Screw M6-1.0 x 12	044	PS02	Phillips® 1/4"-20 x 3/4"
010	PSS04M	Setscrew M6-1.0 x 12	045	P2891044	Left Sleeve
011	PN01M	Hex Nut M6-1.0	046	P2891045	Rear Spindle Rail
012	P2891012	Front Mounting Plate	047	P2891046	Steel Tube
013	P2891013	Brass Packing Sheet	048	P2891047	Control Shaft Sleeve
013-1	P2891013-1	Brass Packing Sheet	049	PSS21M	Setscrew M8-1.25 x 25
014	PSS03M	Setscrew M6-1.0 x 8	050	P2891049	Longit. Feed Handwheel
015	PSS20M	Setscrew M6-1.25 x 8	051	PR11M	Retaining Ring 25mm
016	P2891016	Pulley	052	P2891051	Head Center
017	PR07M	Retaining Ring 18mm	053	P2891052	Center Post
018	P2891018	Cable	054	P2891053	Control Screw
019	PB03M	Hex Bolt M8-1.25 x 16	055	PN09M	Hex Nut M12-1.75
020	P2891020	Spring	056	P2891055	Cross-slide Handwheel
021	PN03M	Hex Nut M8-1.25	057	P2891056	Clamping Plate
022	P2891022	Feed Panel Label	058	P2891057	Packing Sheet
023	P2891023	Carriage Block	059	P2891058	Sleeve
024	PSB42M	Cap Screw M6-1.0 x 85	060	P2891059	Template Support Bracket
025	P2891025	Control Rod	062	PS16M	Phillips® M8-1.25 x 16
026	P2891026	Special Head Bolt	063	PW02	Flat Washer – 3/8"
027	PSS04M	Setscrew M6-1.0 x 12	064	PLW04	Lock Washer – 3/8"
028	P2891028	Carriage Stop Clip	065	PB28M	Hex Bolt M8-1.25 x 60
029	P2891029	Front Spindle Rail	068	PB28M	Hex Bolt M8-1.25 x 60
030	P2891030	Main Body	069	P2891068	Packing Block
031	P2891031	Shaft Sleeve	070	PB07M	Hex Bolt M8-1.25 x 25
032	P2891032	Spindle Plate	071	P2891070	Right Sleeve
033	PLW04M	Lockwasher 8mm	077	P2891071	Adjustment Shaft
034	PS15M	Phillips® M5-0.8 x 15	078	P2891077	Tail Center
035	P2891035	Copying Block	079	P2891078	Center Sleeve
036	PSB43M	Cap Screw M6-1.0 x 38	083	P2891079	Knob
037			084	P2891083	Copy Block Plate