

Hanging Clamp Rack Individual & Combo Sets Instruction Sheet



Phone #: (360) 647-0802 • Tech Support: techsupport@shopfoxtools.com • Web: www.shopfoxtools.com

Introduction

Made from heavy-duty steel and coated with a matte black finish, Shop Fox Hanging Clamp Racks are designed to provide a sturdy and efficient vertical storage system that will last a lifetime.

Hanging clamp racks are packaged individually in three-piece sets, as well as in three-piece combo sets. All clamp racks feature pre-drilled 16"-on-center holes for quick and accurate mounting to wall studs, and also include slotted holes for easy attachment to pre-existing tool storage assemblies.

Model D4345

The **D4345 Pipe Clamp Rack Set** includes (3) 24⁵/₈" Pipe Clamp Racks, which can hold up to nine pipe clamps.

Model D4346

The **D4346 Parallel Clamp Rack Set** includes (3) 23⁵/₈" Parallel Clamp Racks, which can hold up to twelve 50" parallel clamps.

Model D4347

The **D4347 F-Clamp Rack Set** includes (3) 24⁵/₈" F-Clamp Racks, which can hold up to fifteen F-style bar clamps.

Model D4333

The **D4333 Hanging Clamp Rack Combo Set** (pictured in **Figure 1**) includes (1) Pipe Clamp Rack, (1) Parallel Clamp Rack, and (1) F-Clamp Rack.

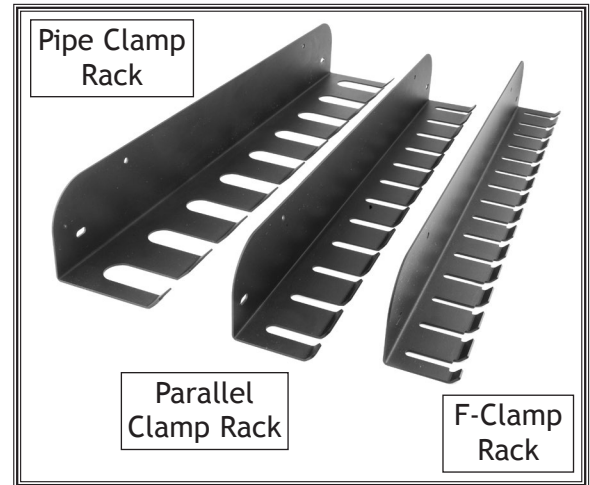

Figure 1. Model D4333 Inventory.

COPYRIGHT © AUGUST, 2012 BY GRIZZLY INDUSTRIAL, INC., REVISED FEBRUARY, 2025 (BL)

WARNING: NO PORTION OF THIS MANUAL MAY BE REPRODUCED IN ANY SHAPE OR FORM WITHOUT

V2.02.25

THE WRITTEN APPROVAL OF GRIZZLY INDUSTRIAL, INC.

#15228JM Printed in China

*****Keep for Future Reference*****

Mounting to Stud Walls

Tools and Supplies Needed

	Qty
Drill with Phillips Head Bit	1
Level	1
Pencil.....	1
6mm Flat Washers (2 per rack)	6
2" Wood Screws (2 per rack).....	6

To mount to stud walls:

1. Position the clamp rack on the wall so that the rack is flush and in an L position, making sure that both mounting locations are centered over stud walls.
2. Adjust the position of the clamp rack with the level until straight. Mark each hole with the pencil.
3. With an assistant holding the rack in place, align the pencil marks with the rack's top bolt holes and secure the rack firmly to each stud wall, using two wood screws and flat washers, as illustrated in **Figure 2**.

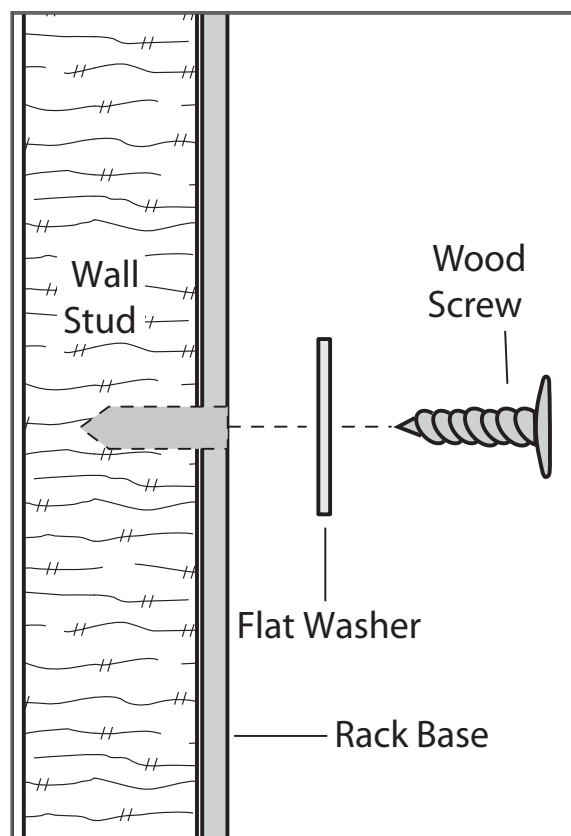

Figure 2. Wall stud installation.