

MODEL D4946 ROUTER TABLE DUST COLLECTION ENCLOSURE



Router Table
Not Included

OWNER'S MANUAL *(FOR MODELS MANUFACTURED SINCE 11/20)*

Phone: (360) 734-3482 • Online Technical Support: techsupport@woodstockint.com

COPYRIGHT © NOVEMBER, 2020 BY WOODSTOCK INTERNATIONAL, INC.
**WARNING: NO PORTION OF THIS MANUAL MAY BE REPRODUCED IN ANY SHAPE OR FORM WITHOUT
THE WRITTEN APPROVAL OF WOODSTOCK INTERNATIONAL, INC.**

#21496MN Printed in Taiwan



WARNING!

This manual provides critical safety instructions on the proper setup, operation, maintenance, and service of this machine/tool. Save this document, refer to it often, and use it to instruct other operators.

Failure to read, understand and follow the instructions in this manual may result in fire or serious personal injury—including amputation, electrocution, or death.

The owner of this machine/tool is solely responsible for its safe use. This responsibility includes but is not limited to proper installation in a safe environment, personnel training and usage authorization, proper inspection and maintenance, manual availability and comprehension, application of safety devices, cutting/sanding/grinding tool integrity, and the usage of personal protective equipment.

The manufacturer will not be held liable for injury or property damage from negligence, improper training, machine modifications or misuse.



WARNING!

Some dust created by power sanding, sawing, grinding, drilling, and other construction activities contains chemicals known to the State of California to cause cancer, birth defects or other reproductive harm. Some examples of these chemicals are:

- Lead from lead-based paints.
- Crystalline silica from bricks, cement and other masonry products.
- Arsenic and chromium from chemically-treated lumber.

Your risk from these exposures varies, depending on how often you do this type of work. To reduce your exposure to these chemicals: Work in a well ventilated area, and work with approved safety equipment, such as those dust masks that are specially designed to filter out microscopic particles.

Contents

INTRODUCTION	2
Woodstock Technical Support	2
Identification	3
Controls & Components	4
SAFETY.....	5
Standard Machinery Safety Instructions	5
ELECTRICAL	7
Circuit Requirements	7
Grounding Requirements.....	8
Extension Cords	8
SETUP	9
Unpacking	9
Items Needed for Setup.....	9
Inventory	9
Assembly.....	10
Connecting Power Cord	11
Dust Collection	12
Test Run.....	13
SERVICE	14
Electrical Safety Instructions.....	14
Wiring Diagram	15
PARTS	16
Main	16
WARRANTY	17





INTRODUCTION

Woodstock Technical Support

This machine has been specially designed to provide many years of trouble-free service. Close attention to detail, ruggedly built parts and a rigid quality control program assure safe and reliable operation.

Woodstock International, Inc. is committed to customer satisfaction. Our intent with this manual is to include the basic information for safety, setup, operation, maintenance, and service of this product.

We stand behind our machines! In the event that questions arise about your machine, please contact Woodstock International Technical Support at (360) 734-3482 Ext. 2 or send e-mail to: techsupport@woodstockint.com. Our knowledgeable staff will help you troubleshoot problems and process warranty claims.

If you need the latest edition, you can download it from <http://www.woodstockint.com/manuals>.

If you have comments about this manual, please contact us at:

Woodstock International, Inc.
Attn: Technical Documentation Manager
P.O. Box 2309
Bellingham, WA 98227
Email: manuals@woodstockint.com

Identification

Become familiar with the names and locations of the controls and features shown below to better understand the instructions in this manual.

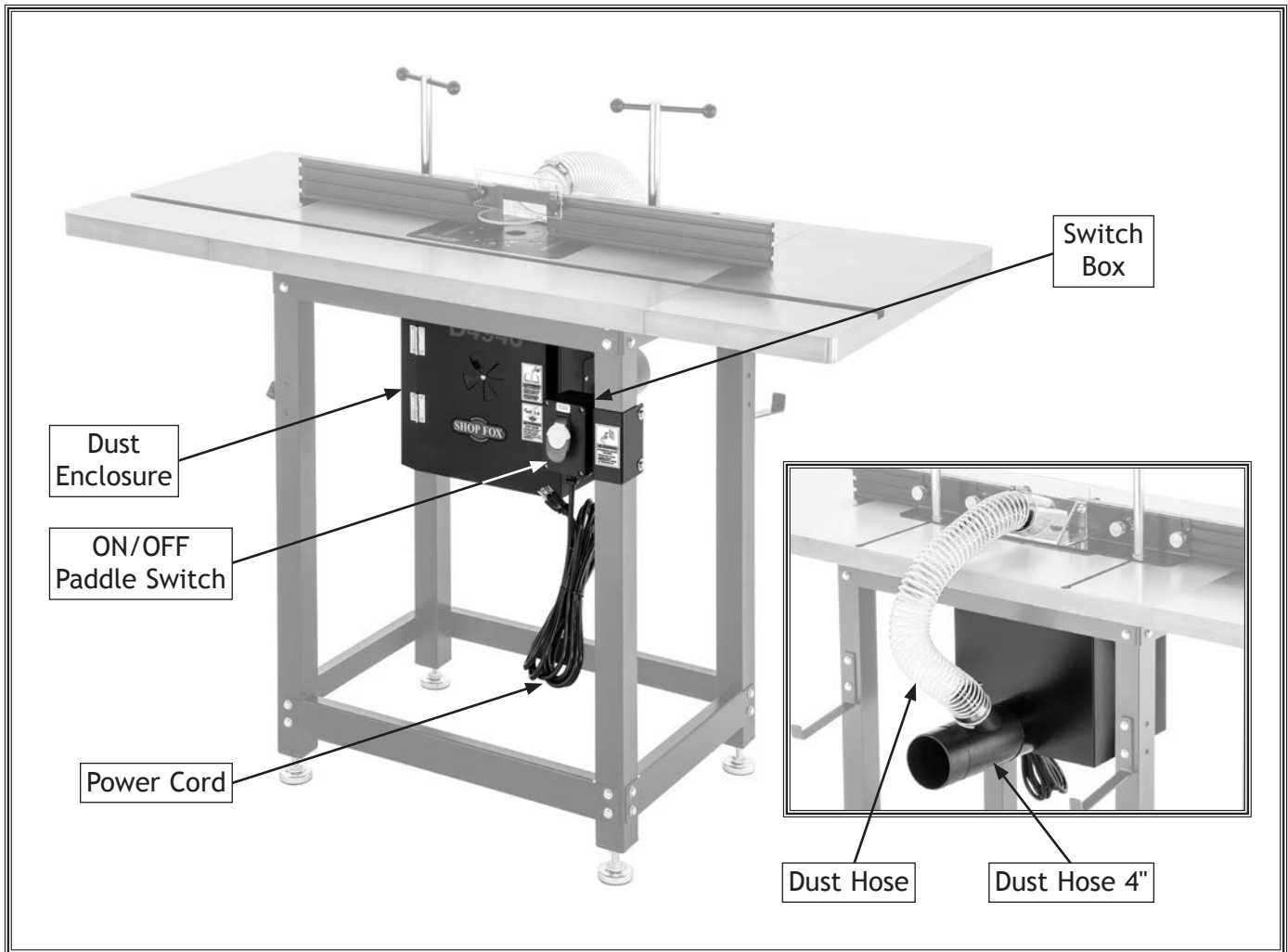

WARNING



To reduce your risk of serious injury or damage to the machine, read this entire manual **BEFORE** using machine.

Controls & Components

Refer to **Figures 1-2** and the following descriptions to become familiar with the basic controls and components of this machine. Understanding these items and how they work will help you understand the rest of the manual and stay safe when operating this machine.

- A. **Dust Enclosure.** Bolts to underside of router table to capture saw dust during operations.
- B. **ON/OFF Paddle Switch.** Turns router **ON** and **OFF**. Remove key to disable switch.
- C. **Switch Box.** Houses 110V electrical outlet, paddle switch, and power cord connection.
- D. **Dust Hose.** Connects included dust port to 2 1/2" outlet on user's router table fence.
- E. **Dust Port.** 4" dust port connects to user's dust-collection system.

WARNING



To reduce your risk of serious injury or damage to the machine, read this entire manual **BEFORE** using machine.

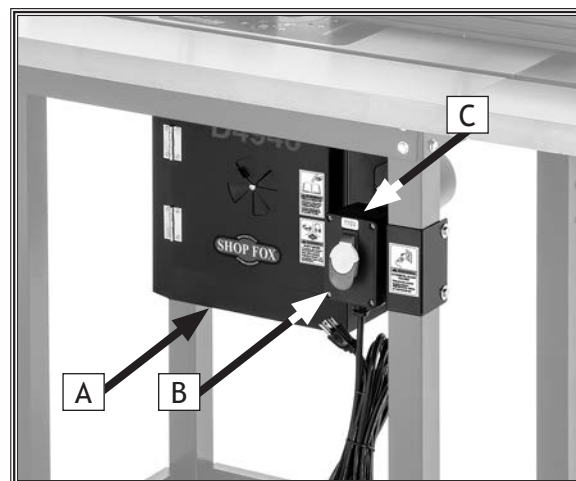

Figure 1. Dust enclosure controls and components (front).

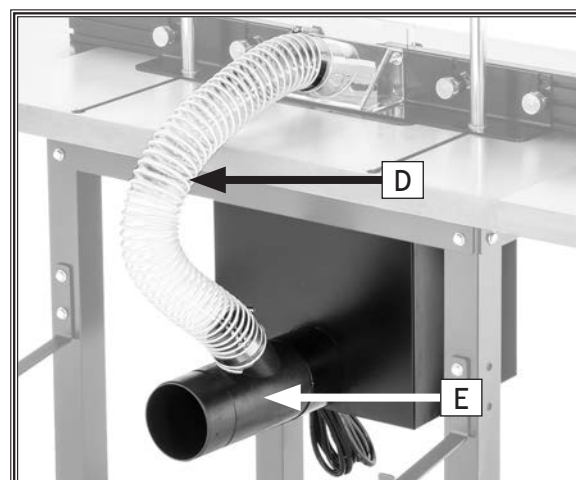

Figure 2. Dust enclosure controls and components (rear).

SAFETY

For Your Own Safety, Read Manual Before Operating Machine

The purpose of safety symbols is to attract your attention to possible hazardous conditions. This manual uses a series of symbols and signal words intended to convey the level of importance of the safety messages. The progression of symbols is described below. Remember that safety messages by themselves do not eliminate danger and are not a substitute for proper accident prevention measures—this responsibility is ultimately up to the operator!



Indicates an imminently hazardous situation which, if not avoided, **WILL** result in death or serious injury.



Indicates a potentially hazardous situation which, if not avoided, **COULD** result in death or serious injury.



Indicates a potentially hazardous situation which, if not avoided, **MAY** result in minor or moderate injury.

NOTICE

This symbol is used to alert the user to useful information about proper operation of the equipment or a situation that may cause damage to the machinery.

Standard Machinery Safety Instructions

OWNER'S MANUAL. Read and understand this owner's manual **BEFORE** using machine.

TRAINED OPERATORS ONLY. Untrained operators have a higher risk of being hurt or killed. Only allow trained/supervised people to use this machine. When machine is not being used, disconnect power, remove switch keys, or lock-out machine to prevent unauthorized use—especially around children. Make workshop kid proof!

DANGEROUS ENVIRONMENTS. Do not use machinery in areas that are wet, cluttered, or have poor lighting. Operating machinery in these areas greatly increases the risk of accidents and injury.

MENTAL ALERTNESS REQUIRED. Full mental alertness is required for safe operation of machinery. Never operate under the influence of drugs or alcohol, when tired, or when distracted.

ELECTRICAL EQUIPMENT INJURY RISKS. You can be shocked, burned, or killed by touching live electrical components or improperly grounded machinery. To reduce this risk, only allow an electrician or qualified service personnel to do electrical installation or repair work, and always disconnect power before accessing or exposing electrical equipment.

DISCONNECT POWER FIRST. Always disconnect machine from power supply **BEFORE** making adjustments, changing tooling, or servicing machine. This eliminates the risk of injury from unintended startup or contact with live electrical components.

EYE PROTECTION. Always wear ANSI-approved safety glasses or a face shield when operating or observing machinery to reduce the risk of eye injury or blindness from flying particles. Everyday eyeglasses are not approved safety glasses.

WEARING PROPER APPAREL. Do not wear clothing, apparel, or jewelry that can become entangled in moving parts. Always tie back or cover long hair. Wear non-slip footwear to avoid accidental slips, which could cause loss of workpiece control.

HAZARDOUS DUST. Dust created while using machinery may cause cancer, birth defects, or long-term respiratory damage. Be aware of dust hazards associated with each workpiece material, and always wear a NIOSH-approved respirator to reduce your risk.

HEARING PROTECTION. Always wear hearing protection when operating or observing loud machinery. Extended exposure to this noise without hearing protection can cause permanent hearing loss.

REMOVE ADJUSTING TOOLS. Tools left on machinery can become dangerous projectiles upon startup. Never leave chuck keys, wrenches, or any other tools on machine. Always verify removal before starting!

INTENDED USAGE. Only use machine for its intended purpose—never make modifications without prior approval from Woodstock International. Modifying machine or using it differently than intended will void the warranty and may result in malfunction or mechanical failure that leads to serious personal injury or death!

AWKWARD POSITIONS. Keep proper footing and balance at all times when operating machine. Do not overreach! Avoid awkward hand positions that make workpiece control difficult or increase the risk of accidental injury.

CHILDREN & BYSTANDERS. Keep children and bystanders at a safe distance from the work area. Stop using machine if they become a distraction.

GUARDS & COVERS. Guards and covers reduce accidental contact with moving parts or flying debris—make sure they are properly installed, undamaged, and working correctly.

FORCING MACHINERY. Do not force machine. It will do the job safer and better at the rate for which it was designed.

NEVER STAND ON MACHINE. Serious injury may occur if machine is tipped or if the cutting tool is unintentionally contacted.

STABLE MACHINE. Unexpected movement during operation greatly increases risk of injury or loss of control. Before starting, verify machine is stable and mobile base (if used) is locked.

USE RECOMMENDED ACCESSORIES. Consult this owner's manual or the manufacturer for recommended accessories. Using improper accessories will increase risk of serious injury.

UNATTENDED OPERATION. To reduce the risk of accidental injury, turn machine **OFF** and ensure all moving parts completely stop before walking away. Never leave machine running while unattended.

MAINTAIN WITH CARE. Follow all maintenance instructions and lubrication schedules to keep machine in good working condition. A machine that is improperly maintained could malfunction, leading to serious personal injury or death.

CHECK DAMAGED PARTS. Regularly inspect machine for any condition that may affect safe operation. Immediately repair or replace damaged or mis-adjusted parts before operating machine.

MAINTAIN POWER CORDS. When disconnecting cord-connected machines from power, grab and pull the plug—NOT the cord. Pulling the cord may damage the wires inside, resulting in a short. Do not handle cord/plug with wet hands. Avoid cord damage by keeping it away from heated surfaces, high traffic areas, harsh chemicals, and wet/damp locations.

EXPERIENCING DIFFICULTIES. If at any time you experience difficulties performing the intended operation, stop using the machine! Contact Technical Support at (360) 734-3482.

ELECTRICAL

Circuit Requirements

This machine must be connected to the correct size and type of power supply circuit, or fire or electrical damage may occur. Read through this section to determine if an adequate power supply circuit is available. If a correct circuit is not available, a qualified electrician **MUST** install one before you can connect the machine to power.

A power supply circuit includes all electrical equipment between the breaker box or fuse panel in the building and the machine. The power supply circuit used for this machine must be sized to safely handle the full-load current drawn from the machine for an extended period of time. (If this machine is connected to a circuit protected by fuses, use a time delay fuse marked D.)

Circuit Requirements for 110V

This machine is prewired to operate on a power supply circuit that has a verified ground and meets the following requirements:

Circuit Type 110V/120V, 60 Hz, Single-Phase
Circuit Size 15 Amps
Plug/Receptacle NEMA 5-15

WARNING

The machine must be properly set up before it is safe to operate. **DO NOT** connect this machine to the power source until instructed to do so later in this manual.

WARNING



Incorrectly wiring or grounding this machine can cause electrocution, fire, or machine damage. To reduce this risk, only an electrician or qualified service personnel should do any required electrical work on this machine.

NOTICE

The circuit requirements listed in this manual apply to a dedicated circuit—where only one machine will be running at a time. If this machine will be connected to a shared circuit where multiple machines will be running at the same time, consult with an electrician to ensure that the circuit is properly sized for safe operation.

Grounding Requirements

This machine **MUST** be grounded. In the event of certain types of malfunctions or breakdowns, grounding provides a path of least resistance for electric current to travel—in order to reduce the risk of electric shock.

Improper connection of the equipment-grounding wire will increase the risk of electric shock. The wire with green insulation (with/without yellow stripes) is the equipment-grounding wire. If repair or replacement of the power cord or plug is necessary, do not connect the equipment-grounding wire to a live (current carrying) terminal.

Check with a qualified electrician or service personnel if you do not understand these grounding requirements, or if you are in doubt about whether the tool is properly grounded. If you ever notice that a cord or plug is damaged or worn, disconnect it from power, and immediately replace it with a new one.

For 110V Connection

This machine is equipped with a power cord with an equipment-grounding wire and NEMA 5-15 grounding plug (see figure). The plug must only be inserted into a matching receptacle that is properly installed and grounded in accordance with local codes and ordinances.

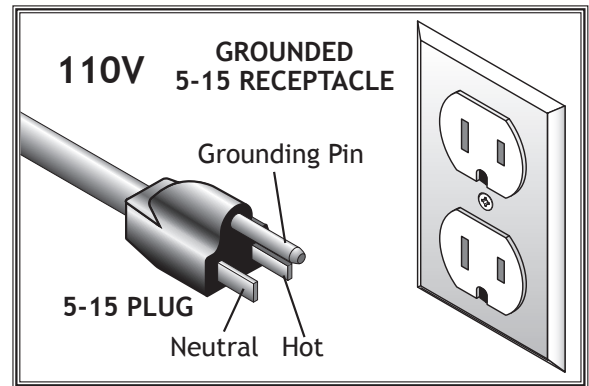
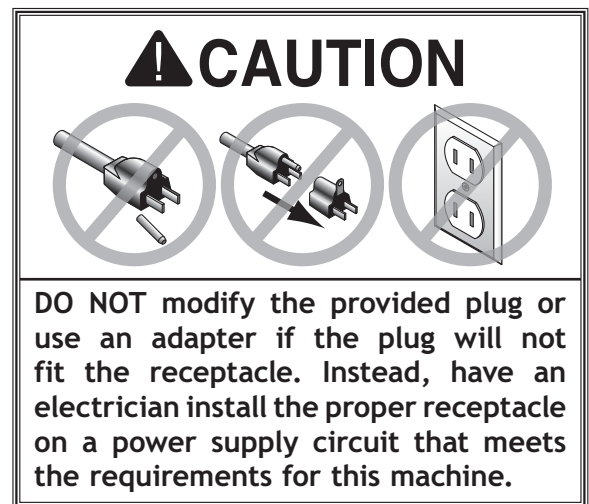

Figure 3. NEMA 5-15 plug & receptacle.



Extension Cords

We do not recommend using an extension cord with this machine. Extension cords cause voltage drop, which may damage electrical components and shorten motor life. Voltage drop increases with longer extension cords and smaller gauge sizes (higher gauge numbers indicate smaller sizes).

Any extension cord used with this machine must contain a ground wire, match the required plug and receptacle, and meet the following requirements:

Minimum Gauge Size at 110V 14 AWG
Maximum Length (Shorter is Better) 50 ft.

SETUP

Unpacking

This machine has been carefully packaged for safe transportation. If you notice the machine has been damaged during shipping, please contact your authorized Shop Fox dealer immediately.

Items Needed for Setup

The following items are needed, but not included, to set up your machine.

Description	Qty
• Phillips Head Screwdriver #1	1
• Open-End Wrench or Socket 12mm.....	1
• Disposable Rags for Cleaning	As Needed

Inventory

The following is a list of items shipped with your machine. Before beginning setup, lay these items out and inventory them.

Note: If you cannot find an item on this list, carefully check around/inside the machine and packaging materials. Often, these items get lost in packaging materials while unpacking or they are pre-installed at the factory.

Box Contents (Figure 4):	Qty
A. Dust Enclosure	1
B. Y-Fitting 4" x 4" x 2 1/2".....	1
C. Switch Box.....	1
D. Dust Hose 2 1/2" x 28".....	1
E. Strain Relief 1/2".....	1
F. Star Knob 1/4"-20 x 1 1/2".....	1
G. Hose Clamps 3".....	2
H. Hex Bolts 1/4"-20 x 2 1/2".....	2
I. Flat Washers 1/4".....	2
J. Phillip Head Screws 10-24 x 3/8".....	6

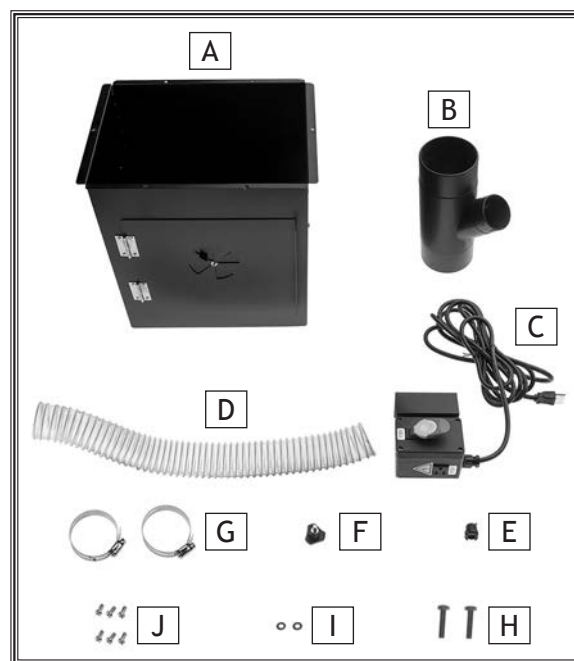
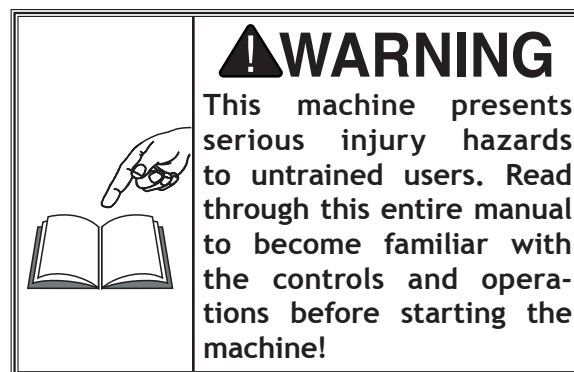

Figure 4. Inventory.

Assembly

Before beginning the assembly process, refer to **Items Needed for Setup** and gather everything you need. Ensure all parts have been properly cleaned of any heavy-duty rust-preventative applied at the factory (if applicable). Be sure to complete all steps in the assembly procedure prior to performing the **Test Run** or connecting the machine to power.

To install switch box and dust enclosure, do these steps:

1. Attach switch box (see **Figure 5**) to leg of your router table stand with pre-installed clamp and (2) 1/4"-20 x 2 1/2" hex bolts and (2) 1/4" flat washers.
2. Install dust enclosure (see **Figure 6**) underneath your router table with (6) 10-24 x 3/8" Phillips head screws.

Note: The vent should be facing the front of your table.

3. Install Y-fitting (see **Figure 7**) on dust port and secure with (1) 1/4"-20 x 1/2" knob.

4. Attach 2 1/2" dust hose (see **Figure 8**) on Y-fitting and the dust shroud on your router table fence. Secure with 3" hose clamps.

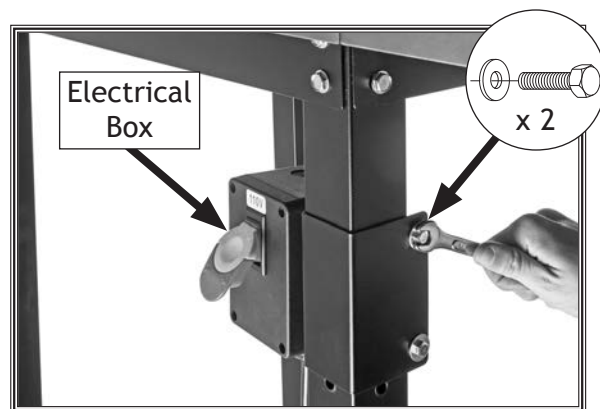

Figure 5. Attaching switch box to a stand.

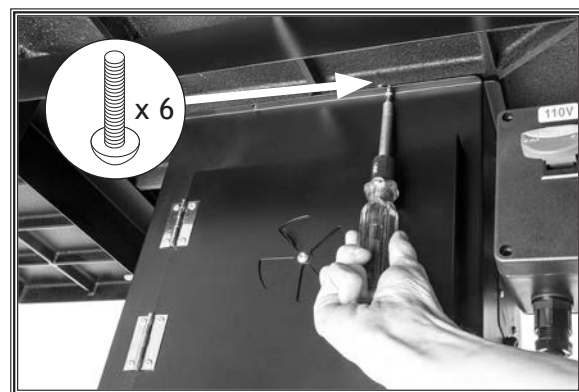

Figure 6. Attaching dust enclosure to table.

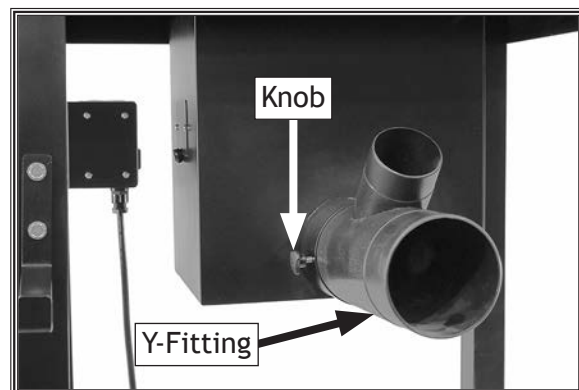

Figure 7. Y-fitting attached to dust port.

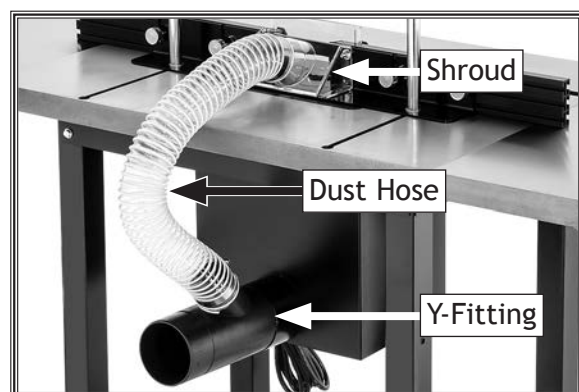

Figure 8. Example of dust hose connecting Y-fitting and fence dust shroud.

Connecting Power Cord

The Model D4946 includes a switch box with a 110V receptacle and an ON/OFF paddle switch (see **Figure 9**). The router power cord can be plugged into the 110V receptacle, and the power cord on the switch box can be plugged into a 110V outlet. This allows you to start and stop your router without having to reach into the dust enclosure for the router ON/OFF switch.

To connect router and router table to power, do these steps:

1. Ensure paddle switch is set to OFF position.
2. Loosen (2) 10-24 x $\frac{3}{8}$ " Phillips head screws (see **Figure 10**) securing side door on dust enclosure, and feed router power cord through opening.
3. Plug router power cord into 110V receptacle on switch box.
4. Plug switch box power cord into matching power supply outlet.
5. Install $\frac{1}{2}$ " strain relief (see **Figure 10**) on router power cord where it emerges from dust enclosure side door and secure by tightening screws.

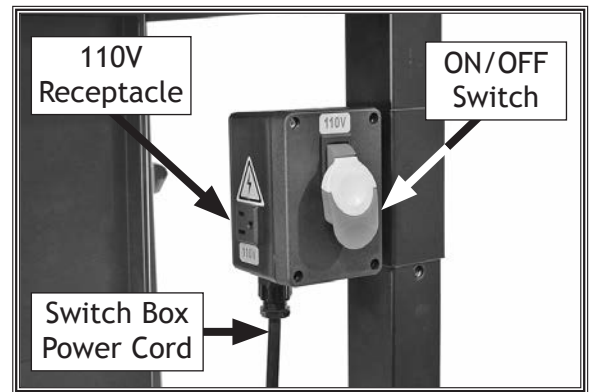

Figure 9. Location of ON/OFF switch and 110V receptacle.

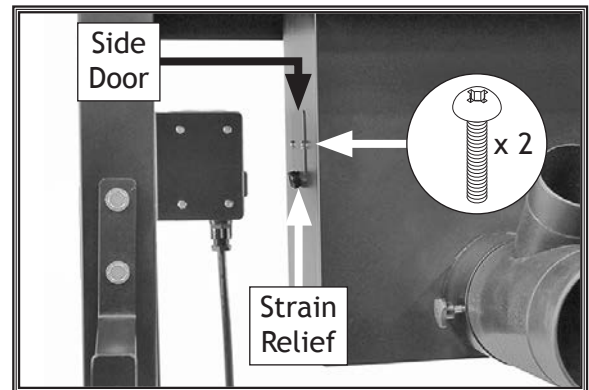

Figure 10. Location of dust enclosure side door.

Dust Collection

Recommended CFM at Dust Port: 400 CFM

Do not confuse this CFM recommendation with the rating of the dust collector. To determine the CFM at the dust port, you must consider these variables: (1) CFM rating of the dust collector, (2) hose type and length between the dust collector and the machine, (3) number of branches or wyes, and (4) amount of other open lines throughout the system. Explaining how to calculate these variables is beyond the scope of this manual. Consult an expert or purchase a good dust collection “how-to” book.

CAUTION

This machine creates substantial amounts of dust during operation. Breathing airborne dust on a regular basis can result in permanent respiratory illness. Reduce your risk by wearing a respirator and capturing the dust with a dust collection system.

SETUP

Tools Needed	Qty
Dust Collection System	1
Dust Hose 4"	1
Hose Clamps 4"	2

To connect a dust collection hose, do these steps:

1. Fit a 4" dust hose over dust port, as shown in **Figure 11**, and secure it in place with a hose clamp.
2. Tug hose to make sure it does not come off.

Note: A tight fit is necessary for proper performance.

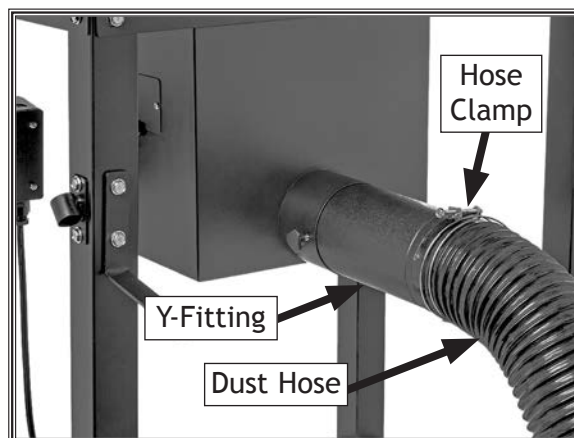

Figure 11. Example of 4" dust hose connected to Y-fitting.

Test Run

Once assembly is complete, test run the machine to ensure it is properly connected to power and safety components are functioning properly.

If you find an unusual problem during the test run, immediately stop the machine, disconnect it from power, and fix the problem **BEFORE** operating the machine again. The **Troubleshooting** table in the **SERVICE** section of this manual can help.

The Test Run consists of verifying the following: 1) The motor powers up and runs correctly, and 2) the switch disabling key disables the switch properly.

To test run the machine, do these steps:

1. Clear all setup tools away from router table.
2. Make sure paddle switch is set to OFF position.
3. Make sure router power cord is plugged into 110V receptacle in switch box.
4. Connect router table power cord to power supply.
5. Reach into dust enclosure and turn router **ON**.
6. Using paddle switch, turn router table **ON**, verify router powers up, and then turn router table **OFF**.
7. Remove switch-disabling key, as shown in **Figure 12**.
8. Try to start router with paddle switch. The router *should not* start.
 - If router *does not* start, switch disabling feature is working as designed.
 - If router *does* start, immediately stop router. The switch disabling feature is not working correctly. This safety feature must work properly before proceeding with regular operations.
9. Re-install switch-disabling key in paddle switch.

Congratulations! The test run is complete. The router table is ready for operation.

WARNING

Serious injury or death can result from using this machine **BEFORE** understanding its controls and related safety information. **DO NOT** operate, or allow others to operate, machine until the information is understood.

WARNING

DO NOT start machine until all preceding setup instructions have been performed. Operating an improperly set up machine may result in malfunction or unexpected results that can lead to serious injury, death, or machine/property damage.

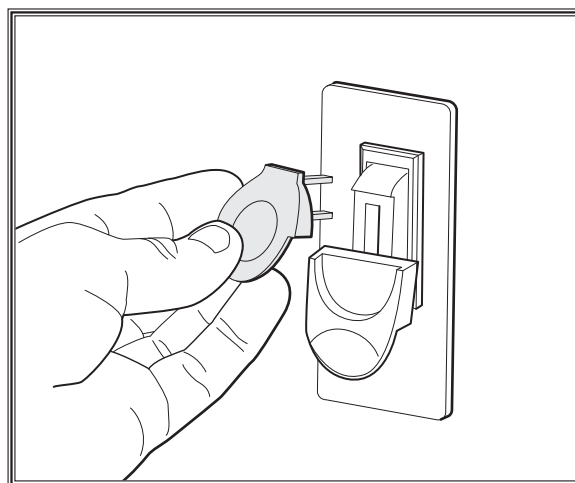

Figure 12. Removing switch key from paddle switch.

SERVICE

Electrical Safety Instructions

These pages are current at the time of printing. However, in the spirit of improvement, we may make changes to the electrical systems of future machines. Compare the manufacture date of your machine to the one stated in this manual, and study this section carefully.

If there are differences between your machine and what is shown in this section, call Technical Support at (360) 734-3482 for assistance BEFORE making any changes to the wiring on your machine. An updated wiring diagram may be available. **Note:** Please gather the serial number and manufacture date of your machine before calling. This information can be found on the main machine label.

⚠ WARNING

SHOCK HAZARD. Working on wiring that is connected to a power source is extremely dangerous. Touching electrified parts will result in personal injury including but not limited to severe burns, electrocution, or death. Disconnect the power from the machine before servicing electrical components!

QUALIFIED ELECTRICIAN. Due to the inherent hazards of electricity, only a qualified electrician should perform wiring tasks on this machine. If you are not a qualified electrician, get help from one before attempting any kind of wiring job.

WIRE CONNECTIONS. All connections must be tight to prevent wires from loosening during machine operation. Double-check all wires disconnected or connected during any wiring task to ensure tight connections.

WIRE/COMPONENT DAMAGE. Damaged wires or components increase the risk of serious personal injury, fire, or machine damage. If you notice that any wires or components are damaged while performing a wiring task, replace those wires or components before completing the task.

MODIFICATIONS. Using aftermarket parts or modifying the wiring beyond what is shown in the diagram may lead to unpredictable results, including serious injury or fire.

MOTOR WIRING. The motor wiring shown in these diagrams is current at the time of printing, but it may not match your machine. Always use the wiring diagram inside the motor junction box.

CAPACITORS/INVERTERS. Some capacitors and power inverters store an electrical charge for up to 10 minutes after being disconnected from the power source. To reduce the risk of being shocked, wait at least this long before working on capacitors.

CIRCUIT REQUIREMENTS. You MUST follow the requirements at the beginning of this manual when connecting your machine to a power source.

EXPERIENCING DIFFICULTIES. If you are experiencing difficulties understanding the information included in this section, contact our Technical Support at (360) 734-3482.

NOTICE

The photos and diagrams included in this section are best viewed in color. You can view these pages in color at www.shopfox.biz.

WIRING DIAGRAM COLOR KEY

BLACK — Bk	BLUE — Bl	YELLOW — Yl	LIGHT BLUE — Lb
WHITE — Wt	BROWN — Br	YELLOW GREEN — Yg	BLUE WHITE — Bw
GREEN — Gn	GRAY — Gy	PURPLE — Pu	TURQUOISE — Tu
RED — Rd	ORANGE — Or	PINK — Pk	

Wiring Diagram

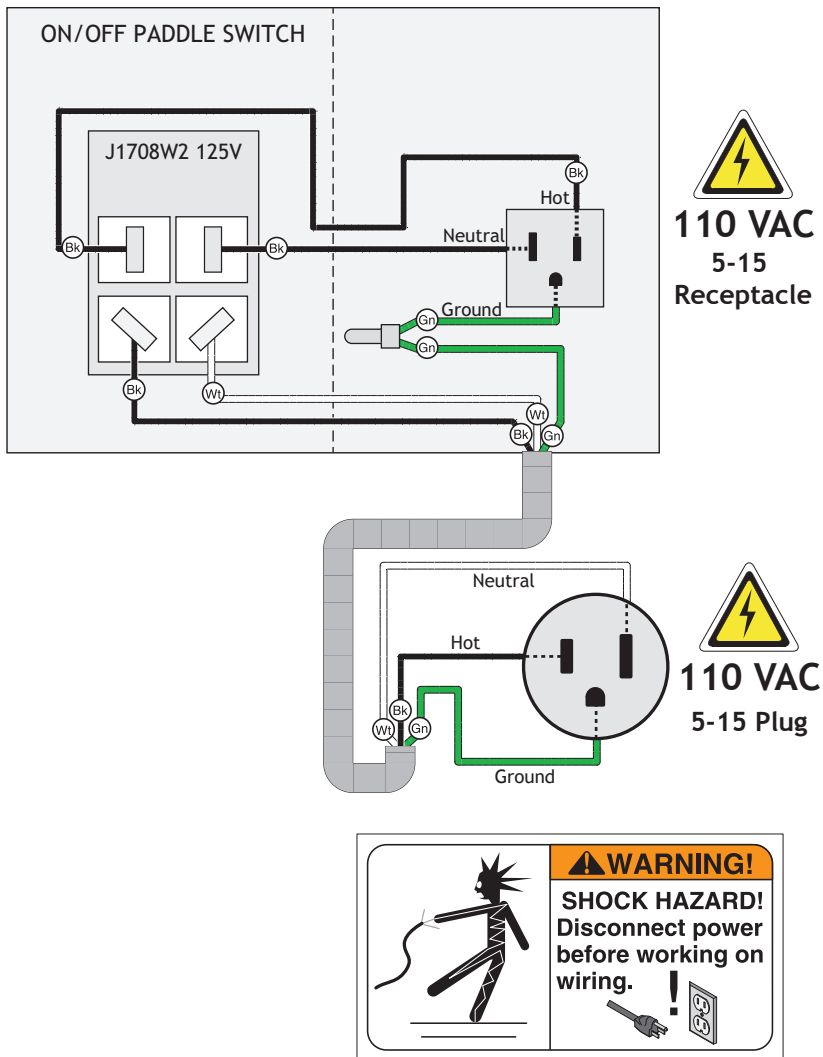
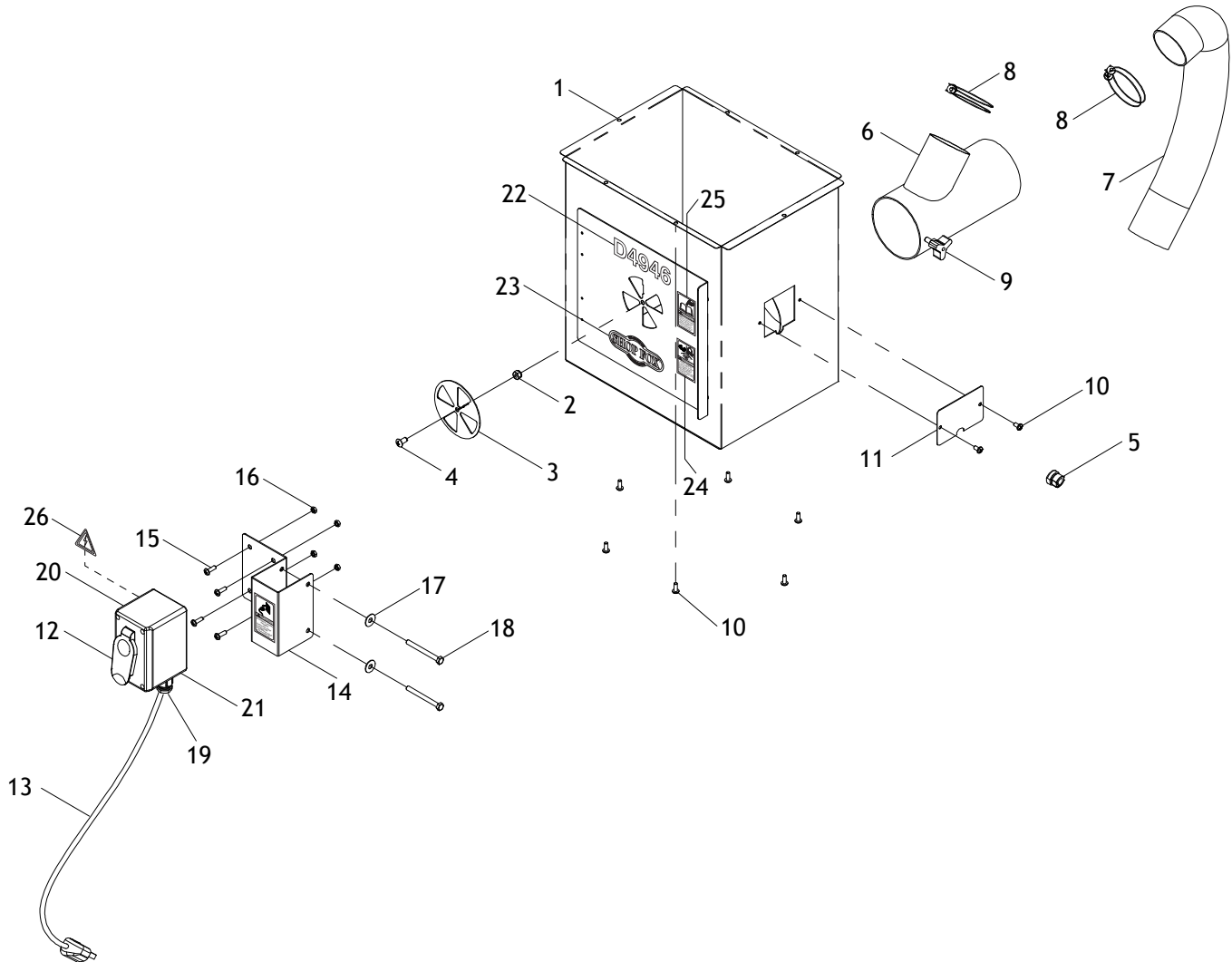

Figure 13. ON/OFF switch and 110V outlet wiring.



PARTS

Main



REF	PART #	DESCRIPTION
1	XD4946001	DUST ENCLOSURE
2	XD4946002	LOCK NUT 1/4-20
3	XD4946003	DUST BOX VENT PLATE
4	XD4946004	BUTTON HD CAP SCR 1/4-20 X 1/2
5	XD4946005	STRAIN RELIEF TYPE-1 1/2
6	XD4946006	Y-FITTING 4" X 4" X 2-1/2"
7	XD4946007	DUST HOSE 2-1/2" X 28"
8	XD4946008	WIRE HOSE CLAMP 3"
9	XD4946009	KNOB BOLT 1/4-20 X 1 1/2, 3-LOBE, D1
10	XD4946010	PHLP HD SCR 10-24 X 3/8
11	XD4946011	CORD CLAMP PLATE
12	XD4946012	PADDLE SWITCH J1708W2 125VAC
13	XD4946013	POWER CORD 14G 3W 72" 5-15P

REF	PART #	DESCRIPTION
14	XD4946014	SWITCH BRACKET
15	XD4946015	PHLP HD SCR 10-24 X 5/8
16	XD4946016	LOCK NUT 10-24
17	XD4946017	FLAT WASHER 1/4
18	XD4946018	HEX BOLT 1/4-20 X 2-1/2
19	XD4946019	STRAIN RELIEF TYPE-3 M16-2
20	XD4946020	ELECTRICAL OUTLET 15A 125V
21	XD4946021	SWITCH BOX
22	XD4946022	MODEL NUMBER LABEL
23	XD4946023	SHOP FOX LOGO
24	XD4946024	EYE EAR LUNG HAZARD LABEL
25	XD4946025	READ MANUAL LABEL
26	XD4946026	ELECTRICITY LABEL

WARRANTY

Woodstock International, Inc. warrants all Shop Fox machinery to be free of defects from workmanship and materials for a period of two years from the date of original purchase by the original owner. This warranty does not apply to defects due directly or indirectly to misuse, abuse, negligence or accidents, lack of maintenance, or reimbursement of third party expenses incurred.

Woodstock International, Inc. will repair, replace, or arrange for a dealer refund, at its expense and option, the Shop Fox machine or machine part proven to be defective for its designed and intended use, provided that the original owner returns the product prepaid to an authorized warranty or repair facility as designated by our Bellingham, Washington office with proof of their purchase of the product within two years, and provides Woodstock International, Inc. reasonable opportunity to verify the alleged defect through inspection. If it is determined there is no defect, or that the defect resulted from causes not within the scope of Woodstock International Inc.'s warranty, then the original owner must bear the cost of storing and returning the product.

This is Woodstock International, Inc.'s sole written warranty and any and all warranties that may be implied by law, including any merchantability or fitness, for any particular purpose, are hereby limited to the duration of this written warranty. We do not warrant that Shop Fox machinery complies with the provisions of any law, acts or electrical codes. We do not reimburse for third party repairs. In no event shall Woodstock International, Inc.'s liability under this limited warranty exceed the purchase price paid for the product, and any legal actions brought against Woodstock International, Inc. shall be tried in the State of Washington, County of Whatcom. We shall in no event be liable for death, injuries to persons or property or for incidental, contingent, special or consequential damages arising from the use of our products.

Every effort has been made to ensure that all Shop Fox machinery meets high quality and durability standards. We are committed to continuously improving the quality of our products, and reserve the right to change specifications at any time.

To register the warranty, go to <https://www.woodstockint.com/warranty>, or scan the QR code below. You will be directed to the Warranty Registration page on www.woodstockint.com. Enter all applicable production information.





High Quality Machines and Tools

Woodstock International, Inc. carries thousands of products designed to meet the needs of today's woodworkers and metalworkers.

Ask your dealer about these fine products:

BROSM
PRECISION STOP BLOCK

JOINTER PAL®

Rotacator®

STEELEX®
FINE TOOLS

PLANER PAL®

THE REBEL®

PRO-STIK®
ABRASIVE BELT & DISC CLEANER

BOARD BUDDIES®

WOODSTOCK
SHOP FOX®
INTERNATIONAL

STEELEX®
PLUS

SLICKPLANE®

Aluma-Classic®

ACCU-SHARP®



PARROT VISE®

WHOLESALE ONLY

WOODSTOCK INTERNATIONAL, INC.

Phone: (360) 734-3482 • Fax: (360) 671-3053 • Toll Free Fax: (800) 647-8801

P.O.Box 2309 • Bellingham, WA 98227

SHOPFOX.BIZ