

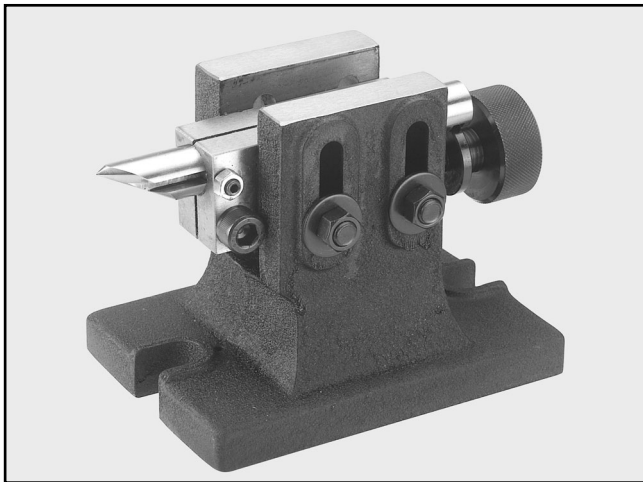

INSTRUCTION SHEET MODEL G1763 TAILSTOCK

The **Model G1763 Tailstock** is designed for the Model G1049 6" Rotary Table. This tailstock allows the operator to support larger workpieces while maintaining a high level of accuracy.



Model G1763 Tailstock

To install the Model G1763 Tailstock to your milling table:

1. Secure the Model G1049 Rotary Table in the vertical position on the milling table.
2. Install the tailstock onto the milling table so the dead center of the tailstock is inline with the center of the rotary table in both the X and Y axes. Note—*For added convenience slots are machined in both the tailstock and the rotary table for keys (not supplied) to help with the alignment of the centers as shown in Figure 1-3.*

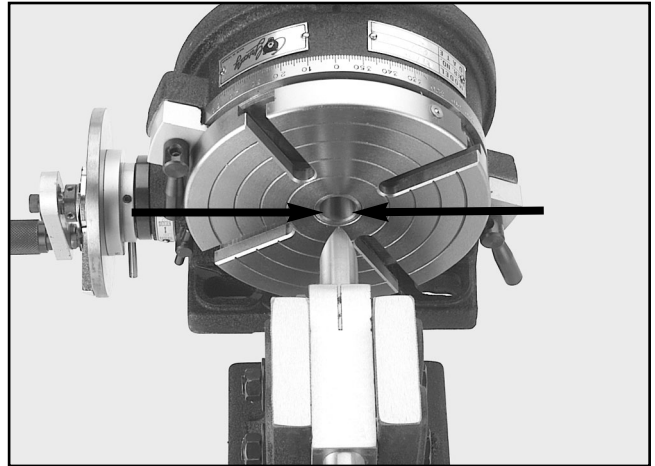

Figure 1. Alignment of Y axis.

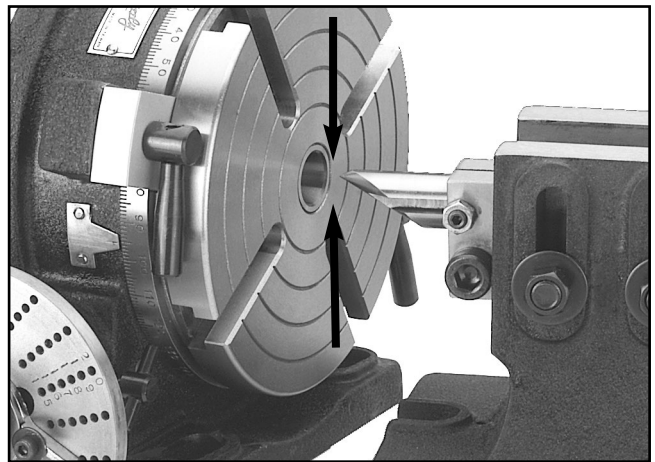

Figure 2. Alignment of Z axis.

NOTICE

It is extremely important to align centers in the Y&Z axes. If axes are not properly aligned, the depth, size, parallelism and overall trueness will be compromised.

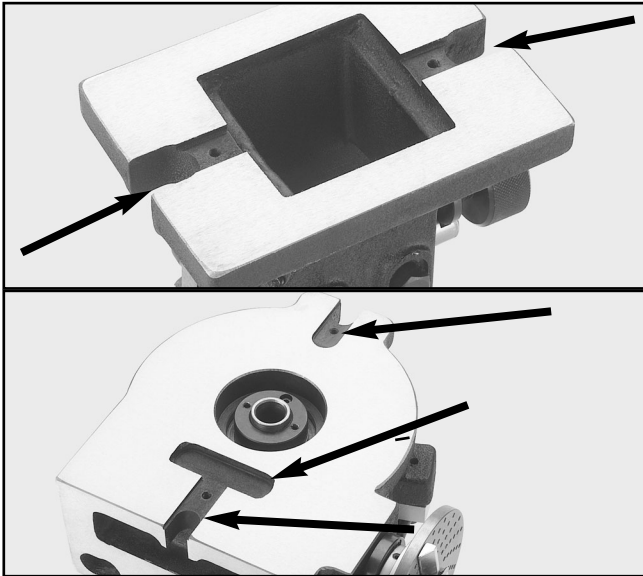

Figure 3. Key placement.

3. Align the dead center of the tailstock vertically by loosening the hex bolts located on the side of the tailstock. With a precision level or indicator (depending on tolerance of work being performed), make the dead center parallel to the horizontal plane and on center with the rotary table centers.

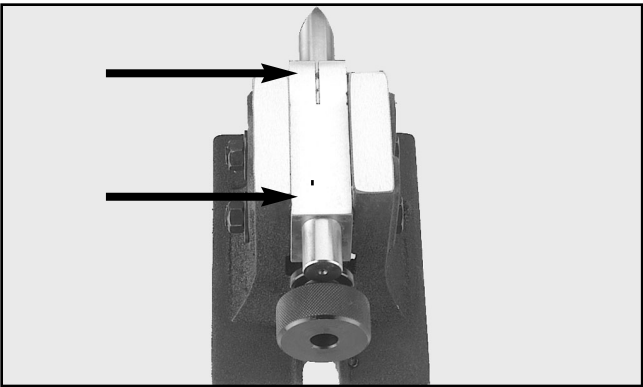

Figure 4. Indicating surface.

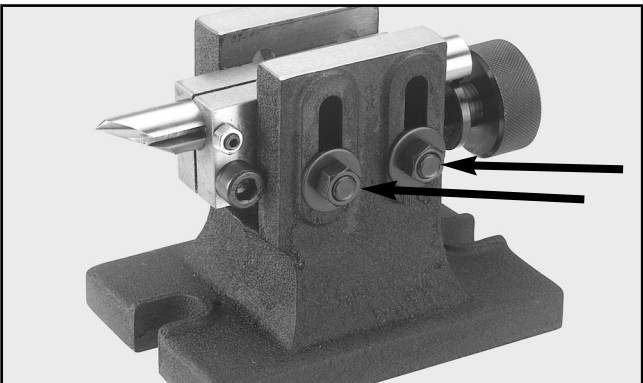
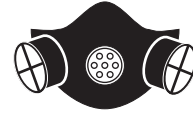

Figure 5. Adjustment hex bolts.

!WARNING

Damage to your eyes, lungs, and ears could result from failure to wear safety glasses, a respirator and hearing protection while using this equipment. Make sure proper filter is worn while wearing respirator.



!WARNING



Loose hair and clothing could get caught in machinery and cause serious personal injury. Keep loose clothing rolled up and long hair tied up and away from moving machinery.

NOTICE

This instruction sheet is designed to give instructions on the basic operations of this equipment. However, it is in no way comprehensive of all of the equipment applications. **WE STRONGLY RECOMMEND** that you read books, trade magazines, or get formal training to maximize the potential of your equipment.



G1763 Tailstock Parts

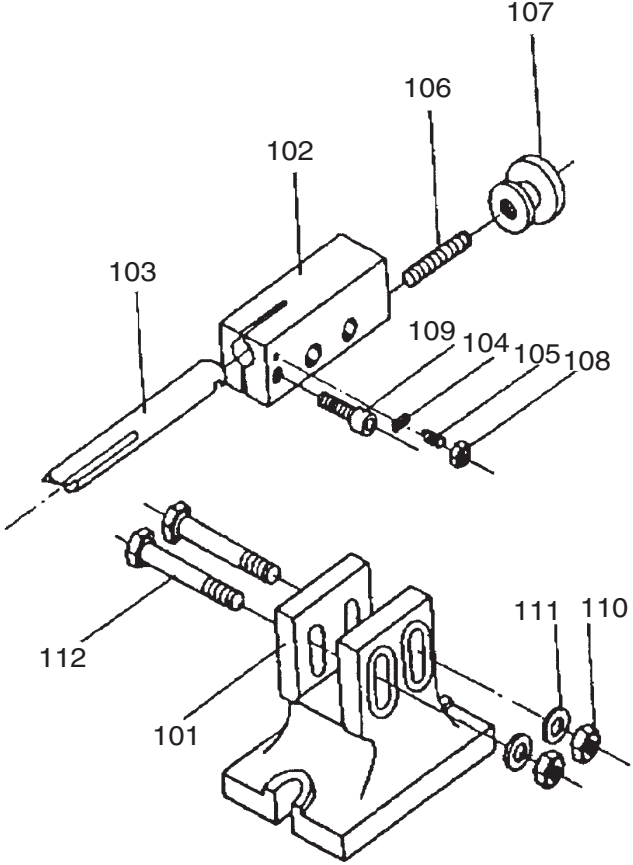

REF	PART #	DESCRIPTION
101	P1763101	TAILSTOCK BASE
102	P1763102	CENTER BASE
103	P1763103	TAIL CENTER
104	PSS05M	SET SCREW M5-8 X 10
105	PSS11M	SET SCREW M6-1. X 16
106	P1763106	SET SCREW M12-1.75 X 45
107	P1763107	ADJUSTMENT NUT
108	PN02M	HEX NUT M10-1.5
109	PSB84M	CAP SCREW M10-1.5 X 35
110	PN02M	HEX NUT M10-1.5
111	PW04M	FLAT WASHER 10MM
112	PSB91M	HEX BOLT M10-1.5 X 75

grizzly.com

TOOL WEBSITE

Buy Direct and Save with Grizzly® – Trusted, Proven and a Great Value!

*Visit Our Website Today And Discover Why
Grizzly® Is The Industry Leader!*

- SECURE ORDERING
- ORDERS SHIPPED WITHIN 24 HOURS
- E-MAIL RESPONSE WITHIN ONE HOUR

-OR-

Call Today For A **FREE**

Full Color Catalog

1-800-523-4777

