

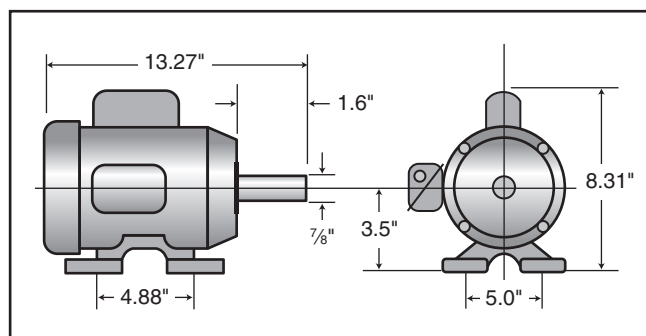

MODEL H5388 3 HP ELECTRIC MOTOR INSTRUCTION SHEET

Specifications

Power 3 HP
 Cycle..... 60Hz
 Voltage 220V
 Amps 13.5A
 RPM..... 3450
 Phase Single
 Class..... B
 Start Capacitor 600MFD 125VAC
 Dimensions..... 1 $\frac{7}{8}$ "D x 3 $\frac{3}{8}$ "L
 Run Capacitor 30MFD 250VAC
 Dimensions..... 1 $\frac{1}{2}$ "D x 2 $\frac{3}{8}$ "L



Making Wire Connections

If you are unsure how to attach wires to terminals, DO NOT continue. Contact an electrician for assistance. Connecting wires improperly may cause them to come loose or contact other wires, which can cause electrocution, fire, or a short.

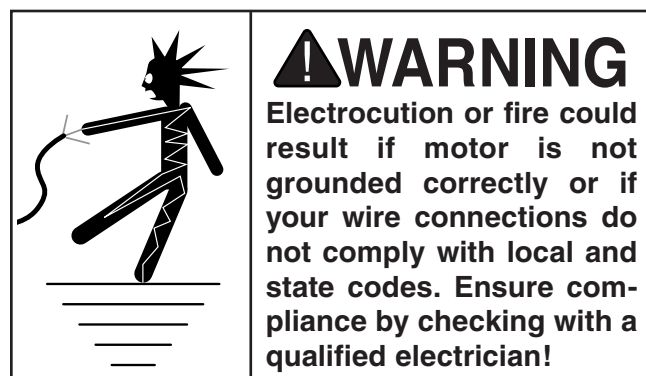
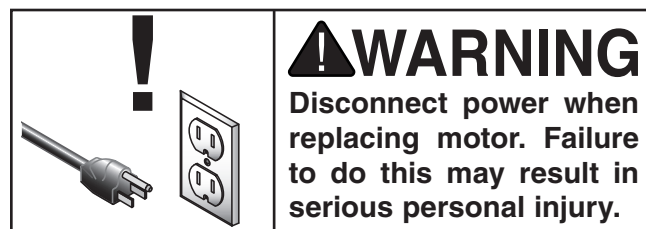

Replaceable Parts

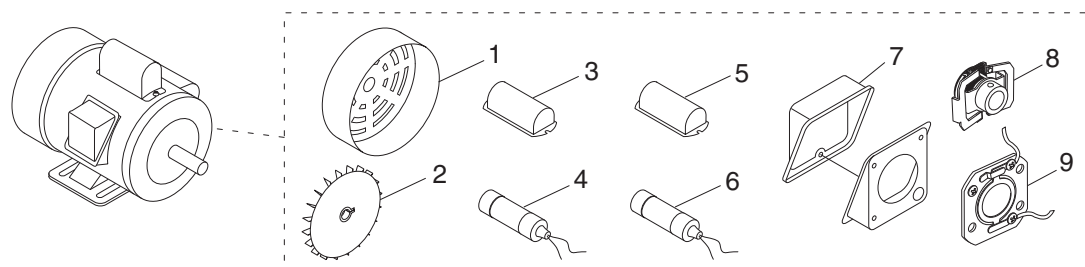

REF	PART #	DESCRIPTION
1	PH5388001	MOTOR FAN COVER
2	PH5388002	MOTOR FAN
3	PH5388003	S CAPACITOR COVER
4	PC600B	S CAPACITOR 600M 125V 1-7/8 X 3-3/8
5	PH5388005	R CAPACITOR COVER

REF	PART #	DESCRIPTION
6	PC030B	R CAPACITOR 30M 250V 1-1/2 X 2-3/8
7	PH5388007	JUNCTION BOX
8	PH5388008	CENTRIFUGAL SWITCH
9	PH5388009	CONTACT PLATE

COPYRIGHT © DECEMBER, 2007 BY GRIZZLY INDUSTRIAL, INC. REVISED JUNE, 2012 (TR)
WARNING: NO PORTION OF THIS INSTRUCTION SHEET MAY BE REPRODUCED IN ANY SHAPE OR FORM WITHOUT THE WRITTEN APPROVAL OF GRIZZLY INDUSTRIAL, INC.

#JB10236 PRINTED IN TAIWAN

H5388 Wiring Diagram

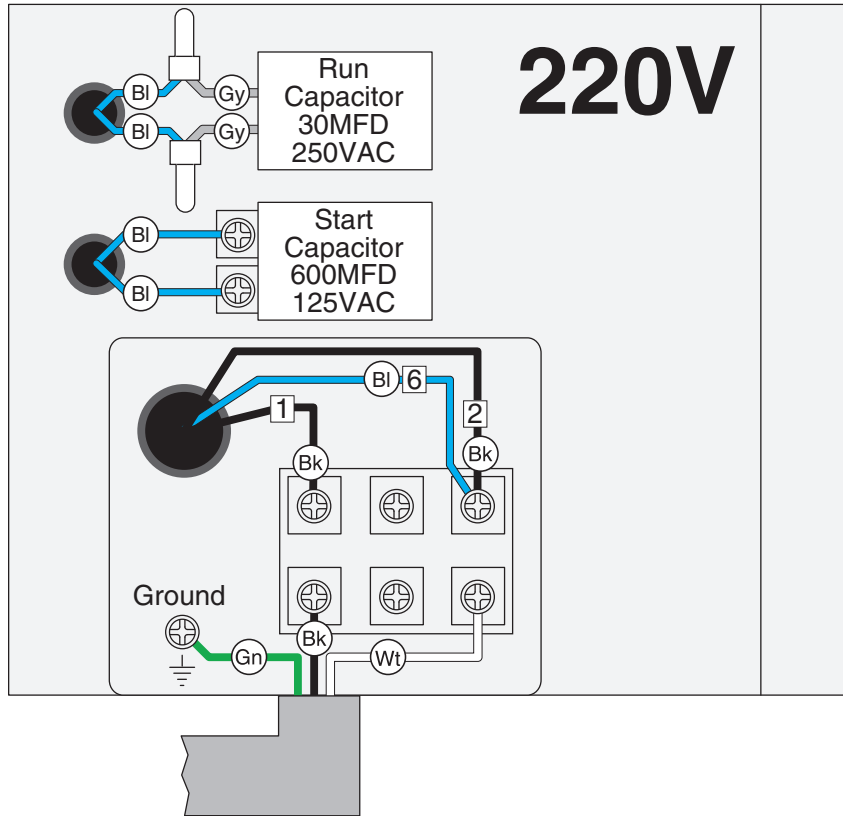

COLOR KEY

BLACK	
WHITE	
GREEN	
BLUE	
GRAY	



**Clockwise
Rotation (PREWIRED)**

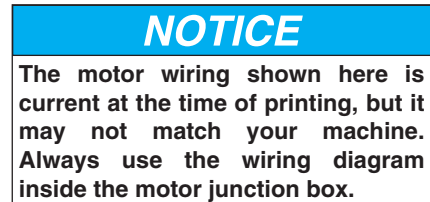
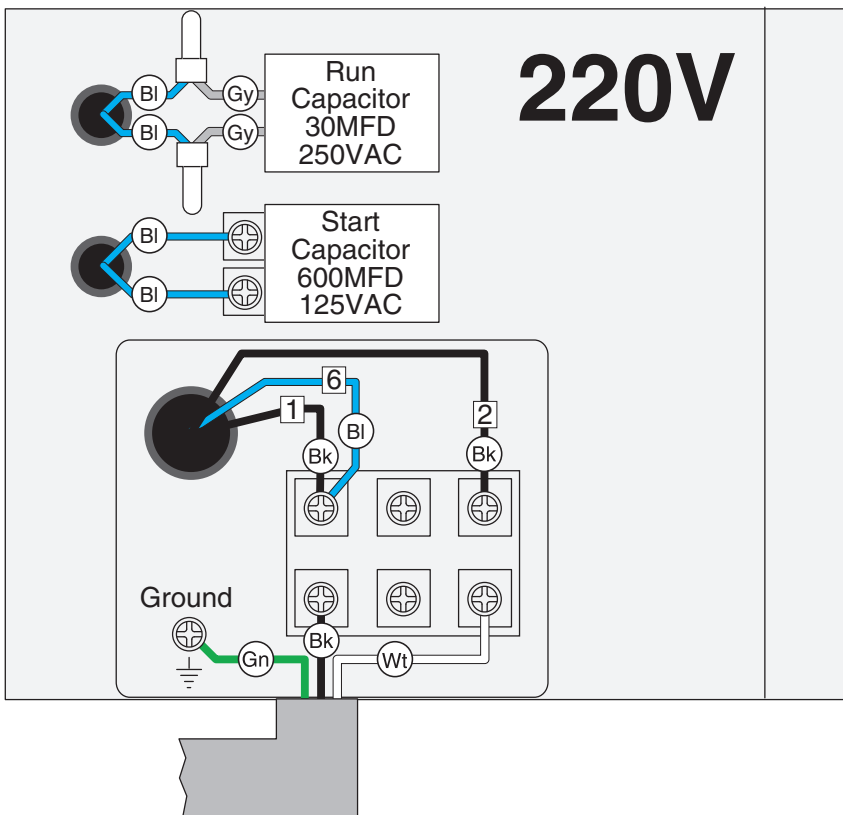

**Counterclockwise
Rotation**

