



MODELS T27429-31 5", 6", 8" PLATE SHEARS INSTRUCTIONS

For questions or help with this product contact Tech Support at (570) 546-9663 or techsupport@grizzly.com

Introduction

These bench-mounted plate shears are designed to cut flat (sheet/plate) stock and round (bar) stock of ferrous and non-ferrous metals, and even plastics. They are simple to use and excel at making quick, clean cuts for rough cutouts. Each model features ground-and-hardened replaceable blades, an extra-long leverage-maximizing handle, and a spring-assisted material hold-down.



Figure 1. Model T27429 plate shear.

Inventory

Description	Qty
Plate Shear Assembly	1
Handle	1
Hex Bolts M10-1.5 x 25 Black C8.8	2
Lock Washers 10mm	2
Flat Washers 10mm	2

Shearing Capacities (Mild Steel)

Model	Max. Shearing Length (Throat)	*Max. Thickness up to 2 ³ / ₄ " Wide	*Max. Thickness @ Full Length	*Max. Round Stock Dia.
T27429	4 ¹ / ₂ "	1/4"	5/32"	3/8"
T27430	4 ⁷ / ₈ "	1/4"	3/16"	3/8"
T27431	7"	1/2"	3/16"	3/8"

* Capacities for high carbon steel and stainless steel are approximately half of those shown here.

Important: *DO NOT attempt to shear hardened steel blocks or rod. You will damage or break the shear blades!*

Assembly & Mounting

1. Attach handle to plate shear assembly with hex bolts, lock washers, and flat washers, as shown in **Figure 2**.

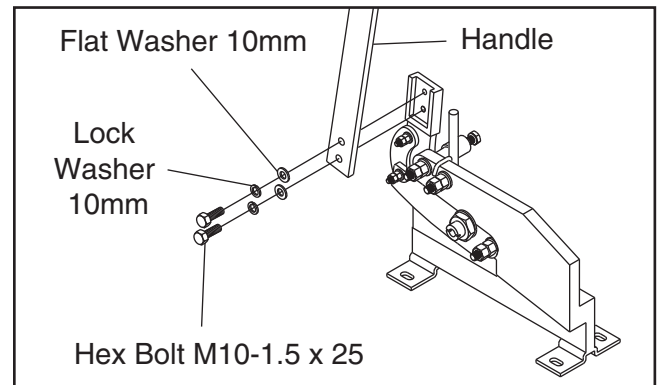

Figure 2. Attaching handle to shear.

2. Place shear on a workbench. Use mounting holes in base as a guide for drilling and attaching shear. This will prevent it from moving during operation and reduce the risk of accidental injury or damage.

COPYRIGHT © DECEMBER, 2015 BY GRIZZLY INDUSTRIAL, INC.

WARNING: NO PORTION OF THIS MANUAL MAY BE REPRODUCED IN ANY SHAPE OR FORM WITHOUT THE WRITTEN APPROVAL OF GRIZZLY INDUSTRIAL, INC.

(FOR MODELS MFD. SINCE 10/15) #BL17880 PRINTED IN CHINA

V11.12.15

The strongest mounting option is a "Through Mount" (see example below) where holes are drilled all the way through the workbench—and hex bolts, washers, and hex nuts are used to secure the shear in place.

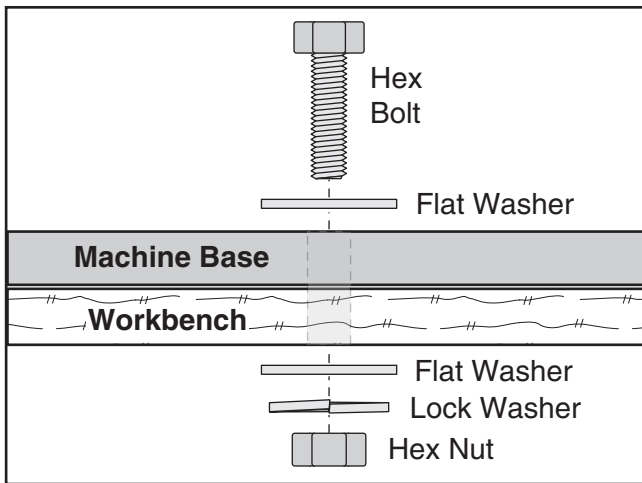

Figure 3. "Through Mount" setup.

Another option is a "Direct Mount" (see example below) where the shear is secured directly to the workbench with lag screws and washers.

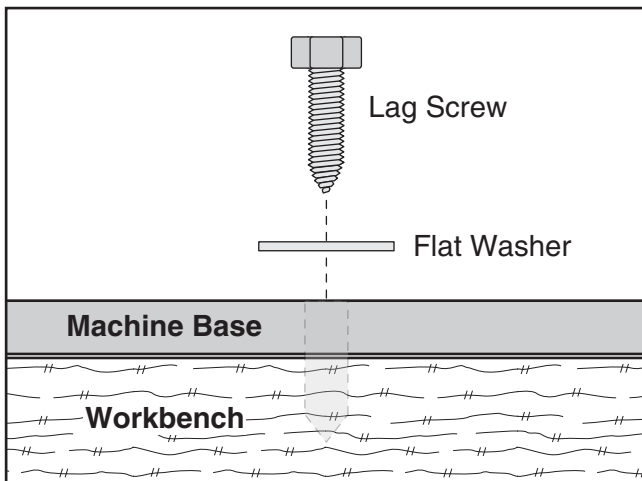

Figure 4. "Direct Mount" setup.

⚠️ WARNING AMPUTATION HAZARD!

To reduce risk of serious personal injury:

- Keep fingers, hands, and all body parts away from blades and cutting area during use.
- Prevent unauthorized use by children or untrained users. Keep children and bystanders at safe distance while shearing.

Basic Operation

1. Raise hold-down using hex bolt shown in **Figure 5** to allow room for workpiece.

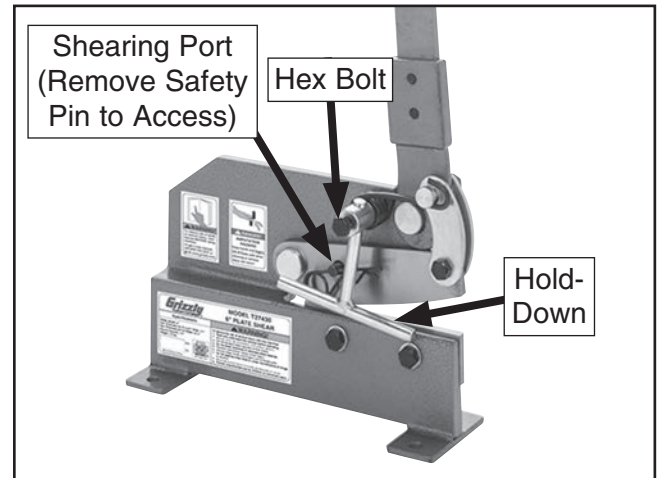

Figure 5. Plate shear hold-down.

2. Place workpiece between blades or through shearing port.

— If shearing flat workpiece, position and secure hold-down so it firmly presses workpiece against lower blade.

3. Using slow and even pressure, pull handle down to cut workpiece.

Note: *If material seems too thick or too hard, do not force shear! Instead, use metal-cutting bandsaw or other tool to cut workpiece.*

Maintenance

- Always keep blades lubricated with light oil.
- Keep pivot points tight.
- Check all shear hardware before every use for loose or worn components.



T27429 & T27430 Breakdown

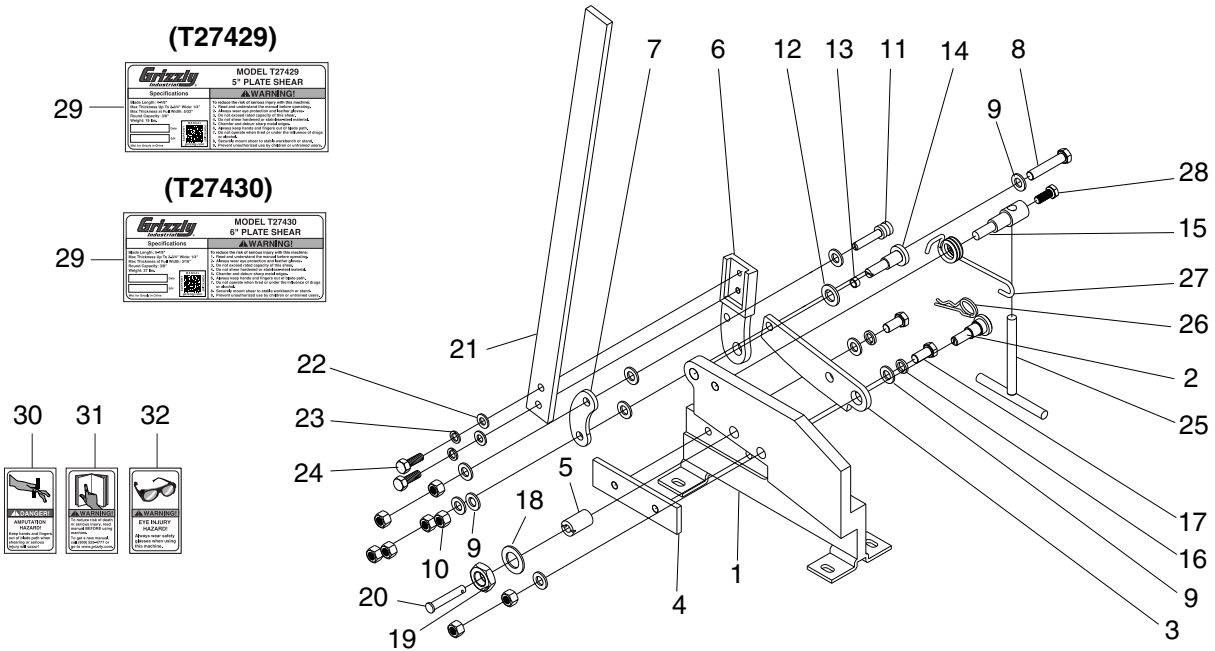

T27429 Parts List

REF	PART #	DESCRIPTION
1	PT27429001	SHEAR BODY
2	PT27429002	PIVOT BOLT M12-1.75 X 30
3	PT27429003	UPPER BLADE 5"
4	PT27429004	LOWER BLADE 5"
5	PT27429005	SHEARING PORT SCREW M22-1.5 X 30
6	PT27429006	HANDLE BRACKET
7	PT27429007	REAR PIVOT ARM
8	PT27429008	HEX BOLT M12-1.75 X 60 BLK C8.8
9	PT27429009	FLAT WASHER 12MM
10	PT27429010	HEX NUT M12-1.75
11	PT27429011	PIVOT BOLT W/SPRING CAPTURE M10-1.5 X 25
12	PT27429012	FLAT WASHER 16MM
13	PT27429013	BUSHING, COPPER
14	PT27429014	PIVOT BOLT M12-1.75 X 35
15	PT27429015	SPRING SUPPORT ROD
16	PT27429016	LOCK WASHER 12MM
17	PT27429017	HEX BOLT M12-1.75 X 25 BLK C8.8
18	PT27429018	FLAT WASHER 22MM
19	PT27429019	HEX NUT M22-1.5
20	PT27429020	CLEVIS PIN 10 X 60MM
21	PT27429021	HANDLE
22	PT27429022	FLAT WASHER 10MM
23	PT27429023	LOCK WASHER 10MM
24	PT27429024	HEX BOLT M10-1.5 X 25 BLK C8.8
25	PT27429025	WORK STOP
26	PT27429026	COTTER PIN 3 X 90, HAIRPIN
27	PT27429027	TORSION SPRING
28	PT27429028	HEX BOLT M10-1.5 X 20 BLK C8.8
29	PT27429029	MACHINE ID LABEL
30	PT27429030	AMPUTATION HAZARD LABEL
31	PT27429031	READ MANUAL LABEL
32	PT27429032	SAFETY GLASSES LABEL

T27430 Parts List

REF	PART #	DESCRIPTION
1	PT27430001	SHEAR BODY
2	PT27430002	PIVOT BOLT M12-1.75 X 30
3	PT27430003	UPPER BLADE 4-7/8"
4	PT27430004	LOWER BLADE 4-7/8"
5	PT27430005	SHEARING PORT SCREW M22-1.5 X 30
6	PT27430006	HANDLE BRACKET
7	PT27430007	REAR PIVOT ARM
8	PT27430008	HEX BOLT M12-1.75 X 60 BLK C8.8
9	PT27430009	FLAT WASHER 12MM
10	PT27430010	HEX NUT M12-1.75
11	PT27430011	PIVOT BOLT W/SPRING CAPTURE M10-1.5 X 25
12	PT27430012	FLAT WASHER 16MM
13	PT27430013	BUSHING, COPPER
14	PT27430014	PIVOT BOLT M12-1.75 X 35
15	PT27430015	SPRING SUPPORT ROD
16	PT27430016	LOCK WASHER 12MM
17	PT27430017	HEX BOLT M12-1.75 X 25 BLK C8.8
18	PT27430018	FLAT WASHER 22MM
19	PT27430019	HEX NUT M22-1.5
20	PT27430020	CLEVIS PIN 10 X 60MM
21	PT27430021	HANDLE
22	PT27430022	FLAT WASHER 10MM
23	PT27430023	LOCK WASHER 10MM
24	PT27430024	HEX BOLT M10-1.5 X 25 BLK C8.8
25	PT27430025	WORK STOP
26	PT27430026	COTTER PIN 3 X 90, HAIRPIN
27	PT27430027	TORSION SPRING
28	PT27430028	HEX BOLT M10-1.5 X 20 BLK C8.8
29	PT27430029	MACHINE ID LABEL
30	PT27430030	AMPUTATION HAZARD LABEL
31	PT27430031	READ MANUAL LABEL
32	PT27430032	SAFETY GLASSES LABEL

Please Note: We do our best to stock replacement parts whenever possible, but we cannot guarantee that all parts shown here are available for purchase. Call (800) 523-4777 or visit our online parts store at www.grizzly.com to check for availability.



T27431 Breakdown

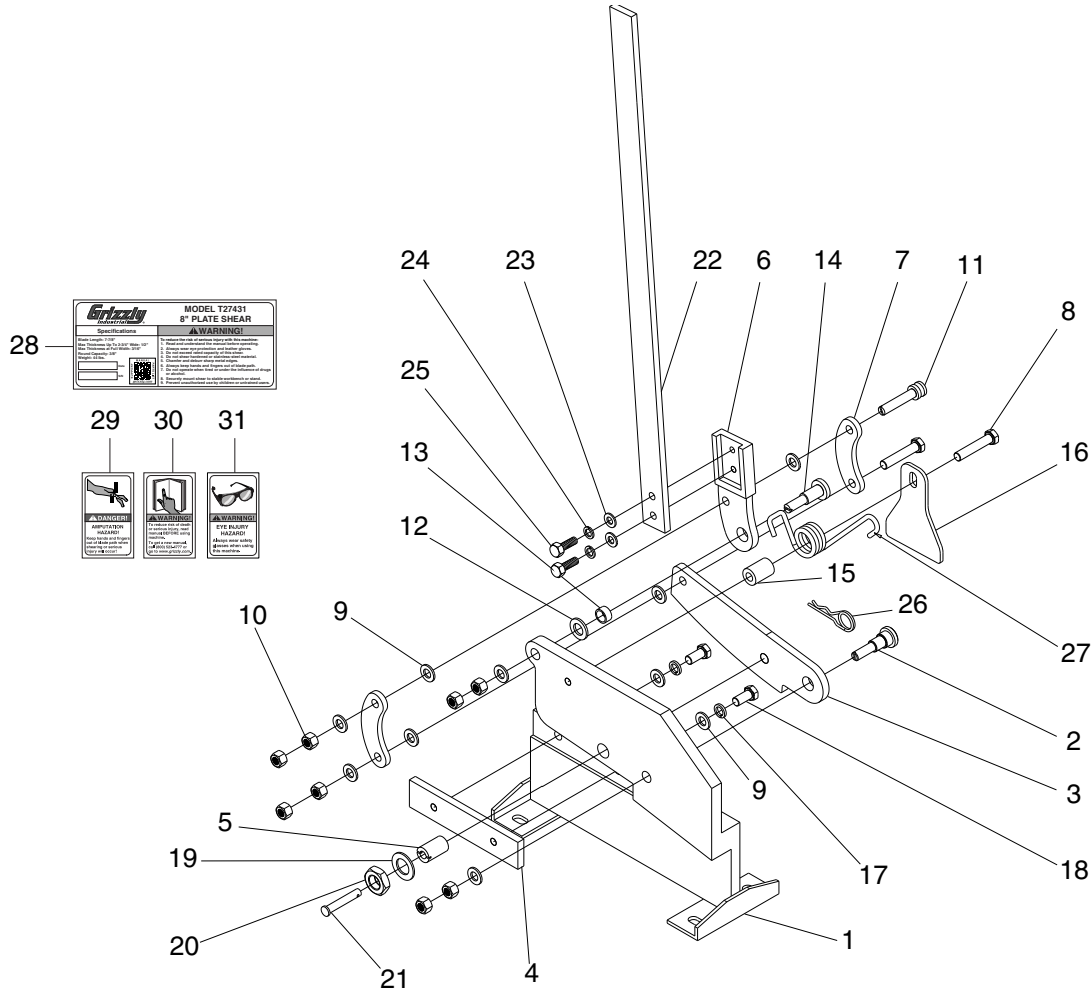

T27431 Parts List

REF	PART #	DESCRIPTION
1	PT27431001	SHEAR BODY
2	PT27431002	PIVOT BOLT M12-1.75 X 30
3	PT27431003	UPPER BLADE 7-7/8"
4	PT27431004	LOWER BLADE 7-7/8"
5	PT27431005	SHEARING PORT SCREW M22-1.5 X 30
6	PT27431006	HANDLE BRACKET
7	PT27431007	REAR PIVOT ARM
8	PT27431008	HEX BOLT M12-1.75 X 60 BLK C8.8
9	PT27431009	FLAT WASHER 12MM
10	PT27431010	HEX NUT M12-1.75
11	PT27431011	PIVOT BOLT W/SPRING CAPTURE M10-1.5 X 25
12	PT27431012	FLAT WASHER 16MM
13	PT27431013	BUSHING, COPPER
14	PT27431014	PIVOT BOLT M12-1.75 X 35
15	PT27431015	BUSHING
16	PT27431016	WORK STOP

REF	PART #	DESCRIPTION
17	PT27431017	LOCK WASHER 12MM
18	PT27431018	HEX BOLT M12-1.75 X 25
19	PT27431019	FLAT WASHER 22MM
20	PT27431020	HEX NUT M22-1.5
21	PT27431021	CLEVIS PIN 10 X 60MM
22	PT27431022	HANDLE
23	PT27431023	FLAT WASHER 10MM
24	PT27431024	LOCK WASHER 10MM
25	PT27431025	HEX BOLT M10-1.5 X 25 BLK C8.8
26	PT27431026	COTTER PIN 3 X 90, HAIRPIN
27	PT27431027	TORSION SPRING
28	PT27431028	MACHINE ID LABEL
29	PT27431029	AMPUTATION HAZARD LABEL
30	PT27431030	READ MANUAL LABEL
31	PT27431031	SAFETY GLASSES LABEL

WARNING

Safety labels help reduce the risk of serious injury caused by machine hazards. If any label comes off or becomes unreadable, the owner of this machine **MUST** replace it in the original location before resuming operations. For replacements, contact (800) 523-4777 or www.grizzly.com.

