



For questions or help with this product contact Tech Support at (570) 546-9663 or techsupport@grizzly.com

MODEL T28173/T28174 ROLLER TABLES INSTRUCTIONS

FOR MODELS MFD. SINCE 10/17

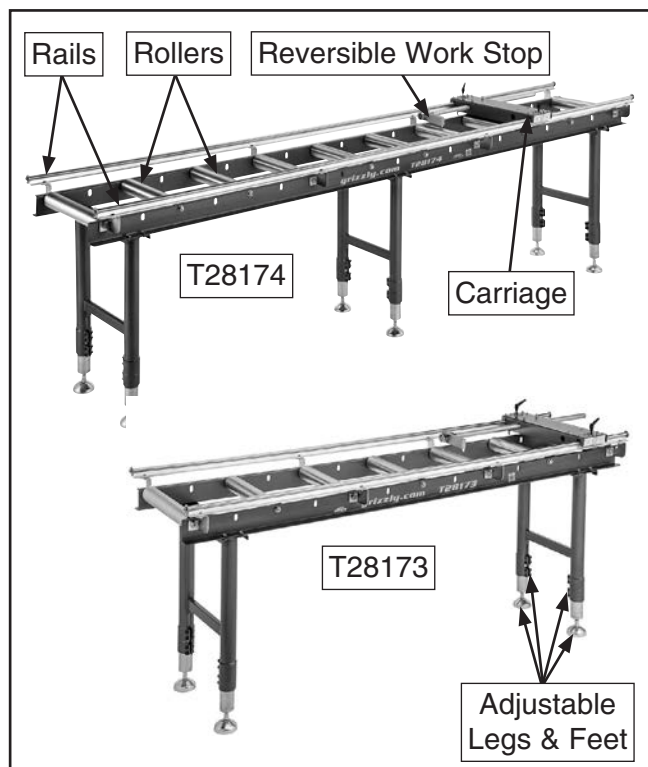

Figure 1. T28173/T28174 Roller Table features.

Introduction

The Model T28173/T28174 Roller Table (see **Figure 1**) allow users to feed long material into a workbench, saw, or other device across steel support rollers using a rail-mounted work-stop system for repeatable cuts.

Support rollers are installed on 12⁵/₈" centers. Adjustable legs and steel feet allow a working height of 28" to 48".

The T28378 Slotted Mounting Plate (not included) allows connection of the roller table to a machine or workbench.

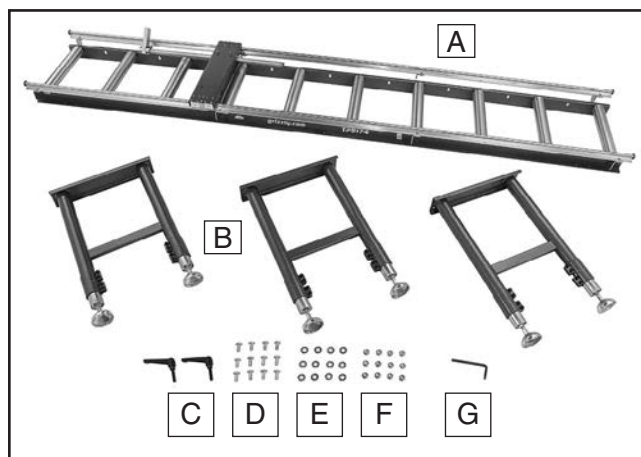

Figure 2. T28173/T28174 inventory.

T28173 & T28174 Inventory

Description (Figure 2)	Qty
A. Roller Table Assembly 78" (T28173)	1
Roller Table Assembly 118" (T28174)	1
B. Adjustable Leg Assemblies (T28173)	2
Adjustable Leg Assemblies (T28174)	3
C. Adjustable Handles 62L, M8-1.25 x 32	2
D. Hex Nuts M8-1.25 (T28173)	8
Hex Nuts M8-1.25 (T28174)	12
E. Flat Washers 8mm (T28173)	8
Flat Washers 8mm (T28174)	12
F. Hex Bolts M8-1.25 x 16 (T28173)	8
Hex Bolts M8-1.25 x 16 (T28174)	12
G. Hex Wrench 6mm	1

Specifications

Model	Length	Weight	Capacity	Rollers
T28173	78"	128 lbs.	1540 lbs.	7
T28174	118"	154 lbs.	1540 lbs.	10

COPYRIGHT © JANUARY, 2018 BY GRIZZLY INDUSTRIAL, INC.
NO PORTION OF THIS MANUAL MAY BE REPRODUCED IN ANY SHAPE
OR FORM WITHOUT THE WRITTEN APPROVAL OF GRIZZLY INDUSTRIAL, INC.

#KB19284 PRINTED IN CHINA

V1.01.18

Assembly

Items Needed

	Qty
Open-End Wrenches or Sockets 14mm.....	2
Hex Wrench 6mm.....	1
4 x 4 Blocks.....	2
Additional People	2

To assemble roller table:

1. Place 4 x 4 blocks on floor positioned near ends of roller table assembly, as shown in **Figure 3**. The blocks will be used to keep weight of table assembly off carriage.

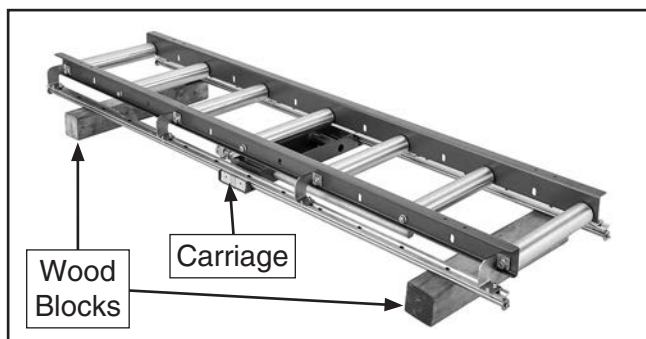

Figure 3. Use wood blocks to keep weight off carriage during leg installation (T28173 shown).

2. With help from another person, turn roller table assembly upside down, then place rails on top of 4x4 blocks (see **Figure 3**).
3. Attach each leg assembly (2 for T28173, 3 for T28174) to table assembly with (4) M8-1.25 x 16 hex bolts, (4) M8-1.25 hex nuts, and (4) 8mm flat washers per leg (see **Figure 4**). Finger-tighten for now.

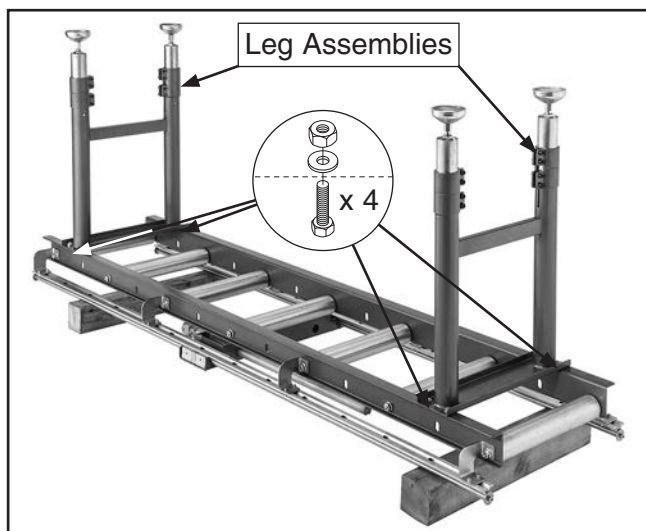

Figure 4. Attaching leg assemblies.

4. Turn assembled roller table upright onto feet (see **Figure 5**).



Figure 5. Leg assemblies attached to roller table assembly (T28173 shown).

5. Final tighten hex nuts with wrench or socket.
6. Install adjustable handles on carriage, as shown in **Figure 6**.

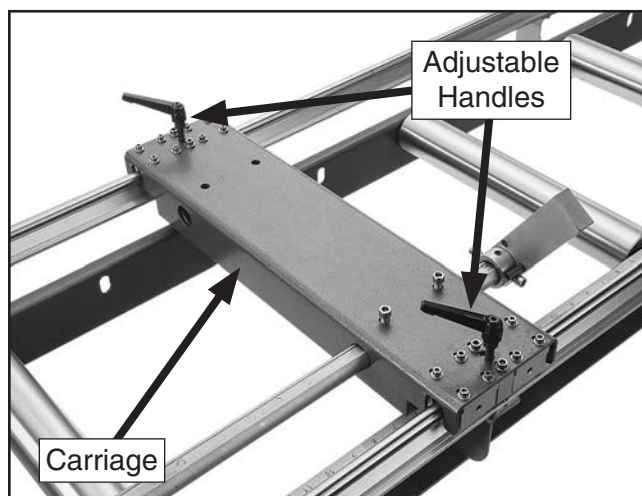

Figure 6. Adjustable handles installed on carriage.



Adjusting Roller Table Height & Level

Roller table height can be adjusted from 28" to 48" by loosening (8) cap screws on each leg assembly to move the inner legs.

The feet can be adjusted to level the unit.

Items Needed	Qty
Hex Wrench 6mm.....	1
Open-End Wrench 16mm.....	1
Open-End Wrench 24mm.....	1
Level	1
Additional People	2

To adjust roller table height and level:

1. While assistants hold each end of roller table, loosen (2) M16-1.5 hex nuts on bottom of legs, then loosen (8) cap screws on each leg assembly just until inner legs move freely (see **Figure 7**).

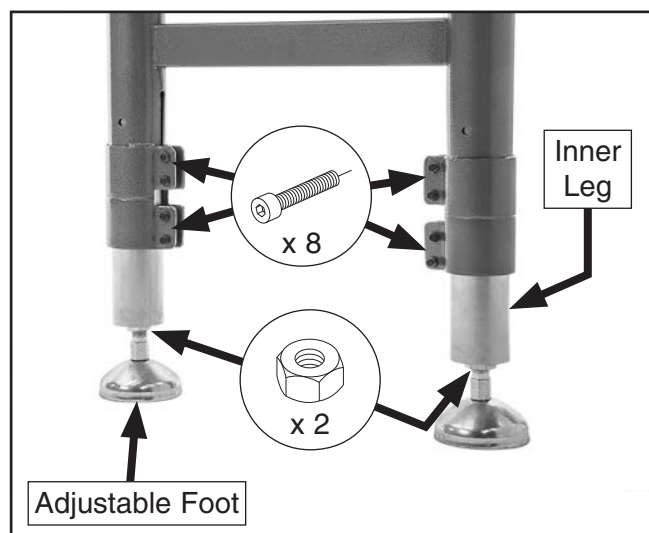

Figure 7. Loosen cap screws to adjust leg assembly height. Loosen hex nuts to adjust feet.

2. Adjust unit until it sits evenly on all legs. Set roller table to desired height, then tighten cap screws on each leg assembly.
3. Check and adjust level side to side and front to back by adjusting feet as needed, then tighten hex nuts on foot assemblies.

Carriage & Slide Bar

The slide bar/work stop is reversible and can be positioned on either side of the carriage. Position work stop in the "down" position to use it as a push block, or place the work stop in the "up" position to use the carriage as a primary stop.

To adjust slide bar and use work stop:

1. Lock carriage with adjustable handles, then loosen (2) cap screws securing slide bar/work stop to adjust slide bar/work stop position inside carriage mounting holes (see **Figure 8**).

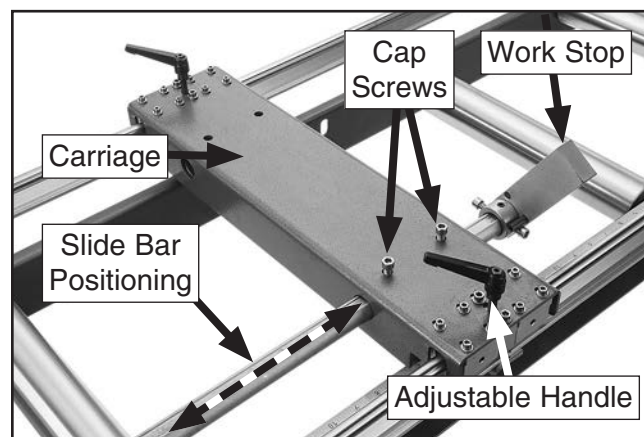

Figure 8. Carriage, work stop, and slide bar.

2. Position work stop in "down" position to use it as a push block, or place stop in "up" position to use carriage as primary stop.
3. Slide bar/work stop can be mounted in either direction in either carriage mounting hole. To remove slide bar/work stop, remove (2) cap screws in carriage, as shown in **Figure 9**.

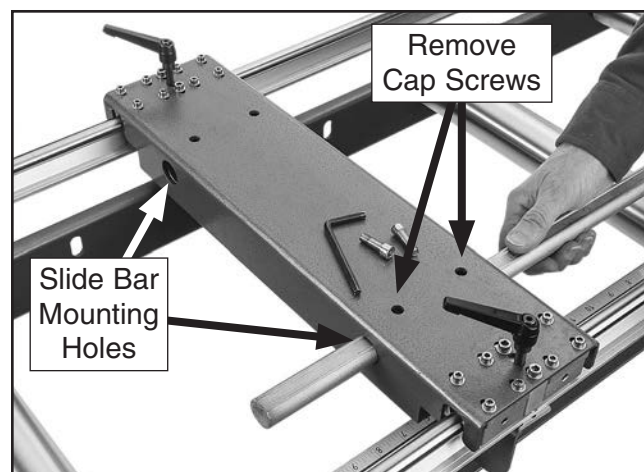

Figure 9. Repositioning or removing slide bar.



- Place slide bar in other mounting hole and secure with cap screws removed in **Step 3** (see **Figure 10**).

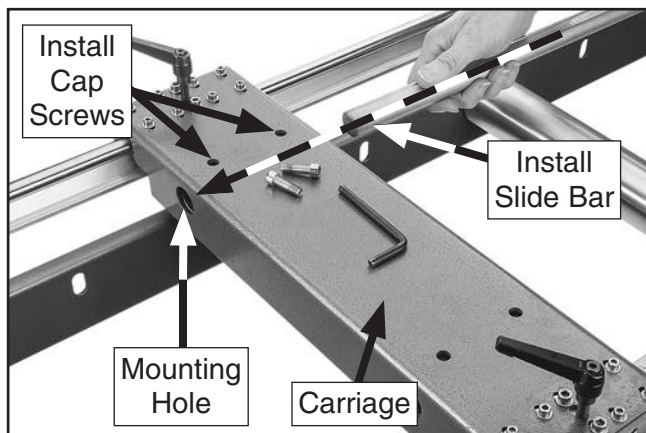

Figure 10. Installing slide bar in carriage.

T28378 Slotted Mounting Plate

Use optional T28378 Slotted Mounting Plate to connect the T28173 or T28174 to a workbench or machine.

Items Needed	Qty
Another Person.....	1
T28378 Slotted Mounting Plate	1
Pencil or Permanent Marker.....	1
Drill with $\frac{3}{8}$ " Bit.....	1

To install and use T28378 slotted mounting plate:

- While an assistant holds end of roller table, remove (4) M8-1.25 x 16 hex bolts, (4) M8-1.25 flange nuts, and (4) 8mm flat washers securing leg assembly to roller table assembly (see **Figure 11**).

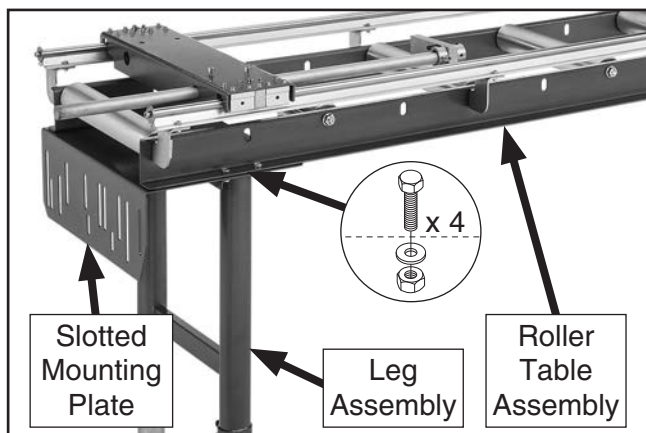

Figure 11. Installing T28378 slotted mounting plate.

- Insert T28378 slotted mounting plate between leg assembly and roller table assembly, and re-install (4) M8-1.25 x 16 hex bolts, (4) M8-1.25 flange nuts, and (4) 8mm flat washers removed in **Step 1**.
- Align roller table fitted with T28378 against suitable workbench or machine. Adjust roller table height if necessary, then use slots to secure to machine (see **Figure 12**).

Note: If machine does not have existing mounting holes, you will need to drill them yourself.

⚠ CAUTION

To avoid machine damage and possible electrocution/shock hazard, inspect workbench or machine to avoid drilling into wiring or important internal components.

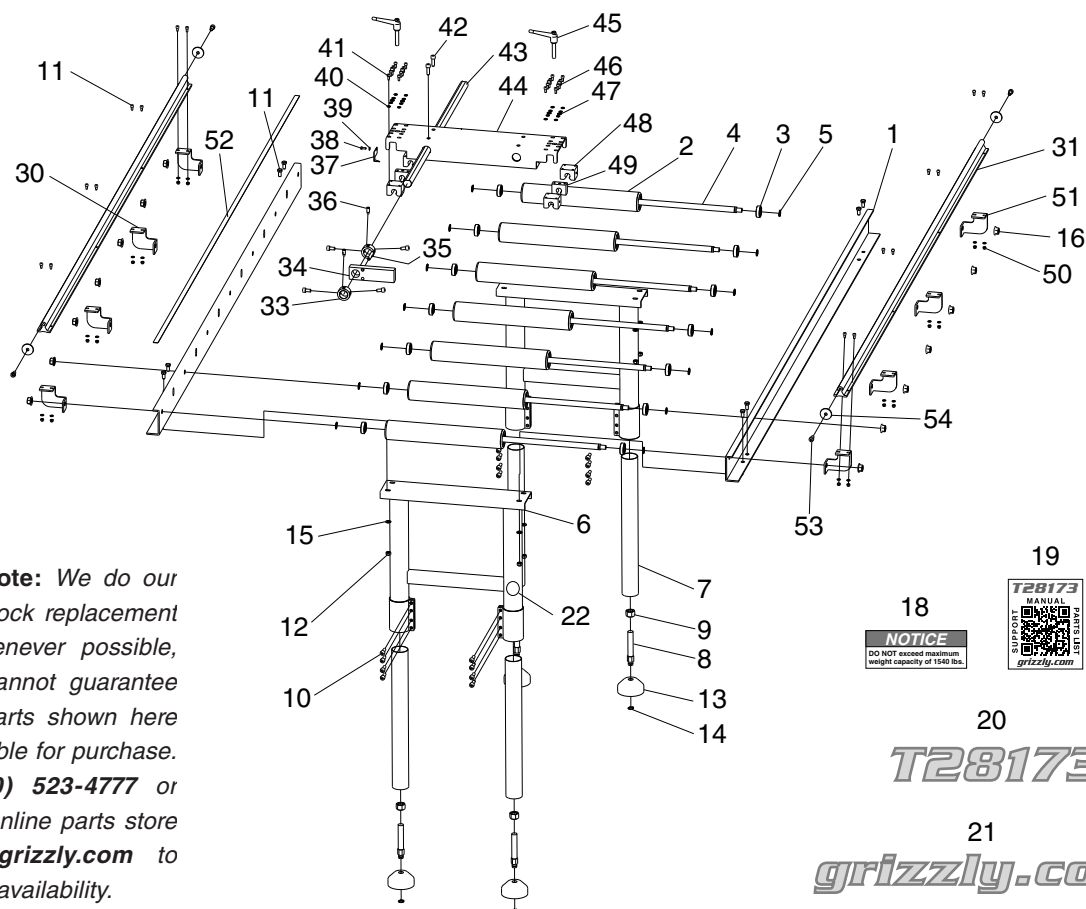

Figure 12. Slots for mounting T28378 to workbench or machine.

- Secure roller table with T28378 slotted mounting plate to workbench or machine using appropriate length $\frac{5}{16}$ " or 8mm hex bolts, hex nuts and washers as needed.



T28173 Parts



Please Note: We do our best to stock replacement parts whenever possible, but we cannot guarantee that all parts shown here are available for purchase. Call (800) 523-4777 or visit our online parts store at www.grizzly.com to check for availability.

REF PART # DESCRIPTION

1	PT28173001	SIDE PLATE 78"
2	PT28173002	ROLLER 14-1/4" X 2-3/8"
3	PT28173003	BALL BEARING 6003ZZ
4	PT28173004	CENTER SHAFT
5	PT28173005	EXT RETAINING RING 17MM
6	PT28173006	SUPPORT FRAME
7	PT28173007	EXTENSION LEG
8	PT28173008	ADJUSTABLE SCREW M16-1.5 X 50
9	PT28173009	HEX NUT M16-1.5
10	PT28173010	CAP SCREW M8-1.25 X 25
11	PT28173011	CAP SCREW M8-1.25 X 16
12	PT28173012	HEX NUT M8-1.25
13	PT28173013	STEEL FOOT 80D M16-1.5
14	PT28173014	EXT RETAINING RING 12MM
15	PT28173015	FLAT WASHER 8MM
16	PT28173016	HEX NUT M12-1.75
18	PT28173018	NOTICE LABEL
19	PT28173019	QR CODE LABEL
20	PT28173020	MODEL NUMBER LABEL
21	PT28173021	GRIZZLY.COM LABEL
22	PT28173022	TOUCH-UP PAINT, GRIZZLY GREEN
30	PT28173030	BRACKET (LEFT)
31	PT28173031	SLIDE GUIDE

REF PART # DESCRIPTION

33	PT28173033	ROTATION LIMITING BLOCK
34	PT28173034	WORK STOP
35	PT28173035	ROLL PIN 8 X 50
36	PT28173036	SET SCREW M8-1.25 X 12
37	PT28173037	INDICATOR
38	PT28173038	CAP SCREW M4-.7 X 12
39	PT28173039	FLAT WASHER 4MM
40	PT28173040	FLAT WASHER 5MM
41	PT28173041	CAP SCREW M5-.8 X 12
42	PT28173042	CAP SCREW M8-1.25 X 25
43	PT28173043	SLIDE BAR
44	PT28173044	CARRIAGE
45	PT28173045	ADJUSTABLE HANDLE 63L, M8-1.25 X 32
46	PT28173046	CAP SCREW M6-1 X 16
47	PT28173047	FLAT WASHER 6MM
48	PT28173048	SLIDING BLOCK
49	PT28173049	LIMITING BLOCK
50	PT28173050	HEX NUT M5-.8
51	PT28173051	BRACKET (RIGHT)
52	PT28173052	SCALE 78"
53	PT28173053	CAP SCREW M8-1.25 X 16
54	PT28173054	FENDER WASHER 8MM



T28174 Parts

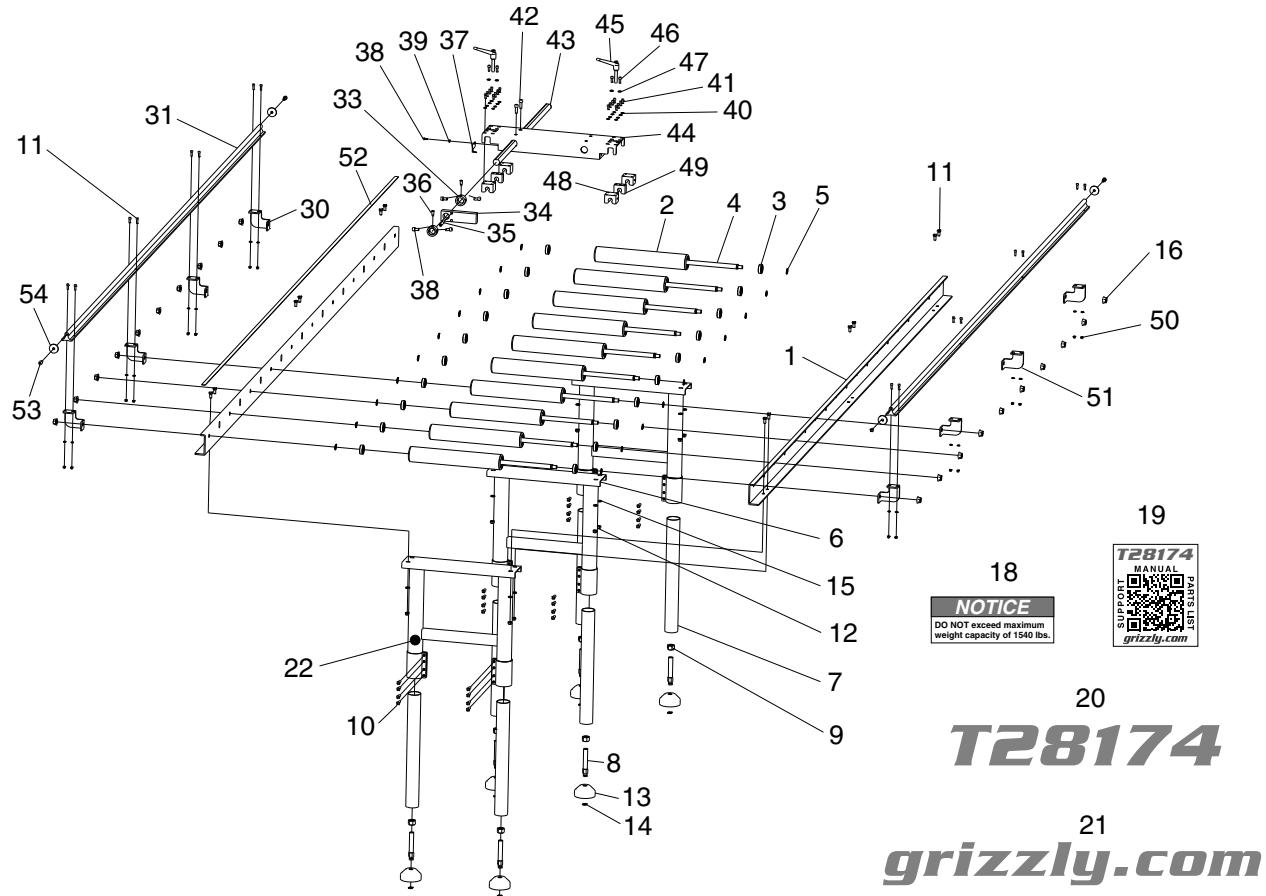

REF PART #	DESCRIPTION
1	PT28174001 SIDE PLATE 118"
2	PT28174002 ROLLER 14-1/4" X 2-3/8"
3	PT28174003 BALL BEARING 6003ZZ
4	PT28174004 CENTER SHAFT
5	PT28174005 EXT RETAINING RING 17MM
6	PT28174006 SUPPORT FRAME
7	PT28174007 EXTENSION LEG
8	PT28174008 ADJUSTABLE SCREW M16-1.5 X 50
9	PT28174009 HEX NUT M16-1.5
10	PT28174010 CAP SCREW M8-1.25 X 25
11	PT28174011 HEX BOLT M8-1.25 X 16
12	PT28174012 HEX NUT M8-1.25
13	PT28174013 FOOT 80D M16-1.5
14	PT28174014 EXT RETAINING RING 12MM
15	PT28174015 FLAT WASHER 8MM
16	PT28174016 FLANGE HEX NUT M12-1.75
18	PT28174018 NOTICE LABEL
19	PT28174019 QR CODE LABEL
20	PT28174020 MODEL NUMBER LABEL
21	PT28174021 GRIZZLY.COM LABEL
22	PT28174022 TOUCH-UP PAINT, GRIZZLY GREEN
30	PT28174030 BRACKET (LEFT)
31	PT28174031 SLIDE GUIDE

REF PART #	DESCRIPTION
33	PT28174033 ROTATION LIMITING BLOCK
34	PT28174034 WORK STOP
35	PT28174035 ROLL PIN 8 X 50
36	PT28174036 SET SCREW M8-1.25 X 12
37	PT28174037 INDICATOR
38	PT28174038 CAP SCREW M4-.7 X 12
39	PT28174039 FLAT WASHER 4MM
40	PT28174040 FLAT WASHER 5MM
41	PT28174041 CAP SCREW M5-.8 X 12
42	PT28174042 CAP SCREW M8-1.25 X 25
43	PT28174043 SLIDE BAR
44	PT28174044 CARRIAGE
45	PT28174045 ADJUSTABLE HANDLE 63L, M8-1.25 X 32
46	PT28174046 CAP SCREW M6-1 X 16
47	PT28174047 FLAT WASHER 6MM
48	PT28174048 SLIDING BLOCK
49	PT28174049 LIMITING BLOCK
50	PT28174050 HEX NUT M5-.8
51	PT28174051 BRACKET (RIGHT)
52	PT28174052 SCALE 118" LONG
53	PT28174053 CAP SCREW M8-1.25 X 16
54	PT28174054 FENDER WASHER 8MM





Buy Direct and Save with Grizzly® – Trusted, Proven and a Great Value!
~Since 1983~

*Visit Our Website Today For
Current Specials!*

**ORDER
24 HOURS A DAY!
1-800-523-4777**

