



For questions or help with this product contact Tech Support at (570) 546-9663 or techsupport@grizzly.com

# MODEL T28372 BED & TOOL POST EXTENSIONS FOR G0838 INSTRUCTIONS

## Introduction

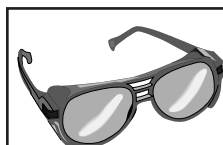
The Model T28372 Bed & Tool Post Extensions are designed to fit on the Model G0838 lathe.

The 22 $\frac{7}{8}$ " bed extension can be mounted to the end of the lathe bed to expand total work area, or it can be offset from the lathe bed to provide a 28" swing over the bed extension for outboard turning operations.

The tool post extension can be mounted to the tool rest base that came with your lathe. It should always be used when the bed extension is mounted for outboard turning operations to ensure the tool rest can be properly positioned.



**Figure 1.** T28372 Bed & Tool Post Extensions.

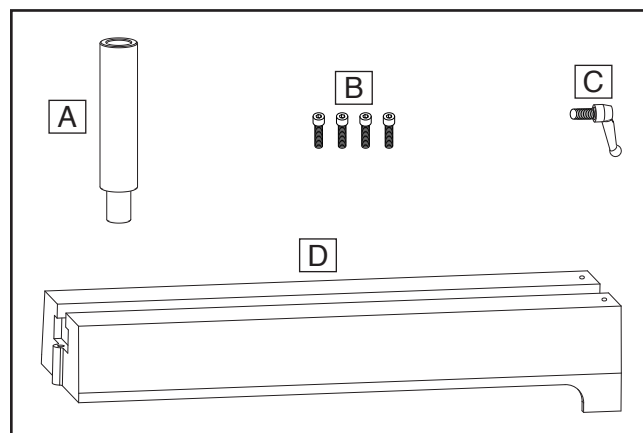


## **!WARNING**

**Wear safety glasses during the entire setup process!**

## Inventory

Description (Figure 2)	Qty
A. Tool Post Extension.....	1
B. Cap Screws M10-1.5 x 30 .....	4
C. Locking Handle M10-1.5 x 18.....	1
D. Bed Extension .....	1



**Figure 2.** Inventory.

COPYRIGHT © APRIL, 2024 BY GRIZZLY INDUSTRIAL, INC.  
NO PORTION OF THIS MANUAL MAY BE REPRODUCED IN ANY SHAPE  
OR FORM WITHOUT THE WRITTEN APPROVAL OF GRIZZLY INDUSTRIAL, INC.  
(FOR MODELS MFD. SINCE 10/23) #JA23145 PRINTED IN CHINA

V1.04.24

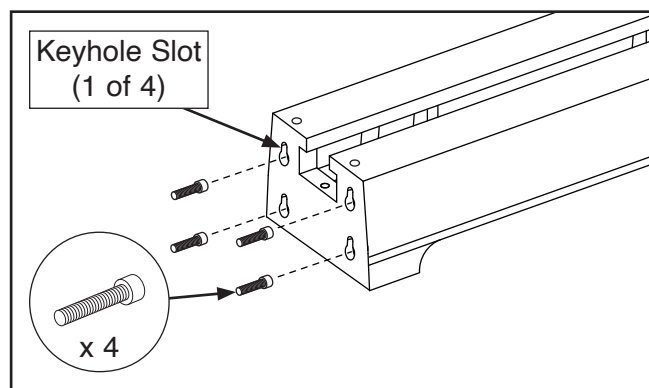
**\*\*\*Keep for Future Reference\*\*\***

## Mounting Extension to Lathe Bed

Items Needed	Qty
Hex Wrenches 3, 8mm.....	1 Ea.
48" Straightedge.....	1
Masking Tape .....	As Needed

### To mount extension to lathe bed:

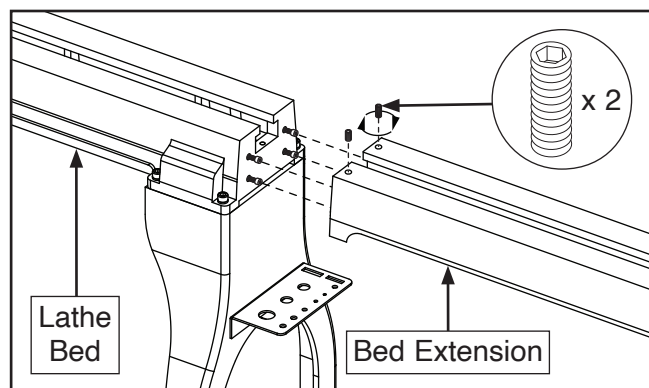
1. Thread (4) M10-1.5 x 30 cap screws approximately halfway into tailstock end of lathe bed.
2. Align cap screws with bottom of keyhole slots (see **Figure 3**), then slide bed extension onto cap screws.



**Figure 3.** Attaching bed extension to lathe bed.

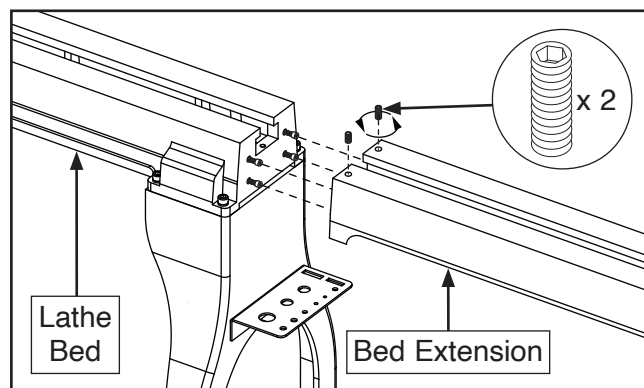
3. Gently lower bed extension so cap screws slide into upper portion of keyhole slots.
4. Place straightedge across lathe bed and bed extension to verify they are parallel and aligned.

- If bed extension sits *below* surface of lathe bed, rotate set screws clockwise to raise bed extension until edge of bed extension is flush with lathe bed (see **Figure 4**).



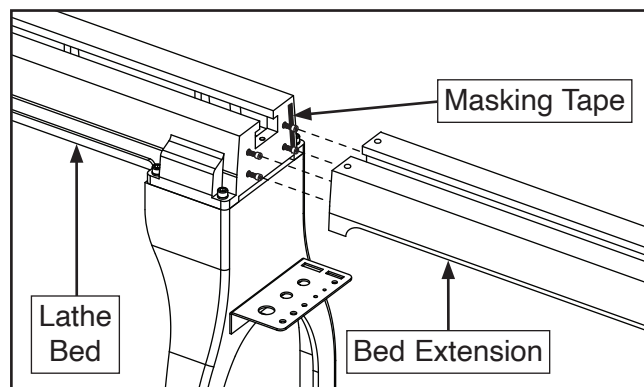
**Figure 4.** Raising bed extension.

- If bed extension sits *above* surface of lathe bed, rotate set screws counterclockwise to lower bed extension until edge of bed extension is flush with lathe bed (see **Figure 5**).



**Figure 5.** Lowering bed extension.

- If bed extension is skewed *left* or *right*, use a vertical strip of masking tape along corresponding edge of lathe bed to make bed extension parallel with lathe bed (see **Figure 6**).



**Figure 6.** Shimming bed extension left.

5. Fully tighten cap screws from **Step 1**.

Refer to **Model G0838 Owner's Manual** for instructions on operating lathe.

*If you need help with your new bed & tool post extensions, call tech support at (570) 546-9663.*



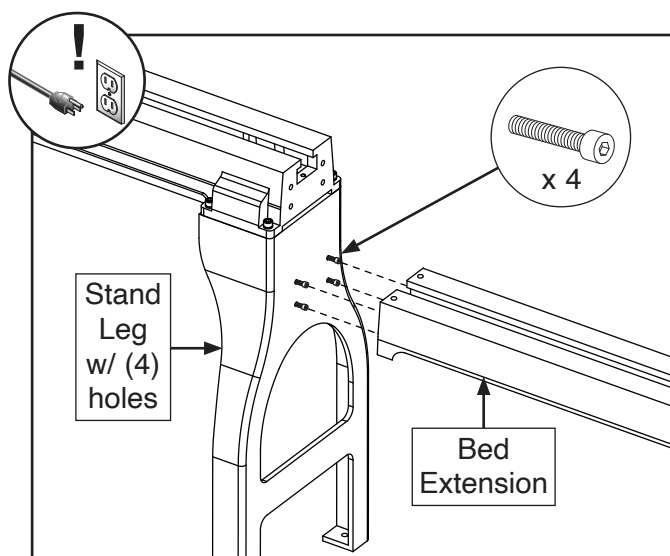
## Mounting Extension in Outboard Position

To use the bed extension in the outboard position, the headstock must be rotated 180° so the faceplate faces the stand leg with (4) pre-drilled holes. This stand leg will be used to mount the bed extension.

Items Needed	Qty
Assistant(s) .....	As Needed
Flat Head Screwdriver .....	1
Hex Wrench 8mm.....	1

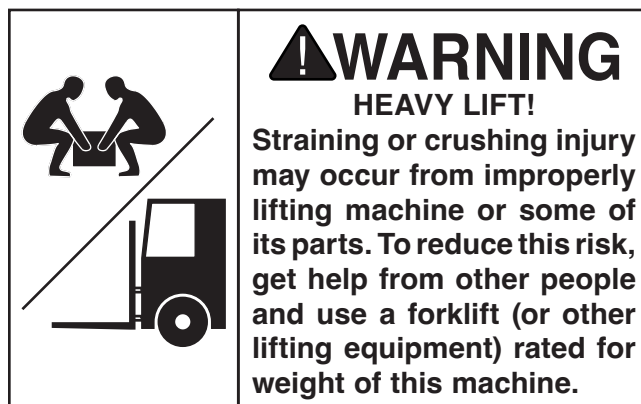
### To mount extension in outboard position:

1. DISCONNECT MACHINE FROM POWER!
2. Thread (4) M10-1.5 x 30 cap screws approximately halfway into stand leg with (4) holes.
3. Align cap screws with bottom of keyhole slots (see **Figure 7**), then slide bed extension onto cap screws.

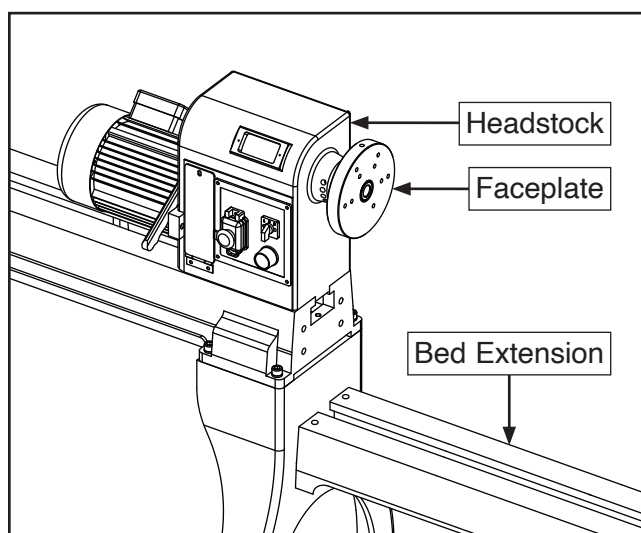


**Figure 7.** Attaching bed extension to left stand leg.

4. Fully tighten cap screws from **Step 2**.
5. Remove bed stop from headstock end of lathe bed.



6. Loosen headstock lock lever, then, with assistance, carefully remove headstock from lathe bed.
7. Rotate headstock 180°, slide it back onto lathe bed with faceplate facing toward bed extension (see **Figure 8**), and tighten headstock lock lever.



**Figure 8.** Headstock rotated 180°.

8. Re-install bed stop removed in **Step 5**.

Refer to **Model G0838 Owner's Manual** for instructions on operating lathe.

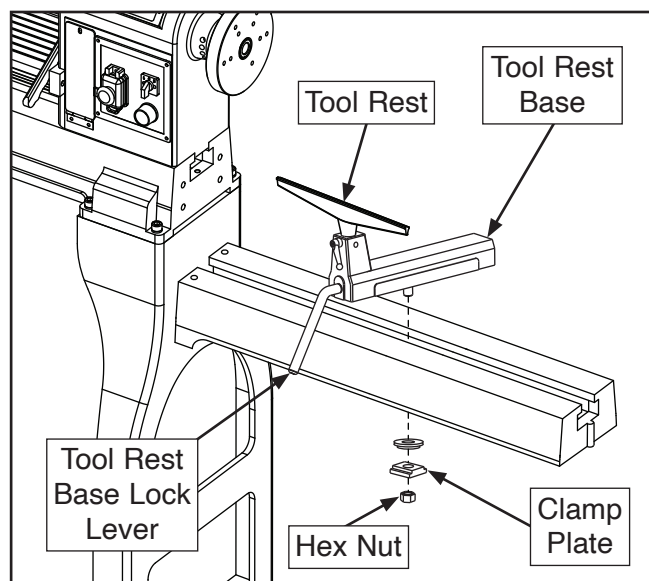
*If you need help with your new bed & tool post extensions, call tech support at (570) 546-9663.*



## Installing Tool Post Extension

1. Remove tool rest base from lathe bed, then slide tool rest base onto bed extension (see **Figure 9**). Clamp plate must be aligned with bed extension to sit flush.
2. Use tool rest base lock lever to secure tool rest base on bed extension (see **Figure 9**).

**Note:** If lock lever does not secure tool rest base, tighten hex nut securing clamp plate until it does.

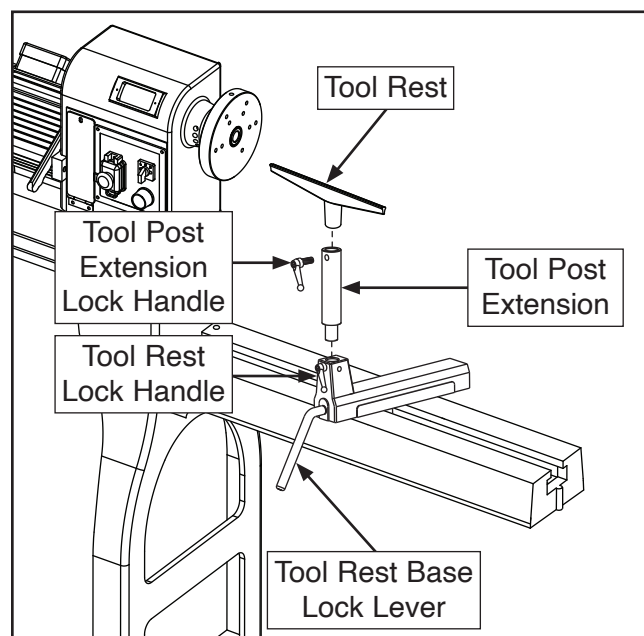


**Figure 9.** Attaching tool rest base to bed extension.

3. Remove tool rest from tool rest base, install tool post extension in tool rest base hole, then secure with tool rest lock handle (see **Figure 10**).

**Note:** Tool rest lock handle is pre-installed on tool rest base.

4. Install tool rest in tool post extension and secure with lock handle (see **Figure 10**).



**Figure 10.** Attaching tool post extension to tool rest base.

Refer to **Model G0838 Owner's Manual** for instructions on operating lathe.

*If you need help with your new bed/tool post extension, call tech support at (570) 546-9663.*



## Adjusting Tool Rest

The tool rest assembly consists of three components: the tool rest base (or banjo), the tool rest, and the tool post extension. The tool rest base moves forward/backward and along the length of the lathe bed. The tool rest rotates and moves up and down in the tool rest base or tool post extension. The tool post extension can be added to the tool rest assembly to allow for tool rest height adjustment for outboard turning operations. Locks for each component allow you to secure the tool rest in position after making these adjustments.

When adjusting the tool rest, position it as close as possible to the workpiece without actually touching it. This maximizes support where the cutting occurs and minimizes leverage, reducing the risk of injury if a "catch" occurs.

Many woodturners typically set the height of the tool rest  $\frac{1}{8}$ " above or below the centerline of the workpiece, depending on their height, the type of tool they're using, and the type of operation they're performing.

**As a rule of thumb:** For most (spindle) turning operations, the cutting tool should contact the workpiece slightly above centerline. For most inside (bowl) turning operations, the cutting tool should contact the workpiece slightly below centerline.

Keeping all these factors in mind, your main goal when adjusting the tool rest should be providing maximum support for the type of tool being used, in a position that is safe and comfortable for you.

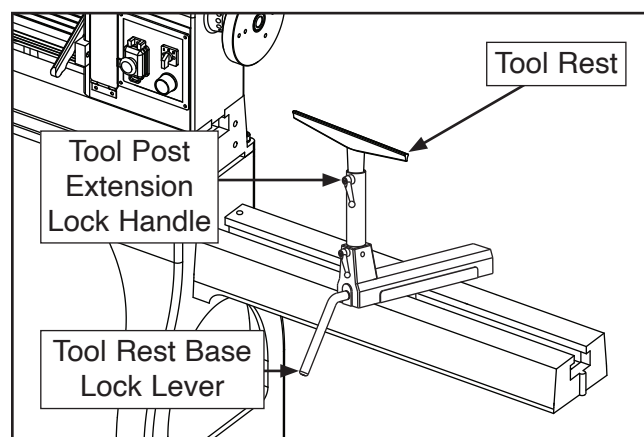
### WARNING

Improperly supported or positioned cutting tools can "catch" on workpiece, ejecting tool from your hands with great force. To reduce this risk, always ensure tool rest is properly positioned for each type of operation, cutting tool is firmly supported against tool rest **BEFORE** cutting, and cutting tool is properly positioned to cut at the correct angle for tool and operation type.

## To adjust tool rest:

1. Loosen tool rest base lock lever and move tool rest assembly to desired position on bed extension (see **Figure 11**).

**Note:** To maximize support, the tool rest base should always be locked on both sides of the bed. Never pull tool rest so far back that it is only secured on one side.



**Figure 11.** Tool rest controls.

2. Tighten tool rest base lock lever to secure tool rest assembly in position.

**Note:** Large clamping hex nut underneath tool rest base requires occasional adjusting to ensure proper clamping pressure of tool rest assembly to bed extension. Turn this hex nut in small increments to fine tune clamping pressure as needed.

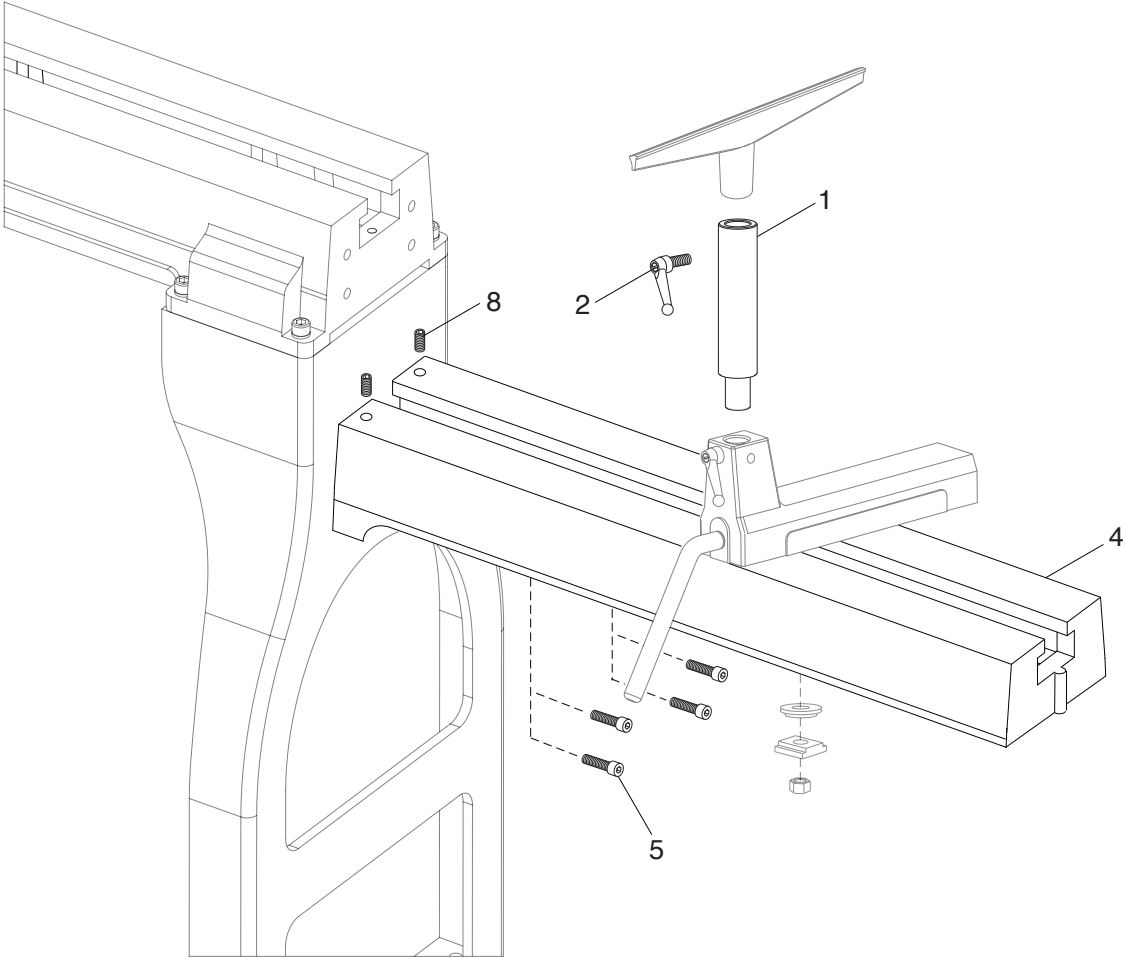
### WARNING

Always operate lathe with tool rest assembly firmly locked in position. Otherwise, serious personal injury may occur by tool being pulled from operator's hands.

3. Loosen tool post extension lock handle (see **Figure 11**).
4. Position tool rest in desired location, then tighten tool post extension lock handle.



# T28372 Parts Breakdown & List



REF	PART #	DESCRIPTION
1	PT28372001	TOOL POST EXTENSION
2	PT28372002	ADJUSTABLE HANDLE M10-1.5 X 18
4	PT28372004	EXTENSION BED

REF	PART #	DESCRIPTION
5	PT28372005	CAP SCREW M10-1.5 X 30
8	PT28372008	SET SCREW M6-1 X 10

**Please Note:** We do our best to stock replacement parts whenever possible, but we cannot guarantee that all parts shown here are available for purchase. Call **(800) 523-4777** or visit our online parts store at **[www.grizzly.com](http://www.grizzly.com)** to check for availability.





# WARRANTY & RETURNS

---

Grizzly Industrial, Inc. warrants every product it sells for a period of **1 year** to the original purchaser from the date of purchase. This warranty does not apply to defects due directly or indirectly to misuse, abuse, negligence, accidents, repairs or alterations or lack of maintenance. This is Grizzly's sole written warranty and any and all warranties that may be implied by law, including any merchantability or fitness, for any particular purpose, are hereby limited to the duration of this written warranty. We do not warrant or represent that the merchandise complies with the provisions of any law or acts unless the manufacturer so warrants. In no event shall Grizzly's liability under this warranty exceed the purchase price paid for the product and any legal actions brought against Grizzly shall be tried in the State of Washington, County of Whatcom.

We shall in no event be liable for death, injuries to persons or property or for incidental, contingent, special, or consequential damages arising from the use of our products.

The manufacturers reserve the right to change specifications at any time because they constantly strive to achieve better quality equipment. We make every effort to ensure that our products meet high quality and durability standards and we hope you never need to use this warranty.

In the event you need to use this warranty, contact us by mail or phone and give us all the details. We will then issue you a "Return Number," which must be clearly posted on the outside as well as the inside of the carton. We will not accept any item back without this number. Proof of purchase must accompany the merchandise.

Please feel free to write or call us if you have any questions about the machine or the manual.

Thank you again for your business and continued support. We hope to serve you again soon.

For further information about the warranty, visit <https://www.grizzly.com/forms/warranty> or scan the QR code below to be automatically directed to our warranty page.





Buy Direct and Save with Grizzly® – Trusted, Proven and a Great Value!  
~Since 1983~

*Visit Our Website Today For  
Current Specials!*

**ORDER  
24 HOURS A DAY!  
1-800-523-4777**

