



For questions or help with this product contact Tech Support at (570) 546-9663 or techsupport@grizzly.com

MODEL T33255 61" 9-DRAWER TOOL CHEST INSTRUCTIONS

Introduction

The Model T33255 9-Drawer Tool Chest requires some assembly. Follow the instructions below for assembly, operation, and maintenance.



Figure 1. Model T33255.

⚠ WARNING

- To reduce risk of crushing injuries from tool chest tipping over on you:
 - Do not stand on tool chest or in drawers.
 - Keep wheels locked and turned facing front of tool chest.
 - Push tool chest only. Do not pull it.
 - Only open one drawer at a time.
 - Only move or transport tool chest with all drawers closed and locked.
- Do not exceed weight capacities:
 - Max individual drawer weight limit is 100 lbs.
 - Max tool chest weight limit (including contents) is 1150 lbs.
- To prevent accidental rolling, always lock brakes after moving tool chest.
- Do not allow children to have unsupervised access to tool chest.

Inventory

Description	Qty
• Tool Chest with Drawers	1
• Fixed Casters	2
• Swivel Casters with Brake	2
• Handles	2
• Keys.....	2
• Hex Bolts 1/4"-20 x 1/2"	8
• Hex Bolts 3/8"-16 x 1"	16
• Power Cord.....	1

Note: Some inventory items may be stored in drawers.

Needed for Setup

Description	Qty
• Additional Person	1
• Open-End Wrenches 7/16", 9/16"	1 Ea.

Assembly

1. Attach handle to each side of tool chest with (4) 1/4"-20 x 1/2" hex bolts (see **Figure 2**). Do not over-tighten!

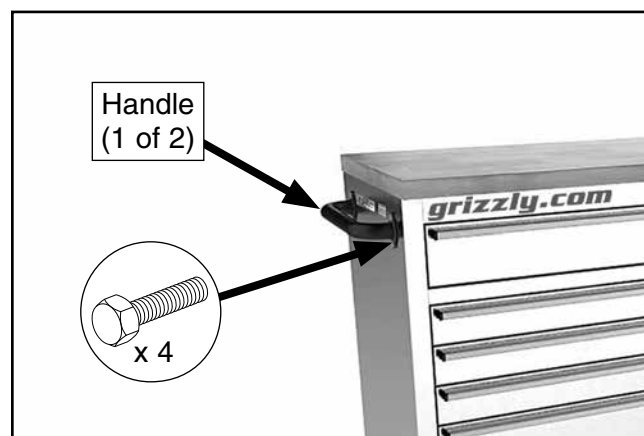

Figure 2. Handle installed.

COPYRIGHT © MARCH, 2022 BY GRIZZLY INDUSTRIAL, INC.
NO PORTION OF THIS MANUAL MAY BE REPRODUCED IN ANY SHAPE
OR FORM WITHOUT THE WRITTEN APPROVAL OF GRIZZLY INDUSTRIAL, INC.
(FOR MODELS MFD. SINCE 04/22) #SS22275 PRINTED IN CHINA

V1.03.22

Keep for Future Reference

2. Remove casters and hardware from bottom drawer.
3. With help from another person, lay back of tool chest flat on floor.

Note: We recommend sweeping the floor clean and laying down a piece of cardboard or a blanket to prevent scratching the finish during this step.

4. Attach each caster using (4) $\frac{3}{8}$ "-16 x 1" hex bolts (see **Figure 3**).

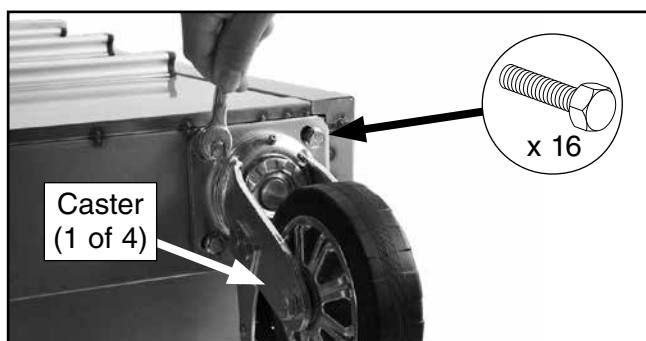

Figure 3. Example of caster installation.

5. Return tool chest to upright position.

Locking Caster

To lock caster, press down on caster lock (see **Figure 4**). Secure each corner caster to ensure tool chest will not shift position.

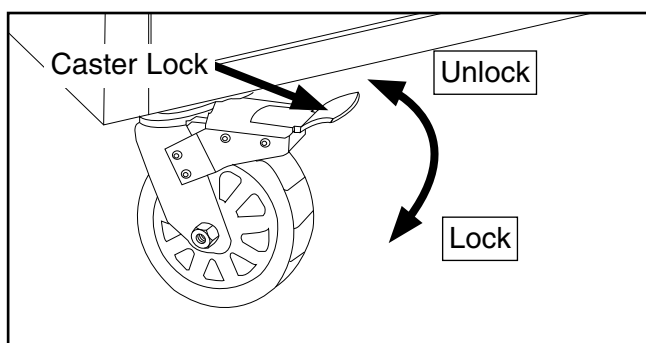

Figure 4. Location of caster lock.

⚠ WARNING

Tool chests can tip and cause crushing injury when wheels are not set up properly. When stationary, wheels should always be locked and turned facing the front of the tool chest to avoid injury and prevent tipping accidents.

Removing & Installing Drawers

The drawers can be removed and re-installed if necessary.

To remove and install drawers:

1. Fully extend drawer and remove contents.
2. Push left locking tab down and hold, then pull right locking tab up and hold (see **Figure 5**).

Note: Larger lower drawers feature two guides per side.

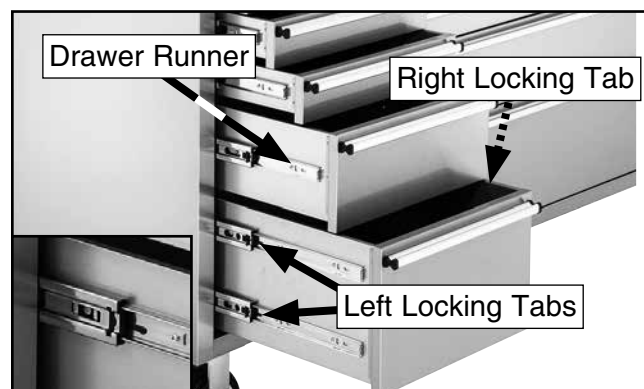

Figure 5. Location of drawer locking tabs.

3. Pull drawer out to remove.
4. To re-install, insert drawer runners into slides (see **Figure 5**) and push drawer completely in. Locking tabs will automatically snap into place to secure drawer in slides.

Locking Drawers

Use the included keys to secure the drawers. Only completely closed drawers will lock.

Maintenance

- Use soft, clean cloth and soapy water (use regular dish soap) to remove grease, dirt, or oil. Do not use solvents or flammable cleaning liquids.
- Lubricate drawer slides as needed with dry lubricant, such as Grizzly's Model G4682 Sprayway Dry Coating Lube.
- Use graphite to lubricate lock annually.



Power Strip

The T33255 features a pre-installed power strip with (4) 5-15 outlets and (2) USB ports, conveniently located for easy access. The included power strip has the following ratings:

Max. Amperage Load 12A
Max. Voltage 125V
Cycle 60 Hz
Max. Wattage 1500W
USB Output 5VDC, Max. 2.1A

Plug the provided power cord into the power strip socket (see **Figure 6**).

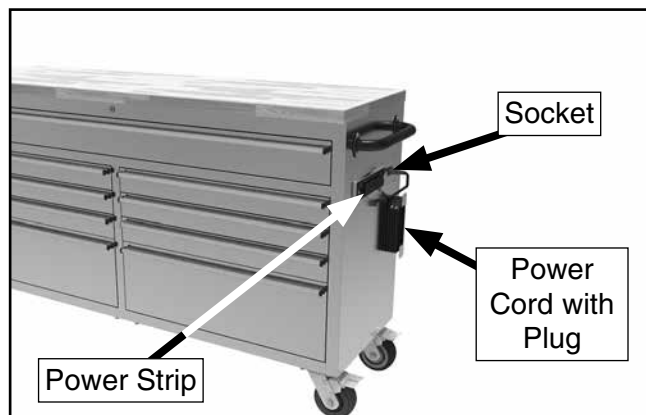

Figure 6. Example of power strip and plug location.

!WARNING

- Do not connect to plug receptacle via extension cords or in series with other power strips.
- Keep electrical connections clear of flammable materials.
- Keep electrical connections dry. Do not use in damp or wet conditions.
- Do not connect devices to power strip that draw more than listed power strip rating. Equipment must be used in accordance with any instructions or labeling.
- Power strips are designed for use with low-powered loads, such as battery chargers. Not designed for use with high-powered loads, such as space heaters or microwaves.
- Do not run cord under floor coverings or where it may be tripped over.
- Not meant for outdoor use.
- Prevent unauthorized use by children or untrained users.

110V Circuit Requirements

This tool chest is prewired to connect to a power supply circuit that has a verified ground and meets the following requirements:

Nominal Voltage 110V, 115V, 120V
Cycle 60 Hz
Phase Single-Phase
Power Supply Circuit 15 Amps

A power supply circuit includes all electrical equipment between the breaker box or fuse panel in the building and the power strip. The power supply circuit used for this power strip must be sized to safely handle the full-load current drawn from the power strip for an extended period of time. (If this power strip is connected to a circuit protected by fuses, use a time delay fuse marked D.)

Grounding & Plug Requirements

This power strip **MUST** be grounded. In the event of certain malfunctions or breakdowns, grounding reduces the risk of electric shock by providing a path of least resistance for electric current.

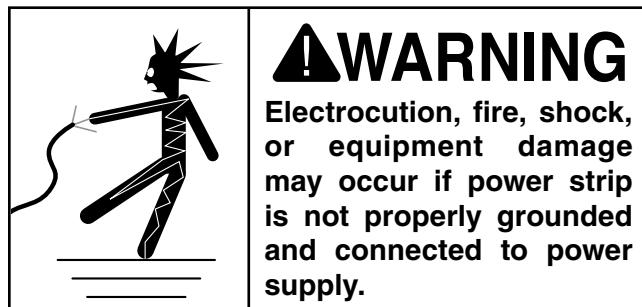

This power strip is equipped with a power cord that has an equipment-grounding wire and a grounding plug. Only insert plug into a matching receptacle (outlet) that is properly installed and grounded in accordance with all local codes and ordinances. **DO NOT** modify the provided plug!

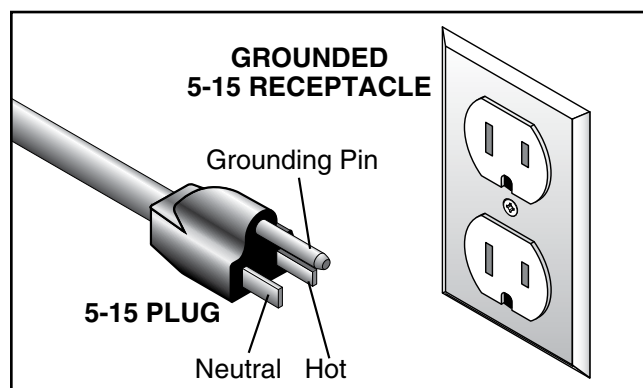
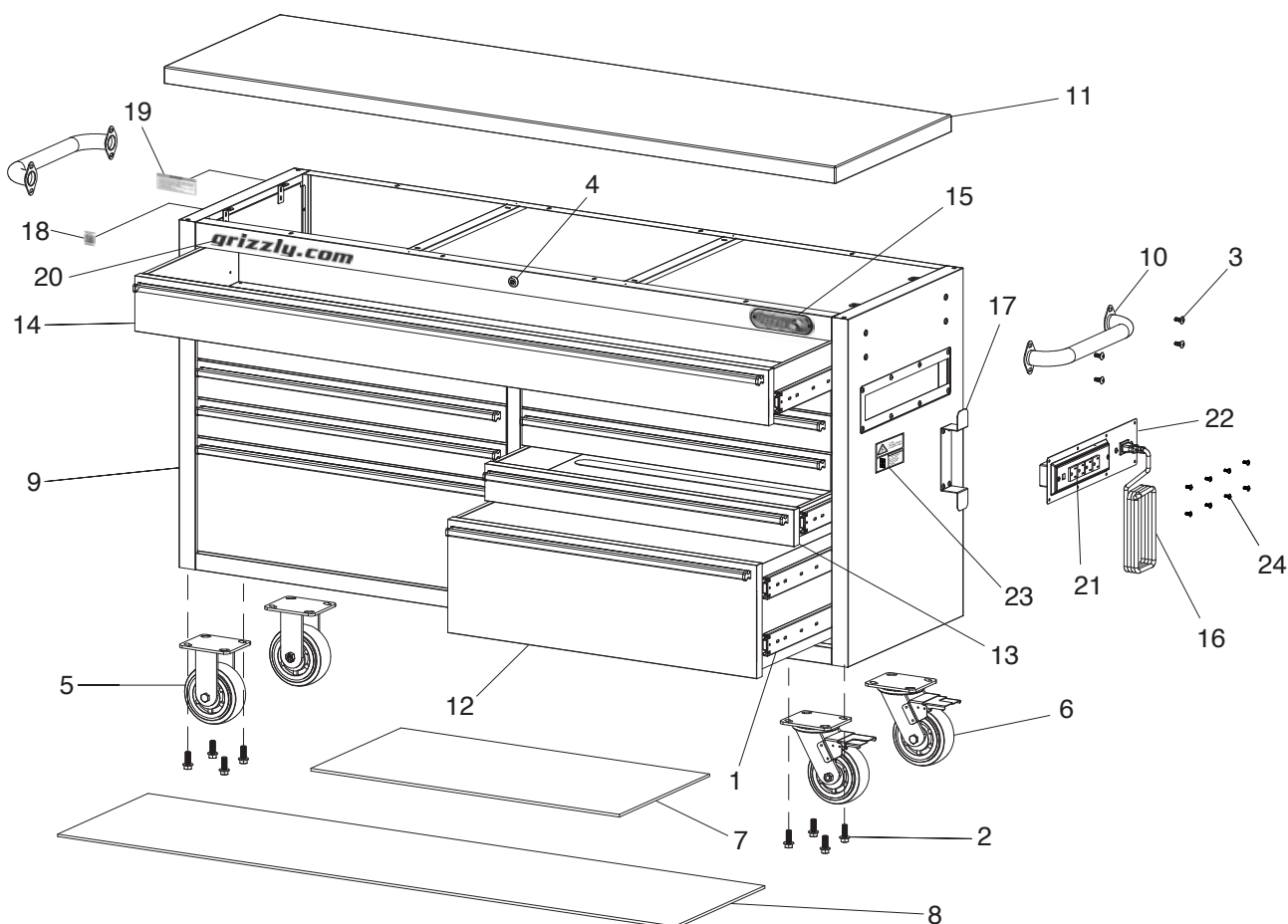

Figure 7. Typical 5-15 plug and receptacle.



T33255 Parts Breakdown & List



REF PART #	DESCRIPTION
1	PT33255001 DRAWER SLIDE SET
2	PT33255002 HEX BOLT 3/8-16 X 1
3	PT33255003 HEX BOLT 1/4-20 X 1/2
4	PT33255004 LOCK SET WITH 2 KEYS
5	PT33255005 CASTER, 6" FIXED
6	PT33255006 CASTER, 6" SWIVEL WITH BRAKE
7	PT33255007 DRAWER LINER, SMALL
8	PT33255008 DRAWER LINER, LARGE
9	PT33255009 CABINET BODY
10	PT33255010 HANDLE
11	PT33255011 WOOD TOP
12	PT33255012 DRAWER, LOWER

REF PART #	DESCRIPTION
13	PT33255013 DRAWER, MIDDLE
14	PT33255014 DRAWER, TOP
15	PT33255015 GRIZZLY NAMEPLATE
16	PT33255016 POWER CORD 18G 3W 72" 5-15P/C14
17	PT33255017 POWER CORD BRACKET
18	PT33255018 QR CODE LABEL
19	PT33255019 WARNING LABEL
20	PT33255020 GRIZZLY.COM LABEL
21	PT33255021 POWER STRIP 18G 3W 6"
22	PT33255022 MOUNTING PLATE
23	PT33255023 POWER STRIP LABEL
24	PT33255024 PHLP HD SCR 8-32 X 1/2

⚠ WARNING

Safety labels help reduce the risk of serious injury caused by machine hazards. If any label comes off or becomes unreadable, the owner of this machine **MUST** replace it in the original location before resuming operations. For replacements, contact (800) 523-4777 or www.grizzly.com.

Please Note: We do our best to stock replacement parts whenever possible, but we cannot guarantee that all parts shown here are available for purchase. Call (800) 523-4777 or visit our online parts store at www.grizzly.com to check for availability.

