



# MODEL T33276

## 72" 15 DRAWER & UPPER

## CABINET TOOL CHEST

### INSTRUCTIONS

For questions or help with this product contact Tech Support at (570) 546-9663 or techsupport@grizzly.com

### Introduction

The Model T33276 15-Drawer Tool Chest requires some assembly. Follow the instructions below for assembly, operation, and maintenance.



Figure 1. Model T33276.

### WARNING

- To reduce risk of crushing injuries from tool chest tipping over on you:
  - Do not stand on tool chest or in drawers.
  - Keep wheels locked and turned facing front of tool chest.
  - Push tool chest only. Do not pull it.
  - Only open one drawer at a time.
  - Only move or transport tool chest with all drawers closed and locked.
- Do not exceed weight capacities:
  - Max individual drawer weight limit is 100 lbs.
  - Max tool chest weight limit (including contents) is 1850 lbs.
- To prevent accidental rolling, always lock brakes after moving tool chest.
- Do not allow children to have unsupervised access to tool chest.

### Inventory

Large Items (Figure 2)	Qty
A. Cabinet Shelves .....	3
B. Rails .....	4
C. Overhead Cabinet Assembly.....	1
D. Handles .....	2
E. Pegboard.....	1
F. Fixed Casters .....	2
G. Swivel Casters with Brakes .....	2
H. Tool Chest with Drawers .....	1
I. Power Cord.....	1
J. LED Light Assembly .....	1

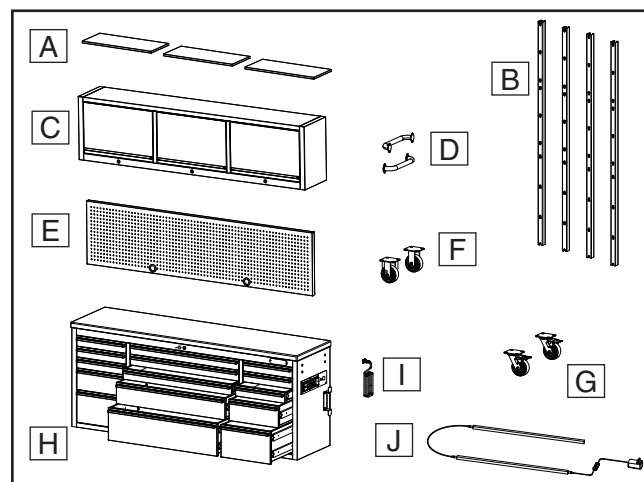

Figure 2. Large items inventory.

Fasteners (Not Shown)	Qty
• Hex Bolts 1/4"-20 x 1/2" .....	48
• Hex Bolts 3/8"-16 x 1" .....	16
• Shelf Brackets .....	12
• Keys.....	2

**Note:** Some inventory items may be stored in drawers.

COPYRIGHT © MARCH, 2022 BY GRIZZLY INDUSTRIAL, INC.  
 NO PORTION OF THIS MANUAL MAY BE REPRODUCED IN ANY SHAPE  
 OR FORM WITHOUT THE WRITTEN APPROVAL OF GRIZZLY INDUSTRIAL, INC.  
 (FOR MODELS MFD. SINCE 04/22) #SS22279 PRINTED IN CHINA

V1.03.22

\*\*\*Keep for Future Reference\*\*\*

## Needed for Setup

Description	Qty
• Additional Person .....	1
• Open-End Wrenches $\frac{7}{16}$ ", $\frac{9}{16}$ " .....	1 Ea.

## Assembly

1. Attach handle to each side of tool chest with (4)  $\frac{1}{4}$ "-20 x  $\frac{1}{2}$ " hex bolts (see **Figure 3**). Do not over-tighten!

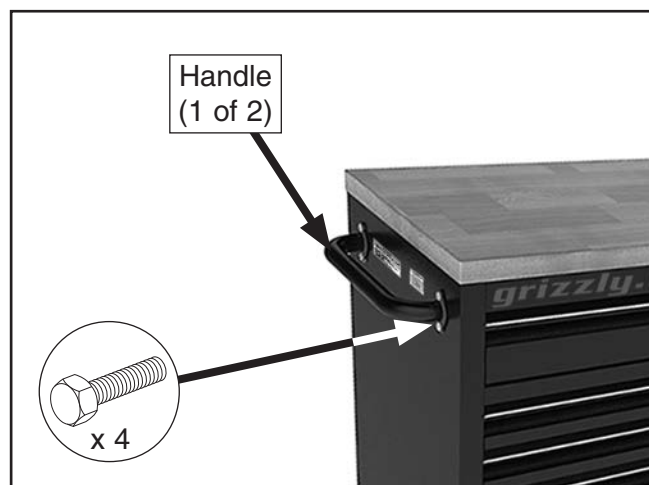
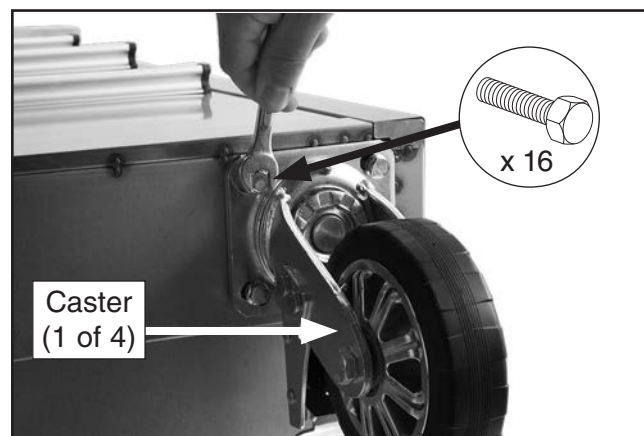

**Figure 3.** Example of handle installed.

2. Remove casters and hardware from bottom drawer.
3. With help from another person, lay back of tool chest flat on floor.

**Note:** We recommend sweeping the floor clean and laying down a piece of cardboard or blanket to prevent scratching the finish during this step.

4. Attach each caster using (4)  $\frac{3}{8}$ "-16 x 1" hex bolts (see **Figure 4**).



**Figure 4.** Example of caster installation.

**Note:** Install swivel casters on right side of tool chest.

5. Return tool chest to upright position.
6. Attach (4) rails to tool cabinet with (4)  $\frac{1}{4}$ "-20 x  $\frac{1}{2}$ " hex bolts for each rail (see **Figure 5**).

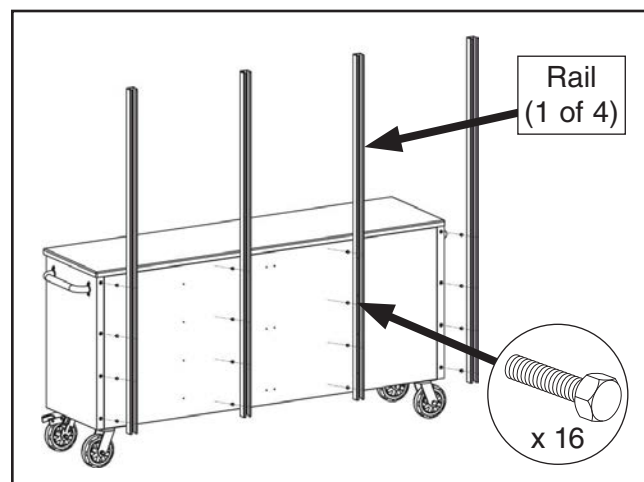
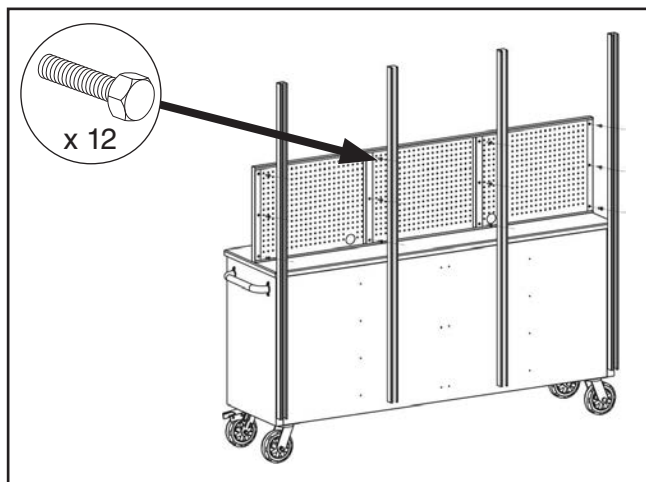

**Figure 5.** Rail installation.

**Note:** Before tightening hex bolts, make sure to slide rails up so that hex bolts sit in bottom of rail slots.



7. Pre install (12)  $\frac{1}{4}$ "-20 x  $\frac{1}{2}$ " hex bolts to peg board, but do not thread on completely (see **Figure 6**).
8. Align hex bolts on pegboard with slots in rails. Allow bolts to rest at bottom of slot, and tighten to secure pegboard.



**Figure 6.** Pegboard installation.

9. Attach cabinet assembly to rails with (12)  $\frac{1}{4}$ "-20 x  $\frac{1}{2}$ " hex bolts (see **Figure 7**).

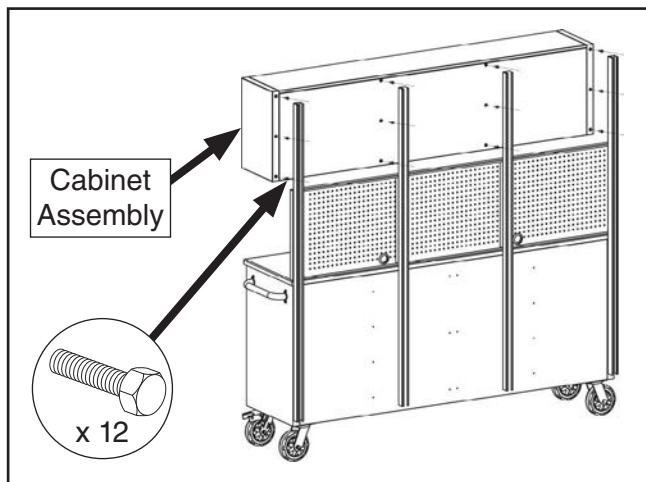

**Figure 7.** Cabinet installation.

10. Insert (4) shelf brackets inside upper cabinet at desired height. Place shelf on shelf brackets (see **Figure 8**).
11. Repeat **Step 9** for other shelves (see **Figure 8**).

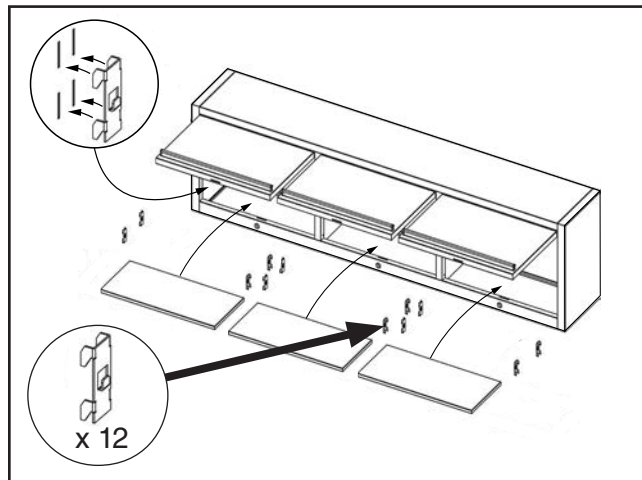

**Figure 8.** Shelf installation.

12. Connect lights from LED light assembly (see **Figure 9**) and install pegboard.

**Note:** LED light assembly is magnetic and can be installed anywhere on pegboard.

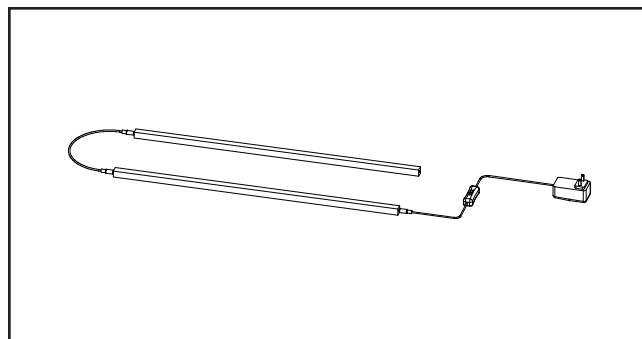
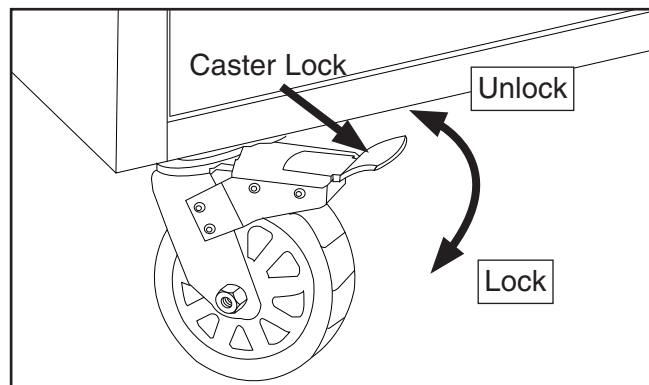

**Figure 9.** LED light assembly.



## Locking Caster

To lock caster, press down on caster lock (see **Figure 10**). Secure each corner caster to ensure tool cabinet will not shift position.



**Figure 10.** Location of caster lock.

## WARNING

Tool chests can tip and cause crushing injury when wheels are not set up properly. When stationary, wheels should always be locked and turned facing the front of the tool chest to avoid injury and prevent tipping accidents.

## Maintenance

- Use soft, clean cloth and soapy water (use regular dish soap) to remove grease, dirt, or oil. Do not use solvents or flammable cleaning liquids.
- Lubricate drawer slides as needed with dry lubricant, such as Grizzly's Model G4682 Spray Dry Coating Lube.
- Use graphite to lubricate lock annually.

## Removing & Installing Drawers

The drawers can be removed and re-installed if necessary.

### To remove and install drawers:

1. Fully extend drawer and remove contents.
2. Push left locking tab down and hold, then pull right locking tab up and hold (see **Figure 11**).

**Note:** Larger lower drawers feature two guides per side.

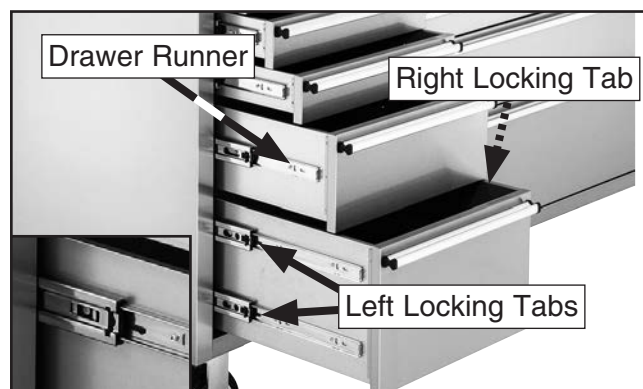

**Figure 11.** Example of location of drawer locking tabs.

3. Pull drawer out to remove.
4. To re-install, insert drawer runners into slides (see **Figure 11**) and push drawer completely in. The locking tabs will automatically snap into place to secure drawer in slides.

## Locking Drawers & Cabinets

Use the included keys to secure the drawers and cabinets. Only completely closed drawers and cabinets will lock.



## Power Strip

The T33276 features a pre-installed power strip with (4) 5-15 outlets and (2) USB ports conveniently located for easy access. The included power strip has the following ratings:

**Max. Amperage Load** ..... 12A  
**Max. Voltage** ..... 125V  
**Cycle** ..... 60 Hz  
**Max. Wattage** ..... 1500W  
**USB Output** ..... 5VDC, Max. 2.1A

Plug the provided power cord into the power strip socket (see **Figure 12**).

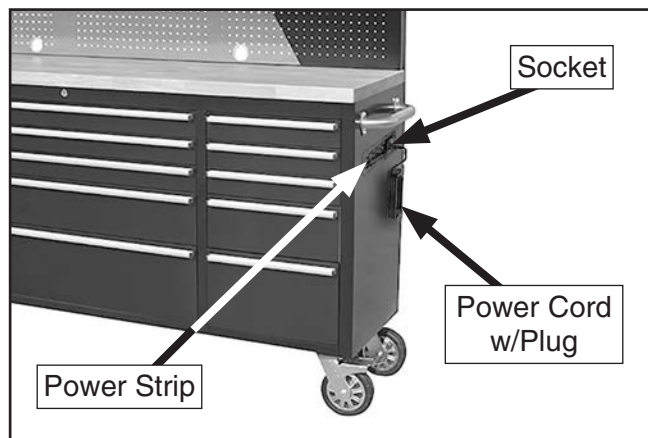

**Figure 12.** Power strip and plug location.

## **!WARNING**

- Do not connect to plug receptacle via extension cords or in series with other power strips.
- Keep electrical connections clear of flammable materials.
- Keep electrical connections dry. Do not use in damp or wet conditions.
- Do not connect devices to power strip that draw more than listed power strip rating. Equipment must be used in accordance with any instructions or labeling.
- Power strips are designed for use with low-powered loads, such as battery chargers. Not designed for use with high-powered loads, such as space heaters or microwaves.
- Do not run cord under floor coverings or where it may be tripped over.
- Not meant for outdoor use.
- Prevent unauthorized use by children or untrained users.

## 110V Circuit Requirements

This tool chest is prewired to connect to a power supply circuit that has a verified ground and meets the following requirements:

**Nominal Voltage** ..... 110V, 115V, 120V  
**Cycle** ..... 60 Hz  
**Phase** ..... Single-Phase  
**Power Supply Circuit** ..... 15 Amps

A power supply circuit includes all electrical equipment between the breaker box or fuse panel in the building and the power strip. The power supply circuit used for this power strip must be sized to safely handle the full-load current drawn from the power strip for an extended period of time. (If this power strip is connected to a circuit protected by fuses, use a time delay fuse marked D.)

## Grounding & Plug Requirements

This power strip **MUST** be grounded. In the event of certain malfunctions or breakdowns, grounding reduces the risk of electric shock by providing a path of least resistance for electric current.

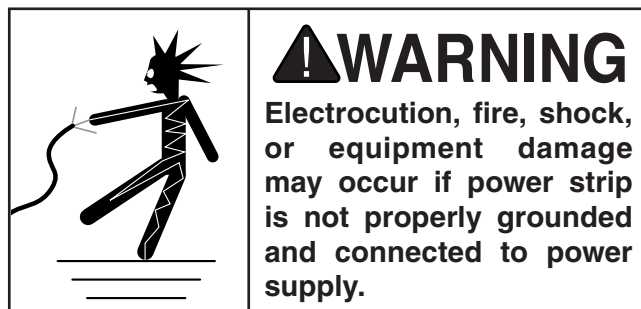

This power strip is equipped with a power cord that has an equipment-grounding wire and a grounding plug. Only insert plug into a matching receptacle (outlet) that is properly installed and grounded in accordance with all local codes and ordinances. **DO NOT** modify the provided plug!

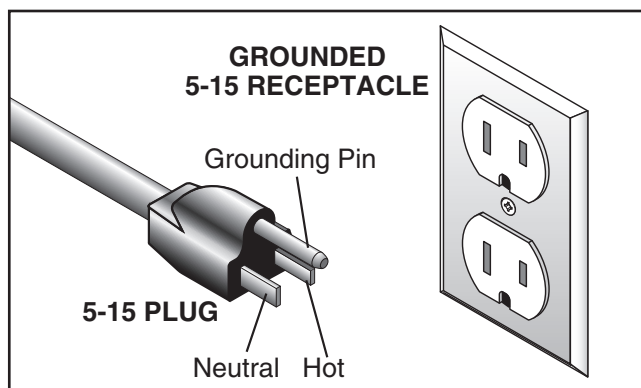
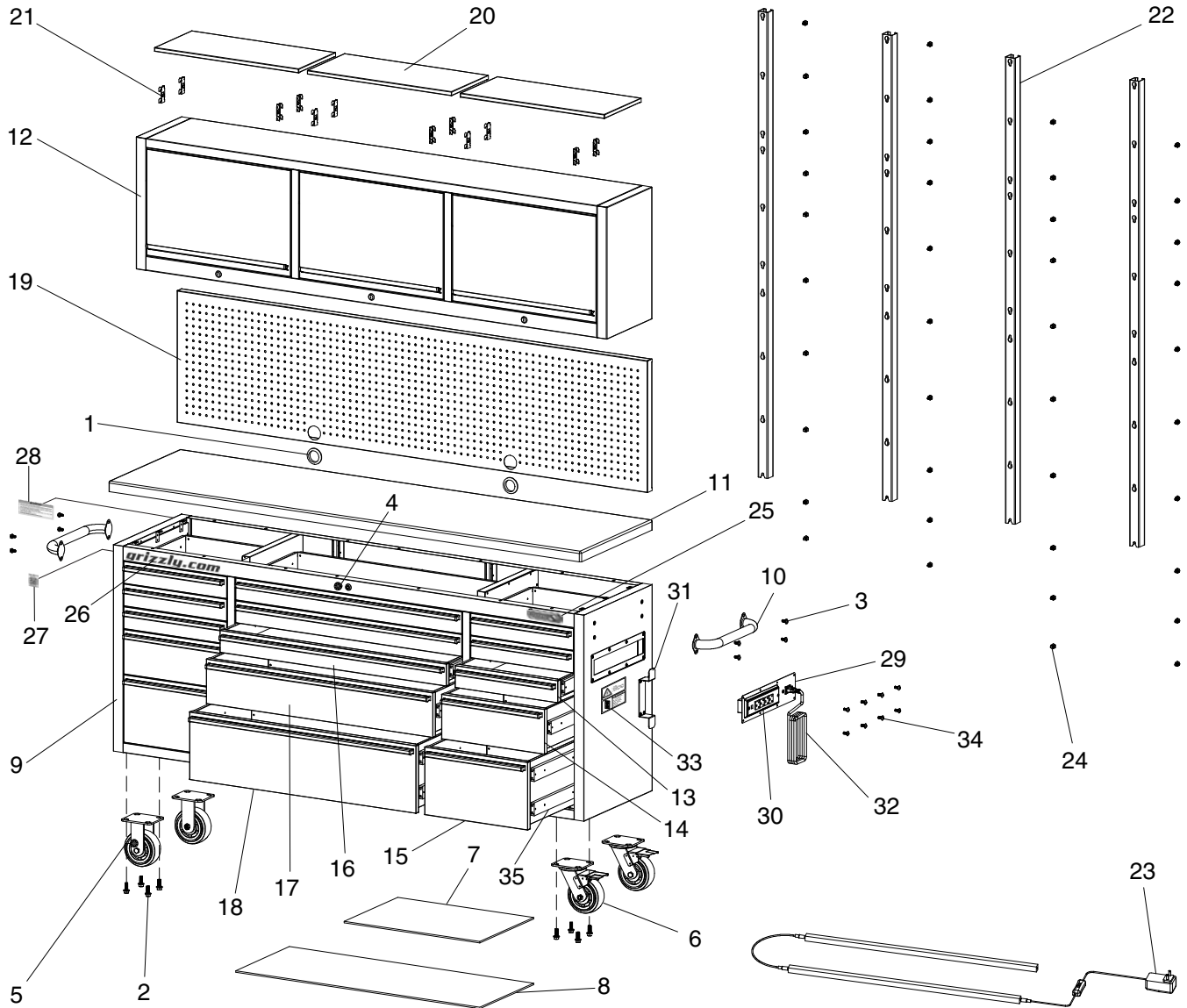

**Figure 13.** Typical 5-15 plug and receptacle.





# T33276 Parts Breakdown



**Please Note:** We do our best to stock replacement parts whenever possible, but we cannot guarantee that all parts shown here are available for purchase. Call (800) 523-4777 or visit our online parts store at [www.grizzly.com](http://www.grizzly.com) to check for availability.



# T33276 Parts List

REF PART #	DESCRIPTION
1	PT33276001 GROMMET
2	PT33276002 HEX BOLT 3/8-16 X 1
3	PT33276003 HEX BOLT 1/4-20 X 1/2
4	PT33276004 LOCK SET WITH 2 KEYS
5	PT33276005 CASTER, 6" FIXED
6	PT33276006 CASTER, 6" SWIVEL WITH BRAKE
7	PT33276007 DRAWER LINER, SMALL
8	PT33276008 DRAWER LINER, LARGE
9	PT33276009 TOOL CHEST BODY
10	PT33276010 HANDLE
11	PT33276011 WOOD TOP
12	PT33276012 CABINET BODY
13	PT33276013 DRAWER, OUTER TOP
14	PT33276014 DRAWER, OUTER MIDDLE
15	PT33276015 DRAWER, OUTER LOWER
16	PT33276016 DRAWER, CENTER TOP
17	PT33276017 DRAWER, CENTER MIDDLE
18	PT33276018 DRAWER, CENTER LOWER

REF PART #	DESCRIPTION
19	PT33276019 PEGBOARD
20	PT33276020 CABINET SHELF
21	PT33276021 SHELF BRACKET
22	PT33276022 CABINET RAIL
23	PT33276023 LED LIGHT ASSEMBLY
24	PT33276024 HEX BOLT 1/4-20 X 1/2
25	PT33276025 GRIZZLY NAMEPLATE
26	PT33276026 GRIZZLY.COM LABEL
27	PT33276027 QR CODE LABEL
28	PT33276028 WARNING LABEL
29	PT33276029 MOUNTING PLATE
30	PT33276030 POWER STRIP 18G 3W 6"
31	PT33276031 POWER CORD BRACKET
32	PT33276032 POWER CORD 18G 3W 72" 5-15P/C14
33	PT33276033 POWER STRIP LABEL
34	PT33276034 PHLP HD SCR 8-32 X 1/2
35	PT33276035 DRAWER SLIDE SET

## WARNING

Safety labels help reduce the risk of serious injury caused by machine hazards. If any label comes off or becomes unreadable, the owner of this machine **MUST** replace it in the original location before resuming operations. For replacements, contact (800) 523-4777 or [www.grizzly.com](http://www.grizzly.com).





Buy Direct and Save with Grizzly® – Trusted, Proven and a Great Value!  
~Since 1983~

*Visit Our Website Today For  
Current Specials!*

**ORDER  
24 HOURS A DAY!  
1-800-523-4777**

