



For questions or help with this product contact Tech Support at (570) 546-9663 or techsupport@grizzly.com

MODEL T34089 84" 4-DRAWER BUTCHER BLOCK WORKBENCH INSTRUCTIONS

Introduction

The T34089 4-Drawer Butcher Block Workbench measures 84" wide, 26" deep, 35" tall and is made of solid hevea wood. This model includes four large felt-lined drawers with ball bearing slides, a 1 1/8" thick benchtop supported by 1 3/4" x 2 1/4" wooden legs, and a built-in storage shelf.



Figure 1. Model T34089 4-Drawer Butcher Block Workbench.

Specifications

- Dimensions84" W x 26" D x 35" H
- Workbench Top.....84" W x 26" D
- Benchtop Thickness 1 1/8"
- Drawers20 1/8" W x 14 3/8" D x 5"H
- Legs 1 3/4" W x 2 1/4" D
- Weight220 lbs.
- Weight Capacity 1100 lbs.



! WARNING

Wear safety glasses during the entire setup process!



! WARNING

HEAVY LIFT!

Straining or crushing injury may occur from improperly lifting workbench or some of its parts. To reduce this risk, get help from other people and use a forklift (or other lifting equipment) rated for weight of this workbench.

! WARNING

- Do not exceed weight capacity of workbench.
- Do not stand or climb on workbench.
- Do not use workbench outdoors or in wet or damp locations.
- Do not overload vise or use cheater pipe on vise handles to increase leverage.
- Do not weld on workbench.
- Do not allow children to have unsupervised access to workbench.

COPYRIGHT © FEBRUARY, 2024 BY GRIZZLY INDUSTRIAL, INC.
NO PORTION OF THIS MANUAL MAY BE REPRODUCED IN ANY SHAPE
OR FORM WITHOUT THE WRITTEN APPROVAL OF GRIZZLY INDUSTRIAL, INC.
(FOR MODELS MFD. SINCE 11/23) #JA23062 PRINTED IN CHINA

V1.02.24

Keep for Future Reference

Inventory

Main (Figure 2)	Qty
A. Workbench Top	1
B. Workbench Leg Crossbars.....	4
C. Workbench Legs	4
D. Cabinet Top Panel.....	1
E. Cabinet Back Panel.....	1
F. Cabinet Base Panel.....	1
G. Cabinet Middle Panel	1
H. Cabinet Side Panels.....	2
I. Drawer Handles.....	4
J. Drawer Base Panels.....	4
K. Drawer Front Panels.....	4
L. Drawer Side Panels.....	8
M. Drawer Back Panels.....	4

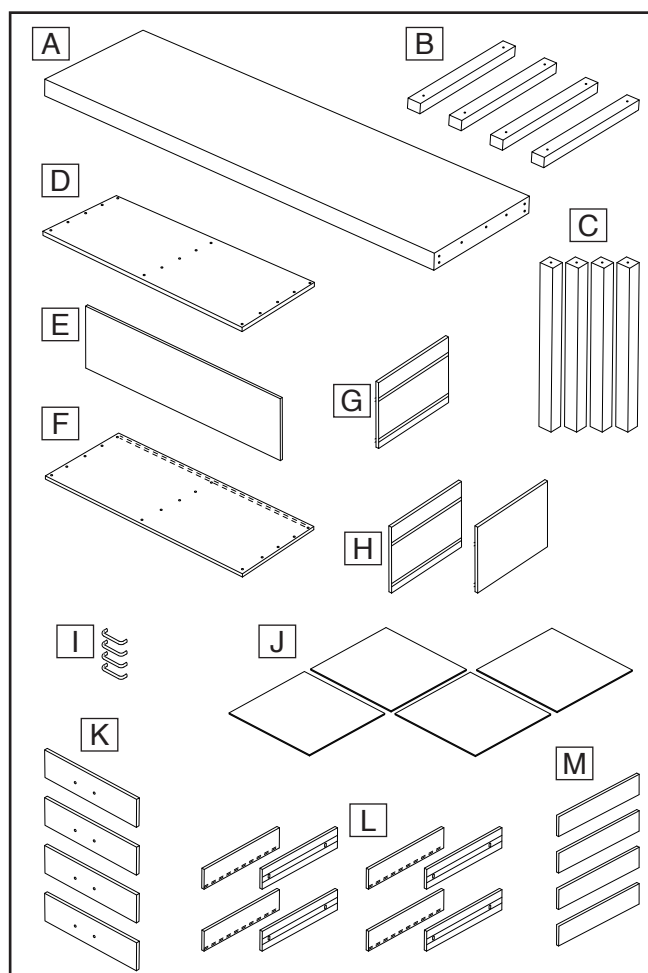

Figure 2. Inventory.

Fasteners (Figure 3)

	Qty
N. Tap Screws M4 x 30.....	62
O. Flat Washers 8mm	12
P. Open-End Wrench 13mm.....	1
Q. Hex Bolts M8-1.25 x 70	8
R. Lag Bolts M8 x 60	4
S. Phillips Head Screwdriver #2	1
T. Tap Screws M4 x 50.....	8
U. Phillips Head Screws M4-.7 x 40.....	8

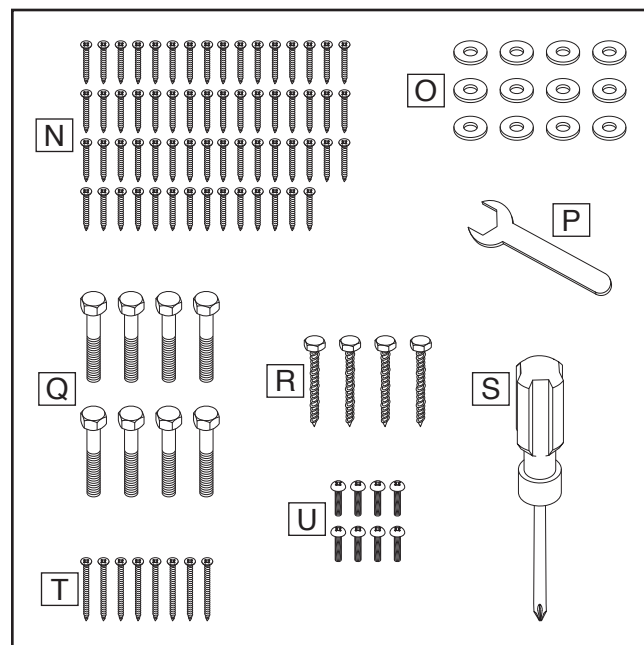

Figure 3. Fasteners.

NOTICE

If you cannot find an item on this list, check the mounting location or examine the packaging materials carefully. Some items are pre-installed for shipping purposes.



Assembly

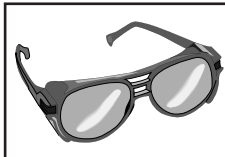

! WARNING
Wear safety glasses during
the entire setup process!

Needed for Assembly

- Additional Person 1
- Safety Glasses (for each person).....1 Pr.
- Square 1

To assemble workbench:

1. Fit (1) drawer back panel to (2) drawer side panels and secure with (4) M4 x 30 tap screws, as shown in **Figure 4**.

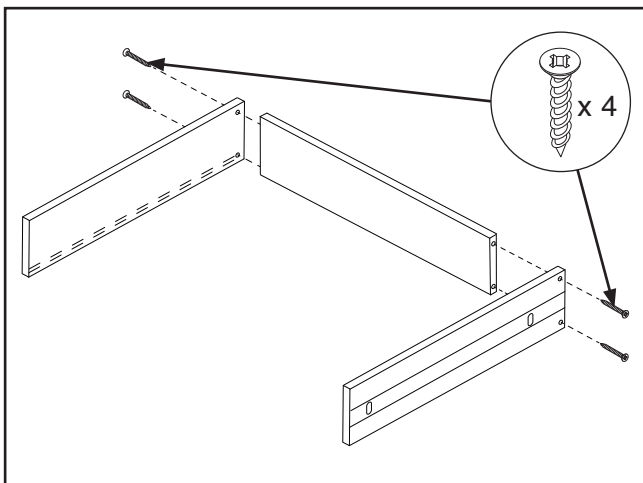

Figure 4. Attaching drawer side panels to back panel.

2. Slide (1) drawer base panel into slots in drawer side panels, then attach (1) drawer front panel using (4) M4 x 30 tap screws, as shown in **Figure 5**.
3. Attach (1) handle to drawer front panel with (2) M4-.7 x 40 Phillips head screws (see **Figure 5**).

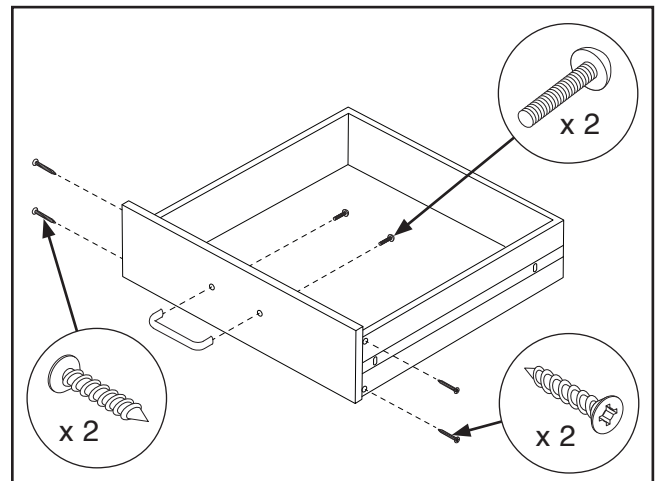

Figure 5. Assembling drawer base panel, front panel, and handle.

4. Repeat **Steps 1–3** for three remaining drawers.
5. Secure cabinet side panels and middle panel to cabinet base panel using (15) M4 x 30 tap screws, as shown in **Figure 6**.

IMPORTANT: Ensure drawer slides on cabinet side and middle panels pull out and away from groove in cabinet base panel.

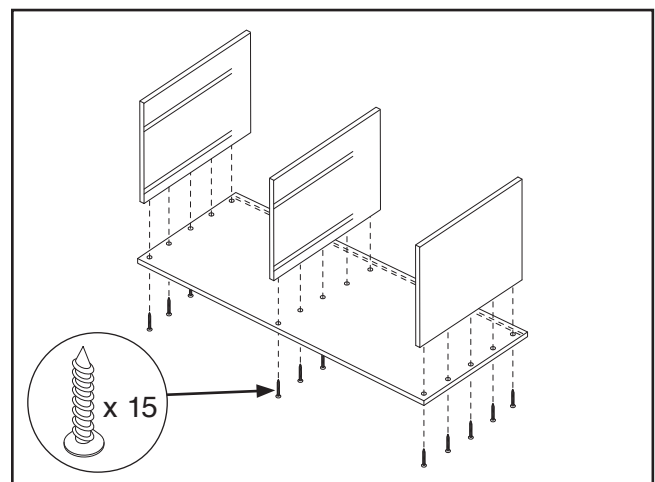

Figure 6. Securing cabinet side and middle panels to base panel.



6. Slide cabinet back panel into grooves in cabinet side and base panels, and attach top panel using (15) M4 x 30 tap screws (see **Figure 7**).

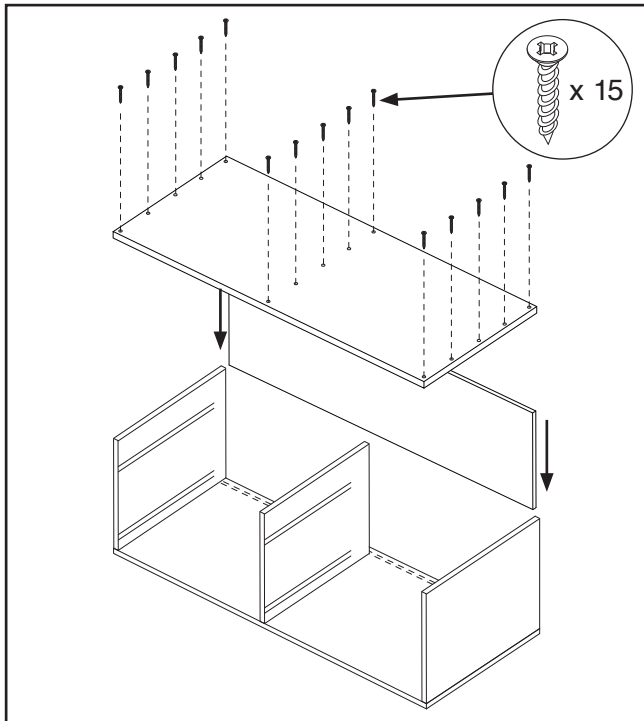

Figure 7. Attaching cabinet back and top.

7. Secure workbench leg crossbars to workbench legs using (8) M4 x 50 tap screws (see **Figure 8**).

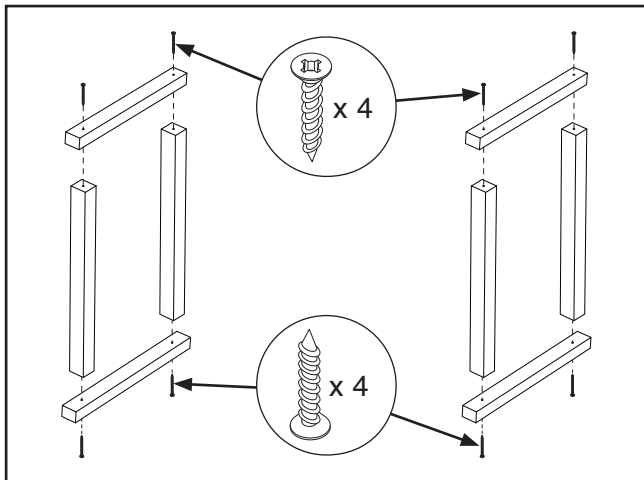

Figure 8. Assembling workbench legs.

8. Position workbench legs approximately 48" apart.
9. Attach drawer cabinet to workbench legs with (8) M8-1.25 x 70 hex bolts and (8) 8mm flat washers (see **Figure 9**). Do not fully tighten.

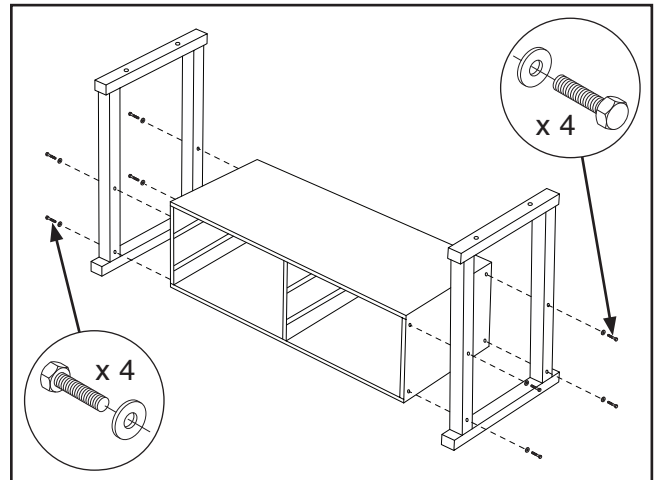

Figure 9. Attaching legs to drawer cabinet.

10. Square workbench frame, then fully tighten fasteners from **Step 9**.
11. Place workbench top onto workbench frame and secure with (4) M8 x 60 lag bolts and (4) 8mm flat washers (see **Figure 10**).

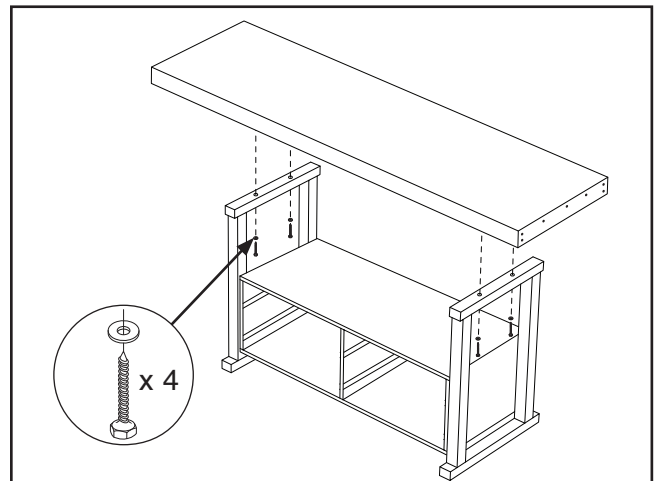

Figure 10. Fastening workbench top to frame.



12. Align drawer slides with slides mounted inside cabinet and push drawers into place (see **Figure 11**).

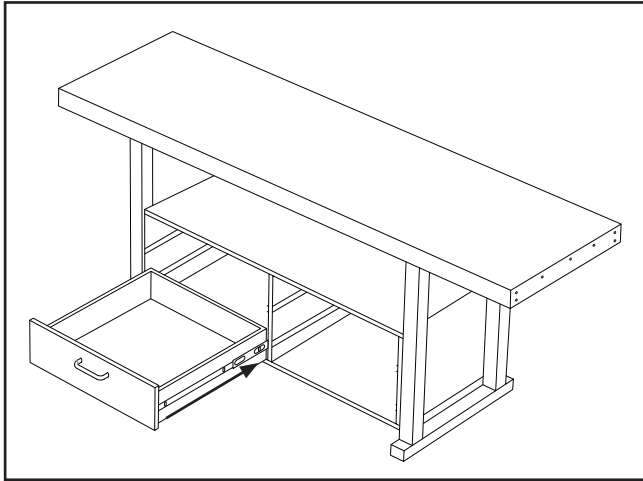

Figure 11. Installing drawers.

13. Repeat **Step 12** for remaining drawers. Complete assembly should resemble **Figure 12**.

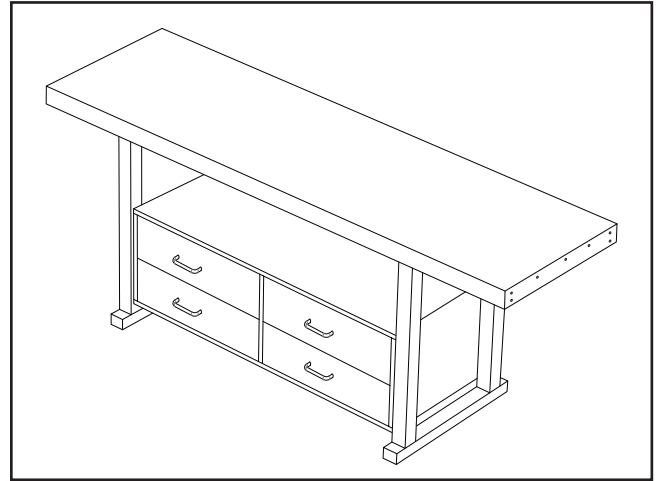
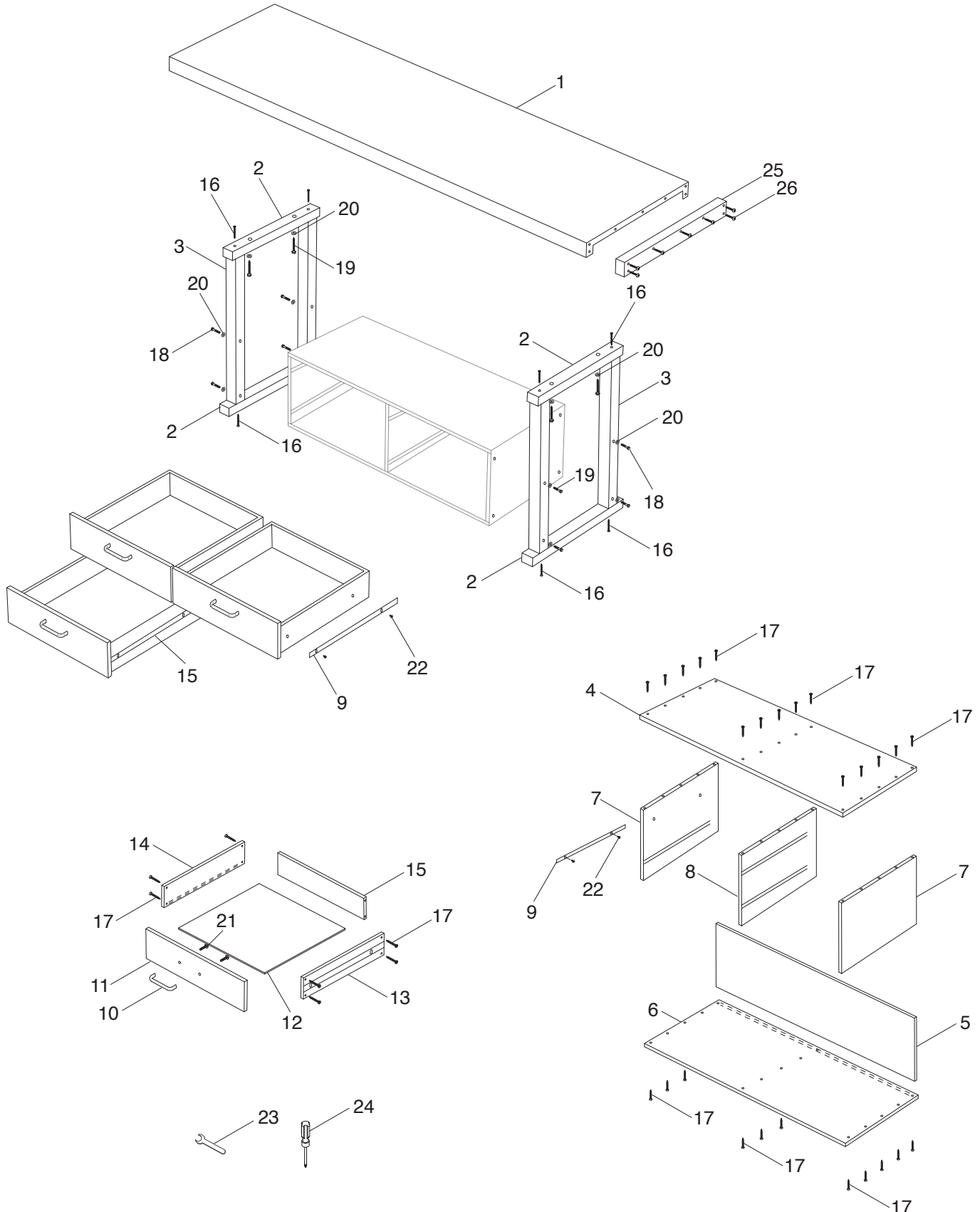

Figure 12. Final assembly.



T34089 Parts Breakdown



Please Note: We do our best to stock replacement parts whenever possible, but we cannot guarantee that all parts shown here are available for purchase. Call (800) 523-4777 or visit our online parts store at www.grizzly.com to check for availability.



T34089 Parts List

REF	PART #	DESCRIPTION
1	PT34089001	WORKBENCH TOP 84" X 26"
2	PT34089002	WORKBENCH LEG CROSSBAR
3	PT34089003	WORKBENCH LEG
4	PT34089004	CABINET TOP PANEL
5	PT34089005	CABINET BACK PANEL
6	PT34089006	CABINET BASE PANEL
7	PT34089007	CABINET SIDE PANEL
8	PT34089008	CABINET MIDDLE PANEL
9	PT34089009	DRAWER SLIDE
10	PT34089010	DRAWER HANDLE
11	PT34089011	DRAWER FRONT PANEL
12	PT34089012	DRAWER BASE PANEL
13	PT34089013	DRAWER RIGHT SIDE PANEL

REF	PART #	DESCRIPTION
14	PT34089014	DRAWER LEFT SIDE PANEL
15	PT34089015	DRAWER BACK PANEL
16	PT34089016	TAP SCREW M4 X 50
17	PT34089017	TAP SCREW M4 X 30
18	PT34089018	HEX BOLT M8-1.25 X 70
19	PT34089019	LAG BOLT M8 X 60
20	PT34089020	FLAT WASHER 8MM
21	PT34089021	PHLP HD SCR M4-.7 X 40
22	PT34089022	TAP SCREW M4 X 12
23	PT34089023	WRENCH 13MM OPEN-END
24	PT34089024	SCREWDRIVER PHILLIPS #2
25	PT34089025	WORKBENCH END CAP
26	PT34089026	TAP SCREW M6 X 50





Buy Direct and Save with Grizzly® – Trusted, Proven and a Great Value!
~Since 1983~

*Visit Our Website Today For
Current Specials!*

**ORDER
24 HOURS A DAY!
1-800-523-4777**

