



For questions or help with this product contact Tech Support at (570) 546-9663 or techsupport@grizzly.com

## MODEL T34090 72" 6-DRAWER BUTCHER BLOCK WORKBENCH INSTRUCTIONS

### Introduction

The T34090 6-Drawer Butcher Block Workbench measures 72" wide, 25" deep, 38" tall and is made of solid hevea wood. This model includes six felt-lined drawers with ball bearing slides, a 1" thick benchtop supported by 2¼" x 2¼" wooden legs, and an integrated wood vise with a 4⅝" clamping capacity.



Figure 1. Model T34090 72" 6-Drawer Butcher Block Workbench.

### Specifications

- Dimensions.....72" W x 31" D x 38" H
- Workbench Top.....72" W x 25"D
- Benchtop Thickness .....3"
- Vise Dimensions ..... 11" W x 3" H
- Vise Capacity ..... 4⅝"
- Top Drawers ..... 13⅞" W x 14¼"D x 2" H
- Middle Drawers..... 13⅞" W x 14¼"D x 4" H
- Bottom Drawers..... 13⅞" W x 14¼"D x 6" H
- Legs..... 2¼" x 2¼"
- Weight .....210 lbs.
- Weight Capacity ..... 1100 lbs.

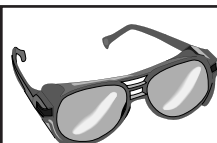

### **!WARNING**

**Wear safety glasses during the entire setup process!**

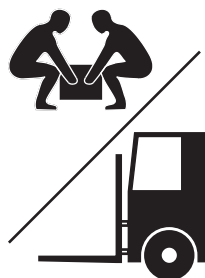

### **!WARNING**

#### **HEAVY LIFT!**

**Straining or crushing injury may occur from improperly lifting workbench or some of its parts. To reduce this risk, get help from other people and use a forklift (or other lifting equipment) rated for weight of this workbench.**

### **!WARNING**

- **Do not exceed weight capacity of workbench.**
- **Do not stand or climb on workbench.**
- **Do not use workbench outdoors or in wet or damp locations.**
- **Do not overload vise or use cheater pipe on vise handles to increase leverage.**
- **Do not weld on workbench.**
- **Do not allow children to have unsupervised access to workbench.**

COPYRIGHT © MARCH, 2024 BY GRIZZLY INDUSTRIAL, INC.  
**NO PORTION OF THIS MANUAL MAY BE REPRODUCED IN ANY SHAPE  
OR FORM WITHOUT THE WRITTEN APPROVAL OF GRIZZLY INDUSTRIAL, INC.**  
(FOR MODELS MFD. SINCE 11/23) #JA23078 PRINTED IN CHINA

V1.03.24

**\*\*\*Keep for Future Reference\*\*\***

## Inventory

### Main (Figure 2)

|                                       | Qty |
|---------------------------------------|-----|
| A. Workbench Top .....                | 1   |
| B. Crossbeams .....                   | 2   |
| C. Workbench Legs .....               | 2   |
| D. Vise Head .....                    | 1   |
| E. Vise Leadscrew Assembly .....      | 1   |
| F. Cabinet Top Panel .....            | 1   |
| G. Cabinet Side Panels w/Slides ..... | 2   |
| H. Cabinet Back Panel .....           | 1   |
| I. Cabinet Base Panel .....           | 1   |
| J. Drawer Handles .....               | 6   |
| K. Small Drawer Front Panels .....    | 2   |
| L. Small Drawer Left Panels .....     | 2   |
| M. Small Drawer Right Panels .....    | 2   |
| N. Small Drawer Back Panels .....     | 2   |
| O. Medium Drawer Front Panels .....   | 2   |
| P. Medium Drawer Left Panels .....    | 2   |
| Q. Medium Drawer Right Panels .....   | 2   |
| R. Medium Drawer Back Panels .....    | 2   |
| S. Large Drawer Front Panels .....    | 2   |
| T. Large Drawer Left Panels .....     | 2   |
| U. Large Drawer Right Panels .....    | 2   |
| V. Large Drawer Back Panels .....     | 2   |
| W. Drawer Base Panels .....           | 6   |

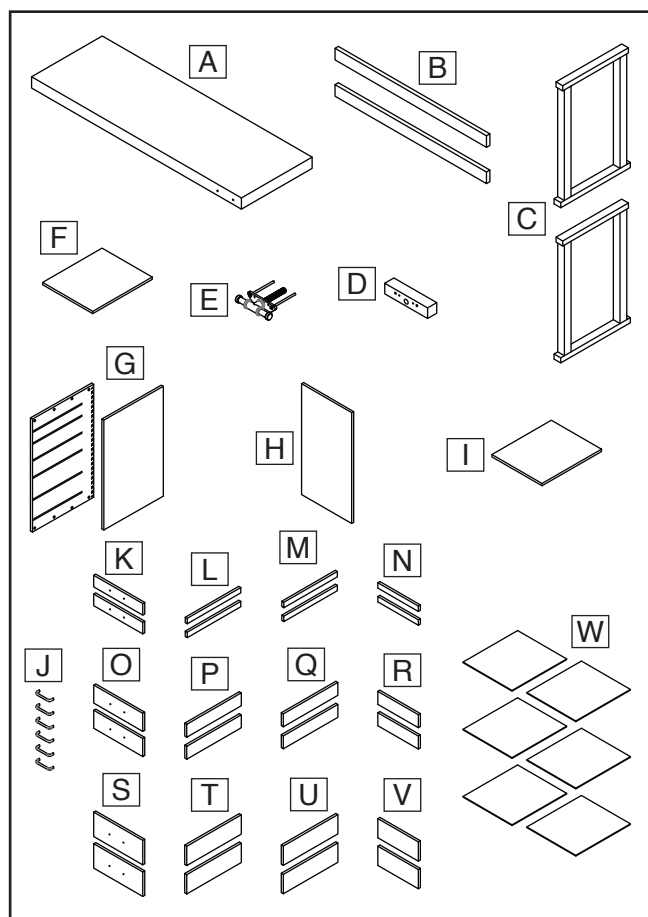

Figure 2. Inventory.

### Fasteners (Figure 3)

|   | Qty   |
|---|-------|
| X. Tap Screws M4 x 30 .....                     | 66    |
| Y. Hex Bolts M12-1.75 x 120 .....               | 4     |
| Z. Lag Bolts M8 x 50 .....                      | 4     |
| AA. Lag Bolts M8 x 60 .....                     | 4     |
| AB. Phillips Head Screws M4-.7 x 40 .....       | 12    |
| AC. Flat Washers 8mm .....                      | 8     |
| AD. Flat Washers 12mm .....                     | 4     |
| AE. Tap Screws M4 x 12 .....                    | 32    |
| AF. Corner Braces .....                         | 8     |
| AG. Hex Bolts M8-1.25 x 15 .....                | 2     |
| AH. Tap Screws M6 x 30 .....                    | 4     |
| AI. Hex Nuts M12-1.75 .....                     | 4     |
| AJ. Fender Washers 8mm .....                    | 2     |
| AK. Phillips Head Screwdriver #2 .....          | 1     |
| AL. Open-End Wrenches<br>12, 13, 17, 19mm ..... | 1 Ea. |

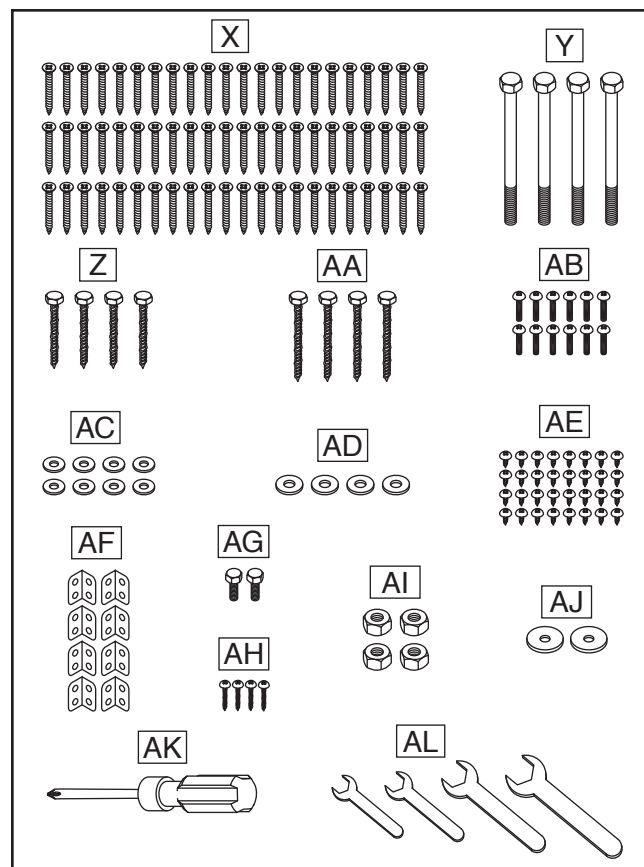

Figure 3. Fasteners and tools.

## NOTICE

If you cannot find an item on this list, check the mounting location or examine the packaging materials carefully. Some items are pre-installed for shipping purposes.



## Assembly



**! WARNING**  
Wear safety glasses during  
the entire setup process!

### Needed for Assembly

- Additional Person ..... 1
- Safety Glasses (for each person).....1 Pr.
- Square ..... 1

### To assemble workbench:

1. Position (1) right and (1) left small drawer side panel against (1) small drawer back panel and secure with (2) corner braces and (8) M4 x 12 tap screws (see **Figure 4**).

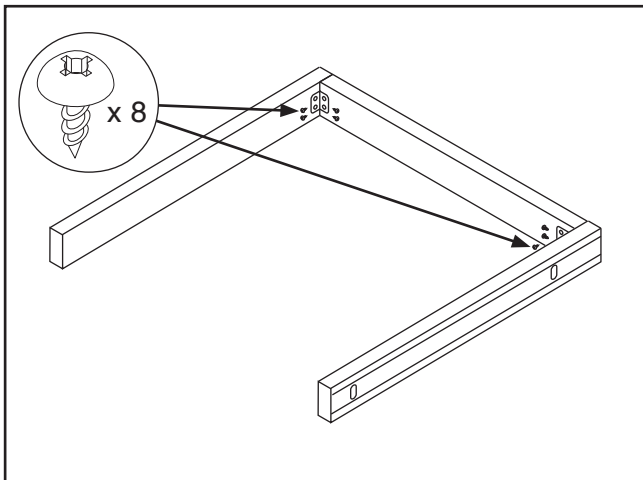

**Figure 4.** Attaching drawer sides to back panel.

2. Slide (1) drawer base panel into slots in drawer side panels, and attach (1) drawer front panel using (2) corner braces, and (8) M4 x 12 tap screws (see **Figure 5**).
3. Attach (1) handle to drawer front panel with (2) M4-.7 x 40 Phillips head screws, as shown in **Figure 5**.

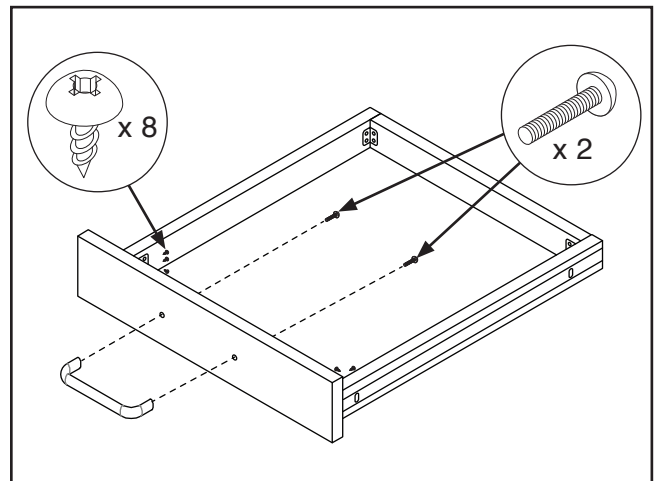

**Figure 5.** Assembling drawer base panel, front panel, and handle.

4. Position (1) right and (1) left medium drawer side panel against (1) medium drawer back panel, and secure with (4) M4 x 30 tap screws, as shown in **Figure 6**.

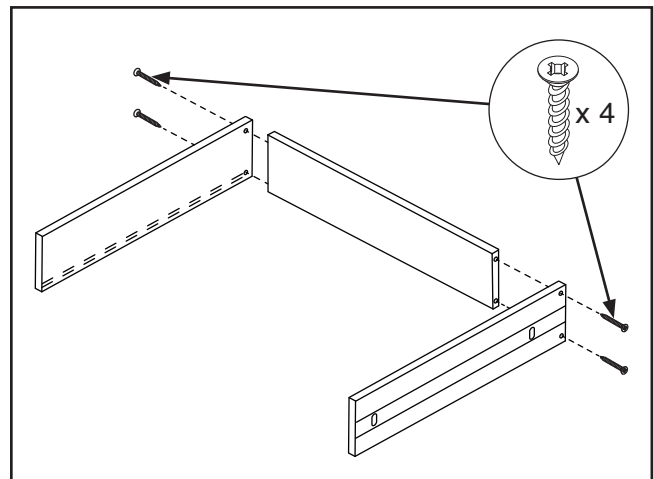

**Figure 6.** Attaching medium drawer sides and back panel.



5. Slide (1) medium drawer base panel into slots in drawer side panels, then attach (1) medium drawer front panel using (4) M4 x 30 tap screws (see **Figure 7**).

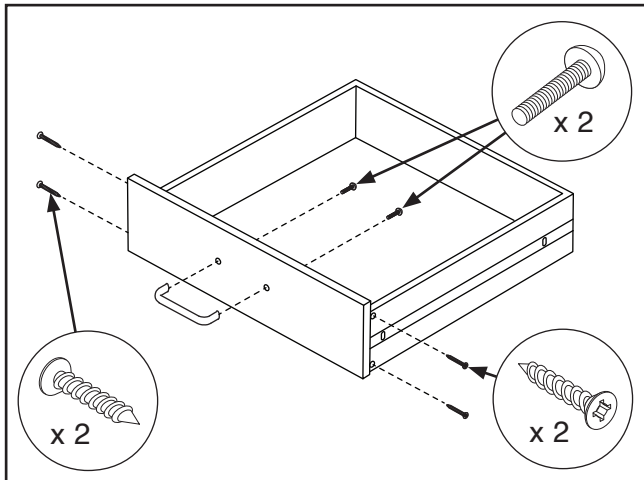

**Figure 7.** Installing medium drawer base panel, front panel, and handle.

6. Repeat **Steps 4–5** for large drawers using (16) M4 x 30 tap screws for each drawer.
7. Secure cabinet side panels to cabinet base panel using (8) M4 x 30 tap screws, as shown in **Figure 8**.

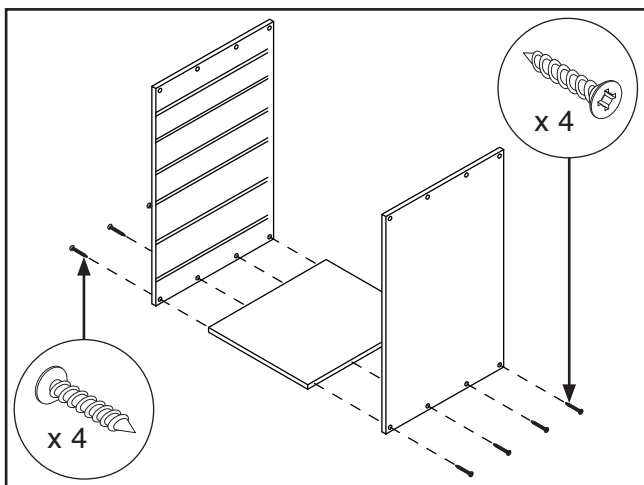

**Figure 8.** Securing cabinet side panels to cabinet base panel.

8. Slide cabinet back panel into grooves in cabinet base and side panels (see **Figure 9**).

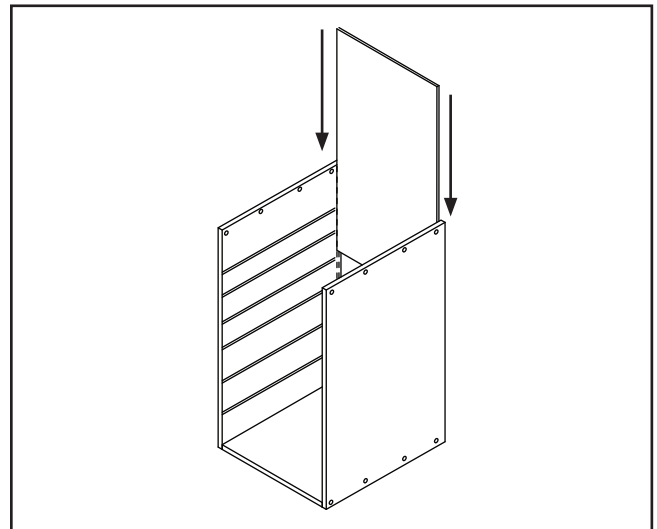

**Figure 9.** Attaching cabinet back panel.

9. Slide groove in cabinet top panel onto top edge of cabinet back panel and secure with (8) M4 x 30 tap screws, as shown in **Figure 10**.

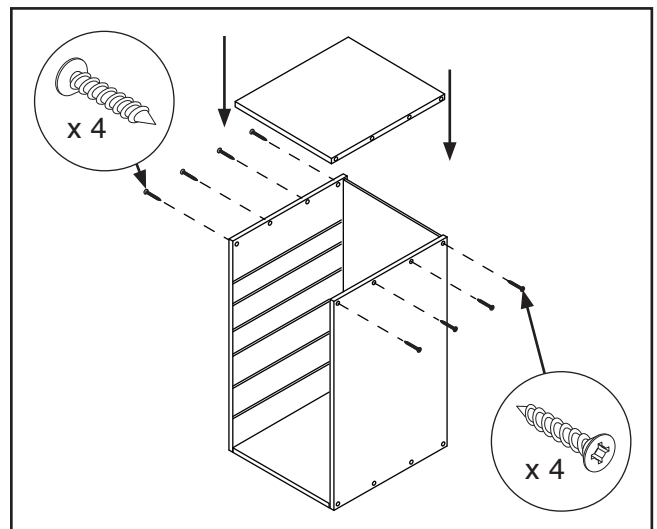

**Figure 10.** Securing cabinet top panel.



10. Position workbench legs approximately 54" apart (see **Figure 11**).
11. Secure crossbeams to table legs using (4) M12-1.75 x 120 hex bolts, (4) 12mm flat washers, and (4) M12-1.75 hex nuts (see **Figure 11**). Do not fully tighten.

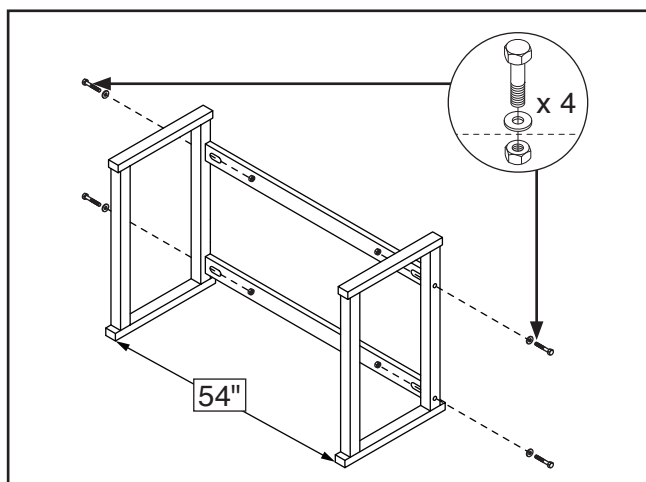

**Figure 11.** Fastening crossbeams to legs.

12. Square workbench frame and fully tighten fasteners from **Step 11**.
13. Place workbench top onto workbench frame and secure with (4) M8 x 60 lag bolts and (4) 8mm flat washers (see **Figure 12**).

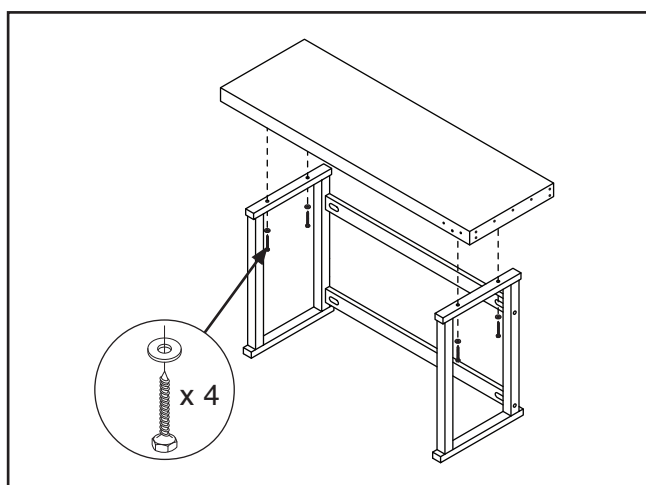

**Figure 12.** Fastening workbench top to frame.

14. Fasten drawer cabinet to workbench top with (4) M8 x 50 lag bolts and (4) 8mm flat washers, as shown in **Figure 13**.
15. Fasten drawer cabinet to left workbench leg with (2) M4 x 30 tap screws (see **Figure 13**).

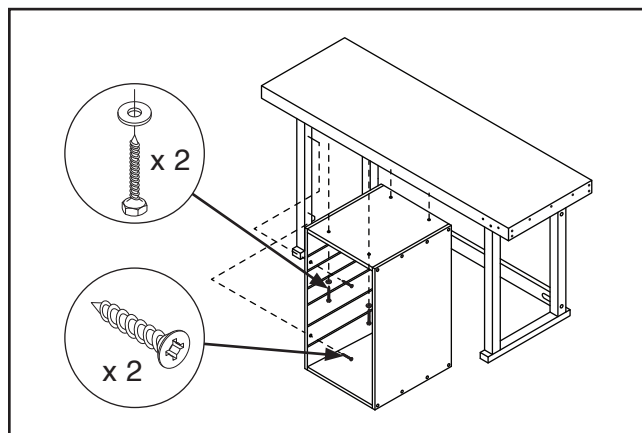

**Figure 13.** Fastening cabinet to workbench top and leg.

16. Align drawer slides on top drawer with slides inside cabinet, then push in until drawers click into place (see **Figure 14**).

**Note:** Ball bearing strips are delicate. Ensure cabinet slides and drawer slides are properly aligned prior to installation to avoid damaging bearing strips.

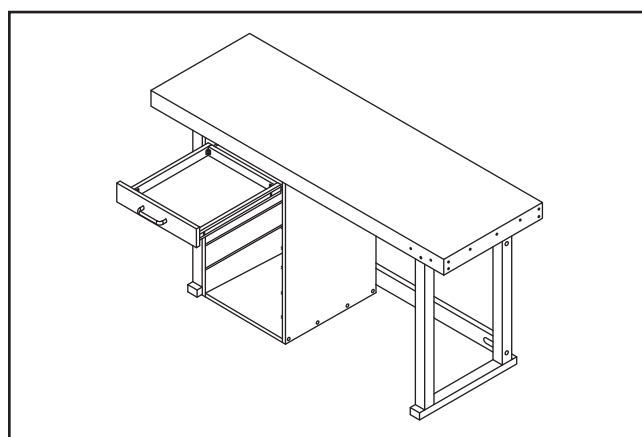

**Figure 14.** Installing drawers.



17. Repeat **Step 16** for all remaining drawers.

**IMPORTANT:** Ensure drawers are installed in descending order, with small drawers on top and large drawers on bottom.

18. Feed vise leadscrew assembly through vise head and attach with (4) M6 x 30 tap screws (see **Figure 15**).

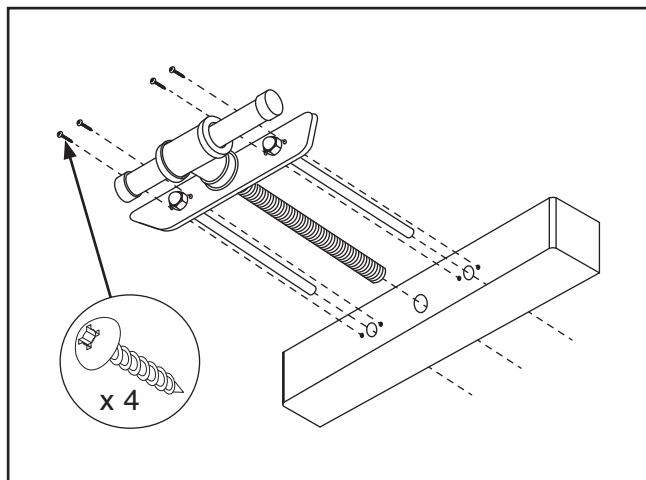

**Figure 15.** Assembling vise components.

19. Insert vise assembly into holes in front right side of workbench, as shown in **Figure 16**.

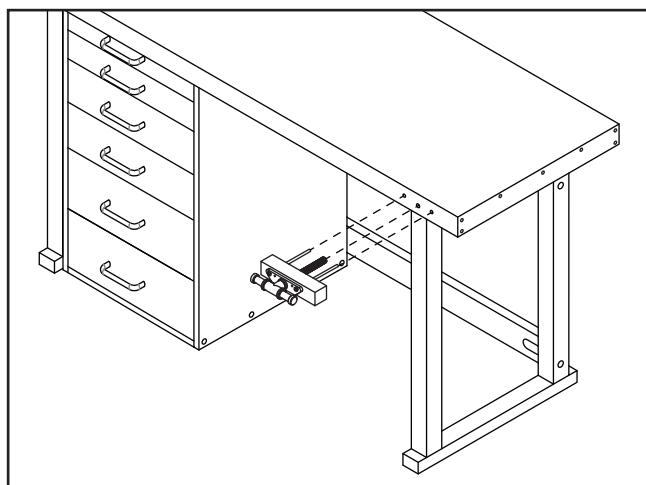

**Figure 16.** Assembling vise components.

20. Thread vise through leadscrew plate and tighten until vise head makes contact with workbench.

21. Install (2) M8-1.25 x 16 hex bolts and (2) 8mm fender washers on back of vise rods (see **Figure 17**).

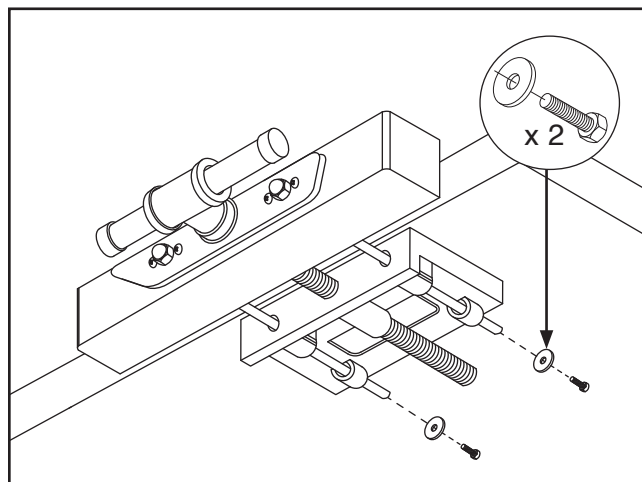

**Figure 17.** Installing vise assembly.

22. Completed vise installation should resemble **Figure 18**. Test vise range of motion by turning handle counterclockwise to open and clockwise to close.

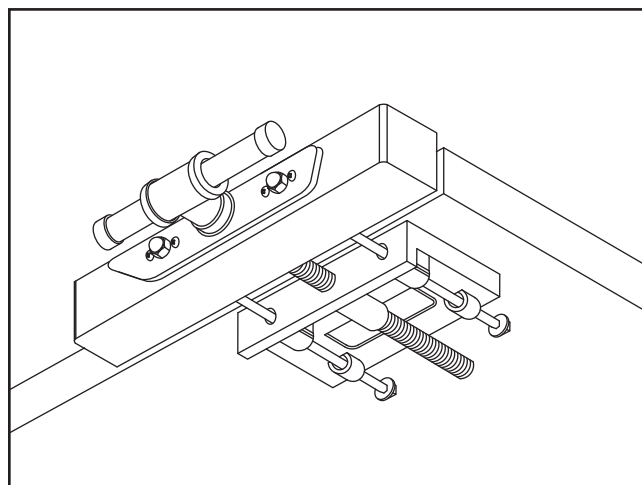
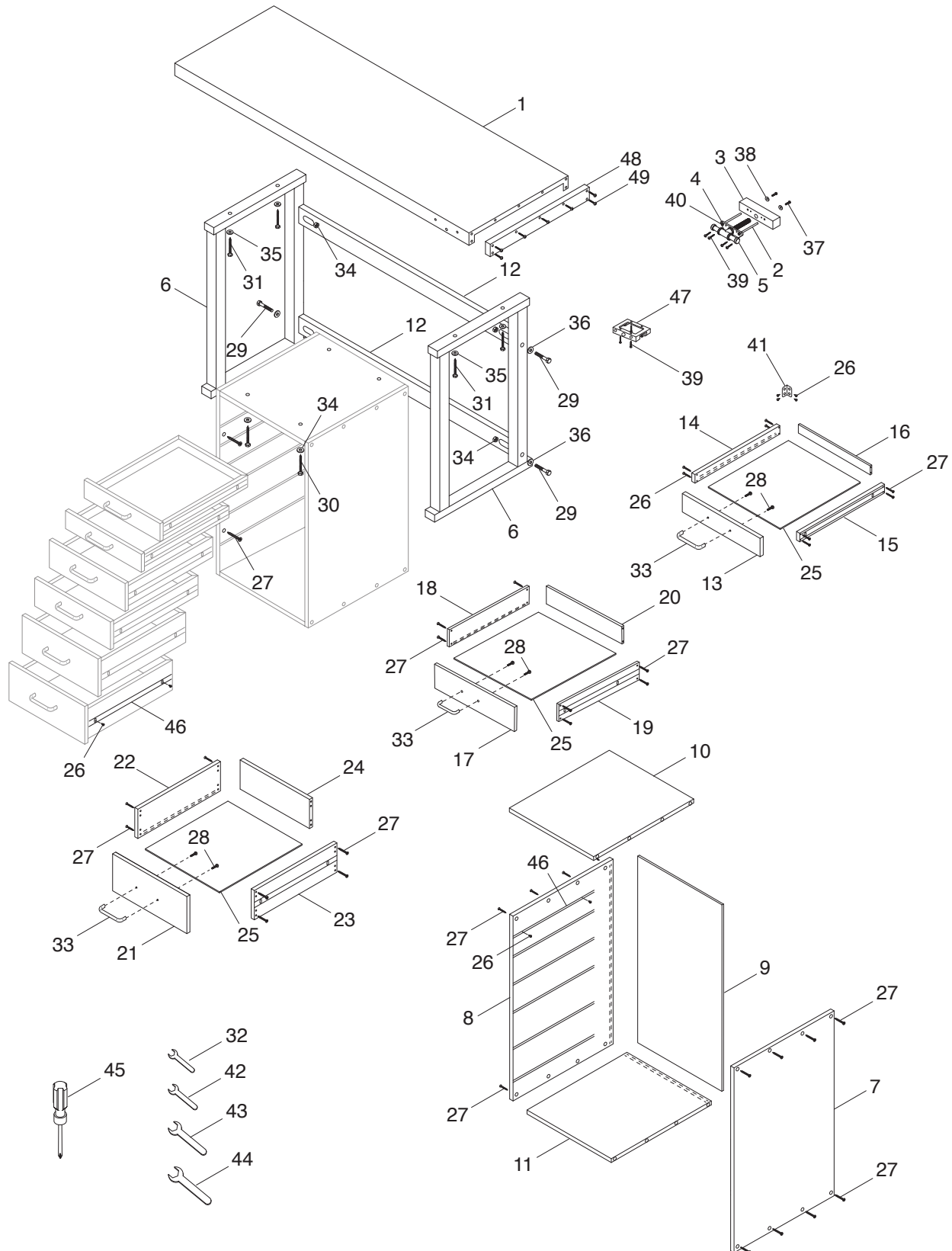

**Figure 18.** Vise assembly installed.





# T34090 Parts Breakdown



**Please Note:** We do our best to stock replacement parts whenever possible, but we cannot guarantee that all parts shown here are available for purchase. Call (800) 523-4777 or visit our online parts store at [www.grizzly.com](http://www.grizzly.com) to check for availability.

Model T34090 (Mfd. Since 11/23)



**BUY PARTS ONLINE AT GRIZZLY.COM!**  
Scan QR code to visit our Parts Store.



# T34090 Parts List

| REF | PART #     | DESCRIPTION                  |
|-----|------------|------------------------------|
| 1   | PT34090001 | WORKBENCH TOP                |
| 2   | PT34090002 | WISE ROD M12-1.75 X 25, 330L |
| 3   | PT34090003 | WISE HEAD                    |
| 4   | PT34090004 | WISE LEADSCREW W/PLATE       |
| 5   | PT34090005 | WISE HANDLE, WOOD            |
| 6   | PT34090006 | LEG ASSEMBLY                 |
| 7   | PT34090007 | CABINET RIGHT SIDE PANEL     |
| 8   | PT34090008 | CABINET LEFT SIDE PANEL      |
| 9   | PT34090009 | CABINET BACK PANEL           |
| 10  | PT34090010 | CABINET TOP PANEL            |
| 11  | PT34090011 | CABINET BOTTOM PANEL         |
| 12  | PT34090012 | CROSSBEAM                    |
| 13  | PT34090013 | SMALL DRAWER FRONT PANEL     |
| 14  | PT34090014 | SMALL DRAWER LEFT PANEL      |
| 15  | PT34090015 | SMALL DRAWER RIGHT PANEL     |
| 16  | PT34090016 | SMALL DRAWER BACK PANEL      |
| 17  | PT34090017 | MEDIUM DRAWER FRONT PANEL    |
| 18  | PT34090018 | MEDIUM DRAWER LEFT PANEL     |
| 19  | PT34090019 | MEDIUM DRAWER RIGHT PANEL    |
| 20  | PT34090020 | MEDIUM DRAWER BACK PANEL     |
| 21  | PT34090021 | LARGE DRAWER FRONT PANEL     |
| 22  | PT34090022 | LARGE DRAWER LEFT PANEL      |
| 23  | PT34090023 | LARGE DRAWER RIGHT PANEL     |
| 24  | PT34090024 | LARGE DRAWER BACK PANEL      |
| 25  | PT34090025 | DRAWER BOTTOM PANEL          |

| REF | PART #     | DESCRIPTION                 |
|-----|------------|-----------------------------|
| 26  | PT34090026 | TAP SCREW M4 X 12           |
| 27  | PT34090027 | TAP SCREW M4 X 30           |
| 28  | PT34090028 | PHLP HD SCR M4-.7 X 40      |
| 29  | PT34090029 | HEX BOLT M12-1.75 X 120     |
| 30  | PT34090030 | LAG BOLT M8 X 50            |
| 31  | PT34090031 | LAG BOLT M8 X 60            |
| 32  | PT34090032 | WRENCH 12MM OPEN-END        |
| 33  | PT34090033 | DRAWER HANDLE               |
| 34  | PT34090034 | HEX NUT M12-1.75            |
| 35  | PT34090035 | FLAT WASHER 8MM             |
| 36  | PT34090036 | FLAT WASHER 12MM            |
| 37  | PT34090037 | HEX BOLT M8-1.25 X 15       |
| 38  | PT34090038 | FENDER WASHER 8MM           |
| 39  | PT34090039 | TAP SCREW M6 X 30           |
| 40  | PT34090040 | ACORN NUT M12-1.75          |
| 41  | PT34090041 | SMALL DRAWER CORNER BRACKET |
| 42  | PT34090042 | WRENCH 13MM OPEN-END        |
| 43  | PT34090043 | WRENCH 17MM OPEN-END        |
| 44  | PT34090044 | WRENCH 19MM OPEN-END        |
| 45  | PT34090045 | SCREWDRIVER PHILLIPS #2     |
| 46  | PT34090046 | DRAWER SLIDE                |
| 47  | PT34090047 | WISE LEADSCREW PLATE        |
| 48  | PT34090048 | WORKBENCH TRIM              |
| 49  | PT34090049 | TAP SCREW M6 X 50           |

