



For questions or help with this product contact Tech Support at (570) 546-9663 or techsupport@grizzly.com

MODEL T34093 80" EURO-STYLE WORKBENCH w/CABINET INSTRUCTIONS

Introduction

The T34093 Euro-Style Butcher Block Workbench with Cabinet measures 80" wide, 30" deep, 34 $\frac{1}{4}$ " tall and is made of solid hevea wood. This model includes a large storage cabinet and a 1 $\frac{1}{8}$ " thick benchtop supported by 2 $\frac{1}{4}$ " x 2 $\frac{1}{4}$ " wooden legs. The workbench also includes a 66"W x 7 $\frac{3}{4}$ "D tool well, an integrated side vise with 12" clamping capacity, a front vise with 4 $\frac{5}{8}$ " clamping capacity, and a built-in storage shelf.



Figure 1. T34093 Euro-Style Butcher Block Workbench w/Cabinet.

Specifications

- Dimensions..... 80" W x 30" D x 34" H
- Workbench Top..... 75" W x 24 $\frac{1}{4}$ " D x 1 $\frac{1}{8}$ " H
- Tool Tray..... 66" W x 7 $\frac{3}{4}$ " D x 2 $\frac{5}{8}$ " H
- Side Vise Dimensions 9 $\frac{1}{2}$ " W x 3 $\frac{3}{4}$ " H
- Side Vise Capacity 12"
- Front Vise Dimensions 19 $\frac{1}{4}$ " W x 3 $\frac{3}{4}$ " H
- Front Vise Capacity 4 $\frac{5}{8}$ "
- Legs..... 2 $\frac{1}{4}$ " W x 2 $\frac{1}{4}$ " D
- Weight 205 lbs.
- Weight Capacity 1100 lbs.

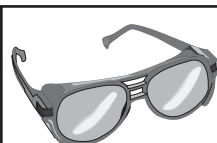

! WARNING

Wear safety glasses during the entire setup process!

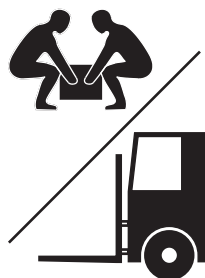

! WARNING

HEAVY LIFT!

Straining or crushing injury may occur from improperly lifting workbench or some of its parts. To reduce this risk, get help from other people and use a forklift (or other lifting equipment) rated for weight of this workbench.

! WARNING

- Do not exceed weight capacity of workbench.
- Do not stand or climb on workbench.
- Do not use workbench outdoors or in wet or damp locations.
- Do not overload vise or use cheater pipe on vise handles to increase leverage.
- Do not weld on workbench.
- Do not allow children to have unsupervised access to workbench.

COPYRIGHT © MARCH, 2024 BY GRIZZLY INDUSTRIAL, INC.
**NO PORTION OF THIS MANUAL MAY BE REPRODUCED IN ANY SHAPE
OR FORM WITHOUT THE WRITTEN APPROVAL OF GRIZZLY INDUSTRIAL, INC.**
(FOR MODELS MFD. SINCE 11/23) #JA23086 PRINTED IN CHINA

V1.03.24

*****Keep for Future Reference*****

Inventory

Main (Figure 2)	Qty
A. Workbench Top	1
B. Bench Dogs.....	2
C. Vise Head.....	1
D. Vise Leadscrew Assembly	1
E. Cross Beams.....	4
F. Cabinet Top Panel.....	1
G. Cabinet Side Panel, Left.....	1
H. Cabinet Side Panel, Right	1
I. Cabinet Back Panel.....	1
J. Cabinet Middle Panel	1
K. Cabinet Base & Front Panel Assembly	1
L. Handle	1
M. Workbench Legs (Left and Right)	1 Ea.

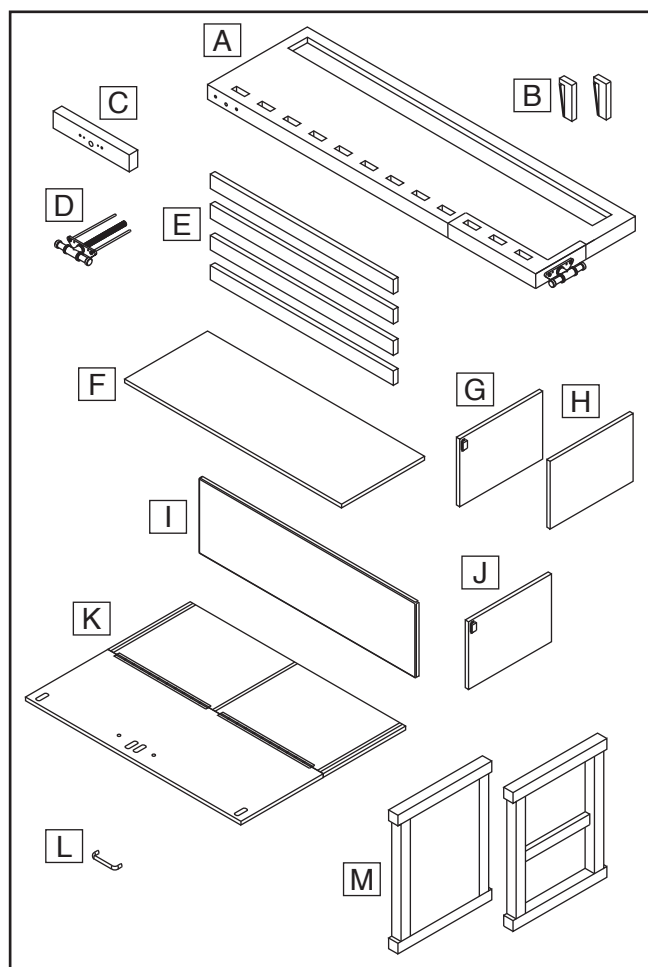

Figure 2. Main inventory.

Fasteners & Tools (Figure 3)	Qty
N. Hex Bolts M12-1.75 x 120	8
O. Flat Washers 12mm	8
P. Lag Bolts M8 x 80	4
Q. Hex Nuts M12-1.75	8
R. Door Supports (Left and Right)	1 Ea.
S. Flat Washers 8mm	4
T. Hex Bolts M8-1.25 x 15	2
U. Tap Screws M4 x 30.....	26
V. Fender Washers 8mm.....	2
W. Tap Screws M6 x 30.....	4
X. Flange Screws M4-.7 x 22.....	2
Y. Tap Screws M4 x 12.....	8
Z. Open-End Wrenches 12, 13, 17, 19mm	1 Ea.
AA. Phillips Head Screwdriver #2.....	1

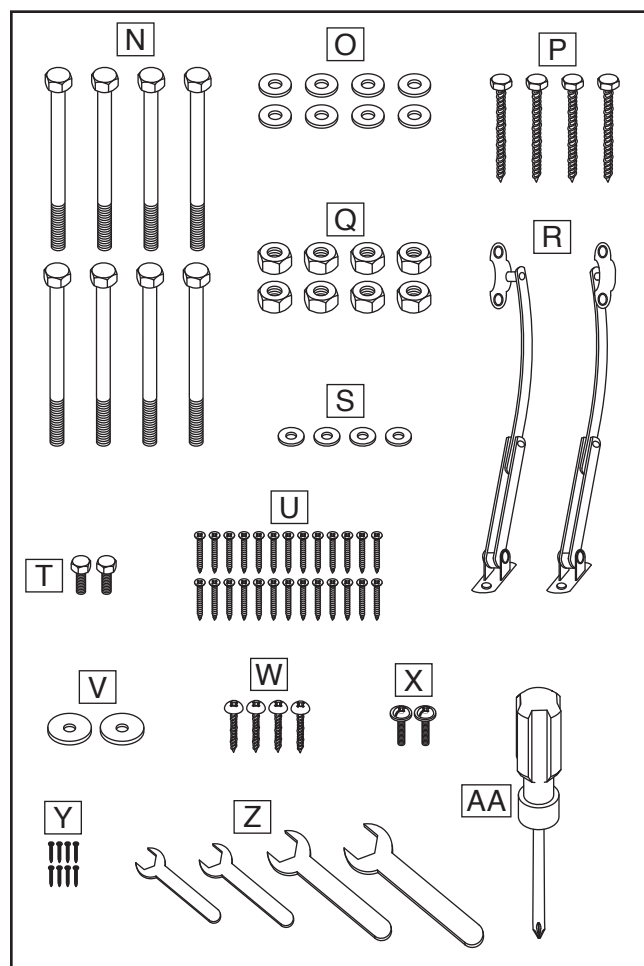

Figure 3. Fasteners and tools.

NOTICE

If you cannot find an item on this list, check the mounting location or examine the packaging materials carefully. Some items are pre-installed for shipping purposes.



Assembly



Needed for Assembly

- Additional Person 1
- Safety Glasses (for each person).....1 Pr.
- Square 1

To assemble workbench:

1. Position workbench legs roughly 48 inches apart, as shown in **Figure 4**.

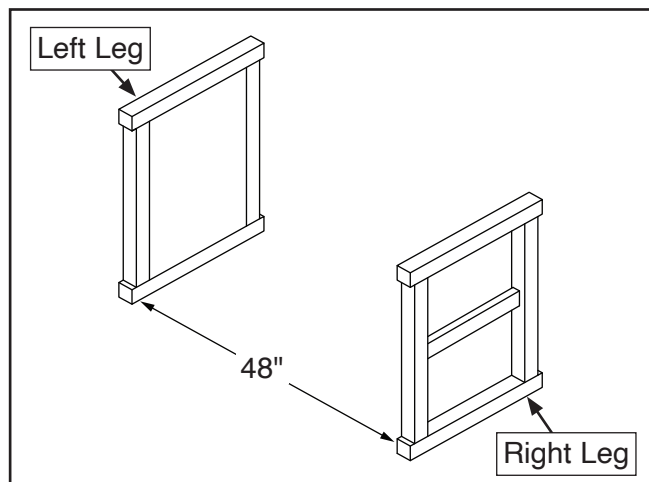

Figure 4. Positioning workbench legs.

2. Attach (4) cross beams to workbench legs with (8) M12-1.75 x 120 hex bolts, (8) 12mm flat washers, and (8) M12-1.75 hex nuts (see **Figure 5**). Do not fully tighten.

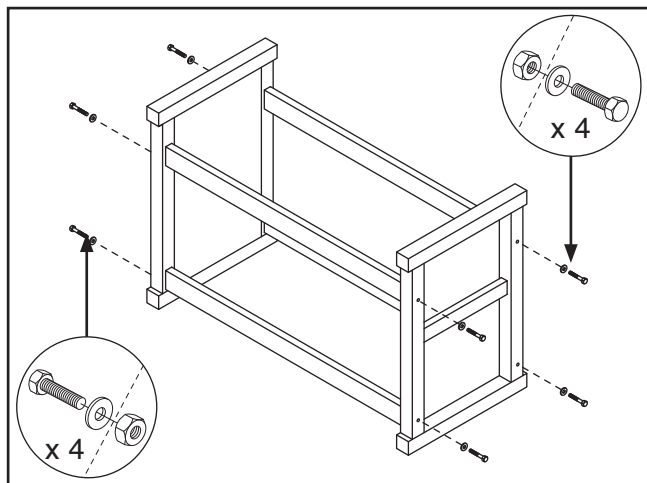

Figure 5. Attaching cross beams.

3. Square workbench frame and fully tighten fasteners from **Step 2**.
4. Lay cabinet base and front panel assembly on a flat protected surface with magnet strips and hinges facing up (see **Figure 6**).

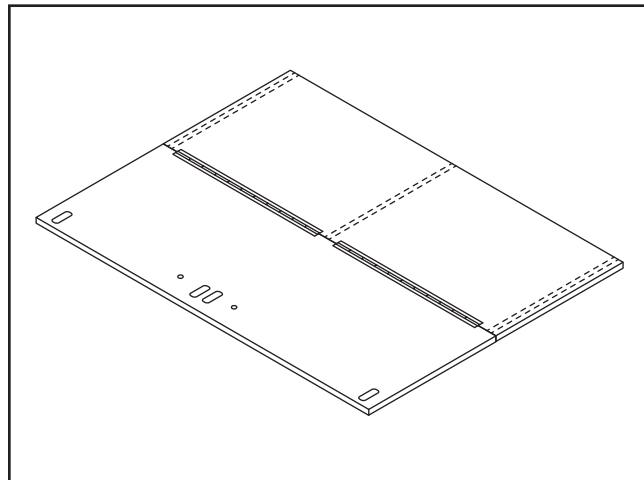

Figure 6. Cabinet base and front panel assembly.

5. Slide cabinet side panels and cabinet middle panel into grooves on cabinet base panel, and secure using (12) M4 x 30 tap screws, as shown in **Figure 7**.

Note: Ensure magnets on side and middle cabinet panels are facing outward and make full contact with magnet strips on front cabinet panel when closed.

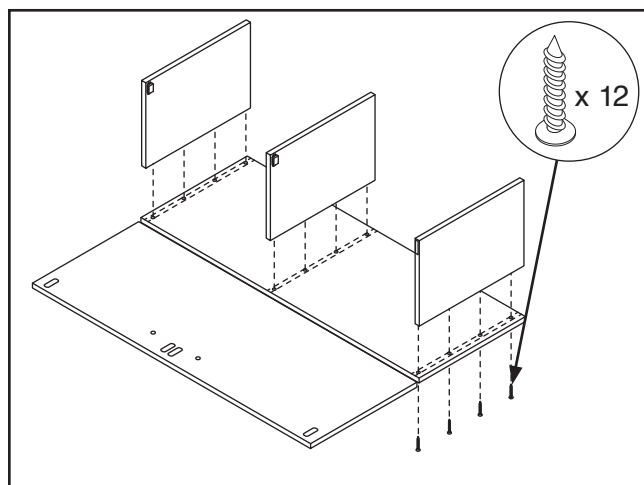

Figure 7. Attaching cabinet side panels, and middle panel to base panel.



6. Slide cabinet back panel into grooves on cabinet side and base panels and attach cabinet top panel with (12) M4 x 30 tap screws, as shown in **Figure 8**.

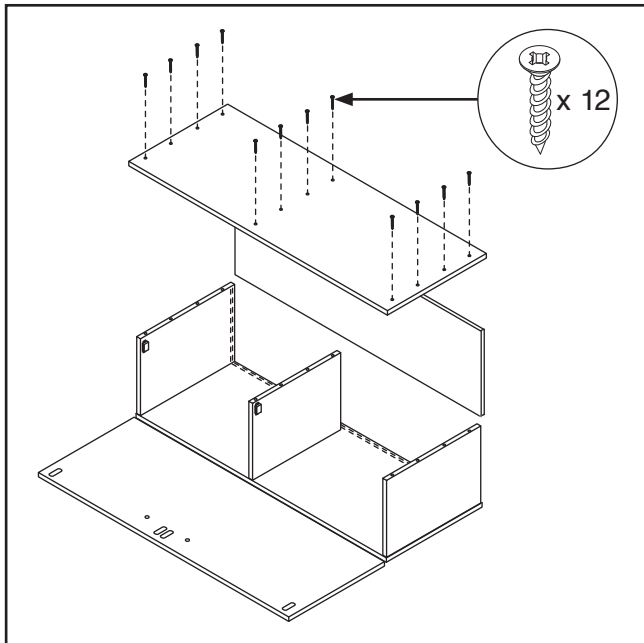

Figure 8. Attaching cabinet back and top panels.

7. Place cabinet assembly between cross beams of workbench frame, then open cabinet front panel and fasten cabinet to workbench legs using (2) M4 x 30 tap screws (see **Figure 9**).

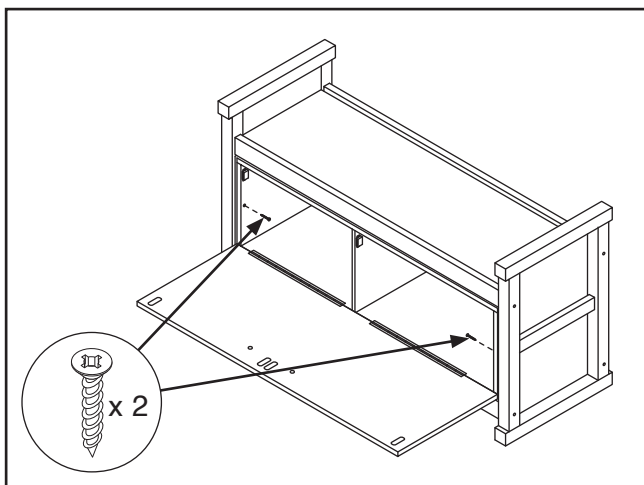

Figure 9. Attaching cabinet to workbench frame.

8. Position left door support on left side of cabinet and fasten to cabinet side and front panels using (4) M4 x 12 tap screws, as shown in **Figure 10**.

9. Repeat **Step 8** for right door support on right side.

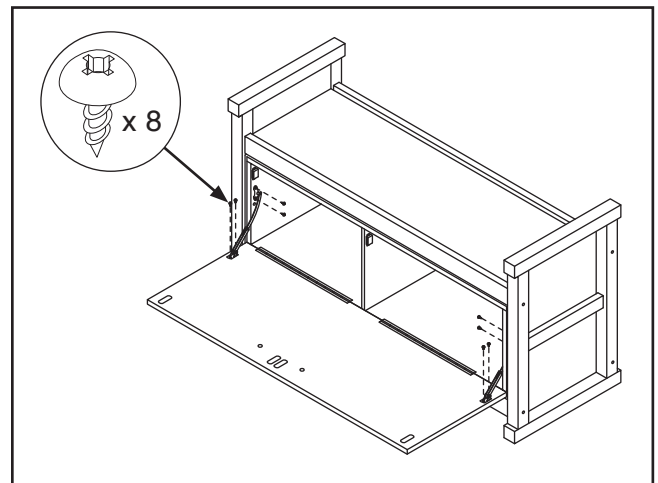

Figure 10. Attaching cabinet limiters.

10. Attach handle to cabinet front panel using (2) M4-7 x 22 flange screws (see **Figure 11**), then close cabinet to test limiter range of motion.

11. Place workbench top onto workbench frame and secure with (4) M8 x 80 lag bolts and (4) 8mm flat washers, as shown in **Figure 11**.

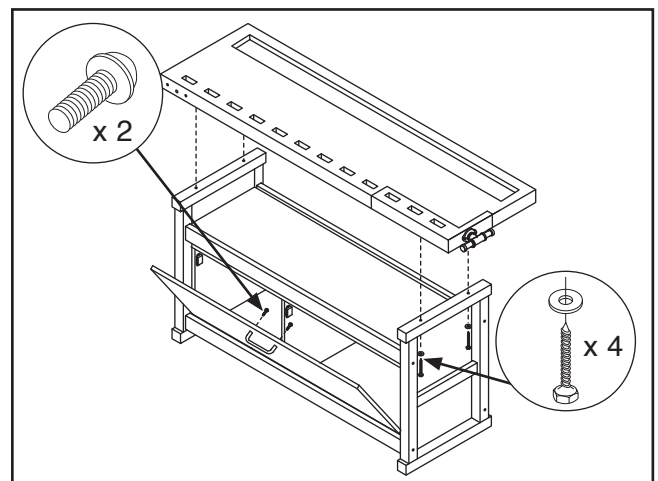

Figure 11. Attaching workbench top and handle.



12. Feed front vise leadscrew assembly through front vise head and attach with (4) M6 x 30 tap screws (see **Figure 12**).

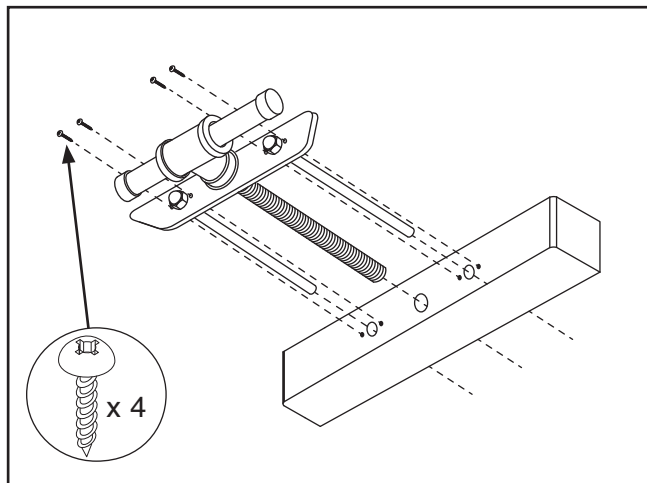

Figure 12. Assembling vise components.

13. Insert front vise assembly through holes in front left side of workbench, as shown in **Figure 13**.

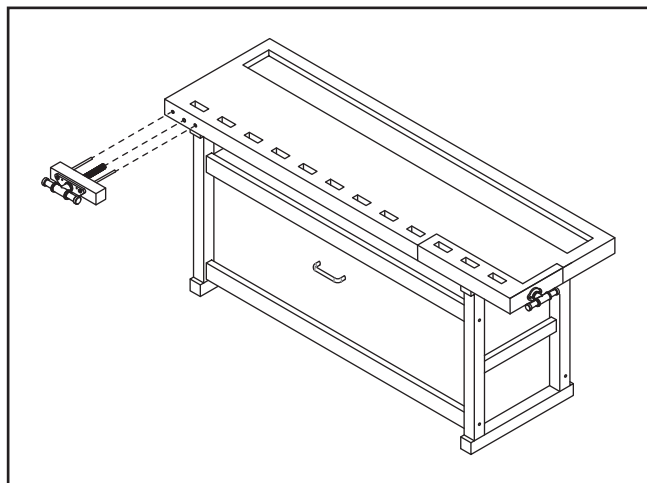

Figure 13. Installing vise components.

14. Thread vise through leadscrew plate and tighten until vise head makes contact with workbench (see **Figure 14**).

15. Install (2) M8-1.25 x 15 hex bolts and (2) 8mm fender washers in back of vise rods (see **Figure 14**).

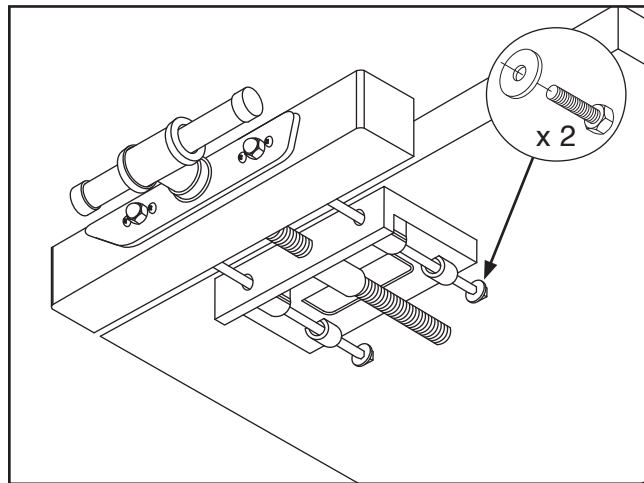

Figure 14. Installing vise assembly.

16. Completed vise installation should resemble **Figure 15**. Test vise range of motion by turning handle counterclockwise to open and clockwise to close.

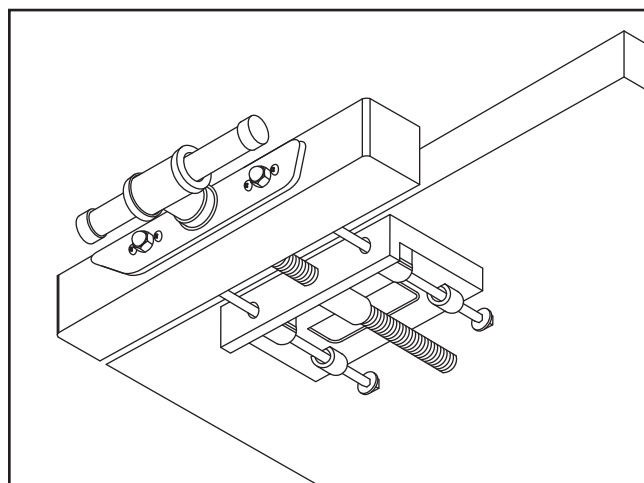
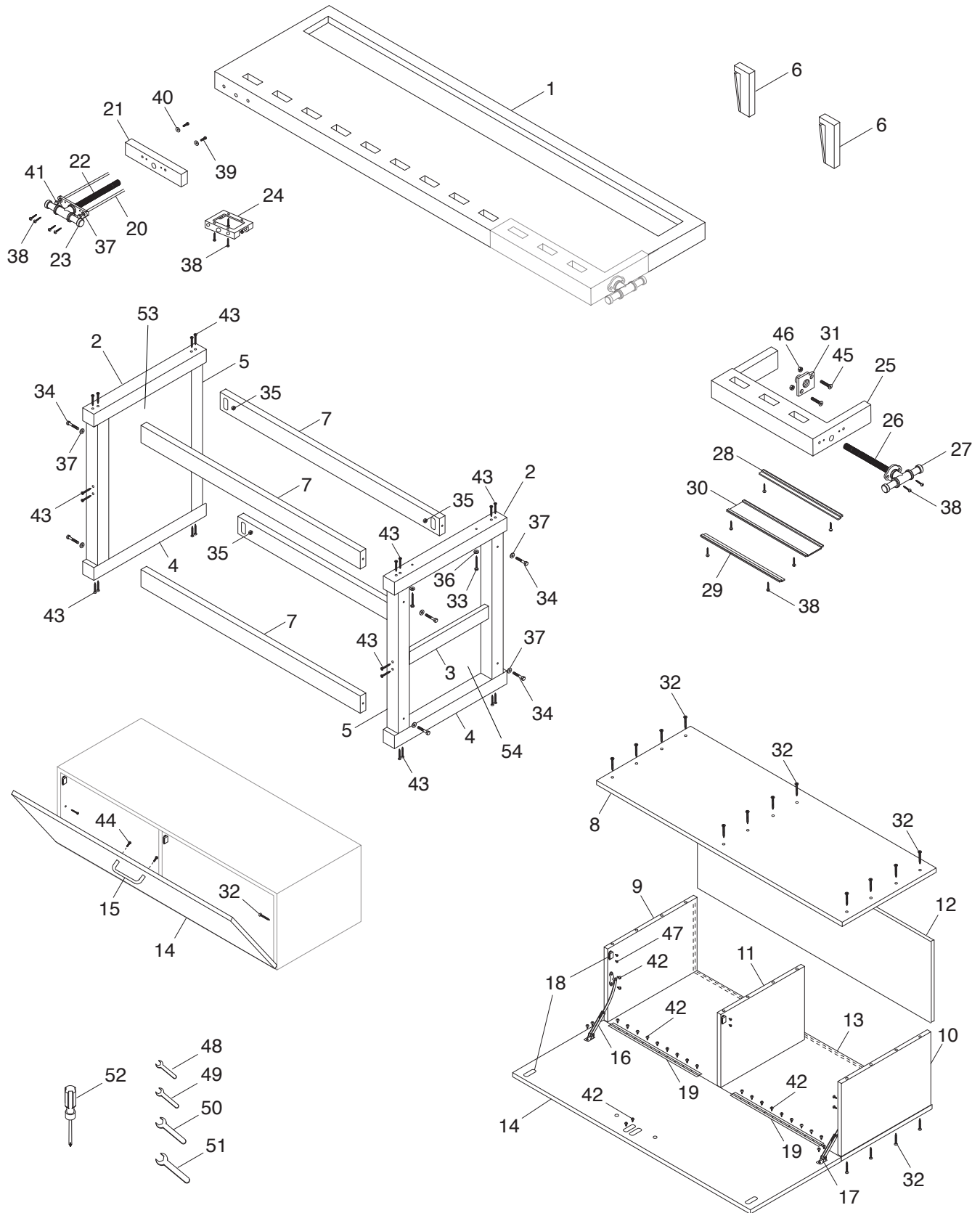

Figure 15. Vise assembly installed.



T34093 Parts Breakdown



Please Note: We do our best to stock replacement parts whenever possible, but we cannot guarantee that all parts shown here are available for purchase. Call (800) 523-4777 or visit our online parts store at www.grizzly.com to check for availability.



T34093 Parts List

REF	PART #	DESCRIPTION
1	PT34093001	WORKBENCH TOP
2	PT34093002	LEG CROSSBAR, TOP
3	PT34093003	LEG CROSSBAR, MIDDLE
4	PT34093004	LEG CROSSBAR, BOTTOM
5	PT34093005	WORKBENCH LEG
6	PT34093006	BENCH DOG
7	PT34093007	CROSS BEAM
8	PT34093008	CABINET TOP PANEL
9	PT34093009	CABINET SIDE PANEL, LEFT
10	PT34093010	CABINET SIDE PANEL, RIGHT
11	PT34093011	CABINET MIDDLE PANEL
12	PT34093012	CABINET BACK PANEL
13	PT34093013	CABINET BASE PANEL
14	PT34093014	CABINET FRONT PANEL
15	PT34093015	HANDLE
16	PT34093016	DOOR SUPPORT, LEFT
17	PT34093017	DOOR SUPPORT, RIGHT
18	PT34093018	MAGNET W/STRIP
19	PT34093019	CABINET HINGE
20	PT34093020	WISE ROD M12-1.75 X 25, 330L, FRONT
21	PT34093021	WISE HEAD, FRONT
22	PT34093022	WISE LEADSCREW W/PLATE, FRONT
23	PT34093023	FRONT VISE HANDLE, WOOD
24	PT34093024	WISE LEADSCREW PLATE, FRONT
25	PT34093025	WISE HEAD, SIDE
26	PT34093026	WISE LEADSCREW W/PLATE, SIDE
27	PT34093027	SIDE VISE HANDLE, WOOD

REF	PART #	DESCRIPTION
28	PT34093028	SIDE VISE RAIL, BACK
29	PT34093029	SIDE VISE RAIL, FRONT
30	PT34093030	WISE SLIDE, SIDE
31	PT34093031	WISE LEADSCREW PLATE, SIDE
32	PT34093032	TAP SCREW M4 X 30
33	PT34093033	LAG BOLT M8 X 80
34	PT34093034	HEX BOLT M12-1.75 X 120
35	PT34093035	HEX NUT M12-1.75
36	PT34093036	FLAT WASHER 8MM
37	PT34093037	FLAT WASHER 12MM
38	PT34093038	TAP SCREW M6 X 30
39	PT34093039	HEX BOLT M8-1.25 X 15
40	PT34093040	FENDER WASHER 8MM
41	PT34093041	ACORN NUT M12-1.75
42	PT34093042	TAP SCREW M4 X 12
43	PT34093043	TAP SCREW M4 X 80
44	PT34093044	FLANGE SCREW M4-.7 X 22
45	PT34093045	FLAT HD CAP SCR M8-1.25 X 60
46	PT34093046	HEX NUT M8-1.25
47	PT34093047	TAP SCREW M3 X 8
48	PT34093048	WRENCH 12MM OPEN-END
49	PT34093049	WRENCH 13MM OPEN-END
50	PT34093050	WRENCH 17MM OPEN-END
51	PT34093051	WRENCH 19MM OPEN-END
52	PT34093052	SCREWDRIVER PHILLIPS #2
53	PT34093053	LEG PANEL, LEFT
54	PT34093054	LEG PANEL, RIGHT





Buy Direct and Save with Grizzly® – Trusted, Proven and a Great Value!
~Since 1983~

*Visit Our Website Today For
Current Specials!*

**ORDER
24 HOURS A DAY!
1-800-523-4777**

