



# MODEL T34094 66" 2-CABINET, 6-DRAWER BUTCHER BLOCK WORKBENCH INSTRUCTIONS

For questions or help with this product contact Tech Support at (570) 546-9663 or techsupport@grizzly.com

## Introduction

The T34094 66" 2-Cabinet, 6-Drawer Butcher Block Workbench measures 66" wide, 19<sup>3</sup>/<sub>4</sub>" deep, 34" tall and is made of solid hevea wood. This model includes six felt-lined drawers with ball bearing slides, and two large cabinets with magnetic latches. The workbench also includes a pre-installed vise with a 4<sup>1</sup>/<sub>4</sub>" clamping capacity.



**Figure 1.** T34094 66" 2-Cabinet, 6-Drawer Butcher Block Workbench.

## Specifications

- Dimensions.....66"W x 19<sup>3</sup>/<sub>4</sub>"D x 34"H
- Workbench Top.....60"W x 19<sup>3</sup>/<sub>4</sub>"D
- Top Drawers ..... 16<sup>5</sup>/<sub>8</sub>"W x 12<sup>5</sup>/<sub>8</sub>"D x 1<sup>3</sup>/<sub>4</sub>"H
- Bottom Drawers..... 16<sup>5</sup>/<sub>8</sub>"W x 12<sup>5</sup>/<sub>8</sub>"D x 2<sup>7</sup>/<sub>8</sub>"H
- Storage Cabinets..... 19"W x 14"D x 12"H
- Vise..... 11"W x 3"H
- Vise Capacity..... 4<sup>1</sup>/<sub>4</sub>"
- Legs.....2<sup>1</sup>/<sub>4</sub>" x 2<sup>1</sup>/<sub>4</sub>"
- Weight .....157 lbs.
- Weight Capacity ..... 1100 lbs.

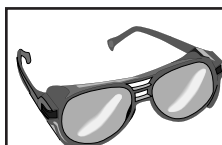

### **!WARNING**

**Wear safety glasses during the entire setup process!**

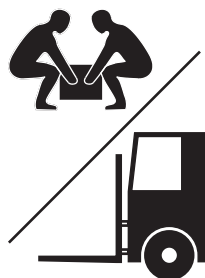

### **!WARNING**

#### **HEAVY LIFT!**

**Straining or crushing injury may occur from improperly lifting workbench or some of its parts. To reduce this risk, get help from other people and use a forklift (or other lifting equipment) rated for weight of this workbench.**

### **!WARNING**

- Do not exceed weight capacity of workbench.
- Do not stand or climb on workbench.
- Do not use workbench outdoors or in wet or damp locations.
- Do not overload vise or use cheater pipe on vise handles to increase leverage.
- Do not weld on workbench.
- Do not allow children to have unsupervised access to workbench.

COPYRIGHT © MARCH, 2024 BY GRIZZLY INDUSTRIAL, INC.  
**NO PORTION OF THIS MANUAL MAY BE REPRODUCED IN ANY SHAPE  
OR FORM WITHOUT THE WRITTEN APPROVAL OF GRIZZLY INDUSTRIAL, INC.**  
(FOR MODELS MFD. SINCE 11/23) #JA23091 PRINTED IN CHINA

V1.03.24

**\*\*\*Keep for Future Reference\*\*\***

## Inventory

Main (Figure 2)	Qty
A. Workbench Top .....	1
B. Vise Head .....	1
C. Vise Leadscrew Assembly .....	1
D. Cabinet & Frame Assembly .....	1
E. Handles .....	8

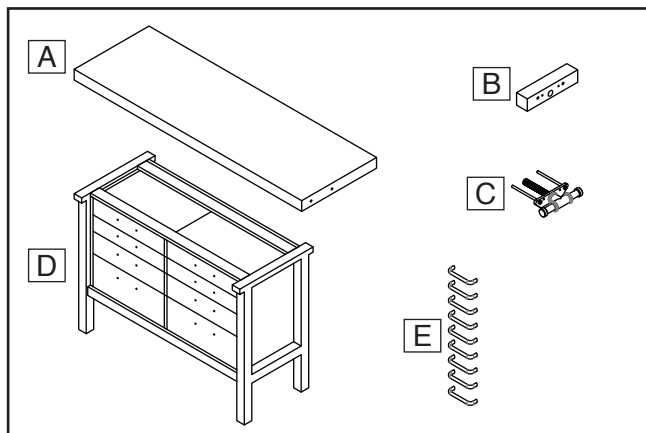

Figure 2. Main inventory.

Fasteners & Tools (Figure 3)	Qty
F. Phillips Head Screws M4-.7 x 40 .....	12
G. Flat Washers 8mm .....	4
H. Lag Bolts M8 x 60 .....	4
I. Tap Screw M6 x 30 .....	4
J. Hex Bolts M8-1.25 x 15 .....	2
K. Flange Screws M4-.7 x 22 .....	4
L. Fender Washers 8mm .....	2
M. Phillips Head Screwdriver #2 .....	1
N. Open-End Wrench 13mm .....	1

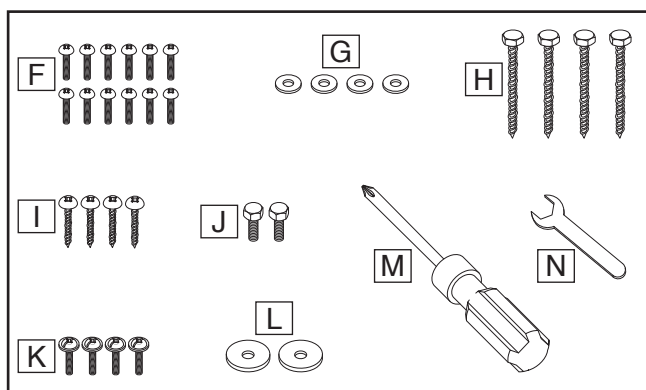

Figure 3. Fasteners and tools.

## NOTICE

If you cannot find an item on this list, check the mounting location or examine the packaging materials carefully. Some items are pre-installed for shipping purposes.

## Assembly



## Needed for Assembly

- Additional Person .....
- Safety Glasses (for each person)..... 1 Pr.
- Square .....

### To assemble workbench:

1. Place workbench top onto cabinet and frame assembly with vise holes facing right, then attach with (4) M8 x 60 lag bolts and (4) 8mm flat washers (see Figure 4).

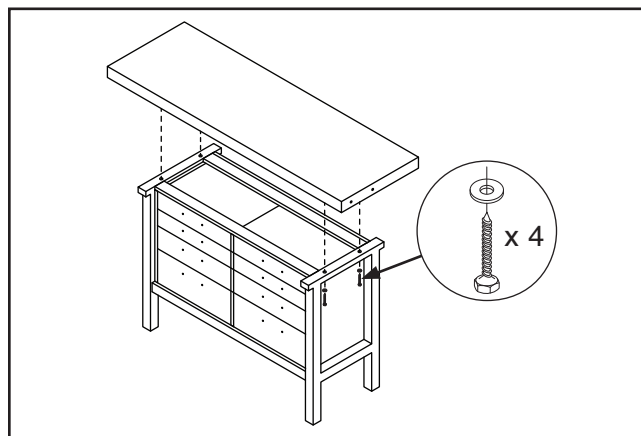

Figure 4. Attaching workbench top to frame.

2. Install (1) handle to (1) drawer using (2) M4-.7 x 40 Phillips head screws (see Figure 5).

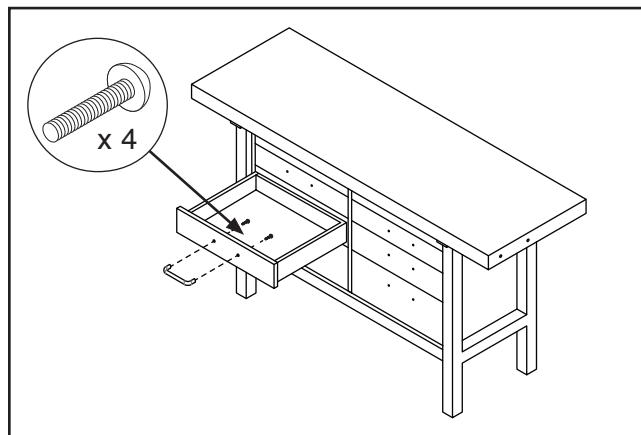
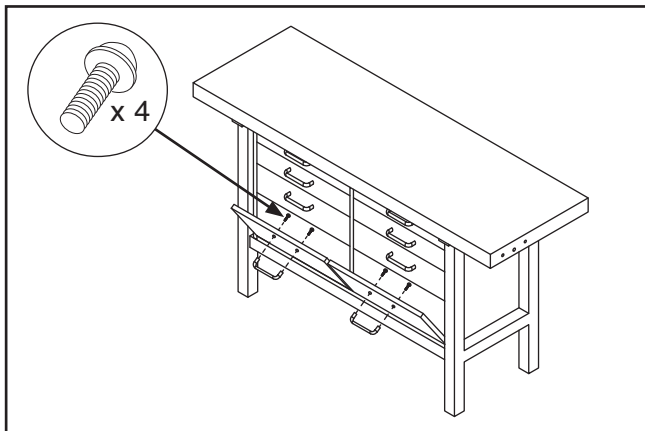

Figure 5. Attaching handles to drawers.

3. Repeat Step 2 for remaining five drawers.



4. Install (1) handle on each cabinet front panel using (2) M4-.7 x 22 flange screws, as shown in **Figure 6**.



**Figure 6.** Installing handles on cabinets.

5. Feed vise leadscrew assembly through vise head and attach with (4) M6 x 30 tap screws (see **Figure 7**).

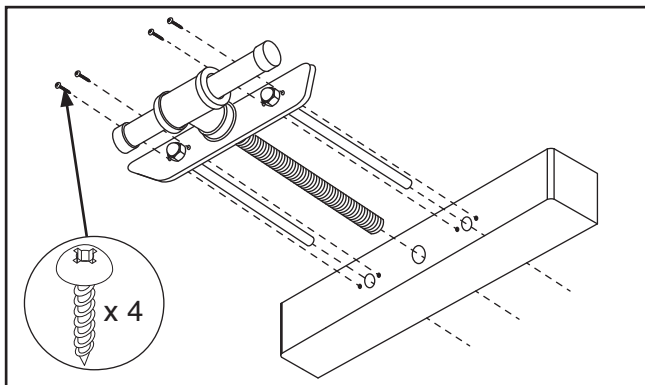

**Figure 7.** Assembling vise components.

6. Insert vise assembly into holes in right edge of workbench top (see **Figure 11**).

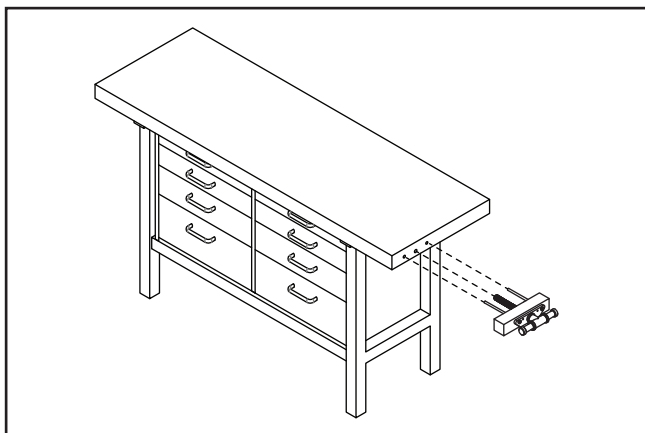

**Figure 8.** Inserting vise assembly into workbench top.

7. Thread vise through leadscrew plate, then tighten until vise head makes contact with workbench.

8. Attach (2) M8-1.25 x 15 hex bolts and (2) 8mm fender washers to back of vise rods (see **Figure 9**).

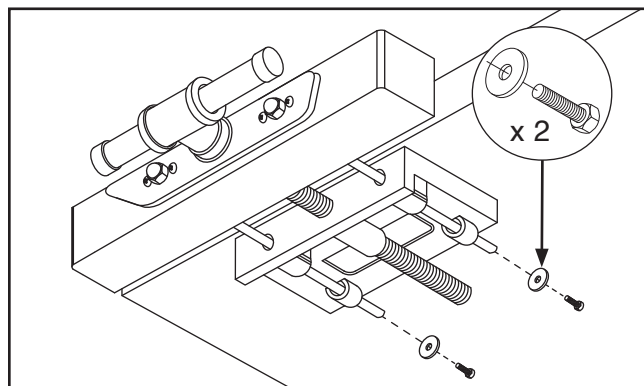

**Figure 9.** Installing vise assembly.

9. Completed vise installation should resemble **Figure 10**. Test vise range of motion by turning handle counterclockwise to open and clockwise to close.

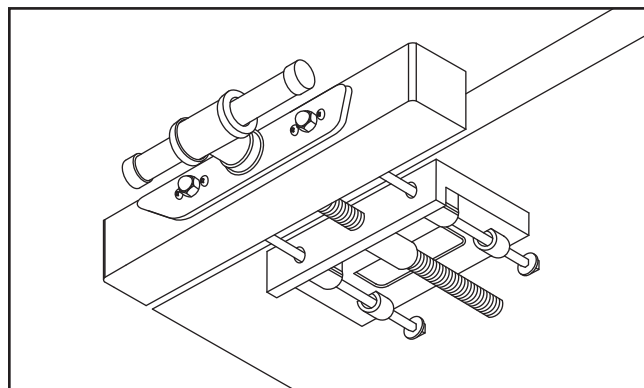

**Figure 10.** Vise assembly installed.



# T34094 Parts Breakdown & List

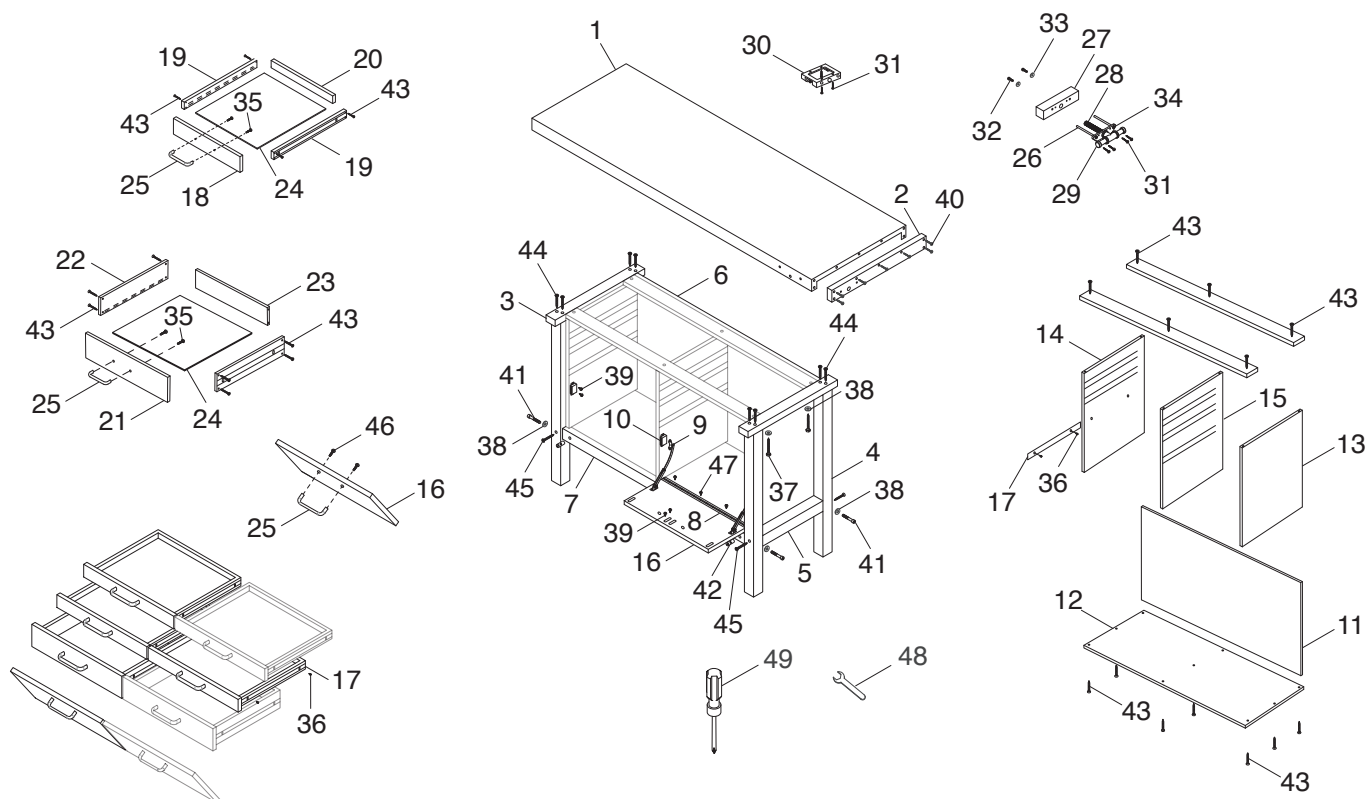

## REF PART # DESCRIPTION

1	PT34094001	WORKBENCH TOP
2	PT34094002	WORKBENCH TRIM
3	PT34094003	LEG CROSSBAR, TOP
4	PT34094004	WORKBENCH LEG
5	PT34094005	LEG CROSSBAR, BOTTOM
6	PT34094006	CROSSBAR, TOP
7	PT34094007	CROSSBAR, BOTTOM
8	PT34094008	CABINET HINGE
9	PT34094009	DOOR SUPPORT
10	PT34094010	MAGNET W/STRIP
11	PT34094011	CABINET PANEL, BACK
12	PT34094012	CABINET PANEL, BASE
13	PT34094013	CABINET SIDE PANEL, RIGHT
14	PT34094014	CABINET SIDE PANEL, LEFT
15	PT34094015	CABINET PANEL, MIDDLE
16	PT34094016	CABINET DOOR
17	PT34094017	DRAWER SLIDE
18	PT34094018	SMALL DRAWER PANEL, FRONT
19	PT34094019	SMALL DRAWER PANEL, SIDE
20	PT34094020	SMALL DRAWER PANEL, BACK
21	PT34094021	LARGE DRAWER PANEL, FRONT
22	PT34094022	LARGE DRAWER PANEL, SIDE
23	PT34094023	LARGE DRAWER PANEL, BACK
24	PT34094024	DRAWER BASE PANEL
25	PT34094025	HANDLE

## REF PART # DESCRIPTION

26	PT34094026	WISE ROD M12-1.75 X 25, 330L
27	PT34094027	WISE HEAD
28	PT34094028	WISE LEADSCREW W/PLATE
29	PT34094029	WISE HANDLE, WOOD
30	PT34094030	WISE LEADSCREW PLATE
31	PT34094031	TAP SCREW M6 X 30
32	PT34094032	HEX BOLT M8-1.25 X 15
33	PT34094033	FENDER WASHER 8MM
34	PT34094034	ACORN NUT M12-1.75
35	PT34094035	PHLP HD SCR M4-.7 X 40
36	PT34094036	TAP SCREW M4 X 12
37	PT34094037	LAG BOLT M8 X 60
38	PT34094038	FLAT WASHER 8MM
39	PT34094039	TAP SCREW M3 X 8
40	PT34094040	TAP SCREW M6 X 40
41	PT34094041	HEX BOLT M8-1.25 X 90
42	PT34094042	DOWEL NUT M8 X 1.25
43	PT34094043	TAP SCREW M4 X 22
44	PT34094044	TAP SCREW M4 X 30
45	PT34094045	TAP SCREW M4 X 55
46	PT34094046	FLANGE SCREW M4-.7 X 22
47	PT34094047	TAP SCREW M4 X 14
48	PT34094048	WRENCH 13MM OPEN-END
49	PT34094049	SCREWDRIVER PHILLIPS #2

**Please Note:** We do our best to stock replacement parts whenever possible, but we cannot guarantee that all parts shown here are available for purchase. Call (800) 523-4777 or visit our online parts store at [www.grizzly.com](http://www.grizzly.com) to check for availability.

