



For questions or help with this product contact Tech Support at (570) 546-9663 or techsupport@grizzly.com

# MODEL T34206 MINI PALLET JACK INSTRUCTIONS

## Introduction

The Model T34206 Mini Pallet Jack is capable of lifting up to 1100 lbs. Features include 7" spacing between forks for moving items with a smaller-than-standard-size pallet, three-position lifting controls, and non-marring ball bearing wheels.

## Specifications

Maximum Capacity .....	1100 lbs.
Overall Lifting Area .....	15" W x 31¼" L
Individual Fork Width .....	4"
Minimum Fork Height .....	2½"
Maximum Fork Height .....	6"

## Inventory

Description	Qty
A. Handle Assembly .....	1
B. Mini Pallet Jack .....	1

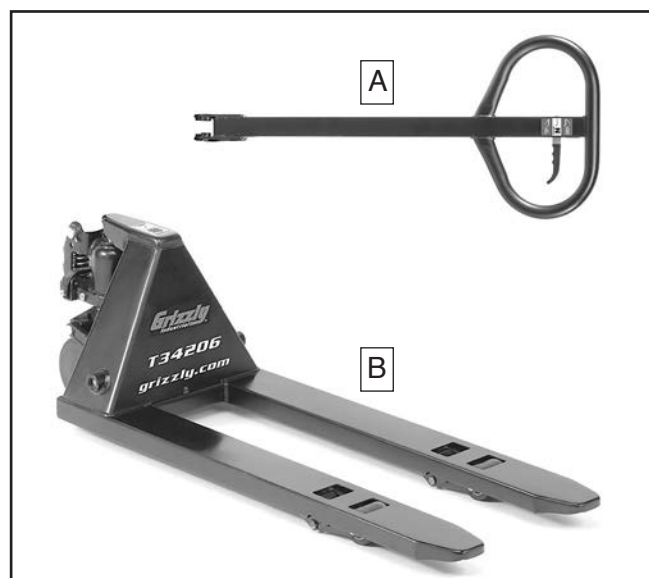
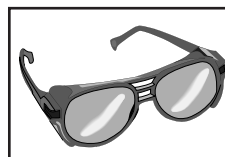

Figure 1. T34206 inventory.



**! WARNING**  
Wear safety glasses during the entire setup process!

## Assembly

The Model T34206 comes assembled except for the handle assembly.

Tools Needed	Qty
Hammer .....	1
Center Punch ⅛" .....	1
Wrenches or Sockets 8, 10mm .....	1 Ea.
Flat Head Screwdriver ⅛" .....	1

### To assemble mini pallet jack:

1. Remove (1) roll pin from handle shaft, then remove handle shaft (see **Figure 2**).
2. Verify location of pivot shaft and leave in place for now (see **Figure 2**).

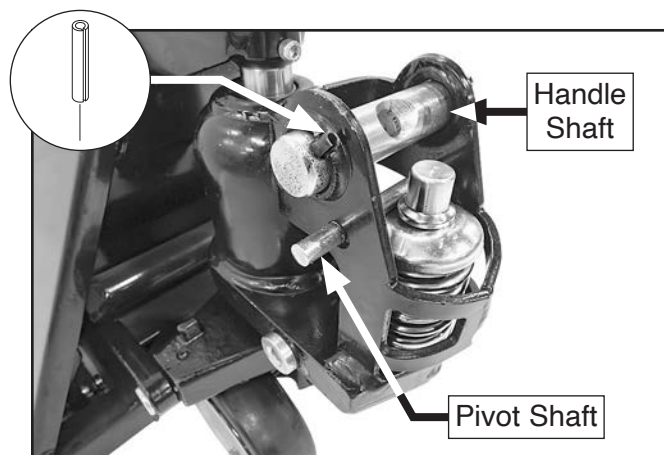

Figure 2. Location of pivot bracket components.

COPYRIGHT © MAY, 2024 BY GRIZZLY INDUSTRIAL, INC.  
NO PORTION OF THIS MANUAL MAY BE REPRODUCED IN ANY SHAPE  
OR FORM WITHOUT THE WRITTEN APPROVAL OF GRIZZLY INDUSTRIAL, INC.  
(FOR MODELS MFD. SINCE 05/24) #KS23216 PRINTED IN CHINA

V1.05.24

\*\*\*Keep for Future Reference\*\*\*

- Align handle assembly in pivot bracket and install handle shaft (see **Figure 3**).

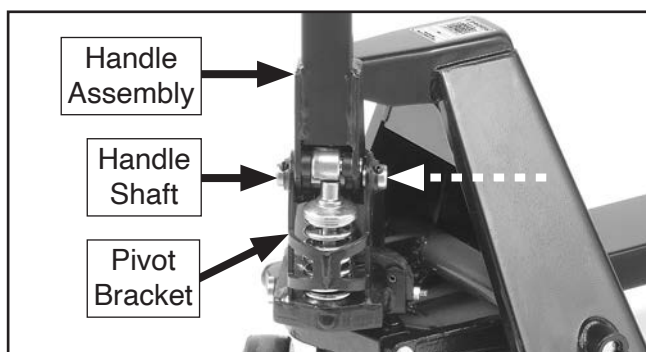

**Figure 3.** Handle shaft installed.

- Push handle down and feed handle chain through handle shaft eyelet (see **Figure 4**).

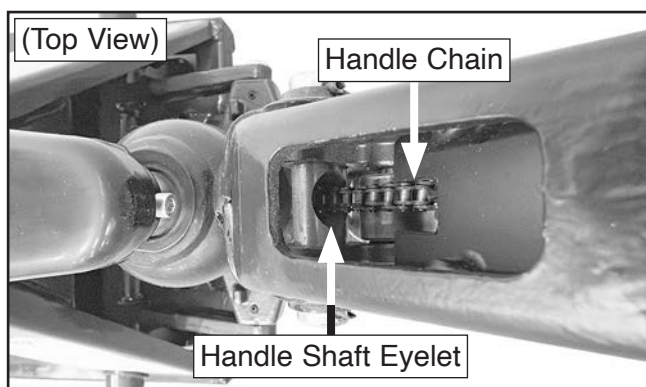

**Figure 4.** Handle chain threaded through eyelet.

- Insert (1) roll pin into open end of handle shaft to secure, then remove pivot shaft from **Step 2** and save for future use.
- Lift actuating cam and slide stud on end of chain through slot, then tighten lock nut 1–2 turns to secure (see **Figure 5**).

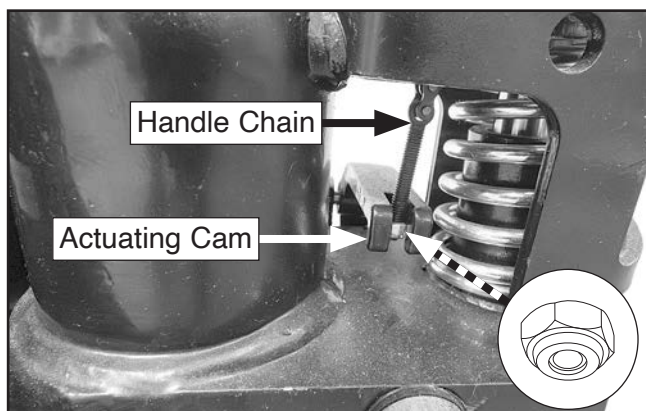
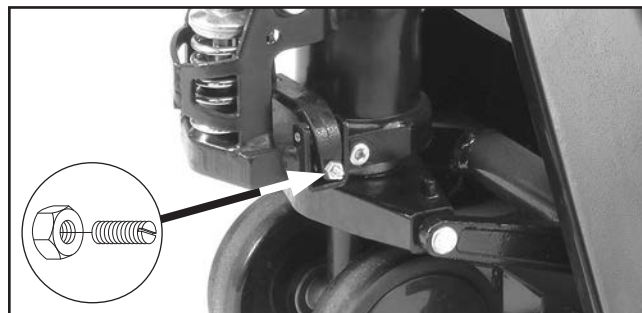

**Figure 5.** Location of actuating cam.

- Test handle assembly operation by lifting forks. Loosen hex nut and adjust slotted set screw (see **Figure 6**) as described below:

- If forks lower immediately after being lifted, loosen slotted set screw.
- If forks lift but will not lower, tighten slotted set screw.

- Tighten hex nut without rotating slotted set screw to secure (see **Figure 6**).



**Figure 6.** Location of adjustment fasteners.

## Operation

The handle lever shown in **Figure 7** has three operating positions.

**Lower Position:** Lowers forks. Pull lever up SLOWLY to begin lowering forks. Avoid pulling lever up quickly or load will drop suddenly.

**Neutral Position:** Place handle in this position to move load.

**Lift Position:** Raises forks when handle is pumped. Move lever down until it locks in place, then pump handle to lift forks.

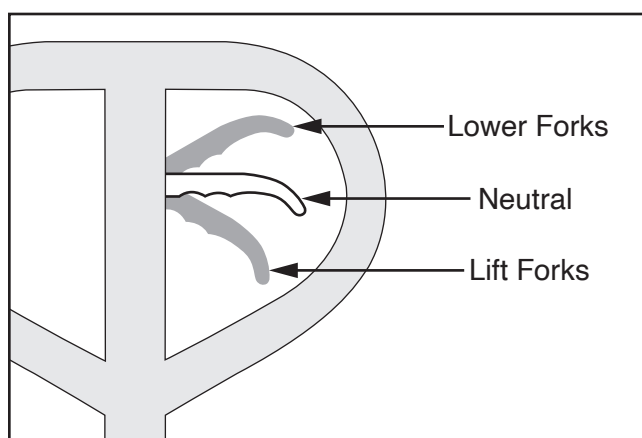

**Figure 7.** Handle lever positions.



## Adding Hydraulic Oil

Oil may need to be added periodically after prolonged use. Use ISO 32 hydraulic oil (not included) in the oil pump as needed.

### To add hydraulic oil:

1. Lower forks completely.
2. Remove oil fill plug (see **Figure 8**).

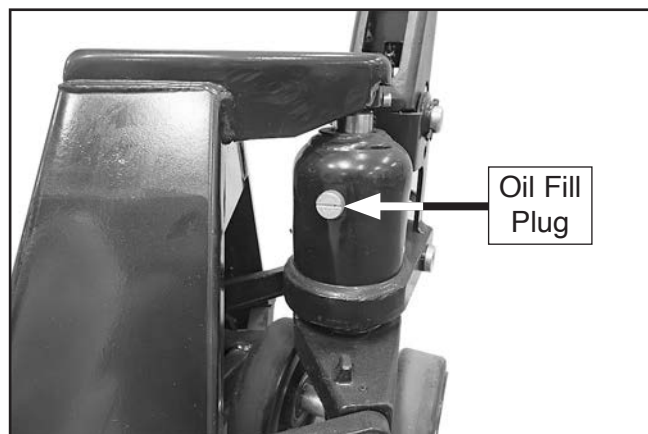

**Figure 8.** Oil fill plug location.

3. Add oil until level is just below fill hole.

4. Without replacing fill plug, pump handle 10–15 times to expel any trapped air.
5. Install oil fill plug.

## Lubrication

Grizzly recommends adding a few drops of SAE 10W-30 motor oil (not included) every three months to each rotating point shown in **Figure 9**.

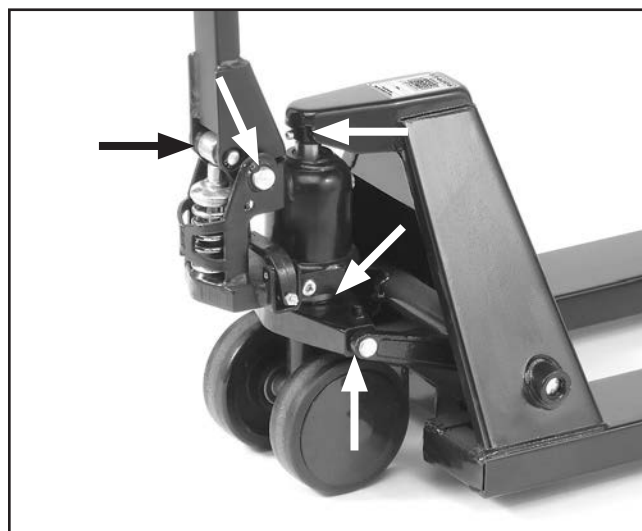

**Figure 9.** Location of lubrication points.

## Troubleshooting

Symptom	Possible Cause	Possible Solution
Forks do not lift, or do not lift sufficiently.	<ol style="list-style-type: none"> <li>1. Pump assembly hydraulic oil level low/contaminated.</li> <li>2. Too much hydraulic oil in pump assembly.</li> <li>3. Actuating cam lock nut too tight.</li> <li>4. Lifting component stuck/bent.</li> </ol>	<ol style="list-style-type: none"> <li>1. Fill pump assembly with hydraulic oil. If necessary, remove old/contaminated oil and replace.</li> <li>2. Pump off extra hydraulic oil.</li> <li>3. Loosen actuating cam lock nut (<b>Page 2</b>).</li> <li>4. Inspect/replace lifting components.</li> </ol>
Forks do not lower from raised position.	<ol style="list-style-type: none"> <li>1. Lifting components jammed with debris.</li> <li>2. Too much hydraulic oil in pump assembly.</li> <li>3. Actuating cam lock nut too loose.</li> <li>4. Lifting components bent/damaged.</li> </ol>	<ol style="list-style-type: none"> <li>1. Inspect mechanism, clear debris.</li> <li>2. Pump off extra hydraulic oil.</li> <li>3. Tighten actuating cam lock nut (<b>Page 2</b>).</li> <li>4. Inspect/replace damaged lifting components.</li> </ol>
Forks lower by themselves.	<ol style="list-style-type: none"> <li>1. Impurities in relief valve/hydraulic oil.</li> <li>2. Relief valve faulty/damaged.</li> <li>3. Seals worn/damaged.</li> </ol>	<ol style="list-style-type: none"> <li>1. Clean relief valve/change hydraulic oil.</li> <li>2. Inspect/replace.</li> <li>3. Inspect/replace.</li> </ol>
Forks lower too slowly.	<ol style="list-style-type: none"> <li>1. Slotted set screw misadjusted.</li> <li>2. Actuating cam lock nut too loose.</li> </ol>	<ol style="list-style-type: none"> <li>1. Tighten slotted set screw (<b>Page 2</b>).</li> <li>2. Tighten actuating cam lock nut (<b>Page 2</b>).</li> </ol>
Forks lower too quickly.	<ol style="list-style-type: none"> <li>1. Slotted set screw misadjusted.</li> <li>2. Actuating cam lock nut too tight.</li> </ol>	<ol style="list-style-type: none"> <li>1. Loosen slotted set screw (<b>Page 2</b>).</li> <li>2. Loosen actuating cam lock nut (<b>Page 2</b>).</li> </ol>
Oil leaks.	<ol style="list-style-type: none"> <li>1. Relief valve damaged.</li> <li>2. Oil fill plug gasket damaged.</li> <li>3. Seals worn/damaged.</li> <li>4. Cracked/worn/damaged parts.</li> </ol>	<ol style="list-style-type: none"> <li>1. Inspect/replace.</li> <li>2. Inspect/replace.</li> <li>3. Inspect/replace.</li> <li>4. Inspect/replace.</li> </ol>



# T34206 Parts Breakdown & List

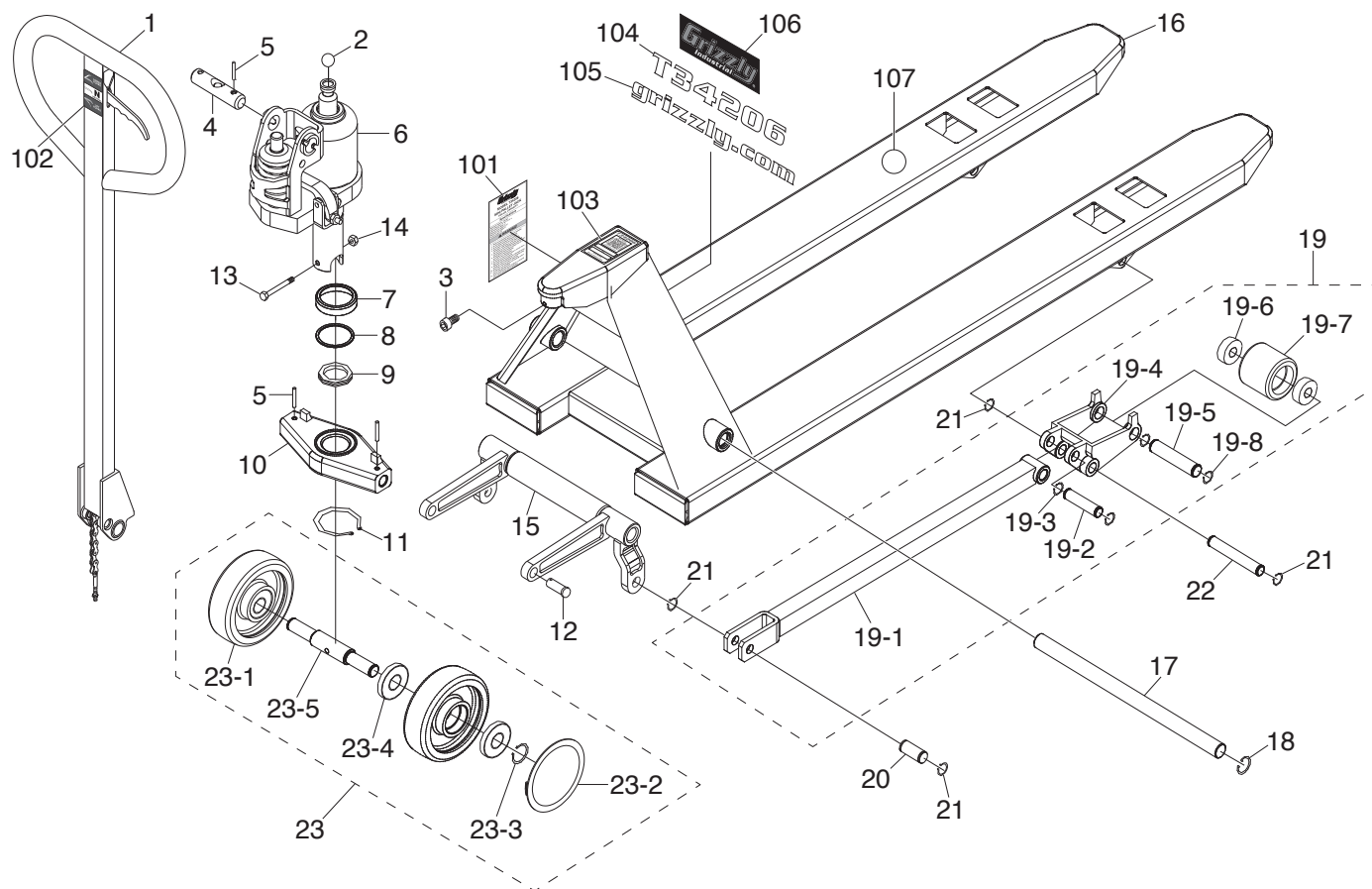

REF	PART #	DESCRIPTION
1	PT34206001	HANDLE ASSEMBLY
2	PT34206002	STEEL BALL 14MM
3	PT34206003	CAP SCREW M5-.8 X 8
4	PT34206004	HANDLE SHAFT
5	PT34206005	ROLL PIN 5 X 28
6	PT34206006	PUMP ASSEMBLY
7	PT34206007	SPACER 50 X 55 X 12
8	PT34206008	BEARING COVER
9	PT34206009	THRUST BEARING 51107
10	PT34206010	BASE SUPPORT
11	PT34206011	EXT RETAINING RING 35MM
12	PT34206012	CLEVIS PIN 14 X 30
13	PT34206013	HEX BOLT M6-1 X 40
14	PT34206014	HEX NUT M6-1
15	PT34206015	ROCKER ARM
16	PT34206016	BASE FRAME
17	PT34206017	PIVOT SHAFT
18	PT34206018	INT RETAINING RING 20MM
19	PT34206019	CARRIAGE ASSEMBLY
19-1	PT34206019-1	CONNECTING ROD
19-2	PT34206019-2	CARRIAGE PIVOT SHAFT
19-3	PT34206019-3	EXT RETAINING RING 14MM

REF	PART #	DESCRIPTION
19-4	PT34206019-4	WHEEL CARRIAGE
19-5	PT34206019-5	WHEEL AXLE
19-6	PT34206019-6	BALL BEARING 6203-2RS
19-7	PT34206019-7	LOAD WHEEL
19-8	PT34206019-8	EXT RETAINING RING 17MM
20	PT34206020	ROCKER SHAFT
21	PT34206021	EXT RETAINING RING 14MM
22	PT34206022	LOAD SHAFT
23	PT34206023	MAIN WHEEL ASSEMBLY
23-1	PT34206023-1	MAIN WHEEL
23-2	PT34206023-2	WHEEL COVER
23-3	PT34206023-3	EXT RETAINING RING 17MM
23-4	PT34206023-4	BALL BEARING 6203-2RS
23-5	PT34206023-5	MAIN WHEEL AXLE
101	PT34206101	MACHINE ID LABEL
102	PT34206102	LIFT CONTROL LABEL
103	PT34206103	QR CODE LABEL
104	PT34206104	MODEL NUMBER LABEL
105	PT34206105	GRIZZLY.COM LABEL
106	PT34206106	GRIZZLY INDUSTRIAL LABEL
107	PT34206107	TOUCH-UP PAINT, GLOSSY BLACK

**Please Note:** We do our best to stock replacement parts whenever possible, but we cannot guarantee that all parts shown here are available for purchase. Call (800) 523-4777 or visit our online parts store at [www.grizzly.com](http://www.grizzly.com) to check for availability.

