



# MODEL T34242

## STAND FOR G0990 DUST COLLECTOR

### OWNER'S MANUAL

*(For models manufactured since 11/24)*



COPYRIGHT © NOVEMBER, 2024 BY GRIZZLY INDUSTRIAL, INC.  
**WARNING: NO PORTION OF THIS MANUAL MAY BE REPRODUCED IN ANY SHAPE  
OR FORM WITHOUT THE WRITTEN APPROVAL OF GRIZZLY INDUSTRIAL, INC.**  
#JA23282 PRINTED IN TAIWAN

V1.11.24

**\*\*\*Keep for Future Reference\*\*\***

# SECTION 1: SETUP

## Unpacking

This dust collector stand was carefully packaged for safe transport. When unpacking, separate all enclosed items from packaging materials and inspect them for shipping damage. ***If items are damaged, please call us immediately at (570) 546-9663.***

**IMPORTANT:** Save all packaging materials until you are completely satisfied with the stand and have resolved any issues between Grizzly or the shipping agent. ***You MUST have the original packaging to file a freight claim. It is also extremely helpful if you need to return your stand later.***

## Needed for Setup

The following items are needed, but not included, for the setup/assembly of this machine.

Description	Qty
• Model G0990.....	1
• Assistant.....	1
• Lifting Straps (Rated for at least 250 lbs.)...	2
• Hoist (Rated for at least 250 lbs.).....	1
• Safety Glasses (for each person).....	1
• Hex Wrench $\frac{5}{32}$ ", $\frac{3}{16}$ ".....	1 Ea.
• Wrench or Socket $\frac{7}{16}$ ", $\frac{1}{2}$ ".....	1 Ea.

Aside from the information in this manual, all other content in the Model G0990 owner's manual applies and MUST be read and understood for your own safety. **IMPORTANT: Keep this manual with the G0990 owner's manual for future reference.**

For questions or help, contact our Tech Support at (570) 546-9663 or [techsupport@grizzly.com](mailto:techsupport@grizzly.com).

## Anchoring to Floor

Number of Mounting Holes..... 4  
Diameter of Mounting Hardware.....  $\frac{7}{16}$ "

Anchoring machinery to the floor prevents tipping or shifting and reduces vibration that may occur during operation, resulting in a machine that runs slightly quieter and feels more solid.

If the stand and machine will be installed in a commercial or workplace setting, or if the machine is permanently connected (hardwired) to the power supply, local codes may require that it be anchored to the floor.

If not required by any local codes, fastening the stand to the floor is an optional step. If you choose not to do this, we recommend placing your stand on machine mounts, as these provide an easy method for leveling and they have vibration-absorbing pads.

## Anchoring to Concrete Floors

Lag shield anchors with lag screws (see below) are a popular way to anchor machinery to a concrete floor, because the anchors sit flush with the floor surface, making it easy to unbolt and move the stand and machine later, if needed. However, anytime local codes apply, you MUST follow the anchoring methodology specified by the code.

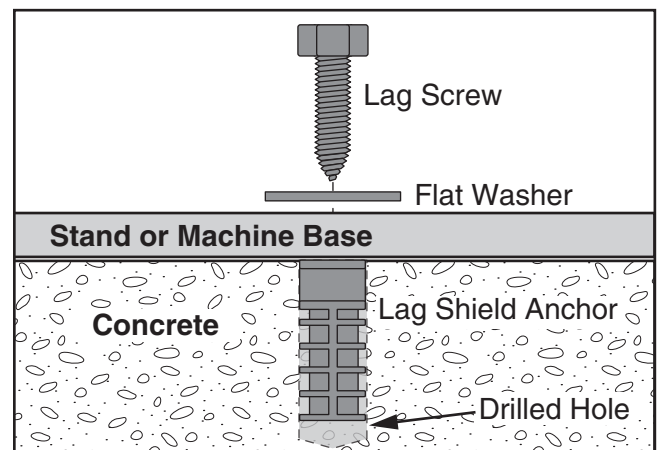

Figure 1. Popular method for anchoring machinery to a concrete floor.



# Inventory



The following is a list of items shipped with your stand. Before beginning setup, lay these items out and inventory them.

If any non-proprietary parts are missing (e.g. a nut or a washer), we will gladly replace them; or for the sake of expediency, replacements can be obtained at your local hardware store.

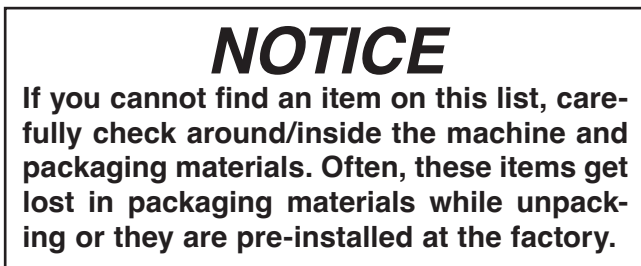

Fasteners (Figure 2)	Qty
A. Button Head Cap Screws $\frac{1}{4}$ "-20 x $\frac{1}{2}$ ".....	28
B. Flange Nuts $\frac{1}{4}$ "-20.....	28
C. Flange Bolts $\frac{5}{16}$ "-18 x $\frac{1}{2}$ ".....	8
D. Button Head Cap Screws $\frac{5}{16}$ "-18 x $\frac{3}{4}$ ".....	8

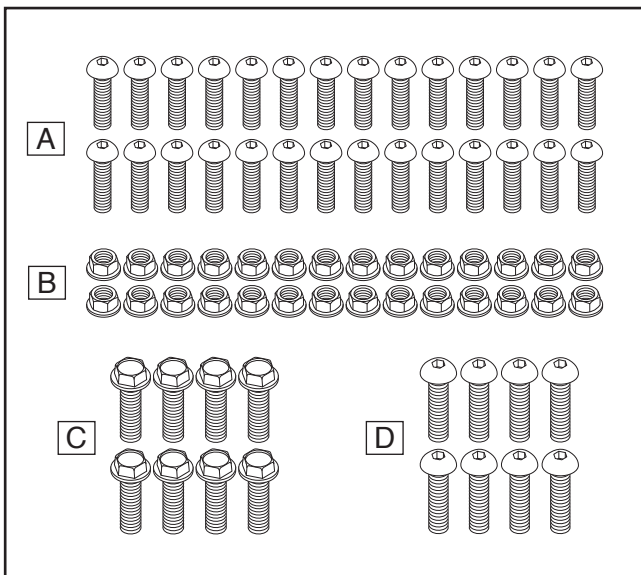

Figure 2. Fastener inventory.

Boxed Inventory (Figure 3)	Qty
E. Legs.....	4
F. Leg Mount Covers.....	2
G. Mounting Brackets.....	4
H. Long Brace.....	1
I. Short Braces.....	2

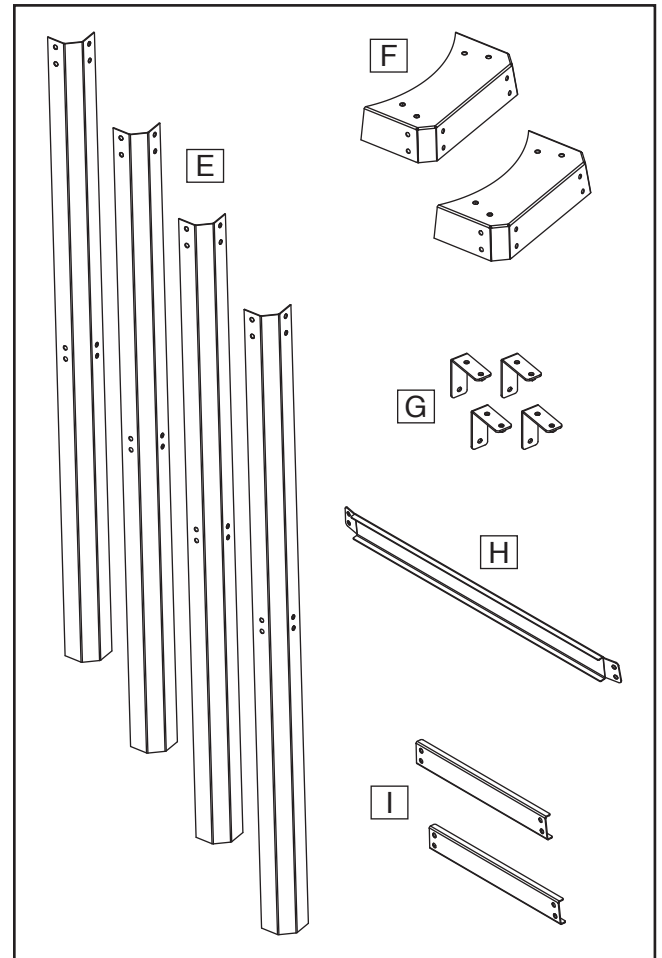

Figure 3. Boxed inventory.

**IMPORTANT:** The T34242 stand replaces the wall-mount that comes with the Model G0990 dust collector. When installing the stand, you can set aside the impeller housing bracket, wall bracket, and (4)  $\frac{5}{16}$ "-18 x  $\frac{1}{2}$ " flange bolts that come with the dust collector.



# Installation

Before beginning the assembly process, refer to **Needed for Setup** in this manual and gather all listed items.



## To install stand on machine:

1. Use a hoist to raise machine off floor to create room for stand.
  - If machine is mounted to wall, lift machine out of wall bracket, and keep suspended.
  - If machine is new and unassembled, lift and suspend impeller housing, then attach stand before completing machine assembly in **Step 12**.

**Note:** Lower mounting holes should be at least 43" from ground for stand installation (see **Figure 4**).



**Figure 4.** Location of mounting holes.

2. Remove (4)  $\frac{5}{16}$ "-18 x  $\frac{3}{4}$ " button head cap screws from front mounting holes (see **Figure 4**).
3. Attach (2) mounting brackets to front of impeller housing with fasteners removed in **Step 2** (see **Figure 5**).

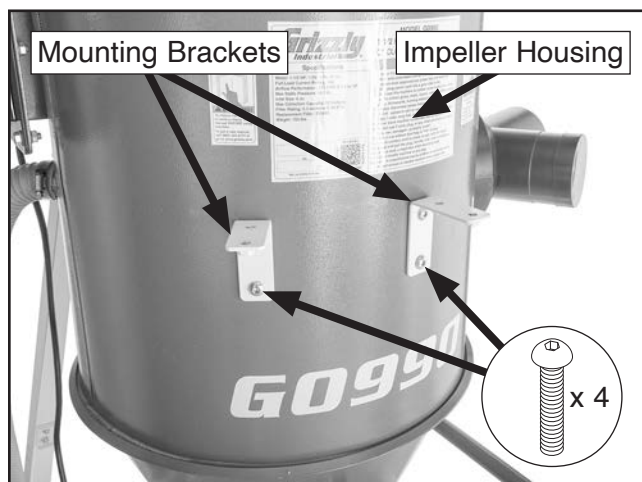

**Figure 5.** Mounting brackets attached to front of impeller housing.

4. Repeat **Steps 2–3** on rear of impeller housing.
5. Attach (1) leg mount cover to front mounting brackets using (4)  $\frac{5}{16}$ "-18 x  $\frac{1}{2}$ " flange bolts, as shown in **Figure 6**.

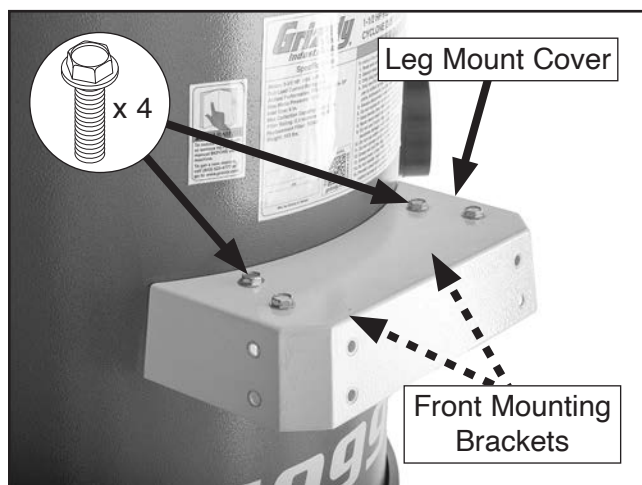
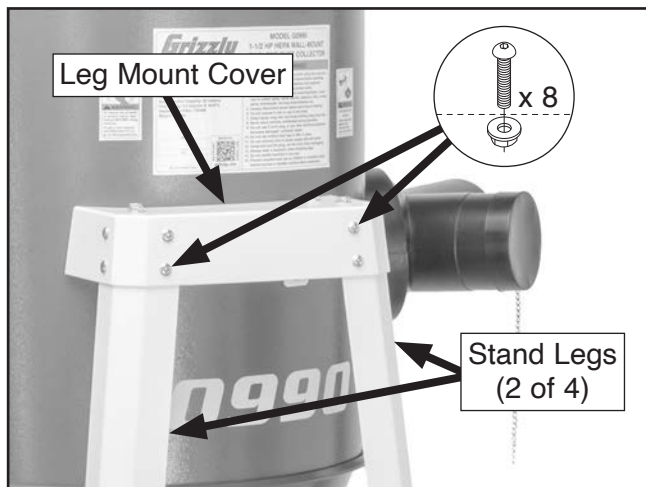

**Figure 6.** Leg mount cover attached to front mounting brackets.

6. Repeat **Step 5** on rear mounting brackets.



7. Attach (2) stand legs to front leg mount cover using (8) 1/4"-20 x 1/2" button head cap screws and (8) 1/4"-20 flange nuts (see **Figure 7**).



**Figure 7.** Stand legs attached to leg mount cover.

8. Repeat **Step 7** to attach (2) stand legs to rear leg mount cover.
9. Secure (1) short brace to front stand legs using (4) 1/4"-20 x 1/2" button head cap screws and (4) 1/4"-20 flange nuts (see **Figure 8**).

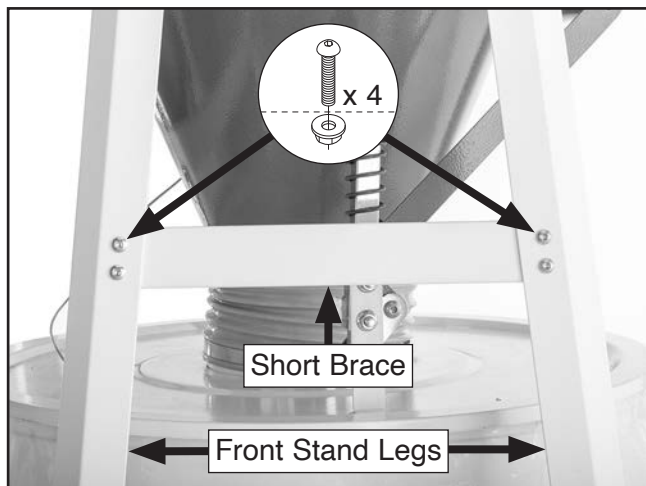

**Figure 8.** Short brace attached to stand legs.

10. Repeat **Step 9** on rear stand legs.

11. Secure long brace to front left and rear left legs using (4) 1/4"-20 x 1/2" button head cap screws and (4) 1/4"-20 flange nuts, as shown in **Figure 9**.

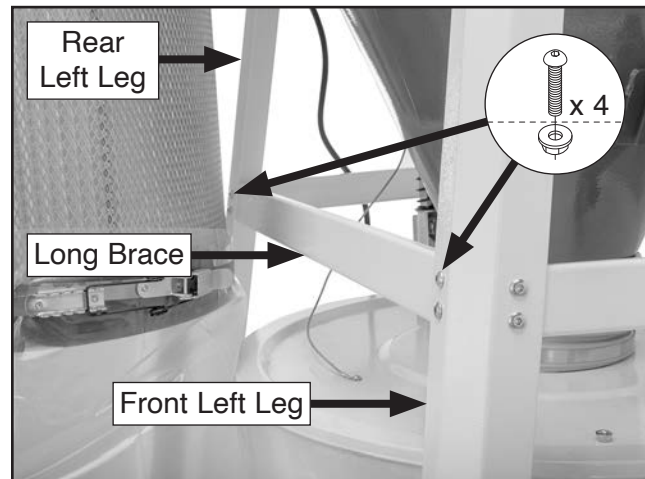

**Figure 9.** Long brace attached to front left and rear left stand legs.

12. If your machine *is* fully assembled, then stand assembly is complete.

If your machine *is not* fully assembled, then proceed to **Step 4** of **Assembly** in **G0990 Manual** to complete machine assembly.





# SECTION 2: PARTS

We do our best to stock replacement parts when possible, but we cannot guarantee that all parts shown are available for purchase. Call **(800) 523-4777** or visit **[www.grizzly.com/parts](http://www.grizzly.com/parts)** to check for availability.

## Main

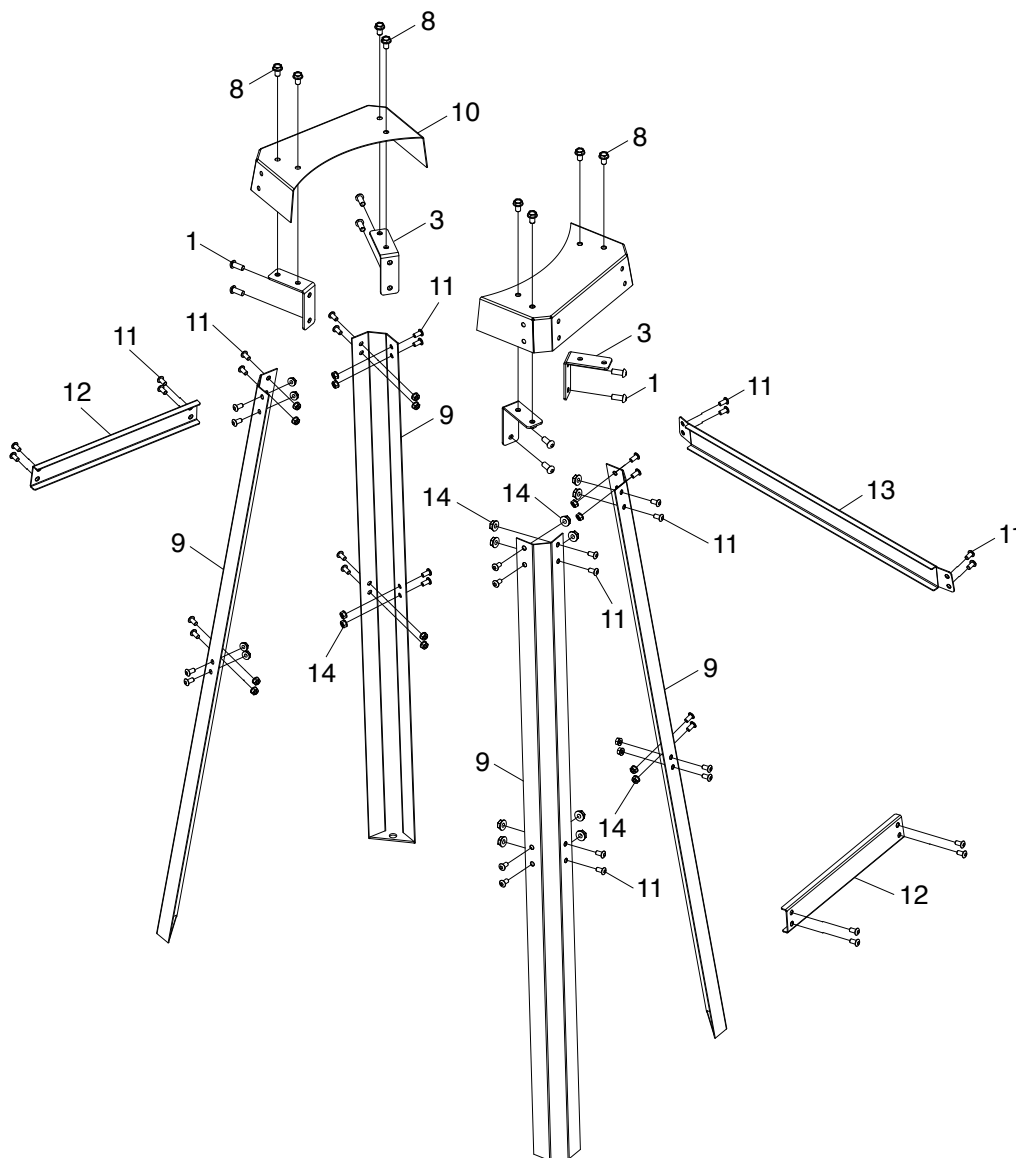

REF	PART #	DESCRIPTION
1	PT34242001	BUTTON HD CAP SCR 5/16-18 X 3/4
3	PT34242003	MOUNTING BRACKET
8	PT34242008	FLANGE BOLT 5/16-18 X 1/2
9	PT34242009	LEG
10	PT34242010	LEG MOUNT COVER

REF	PART #	DESCRIPTION
11	PT34242011	BUTTON HD CAP SCR 1/4-20 X 1/2
12	PT34242012	SHORT BRACE
13	PT34242013	LONG BRACE
14	PT34242014	FLANGE NUT 1/4-20



# WARRANTY & RETURNS

---

Grizzly Industrial, Inc. warrants every product it sells for a period of **1 year** to the original purchaser from the date of purchase. This warranty does not apply to defects due directly or indirectly to misuse, abuse, negligence, accidents, repairs or alterations or lack of maintenance. This is Grizzly's sole written warranty and any and all warranties that may be implied by law, including any merchantability or fitness, for any particular purpose, are hereby limited to the duration of this written warranty. We do not warrant or represent that the merchandise complies with the provisions of any law or acts unless the manufacturer so warrants. In no event shall Grizzly's liability under this warranty exceed the purchase price paid for the product and any legal actions brought against Grizzly shall be tried in the State of Washington, County of Whatcom.

We shall in no event be liable for death, injuries to persons or property or for incidental, contingent, special, or consequential damages arising from the use of our products.

The manufacturers reserve the right to change specifications at any time because they constantly strive to achieve better quality equipment. We make every effort to ensure that our products meet high quality and durability standards and we hope you never need to use this warranty.

In the event you need to use this warranty, contact us by mail or phone and give us all the details. We will then issue you a "Return Number," which must be clearly posted on the outside as well as the inside of the carton. We will not accept any item back without this number. Proof of purchase must accompany the merchandise.

Please feel free to write or call us if you have any questions about the machine or the manual.

Thank you again for your business and continued support. We hope to serve you again soon.

For further information about the warranty, visit <https://www.grizzly.com/forms/warranty> or scan the QR code below to be automatically directed to our warranty page.





Buy Direct and Save with Grizzly® – Trusted, Proven and a Great Value!  
~Since 1983~

*Visit Our Website Today For  
Current Specials!*

**ORDER  
24 HOURS A DAY!  
1-800-523-4777**

