



MODEL T34606 PLANER/MITER SAW STAND w/EXTENSION ROLLERS INSTRUCTIONS

For questions or help with this product contact Tech Support at (570) 546-9663 or techsupport@grizzly.com

Introduction

The Model T34606 Planer/Miter Saw Stand with Extension Rollers provides a stable mounting surface for benchtop machinery. The stand features a 20 $\frac{3}{4}$ " x 30" table, two adjustable roller supports, a built-in shelf, and an integrated mobile base.



Figure 1. T34606 Planer/Miter Saw Stand w/ Extension Rollers.

Specifications

Dimensions.....30"W x 20 $\frac{3}{4}$ "D x 29"H
Distance Between Supports..... 32 $\frac{1}{4}$ "–63 $\frac{1}{2}$ "
Table Dimensions.....20 $\frac{3}{4}$ " x 30"
Table Weight Capacity220 lbs.
Shelf Dimensions 14 $\frac{1}{2}$ " x 29 $\frac{3}{4}$ "
Shelf Weight Capacity33 lbs.

⚠ WARNING

- To reduce risk of serious personal injury:
 - Do not climb, sit or stand on stand.
 - Push stand only, do not pull it.
 - Do not use support extensions as a ladder or scaffolding.
 - Properly secure power tool to stand before operation.
 - Always use stand on a flat and level surface to prevent rocking or tipping.
 - Make sure stand is firmly on floor, foot pedal is down, and wheel is raised before use.
 - Do not modify or use stand for any operation for which it is not intended.
 - Do not exceed total weight capacity of 220 lbs.

Needed for Setup

Description	Qty
Safety Glasses	1 Pr.
Wrenches 13, 14mm.....	1 Ea.
Phillips Head Screwdriver #2	1

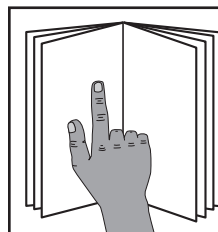

⚠ WARNING

To reduce your risk of serious injury, read this entire manual BEFORE using machine.

COPYRIGHT © JUNE, 2025 BY GRIZZLY INDUSTRIAL, INC.
NO PORTION OF THIS MANUAL MAY BE REPRODUCED IN ANY SHAPE
OR FORM WITHOUT THE WRITTEN APPROVAL OF GRIZZLY INDUSTRIAL, INC.
(FOR MODELS MFD. SINCE 06/25) #JP23641 PRINTED IN CHINA

V1.06.25

Keep for Future Reference

Inventory

Description	Qty
A. Table.....	1
B. Shelf.....	1
C. Base Assembly.....	1
D. Legs.....	4
E. Roller Supports.....	2
F. Support Extensions.....	2
G. Knob Bolts M8-1.25 x 14.....	4
H. Shelf Brackets.....	2
I. Foot Pedal Assembly.....	1
J. Hex Bolts M8-1.25 x 60.....	6
K. Carriage Bolts M8-1.25 x 16.....	32
L. Flat Washers 8mm.....	38
M. Hex Nuts M8-1.25.....	38
N. Tap Screws #8 x 1/2".....	2

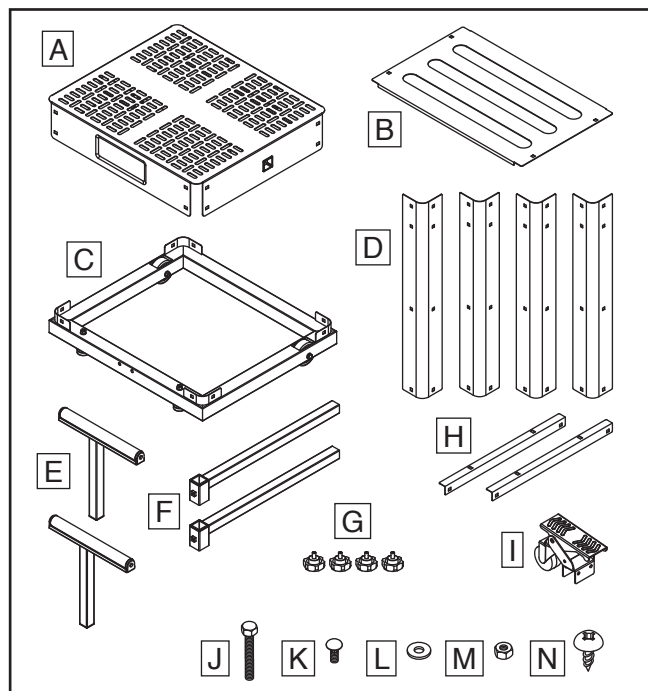

Figure 2. Inventory.

Assembly

The Model T34606 must be fully assembled before it can be used. Before beginning the assembly process, refer to **Needed for Setup** and gather all listed items.

Note: Only hand tighten fasteners until instructed to fully tighten in **Step 7**.

To assemble stand:

1. Place table upside down on flat, protected surface.
2. Attach (1) leg to each corner of table with (16) M8-1.25 x 16 carriage bolts, 8mm flat washers, and M8-1.25 hex nuts (see **Figure 3**).

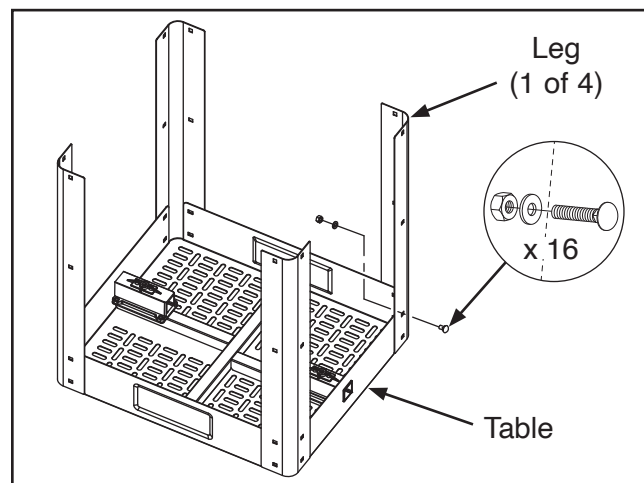

Figure 3. Leg to table installation.

3. Insert support extensions into holes in either side of table (see **Figure 4**), and secure with (2) M8-1.25 x 40 knob bolts.

Note: Install support extensions with pre-drilled holes facing away from table.

4. Thread (2) #8 tap screws into pre-drilled hole in end of each support extension (see **Figure 4**).

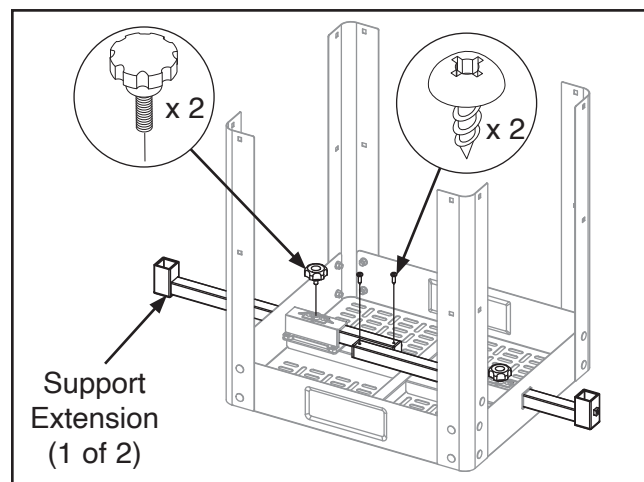

Figure 4. Support extensions installation.



5. Turn table assembly over and place on base assembly (see **Figure 5**), with legs positioned outside mounting tabs.
6. Attach legs to base assembly with (8) M8-1.25 x 16 carriage bolts, 8mm flat washers, and M8-1.25 hex nuts (see **Figure 5**).

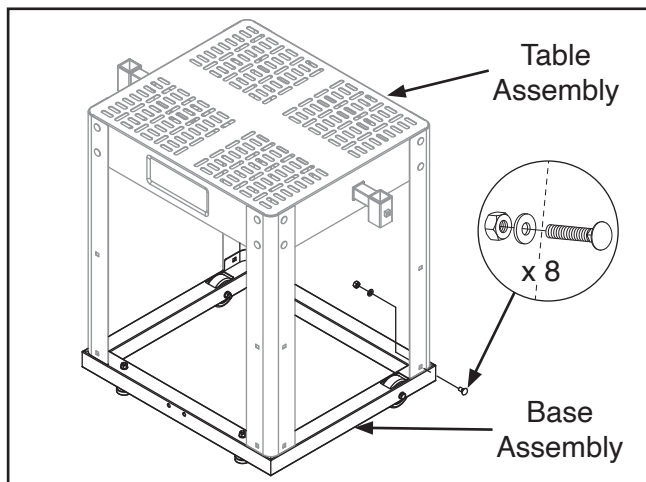

Figure 5. Leg to base installation.

7. Fully tighten all fasteners used in **Steps 2–6**.
8. Attach (2) shelf brackets, each with (2) M8-1.25 x 16 carriage bolts, 8mm flat washers, and M8-1.25 hex nuts (see **Figure 6**).
9. Attach shelf to shelf brackets with (4) M8-1.25 x 16 carriage bolts, 8mm flat washers, and M8-1.25 hex nuts (see **Figure 6**).

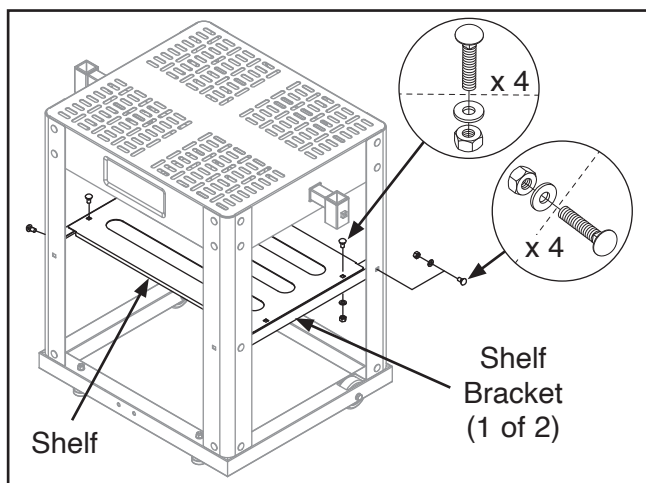

Figure 6. Shelf brackets and shelf installation.

10. Attach foot pedal assembly to base assembly with (2) M8-1.25 x 60 hex bolts, 8mm flat washers, and M8-1.25 hex nuts (see **Figure 7**).

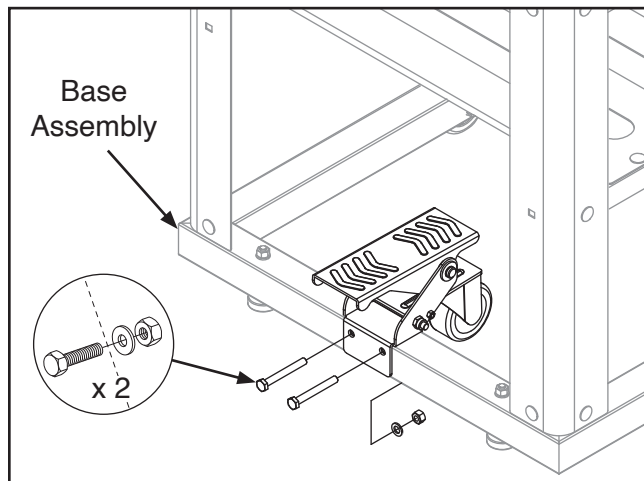

Figure 7. Foot pedal assembly installed.

11. Insert roller supports into support brackets (see **Figure 8**) and secure with (2) M8-1.25 x 14 knob bolts.

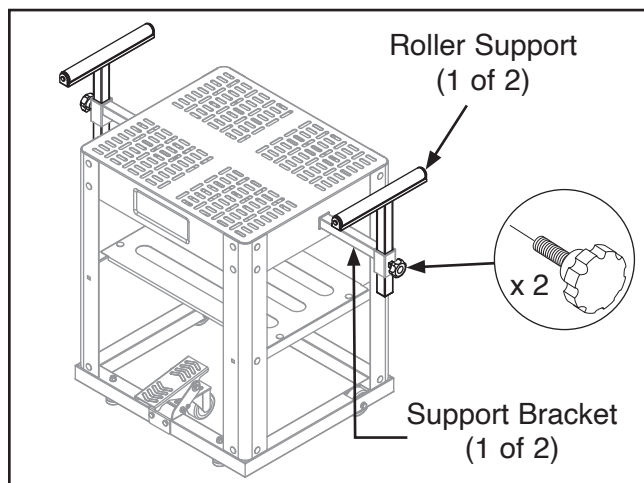

Figure 8. Roller supports installed.

Installing Machine

Install a planer or miter saw using (4) M8-1.25 x 60 hex bolts, 8mm flat washers, and M8-1.25 hex nuts.

For planer use: Position the planer so the support arms are to the front and rear of the machine (see **Figure 9**).

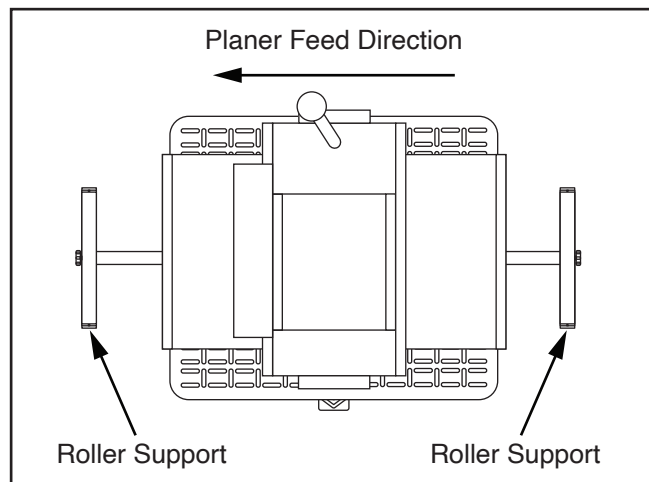

Figure 9. Planer installation (top view).

For miter saw use: Position the miter saw so the support arms are on each side of the machine (see **Figure 10**).

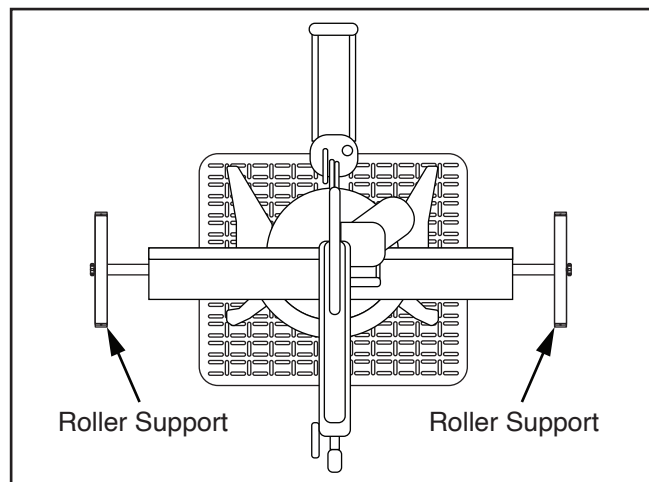

Figure 10. Miter saw installation (top view).

Moving Stand

Press down on the front of the foot pedal (see **Figure 11**) to unlock and lift the stand. Carefully move the stand into desired position, then press the back of the foot pedal to lower stand to the floor and lock.

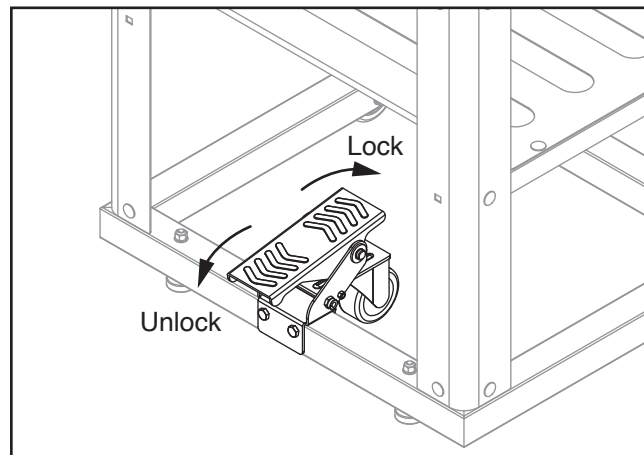

Figure 11. Foot pedal operation.

WARNING

Make sure stand is firmly on floor, foot pedal is down, and wheel is raised before use.



T34606 Parts Breakdown & List

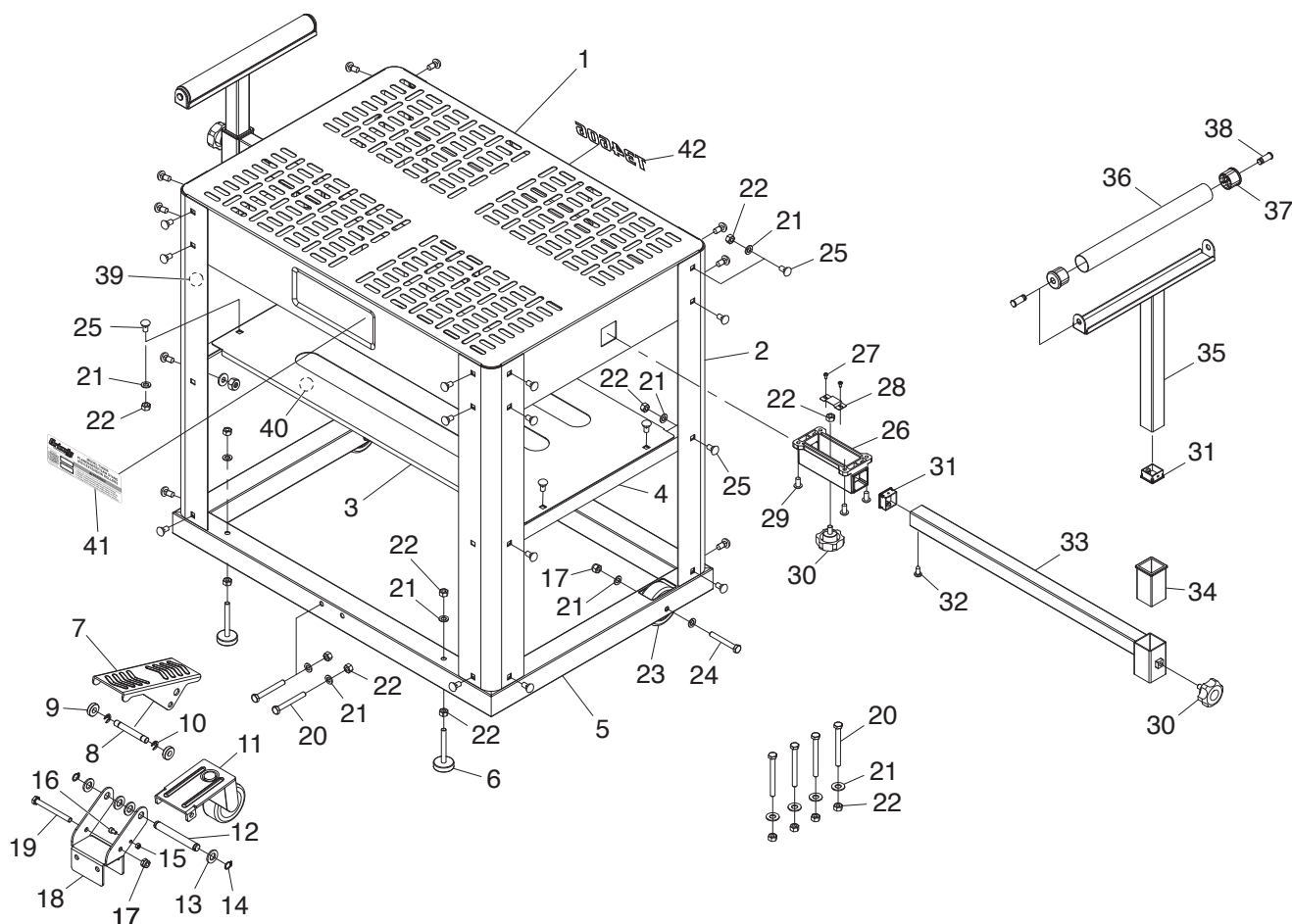

REF	PART #	DESCRIPTION
1	PT34606001	TABLE
2	PT34606002	LEG
3	PT34606003	SHELF
4	PT34606004	SHELF SUPPORT BRACKET
5	PT34606005	BASE
6	PT34606006	FOOT M8-1.25 X 68
7	PT34606007	FOOT PEDAL
8	PT34606008	PIVOT SHAFT 10 X 75MM
9	PT34606009	SPACER 6 X 10 X 23MM
10	PT34606010	E-CLIP 8MM
11	PT34606011	CASTER 72.5MM, SWIVEL
12	PT34606012	CAM SHAFT 12.7 X 100MM
13	PT34606013	FLAT WASHER 12MM
14	PT34606014	EXT RETAINING RING 12MM
15	PT34606015	HEX NUT M5-.8
16	PT34606016	HEX BOLT M5-.8 X 8
17	PT34606017	LOCK NUT M8-1.25
18	PT34606018	CASTER SUPPORT
19	PT34606019	HEX BOLT M8-1.25 X 100
20	PT34606020	HEX BOLT M8-1.25 X 60
21	PT34606021	FLAT WASHER 8MM

REF	PART #	DESCRIPTION
22	PT34606022	HEX NUT M8-1.25
23	PT34606023	WHEEL 8 X 30 X 72.5MM
25	PT34606025	CARRIAGE BOLT M8-1.25 X 16
26	PT34606026	EXTENSION GUIDE BRACKET
27	PT34606027	TAP SCREW #6 X 3/8
28	PT34606028	TENSION BRACKET
29	PT34606029	BUTTON HD CAP SCR M5-.8 X 10
30	PT34606030	KNOB BOLT M8-1.25 X 14
31	PT34606031	END CAP
32	PT34606032	TAP SCREW #8 X 1/2
33	PT34606033	EXTENSION ARM
34	PT34606034	ROLLER SUPPORT SLEEVE
35	PT34606035	ROLLER SUPPORT
36	PT34606036	ROLLER 32 X 300MM, STEEL
37	PT34606037	ROLLER CAP
38	PT34606038	AXLE PIN
39	PT34606039	TOUCH-UP PAINT, GLOSSY BLACK
40	PT34606040	TOUCH-UP PAINT, GRIZZLY GREEN
41	PT34606041	MACHINE ID LABEL
42	PT34606042	MODEL NUMBER LABEL

Please Note: We do our best to stock replacement parts whenever possible, but we cannot guarantee that all parts shown here are available for purchase. Call (800) 523-4777 or visit our online parts store at www.grizzly.com to check for availability.



Grizzly Industrial, Inc. warrants every product it sells for a period of **1 year** to the original purchaser from the date of purchase. This warranty does not apply to defects due directly or indirectly to misuse, abuse, negligence, accidents, repairs or alterations or lack of maintenance. This is Grizzly's sole written warranty and any and all warranties that may be implied by law, including any merchantability or fitness, for any particular purpose, are hereby limited to the duration of this written warranty. We do not warrant or represent that the merchandise complies with the provisions of any law or acts unless the manufacturer so warrants. In no event shall Grizzly's liability under this warranty exceed the purchase price paid for the product and any legal actions brought against Grizzly shall be tried in the State of Washington, County of Whatcom.

We shall in no event be liable for death, injuries to persons or property or for incidental, contingent, special, or consequential damages arising from the use of our products.

The manufacturers reserve the right to change specifications at any time because they constantly strive to achieve better quality equipment. We make every effort to ensure that our products meet high quality and durability standards and we hope you never need to use this warranty.

In the event you need to use this warranty, contact us by mail or phone and give us all the details. We will then issue you a "Return Number," which must be clearly posted on the outside as well as the inside of the carton. We will not accept any item back without this number. Proof of purchase must accompany the merchandise.

Please feel free to write or call us if you have any questions about the machine or the manual.

Thank you again for your business and continued support. We hope to serve you again soon.

For further information about the warranty, visit **<https://www.grizzly.com/forms/warranty>** or scan the QR code below to be automatically directed to our warranty page.





Buy Direct and Save with Grizzly® – Trusted, Proven and a Great Value!
~Since 1983~

*Visit Our Website Today For
Current Specials!*

**ORDER
24 HOURS A DAY!
1-800-523-4777**

