

# SECTION 10: PARTS

## Main

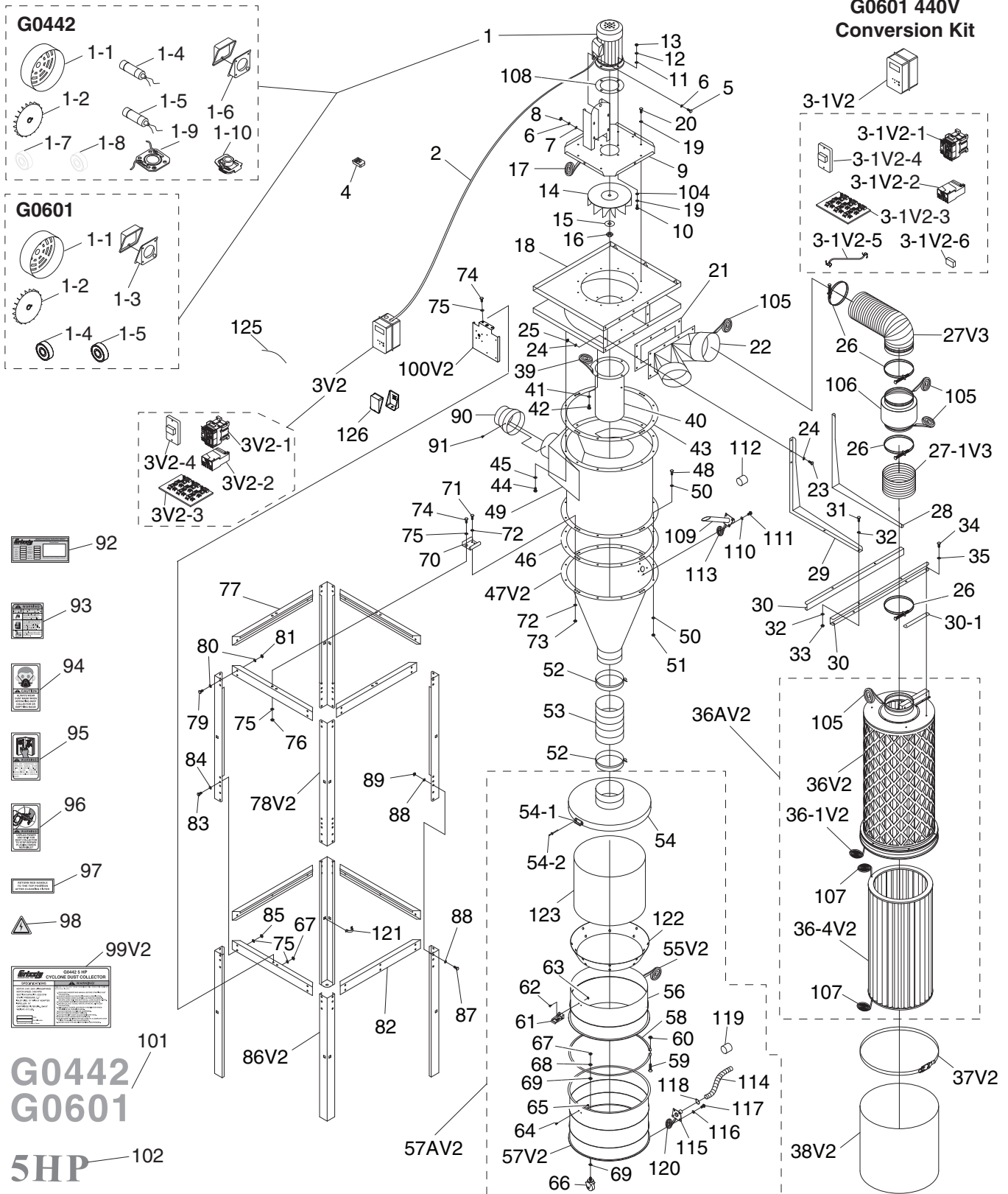

# G0442 Only Parts List

REF	PART #	DESCRIPTION
1	P0442001	MOTOR 5HP 220V 1-PH
1-1	P0442001-1	MOTOR FAN COVER
1-2	P0442001-2	MOTOR FAN
1-4	P0442001-4	S CAPACITOR 400M 250V 1-3/4 X 3-3/4
1-5	P0442001-5	R CAPACITOR 40M 450V
1-6	P0442001-6	JUNCTION BOX
1-7	P0442001-7	BALL BEARING 6207ZZ
1-8	P0442001-8	BALL BEARING 6205ZZ
1-9	P0442001-9	CONTACT PLATE
1-10	P0442001-10	CENTRIFUGAL SWITCH 3450 RPM
2	P0442002	MOTOR CORD 12G 3W

REF	PART #	DESCRIPTION
3V2	P0442003V2	CONT BOX ASSY 220V 1-PH V2.4.12
3V2-1	P0442003V2-1	CONTACTOR NHD C-18D 220V V2.04.12
3V2-2	P0442003V2-2	OL RELAY NHD NTH-25 21-25A
3V2-3	P0442003V2-3	CIRCUIT BOARD
3V2-4	P0442003V2-4	ON/OFF SWITCH 220V
99V2	P0442099V2	MACHINE ID LABEL CSA V2.01.12
100V2	P0442100V2	SWITCH BRACKET CSA V2.03.12
101	P0442101	MODEL NUMBER LABEL
125	P0442125	GREEN GROUNDING WIRE 12G 6"
126	P0442126	JUNCTION BOX

# G0601 Only Parts List

REF	PART #	DESCRIPTION
1	P0601001	MOTOR 5HP 220/440V 3-PH
1-1	P0601001-1	MOTOR FAN COVER
1-2	P0601001-2	MOTOR FAN
1-3	P0601001-3	JUNCTION BOX
1-4	P0601001-4	FRONT MOTOR BEARING
1-5	P0601001-5	REAR MOTOR BEARING
2	P0601002	MOTOR CORD 12G 4W 300V
3V2	P0601003V2	CONT BOX ASSY 220V 3-PH V2.04.12
3V2-1	P0601003V2-1	CONTACTOR NHD C-18D 220V
3V2-2	P0601003V2-2	OL RELAY NHD NTH-15 10-15A
3V2-3	P0601003V2-3	CIRCUIT BOARD
3V2-4	P0601003V2-4	ON/OFF SWITCH 220V

REF	PART #	DESCRIPTION
3-1V2	P0601003-1V2	CONT BOX ASSY 440V V2.04.12
3-1V2-1	P0601003-1V2-1	CONTACTOR NHD C-09D 440V
3-1V2-2	P0601003-1V2-2	OL RELAY NHD NTH-08 6-8A
3-1V2-3	P0601003-1V2-3	CIRCUIT BOARD
3-1V2-4	P0601003-1V2-4	ON/OFF SWITCH 440V
3-1V2-5	P0601003-1V2-5	MOTOR CORD 12G 4W 600V
3-1V2-6	P0601003-1V2-6	SWITCH TRANSFORMER 30VA
99V2	P0601099V2	MACHINE ID LABEL CSA V2.01.12
100V2	P0601100V2	SWITCH BRACKET CSA V2.03.12
101	P0601101	MODEL NUMBER LABEL
125	P0601125	GREEN GROUNDING WIRE 12G 6"
126	P0601126	JUNCTION BOX

# G0442/G0601 Common Parts List

REF	PART #	DESCRIPTION
4	P0442004	REMOTE CONTROLLER
5	P0442005	HEX BOLT 3/8-16 X 1-1/2
6	P0442006	FLAT WASHER 3/8
7	P0442007	LOCK WASHER 3/8
8	P0442008	HEX NUT 3/8-16
9	P0442009	BLOWER COVER
10	P0442010	HEX BOLT 1/2-13 X 1-1/2
11	P0442011	FENDER WASHER 1/2"
12	P0442012	LOCK WASHER 1/2
13	P0442013	HEX NUT 1/2-13
14	P0442014	IMPELLER 16"
15	P0442015	FLAT WASHER 3/4
16	P0442016	HEX NUT 3/4-16 LH
17	P0442017	FOAM TAPE 3 X 6 X 1800MM
18	P0442018	IMPELLER HOUSING
19	P0442019	FLAT WASHER 5/16

REF	PART #	DESCRIPTION
20	P0442020	HEX BOLT 5/16-18 X 3/4
21	P0442021	OUTLET GASKET 456 X 226MM
22	P0442022	OUTLET PORT
23	P0442023	HEX BOLT 5/16-18 X 1
24	P0442024	FLAT WASHER 5/16
25	P0442025	HEX NUT 5/16-18
26	P0442026	HOSE CLAMP 8"
27V3	P0442027V3	FLEXIBLE HOSE 8" X 23-1/2" V3.11.09
27-1V3	P0442027-1V3	FLEXIBLE HOSE 8" X 4-3/4" V3.11.09
28	P0442028	LEFT FILTER L-BRACE
29	P0442029	RIGHT FILTER L-BRACE
30	P0442030	FILTER CROSS BRACE
30-1	P0442030-1	BRACE GASKET 240 X 32MM
31	P0442031	HEX BOLT 3/8-16 X 3/4
32	P0442032	FLAT WASHER 3/8
33	P0442033	HEX NUT 3/8-16



# G0442/G0601 Common Parts List

REF	PART #	DESCRIPTION
34	P0442034	HEX BOLT 5/16-18 X 3/4
35	P0442035	FLAT WASHER 5/16
36AV2	P0442036AV2	CANISTER ASSEMBLY, GREEN V2.11.09
36V2	P0442036V2	CANISTER OUTER CAGE V2.11.09
36-1V2	P0442036-1V2	GASKET 3 X 25 X 1700MM V2.11.09
36-4V2	P0442036-4V2	CANISTER FILTER 486 X 995MM W/TAPE V2.11.09
37V2	P0442037V2	FILTER BAG CLAMP 545MM V2.11.09
38V2	P0442038V2	PLASTIC BAG 570 X 600MM V2.11.09
39	P0442039	FOAM TAPE 3 X 6 X 1800MM
40	P0442040	INTAKE CYLINDER 12"
41	P0442041	FLAT WASHER 5/16
42	P0442042	HEX BOLT 5/16-18 X 3/4
43	P0442043	BARREL GASKET 686MM DIA.
44	P0442044	HEX BOLT 5/16-18 X 3/4
45	P0442045	FLAT WASHER 5/16
46	P0442046	BARREL GASKET 686MM DIA.
47V2	P0442047V2	CYCLONE FUNNEL V2.08.10
48	P0442048	HEX BOLT 5/16-18 X 1
49	P0442049	INTAKE BARREL
50	P0442050	FLAT WASHER 5/16
51	P0442051	HEX NUT 5/16-18
52	P0442052	HOSE CLAMP 9"
53	P0442053	CLEAR FLEXIBLE PIPE 9" X 10"
54	P0442054	COLLECTION DRUM LID V2.08.06
54-1	P0442054-1	DRUM LID HOOK
54-2	P0442054-2	HOOK RIVET
55V2	P0442055V2	DRUM SEAL TYPE-R 2M V2.11.09
56	P0442056	UPPER DRUM 25GAL
57AV2	P0442057AV2	COLLECTION DRUM ASSY 55GAL V2.11.09
57V2	P0442057V2	COLLECTION DRUM 35GAL V2.08.10
58	P0442058	DRUM CLAMP
59	P0442059	HEX BOLT 5/16-18 X 3
60	P0442060	HEX NUT 5/16-18
61	P0442061	DRUM LID LATCH
62	P0442062	PHLP HD SCR 10-24 X 3/8
63	P0442063	HEX NUT 10-24
64	P0442064	PHLP HD SCR 10-24 X 3/8
65	P0442065	HEX NUT 10-24
66	P0442066	CASTER 2"
67	P0442067	HEX NUT 3/8-16
68	P0442068	LOCK WASHER 3/8
69	P0442069	FLAT WASHER 3/8
70	P0442070	COLLECTOR MOUNTING BRACKET
71	P0442071	HEX BOLT 5/16-18 X 1
72	P0442072	FLAT WASHER 5/16
73	P0442073	LOCK NUT 5/16-18

REF	PART #	DESCRIPTION
74	P0442074	HEX BOLT 3/8-16 X 3/4
75	P0442075	FLAT WASHER 3/8
76	P0442076	LOCK NUT 3/8-16
77	P0442077	UPPER STAND BRACE
78V2	P0442078V2	UPPER STAND LEG V2.08.10
79	P0442079	HEX BOLT 3/8-16 X 3/4
80	P0442080	FLAT WASHER 3/8
81	P0442081	LOCK NUT 3/8-16
82	P0442082	LOWER STAND BRACE
83	P0442083	HEX BOLT 3/8-16 X 3/4
84	P0442084	FLAT WASHER 3/8
85	P0442085	LOCK NUT 3/8-16
86V2	P0442086V2	LOWER STAND LEG V2.08.10
87	P0442087	HEX BOLT 3/8-16 X 3/4
88	P0442088	FLAT WASHER 3/8
89	P0442089	LOCK NUT 3/8-16
90	P0442090	REDUCER 10" TO 8"
91	P0442091	TAP SCREW M4 X 12
92	P0442092	MOTOR SPEC LABEL
93	P0442093	MOTOR WARNING LABEL
94	P0442094	GLASSES/RESPIRATOR DC LABEL
95	P0442095	READ MANUAL 2W X 3.3H
96	P0442096	HANDS/INLET LABEL
97	P0442097	RETURN RED HANDLE LABEL
98	P0442098	ELECTRICITY 1.4W X 1.2H
102	P0442102	HORSEPOWER LABEL
104	P0442104	EXT TOOTH WASHER 1/2
105	P0442105	FOAM TAPE 3 X 15 X 700MM
106	P0442106	NOISE MUFFLER 8"
107	P0442107	GASKET 35 X 38 X 1570MM V2.11.09
108	P0442108	MOTOR GASKET
109	P0442109	CYCLONE VACUUM PORT
110	P0442110	FLAT WASHER 5/16
111	P0442111	HEX BOLT 5/16-18 X 3/4
112	P0442112	PORT PLUG 1-1/4"
113	P0442113	FOAM TAPE 3 X 6 X 300MM
114	P0442114	VACUUM HOSE 1-1/4" X 98"
115	P0442115	COLLECTION DRUM VACUUM PORT
116	P0442116	FLAT WASHER 5/16
117	P0442117	HEX BOLT 5/16-18 X 3/4
118	P0442118	HOSE CLAMP 1-1/4"
119	P0442119	PORT PLUG 1-1/4"
120	P0442120	FOAM TAPE 3 X 6 X 300MM
121	P0442121	VACUUM HOSE CLIP 2-1/2"
122	P0442122	COLLECTION DRUM VACUUM RING
123	P0442123	DRUM COLLECTION BAG 640 X 1200MM

