

H8089 Parts Breakdown and List

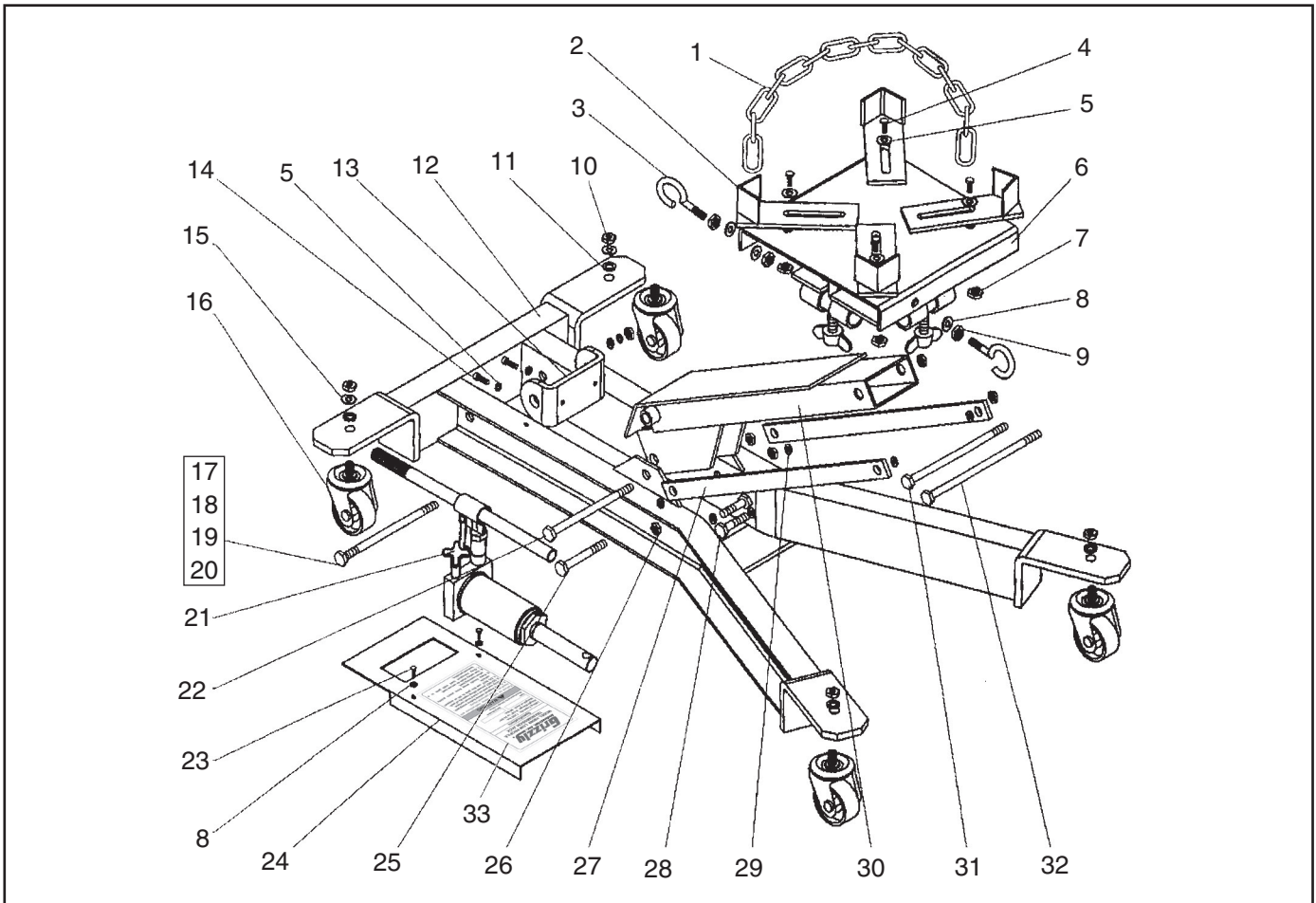

REF	PART #	DESCRIPTION
1	PH8089001	CHAIN
2	PH8089002	GUIDE PLATE
3	PH8089003	CHAIN HOOK
4	PB32M	HEX BOLT M10-1.5 X 25
5	PW04M	FLAT WASHER 10MM
6	PH8089006	GUIDE PLATE BASE
7	PN02M	HEX NUT M10-1.5
8	PW03M	FLAT WASHER 6MM
9	PN01M	HEX NUT M6-1
10	PN09M	HEX NUT M12-1.75
11	PLW03M	LOCK WASHER 6MM
12	PH8089012	BASE FRAME
13	PH8089013	RAM CONNECT PLATE
14	PSB61M	CAP SCREW M10-1.5 X 20
15	PW06M	FLAT WASHER 12MM
16	PH8089016	3" SWIVEL CASTER
17	PH8089017	HEX BOLT M16-2 X 225 GRADE 8.8

REF	PART #	DESCRIPTION
18	PLW10M	LOCK WASHER 16MM
19	PN13M	HEX NUT M16-2
20	PW08M	FLAT WASHER 16MM
21	PH8089021	HYDRAULIC PUMP ASSY
22	PH8089022	HEX BOLT M16-2 X 140 GRADE 8.8
23	PB83M	HEX BOLT M6-1 X 16
24	PH8089024	RAM COVER
25	PH8089025	HEX BOLT M14-2 X 65 GRADE 8.8
26	PH8089026	LOCK NUT M14-2
27	PH8089027	LONG CONNECTION BAR
28	PH8089028	HEX BOLT M14-2 X 70
29	PW10M	FLAT WASHER 14MM
30	PH8089030	LIFTING ARM
31	PH8089031	HEX BOLT M14-2 X 120
32	PH8089032	HEX BOLT M14-2 X 130
33	PH8089033	MACHINE ID LABEL

WARNING

The safety label warns about hazards and ways to prevent injury. The owner of the jack **MUST** maintain the original location and readability of the label. If the label is removed or becomes unreadable, contact Grizzly at (800) 523-4777 or www.grizzly.com to order a new label.