



MODEL T28941 WORK STOP MEASURING SYSTEM INSTRUCTIONS

For questions or help with this product contact Tech Support at (570) 546-9663 or techsupport@grizzly.com

Introduction

The Model T28941 Work Stop Measuring System is designed to work with the T30399 Infeed/Outfeed Roller Set to produce fast, repetitive, and accurate cuts.

Inventory

Description	Qty
A. Carriage Rail	1
B. Measuring Tape.....	1
C. Adjustable Push Bar.....	1
D. Rail Extension	1
E. Extension Bracket	1
F. Workpiece Stop	1
G. Carriage.....	1
H. Cap Screws M6-1 x 12	4
I. Cap Screw M8-1.25 x 10	1
J. Cap Screws M8-1.25 x 55	4
K. Flat Washers 8mm	4
L. Spacers 11ID x 17OD x 38	4
M. Hex Bolts M6-1 x 16	2
N. Lock Handle	1
O. Steel Ball 10mm	1
P. Workpiece Guide.....	1

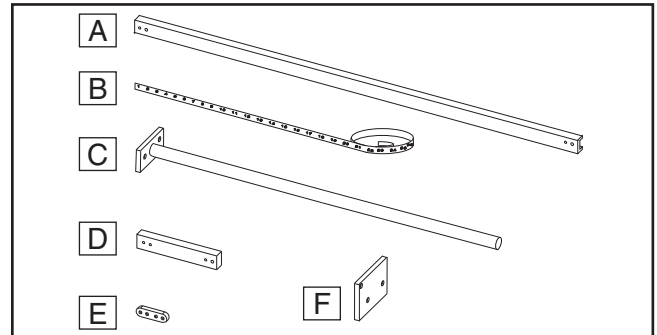

Figure 1. Model T28941 inventory.

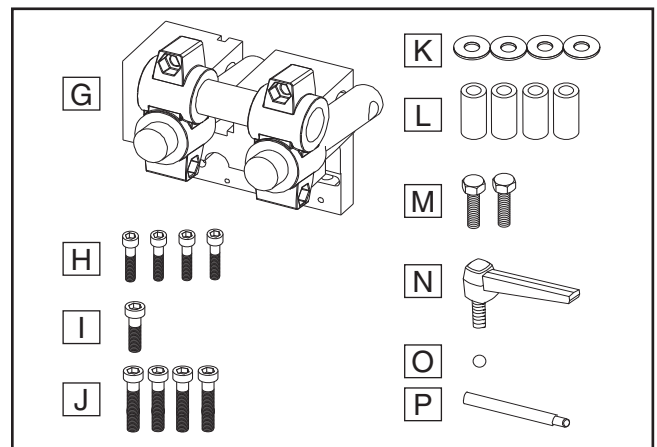

Figure 2. Carriage and hardware.

Needed for Setup

Description	Qty
A. G0613/G0614 Metal Bandsaw.....	1
B. Assembled/Mounted T30399 Roller Set	1
C. Hex Wrenches 5, 6mm.....	1 Ea.
D. Wrench or Socket 6mm.....	1

Assembly

1. Attach rail extension to carriage rail with extension bracket and (4) M6-1 x 12 cap screws (see **Figure 3**). Attach rail extension to side of carriage rail shown in **Figure 4**, as it will need clearance when rail is attached to machine.

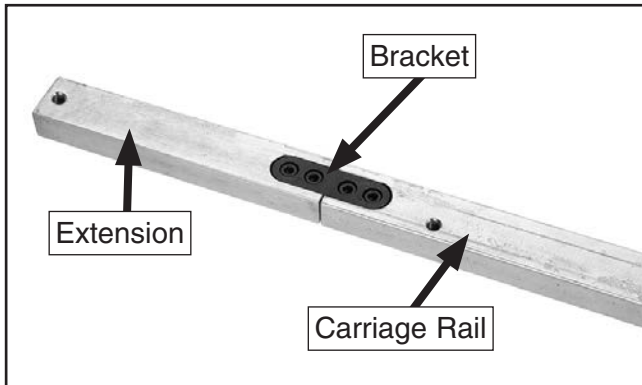

Figure 3. Rail extension attached to carriage rail.

2. Attach carriage rail to roller table using (4) M8-1.25 x 55 cap screws, (4) 8mm washers, and (4) spacers (see **Figure 4**).

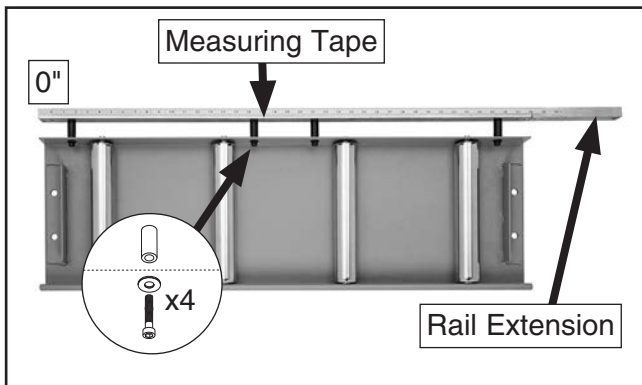

Figure 4. Roller table with extended rail.

3. Unroll measuring tape and affix to the full measuring rail assembled in **Step 2**. Take care to line up the edge, beginning at 0" (see **Figure 4**).

4. Attach workpiece stop to end of push bar using (2) M6-1 x 16 hex bolts (see **Figure 5**).

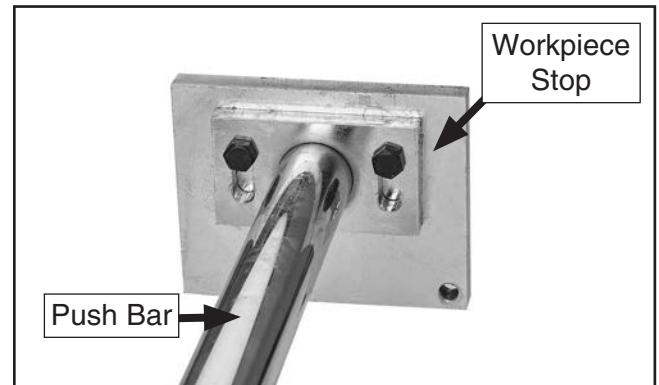

Figure 5. Workpiece stop and push bar.

5. Slide carriage onto measuring rail. Measure gauge on carriage should depict measuring numbers, or carriage is backwards (see **Figure 6**).

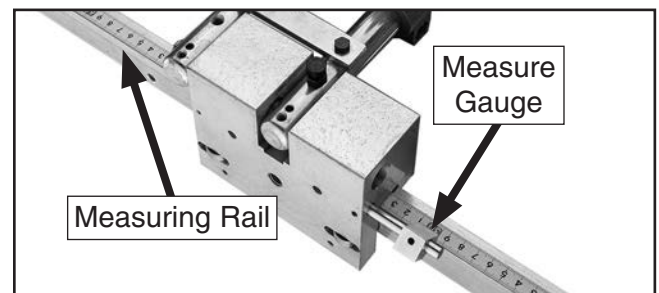

Figure 6. Assembled carriage and rail (roller table removed for clarity).

6. Thread M8-1.25 x 10 cap screw into end of rail extension to secure (see **Figure 7**).

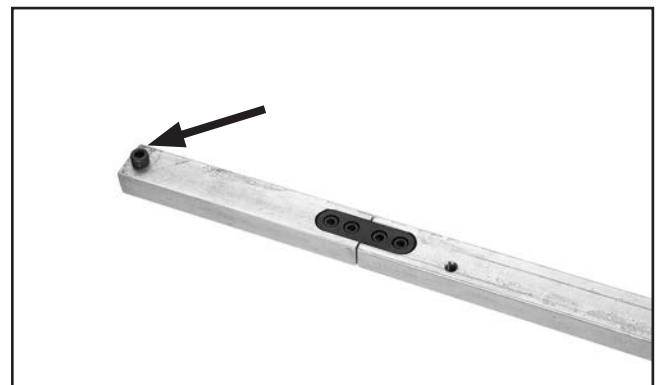

Figure 7. Rail extension cap screw.



7. Insert steel ball into hole at back of carriage (see **Figure 8**) and secure by screwing in lock handle. Use this handle to position and lock carriage at different measurements.

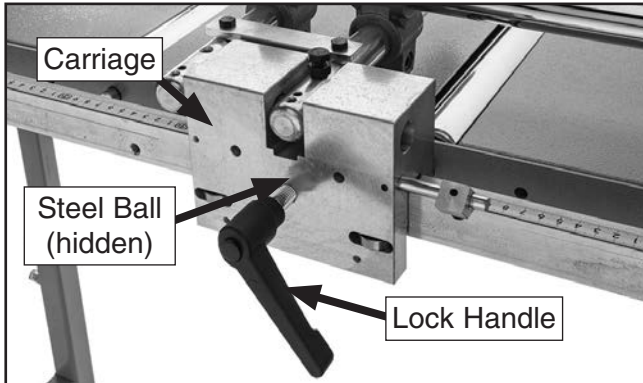

Figure 8. Steel ball secured by lock handle.

8. Set and lock measuring gauge at 0" then line up push bar mounts at base of carriage (see **Figure 9**). Slide push bar through mounts with workpiece stop positioned on bandsaw side.

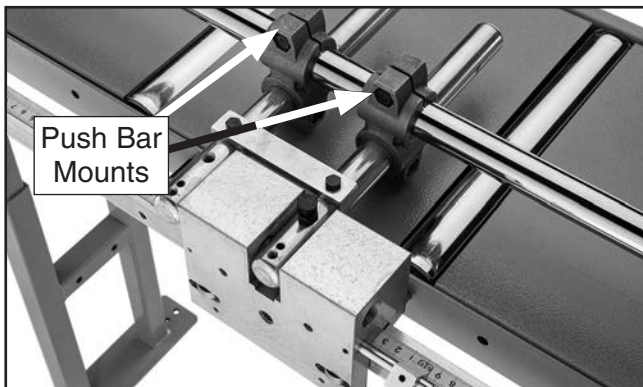

Figure 9. Push bar and mounts.

9. Align workpiece stop with workpiece where it will contact bandsaw blade (see **Figure 10**).

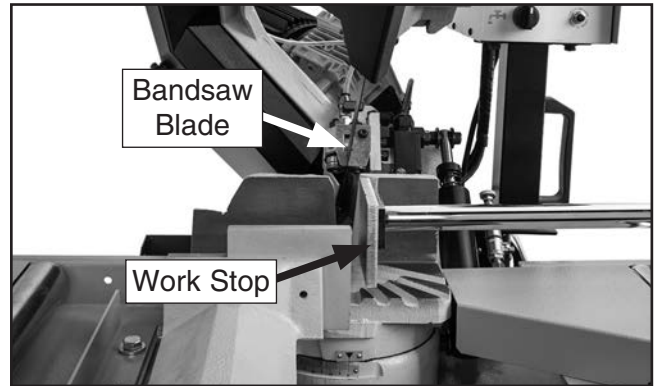

Figure 10. Push bar aligned with workpiece cutting point.

10. Tighten pre-installed hardware in bar mounts.
11. For cuts larger than 8", attach workpiece guide to workpiece stop by screwing guide threads into corner hole of stop (see **Figure 11**).

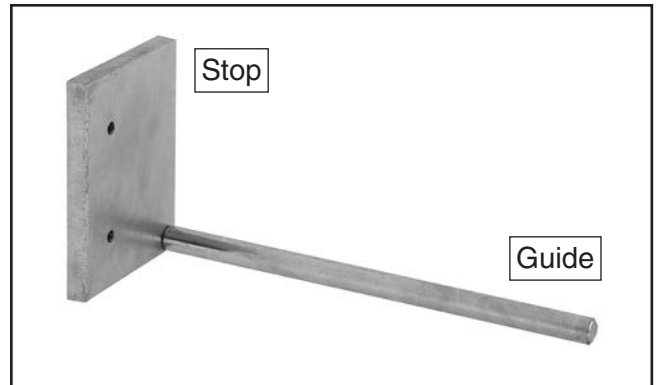
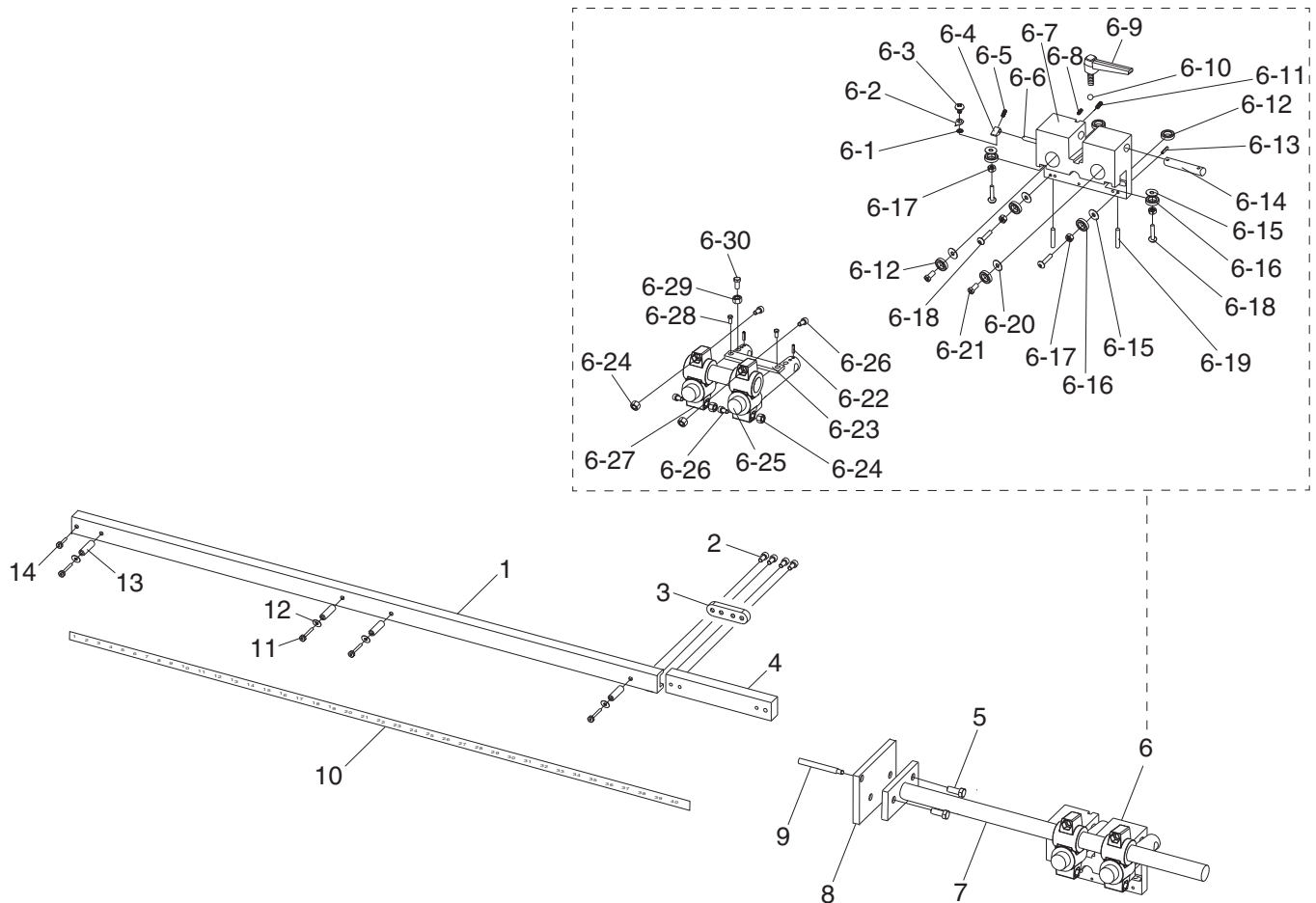

Figure 11. Workpiece guide and stop. (Other assembled parts removed for clarity).



T28941 Parts Breakdown



REF	PART #	DESCRIPTION
1	PT28941001	CARRIAGE RAIL
2	PT28941002	CAP SCREW M6-1 X 12
3	PT28941003	EXTENSION BRACKET
4	PT28941004	RAIL EXTENSION
5	PT28941005	HEX BOLT M6-1 X 16
6	PT28941006	CARRIAGE
6-1	PT28941006-1	EXT TOOTH WASHER 5MM
6-2	PT28941006-2	MEASURING POINTER
6-3	PT28941006-3	PHLP HD SCR M5-.8 X 6
6-4	PT28941006-4	MEASURING WEDGE
6-5	PT28941006-5	SET SCREW M5-.8 X 6
6-6	PT28941006-6	MEASURING ROD
6-7	PT28941006-7	CARRIAGE BODY
6-8	PT28941006-8	SET SCREW M4-.7 X 6
6-9	PT28941006-9	ADJ HANDLE 25 X 80, M12-1.75 X 40
6-10	PT28941006-10	STEEL BALL 10MM
6-11	PT28941006-11	SET SCREW 8-32 X 1/4
6-12	PT28941006-12	BALL BEARING 608-2RS
6-13	PT28941006-13	ROLL PIN 5 X 20
6-14	PT28941006-14	CARRIAGE CONNECTING LOCK
6-15	PT28941006-15	FLAT WASHER 8MM
6-16	PT28941006-16	BALL BEARING 608-2RS

REF	PART #	DESCRIPTION
6-17	PT28941006-17	HEX NUT M5-.8
6-18	PT28941006-18	BUTTON HD CAP SCR M5-.8 X 20
6-19	PT28941006-19	BEARING BAR
6-20	PT28941006-20	FLAT WASHER 5MM
6-21	PT28941006-21	CAP SCREW M8-1.25 X 20
6-22	PT28941006-22	ROLL PIN 5 X 25
6-23	PT28941006-23	CROSS BAR
6-24	PT28941006-24	LOCK NUT M8-1.25
6-25	PT28941006-25	CARRIAGE MOUNT BAR
6-26	PT28941006-26	CAP SCREW M8-1.25 X 25
6-27	PT28941006-27	CARRIAGE MOUNT
6-28	PT28941006-28	HEX BOLT M6-1 X 16
6-29	PT28941006-29	HEX NUT M8-1.25
6-30	PT28941006-30	HEX BOLT M8-1.25 X 45
7	PT28941007	ADJUSTABLE PUSH BAR
8	PT28941008	WORKPIECE STOP
9	PT28941009	WORKPIECE GUIDE
10	PT28941010	MEASURING TAPE
11	PT28941011	CAP SCREW M8-1.25 X 55
12	PT28941012	FLAT WASHER 8MM
13	PT28941013	SPACER 11ID X 17OD X 38
14	PT28941014	CAP SCREW M8-1.25 X 10

Please Note: We do our best to stock replacement parts whenever possible, but we cannot guarantee that all parts shown here are available for purchase. Call (800) 523-4777 or visit our online parts store at www.grizzly.com to check for availability.

