

READ THIS FIRST



For questions or help with this product contact Tech Support at (570) 546-9663 or techsupport@grizzly.com

Model T33955/T33956

*****IMPORTANT UPDATE*****

**For Machines Mfd. Since 09/23
and Owner's Manual Printed 12/23**

The following changes were recently made since the owner's manual was printed:

- Parts descriptions have been updated.
- Manual sub-sections have been updated.
- Manual sub-section **Installing Nut** has been removed. Nut comes pre-installed on neck.

Aside from this information, all other content in the owner's manual applies and **MUST** be read and understood for your own safety. **IMPORTANT: Keep this update with the owner's manual for future reference.**

For questions or help, contact our Tech Support at (570) 546-9663 or techsupport@grizzly.com.

SECTION 8: PARTS

We do our best to stock replacement parts when possible, but we cannot guarantee that all parts shown are available for purchase. Call **(800) 523-4777** or visit **www.grizzly.com/parts** to check for availability.

Main

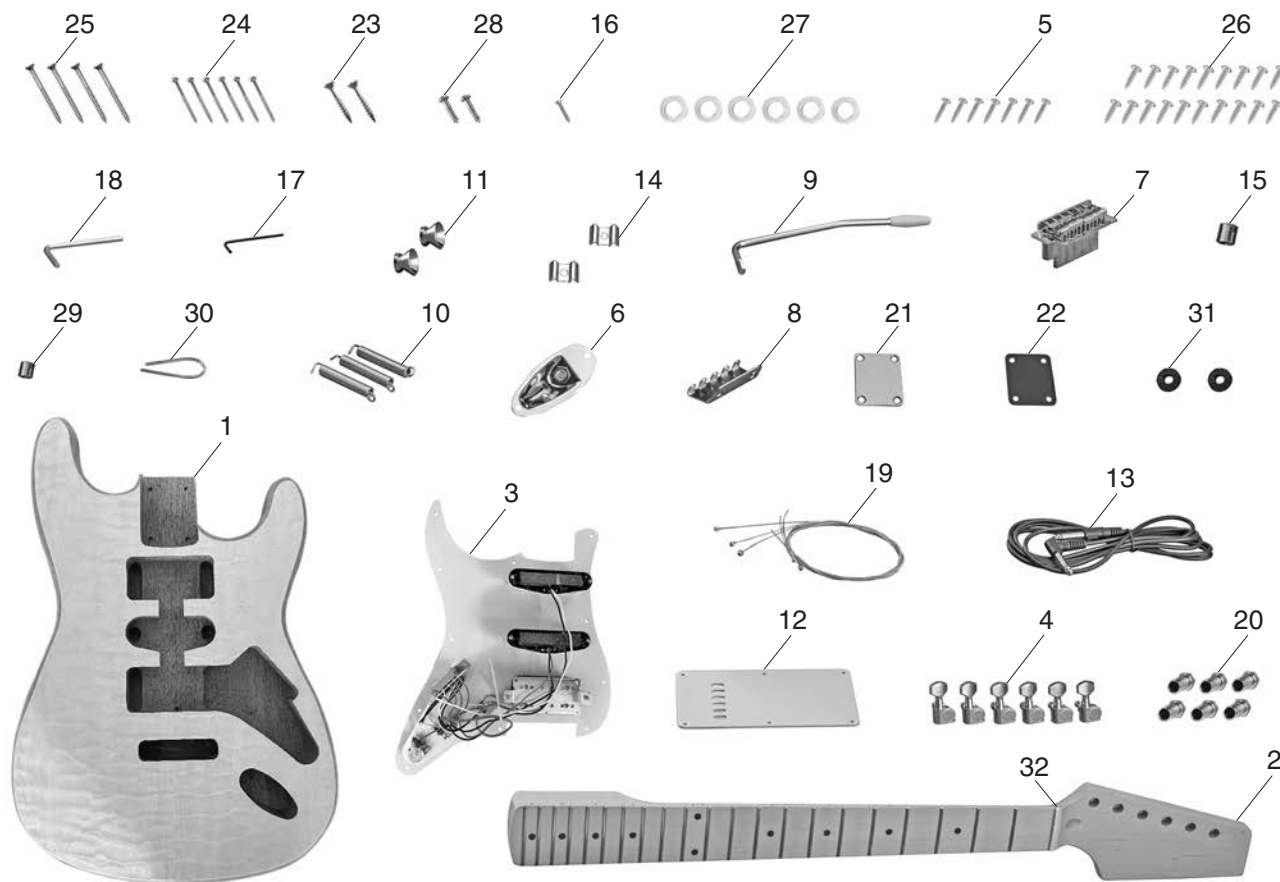

| REF | PART # | DESCRIPTION |
|-----|------------|---------------------------------|
| 1 | PT33955001 | BODY, QUILTED MAPLE (T33955) |
| 1 | PT33956001 | BODY, FIDDLEBACK MAPLE (T33956) |
| 2 | PT33955002 | NECK |
| 3 | PT33955003 | PICK GUARD |
| 4 | PT33955004 | TUNING MACHINE |
| 5 | PT33955005 | TAP SCREW M2.2 X 10 |
| 6 | PT33955006 | OUTPUT JACK |
| 7 | PT33955007 | TREMOLO BRIDGE |
| 8 | PT33955008 | SPRING HANGER |
| 9 | PT33955009 | TREMOLO ARM |
| 10 | PT33955010 | TREMOLO SPRING |
| 11 | PT33955011 | STRAP BUTTON |
| 12 | PT33955012 | BACK PLATE |
| 13 | PT33955013 | GUUITAR CABLE |
| 14 | PT33955014 | STRING RETAINER |
| 15 | PT33955015 | BUSHING 2.5 X 5 X 5MM |
| 16 | PT33955016 | WOOD SCREW M2.2 X 12 |

| REF | PART # | DESCRIPTION |
|-----|------------|---------------------------------------|
| 17 | PT33955017 | HEX WRENCH 1.5MM |
| 18 | PT33955018 | HEX WRENCH 4MM |
| 19 | PT33955019 | STRING SET |
| 20 | PT33955020 | TUNING MACHINE SEAT |
| 21 | PT33955021 | NECK PLATE GASKET |
| 22 | PT33955022 | NECK PLATE |
| 23 | PT33955023 | WOOD SCREW M4 X 32 |
| 24 | PT33955024 | WOOD SCREW M4 X 25 |
| 25 | PT33955025 | WOOD SCREW M5 X 40 |
| 26 | PT33955026 | TAP SCREW M2.5 X 8 |
| 27 | PT33955027 | TUNING MACHINE WASHER 8 X 14 X 1 |
| 28 | PT33955028 | WOOD SCREW M3 X 20 |
| 29 | PT33955029 | BUSHING 2.5 X 5 X 2.5MM |
| 30 | PT33955030 | SOLDERING WIRE 60/40 ROSIN-CORE .062" |
| 31 | PT33955031 | PAD 4 X 10 X 1.5MM |
| 32 | PT33955032 | NUT |





Buy Direct and Save with Grizzly® – Trusted, Proven and a Great Value!
~Since 1983~

*Visit Our Website Today For
Current Specials!*

**ORDER
24 HOURS A DAY!
1-800-523-4777**



SECTION 8: PARTS

We do our best to stock replacement parts when possible, but we cannot guarantee that all parts shown are available for purchase. Call (800) 523-4777 or visit www.grizzly.com/parts to check for availability.

Main

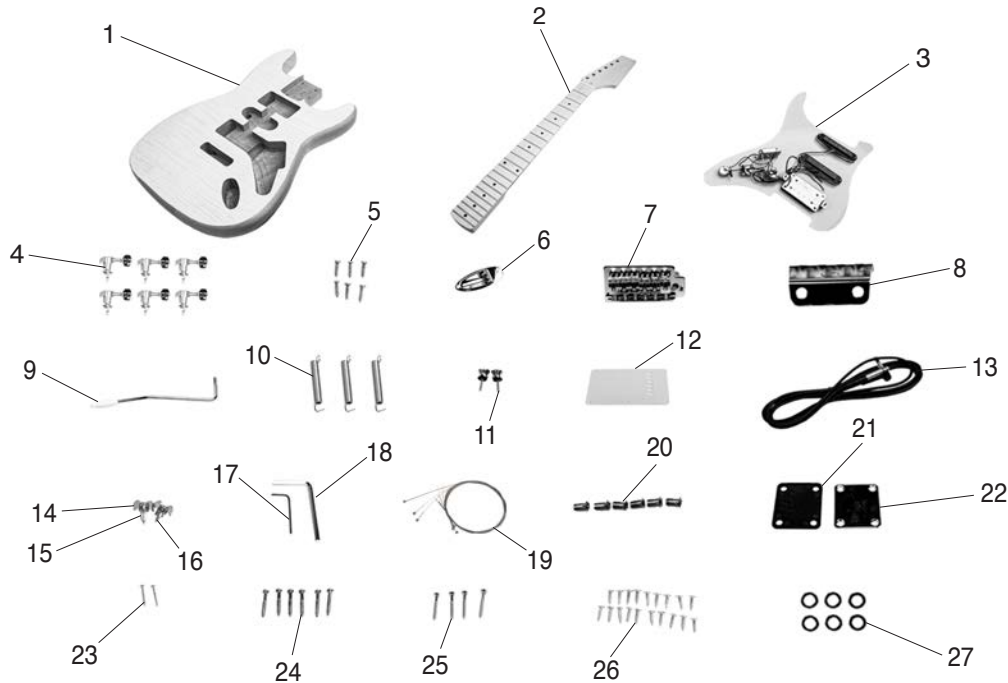

| REF | PART # | DESCRIPTION |
|-----|------------|-----------------------|
| 1 | PT33955001 | BODY QUILTED MAPLE |
| 1 | PT33956001 | BODY FIDDLEBACK MAPLE |
| 2 | PT33955002 | NECK |
| 3 | PT33955003 | PICK GUARD |
| 4 | PT33955004 | TUNING MACHINE |
| 5 | PT33955005 | PHLP HD SCR M2 X 14 |
| 6 | PT33955006 | OUTPUT JACK |
| 7 | PT33955007 | TREMOLO BRIDGE |
| 8 | PT33955008 | SPRING HANGER |
| 9 | PT33955009 | TREMOLO ARM |
| 10 | PT33955010 | TREMOLO SPRING |
| 11 | PT33955011 | STRAP BUTTON |
| 12 | PT33955012 | BACK PLATE |
| 13 | PT33955013 | GUITAR CABLE |

| REF | PART # | DESCRIPTION |
|-----|------------|-----------------------|
| 14 | PT33955014 | STRING RETAINER |
| 15 | PT33955015 | BUSHING 4 X 5 X 3 |
| 16 | PT33955016 | PHLP HD SCR M2.5 X 14 |
| 17 | PT33955017 | HEX WRENCH 1.5MM |
| 18 | PT33955018 | HEX WRENCH 4MM |
| 19 | PT33955019 | STRING SET |
| 20 | PT33955020 | TUNING MACHINE SEAT |
| 21 | PT33955021 | NECK PLATE GASKET |
| 22 | PT33955022 | NECK PLATE |
| 23 | PT33955023 | PHLP HD SCR M3.5 X 30 |
| 24 | PT33955024 | PHLP HD SCR M4 X 50 |
| 25 | PT33955025 | PHLP HD SCR M5 X 45 |
| 26 | PT33955026 | PHLP HD SCR M3 X 12 |
| 27 | PT33955027 | TUNING MACHINE WASHER |

