

To install extension wings:

1. DISCONNECT MACHINE FROM POWER!
2. Clean and inspect machine table edges.

IMPORTANT: Models manufactured after 12/23 come with pre-drilled screw holes. If your Model G1026 has pre-drilled screw holes on both sides, proceed to **Step 10**.

3. Align mounting template with top edge of table (see **Figure 2**), and ensure key on mounting template is aligned with table miter slot.

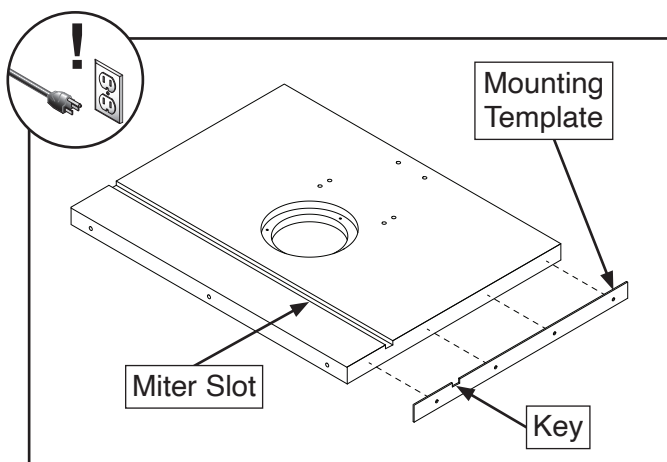

Figure 2. Positioning mounting template.

4. Tape mounting template in place.
5. Use 4mm bit to drill pilot holes through table at each of (4) guide holes in mounting template.
6. Repeat **Steps 3–5** on opposite side of table.
7. Remove mounting template.
8. Enlarge all eight pilot holes using $\frac{5}{16}$ " drill bit.
9. Use $\frac{3}{8}$ "-16 plug tap to cut threads clockwise in drilled holes.
10. Align extension wings with tapped holes and secure with (8) $\frac{3}{8}$ "-16 x $1\frac{1}{4}$ " cap screws, $\frac{3}{8}$ " lock washers, and $\frac{3}{8}$ " flat washers (see **Figure 3**).

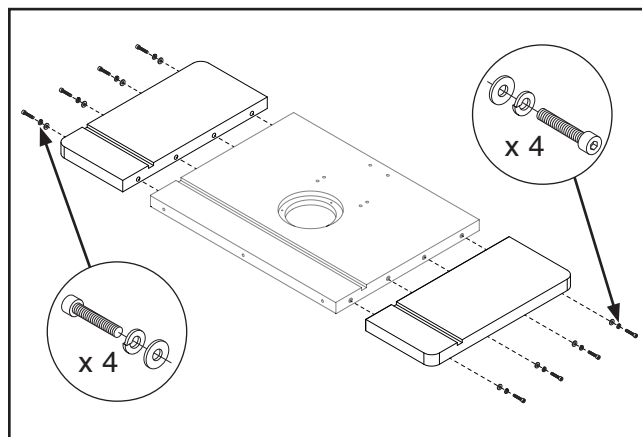
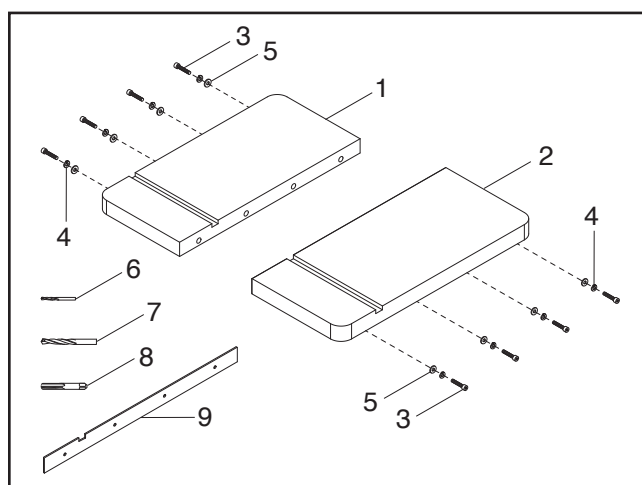

Figure 3. Attaching extension wings.

T34064 Parts Breakdown & List



REF	PART #	DESCRIPTION
1	PT34064001	EXTENSION WING (LEFT)
2	PT34064002	EXTENSION WING (RIGHT)
3	PT34064003	CAP SCREW 3/8-16 X 1-1/4
4	PT34064004	LOCK WASHER 3/8
5	PT34064005	FLAT WASHER 3/8
6	PT34064006	DRILL BIT 4MM
7	PT34064007	DRILL BIT 5/16
8	PT34064008	PLUG TAP 3/8-16
9	PT34064009	MOUNTING TEMPLATE

Please Note: We do our best to stock replacement parts when possible, but we cannot guarantee that all parts shown are available for purchase. Call (800) 523-4777 or visit www.grizzly.com/parts to check for availability.

