

## To install extension wings:

1. DISCONNECT MACHINE FROM POWER!
2. Clean and inspect machine table edges.

**IMPORTANT:** Models manufactured after 12/23 come with pre-drilled screw holes. If your Model G1035 has pre-drilled screw holes on both sides, proceed to **Step 10**.

3. Align mounting template with top edge of table (see **Figure 2**), and ensure key on mounting template is aligned with table miter slot.

**Note:** G1035 models manufactured before 12/23 have (3) pre-drilled holes on right-hand side, but (2) additional holes will still need to be drilled to install right extension wing.

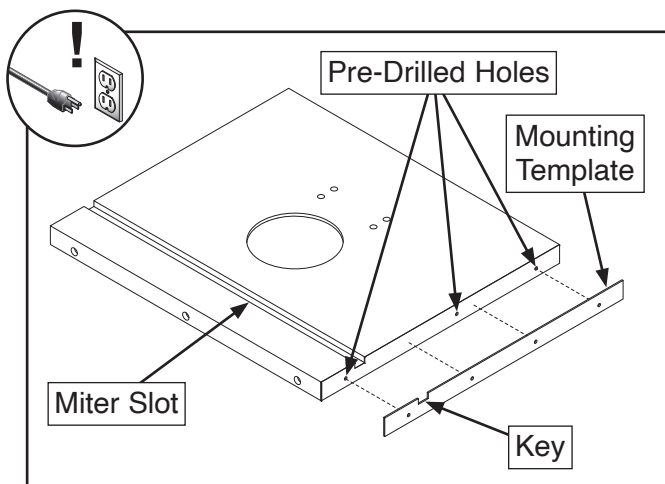

**Figure 2.** Positioning mounting template.

4. Tape mounting template in place.
5. Use 4mm bit to drill pilot holes through right side of table at (2) middle guide holes in mounting template.
6. Repeat **Steps 3–5** on left side of table, using all (4) guide holes in mounting template.
7. Remove mounting template.
8. Enlarge all (6) pilot holes using  $\frac{5}{16}$ " drill bit.
9. Use  $\frac{3}{8}$ "-16 plug tap to cut threads clockwise in freshly drilled holes.

10. Align extension wings with tapped holes and secure with (8)  $\frac{3}{8}$ "-16 x  $1\frac{1}{4}$ " cap screws,  $\frac{3}{8}$ " lock washers, and  $\frac{3}{8}$ " flat washers (see **Figure 3**).

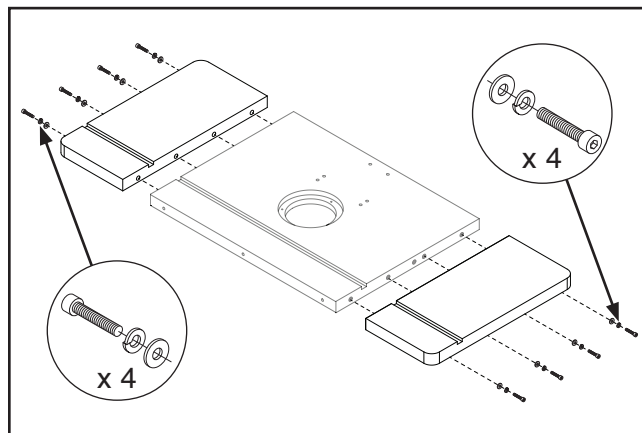

**Figure 3.** Attaching extension wings.

## T34065 Parts Breakdown & List

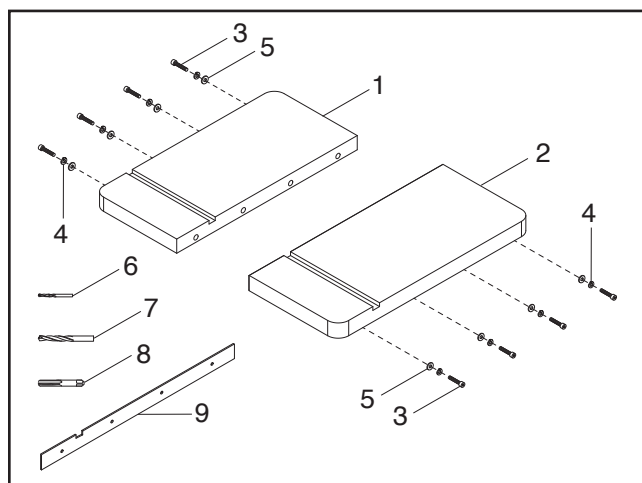

REF	PART #	DESCRIPTION
1	PT34065001	EXTENSION WING (LEFT)
2	PT34065002	EXTENSION WING (RIGHT)
3	PT34065003	CAP SCREW 3/8-16 X 1-1/4
4	PT34065004	LOCK WASHER 3/8
5	PT34065005	FLAT WASHER 3/8
6	PT34065006	DRILL BIT 4MM
7	PT34065007	DRILL BIT 5/16
8	PT34065008	PLUG TAP 3/8-16
9	PT34065009	MOUNTING TEMPLATE

**Please Note:** We do our best to stock replacement parts when possible, but we cannot guarantee that all parts shown are available for purchase. Call (800) 523-4777 or visit [www.grizzly.com/parts](http://www.grizzly.com/parts) to check for availability.

