

4. Thread (4) M6-1 x 10 button head cap screws through extension wing and into mounting brackets, then hand tighten (see **Figure 4**).

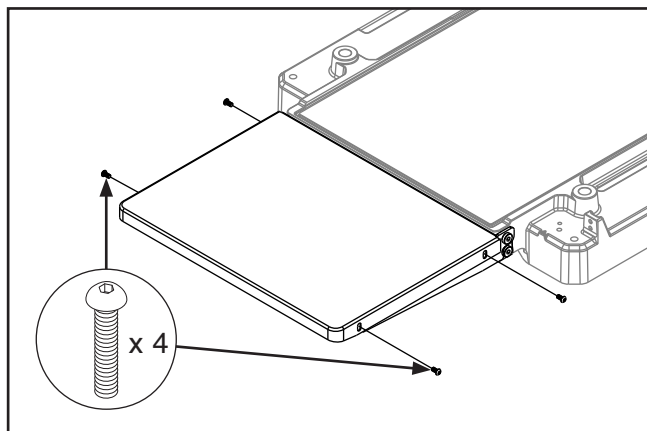
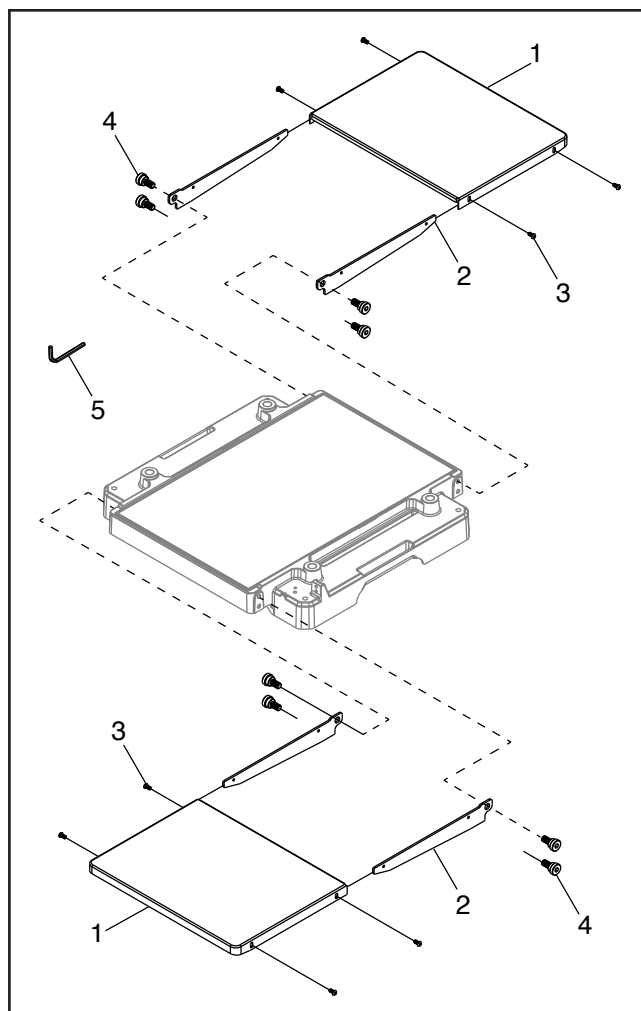

Figure 4. Location of extension wing fasteners.

5. Repeat **Steps 3–4** for rear extension wing.
6. Place straightedge across extension wings and machine table to verify they are aligned. Make adjustments as necessary.
7. Once extension wings are aligned, fully tighten fasteners from **Step 4**.

T34360 Parts Breakdown & List



| REF | PART # | DESCRIPTION |
|-----|------------|-------------------------------------|
| 1 | PT34360001 | EXTENSION WING |
| 2 | PT34360002 | MOUNTING BRACKET |
| 3 | PT34360003 | BUTTON HD CAP SCR M6-1 X 10 |
| 4 | PT34360004 | SHOULDER SCREW M8-1.25 X 12, 4 X 13 |
| 5 | PT34360005 | HEX WRENCH 4MM |

Please Note: We do our best to stock replacement parts when possible, but we cannot guarantee that all parts shown are available for purchase. Call **(800) 523-4777** or visit **www.grizzly.com/parts** to check for availability.

