

CORNHOLE BOARDS

ASSEMBLY INSTRUCTIONS

Built in strict accordance to official 24" x 48" American Cornhole Association regulations, this build features shadow box-style construction, using mitered corners and precision biscuit joinery to hide unsightly plywood layers under beautiful solid wood sides. Threaded inserts are also featured to conceal leg hardware.

Visit playcornhole.org for rules, regulations, and more!

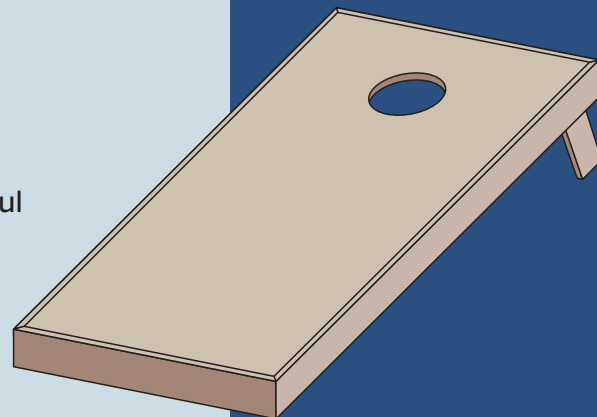

⚠ WARNING
Wear safety glasses during
the entire setup process!

grizzly.com[®]

CORNHOLE BOARDS

ANATOMIC VIEW

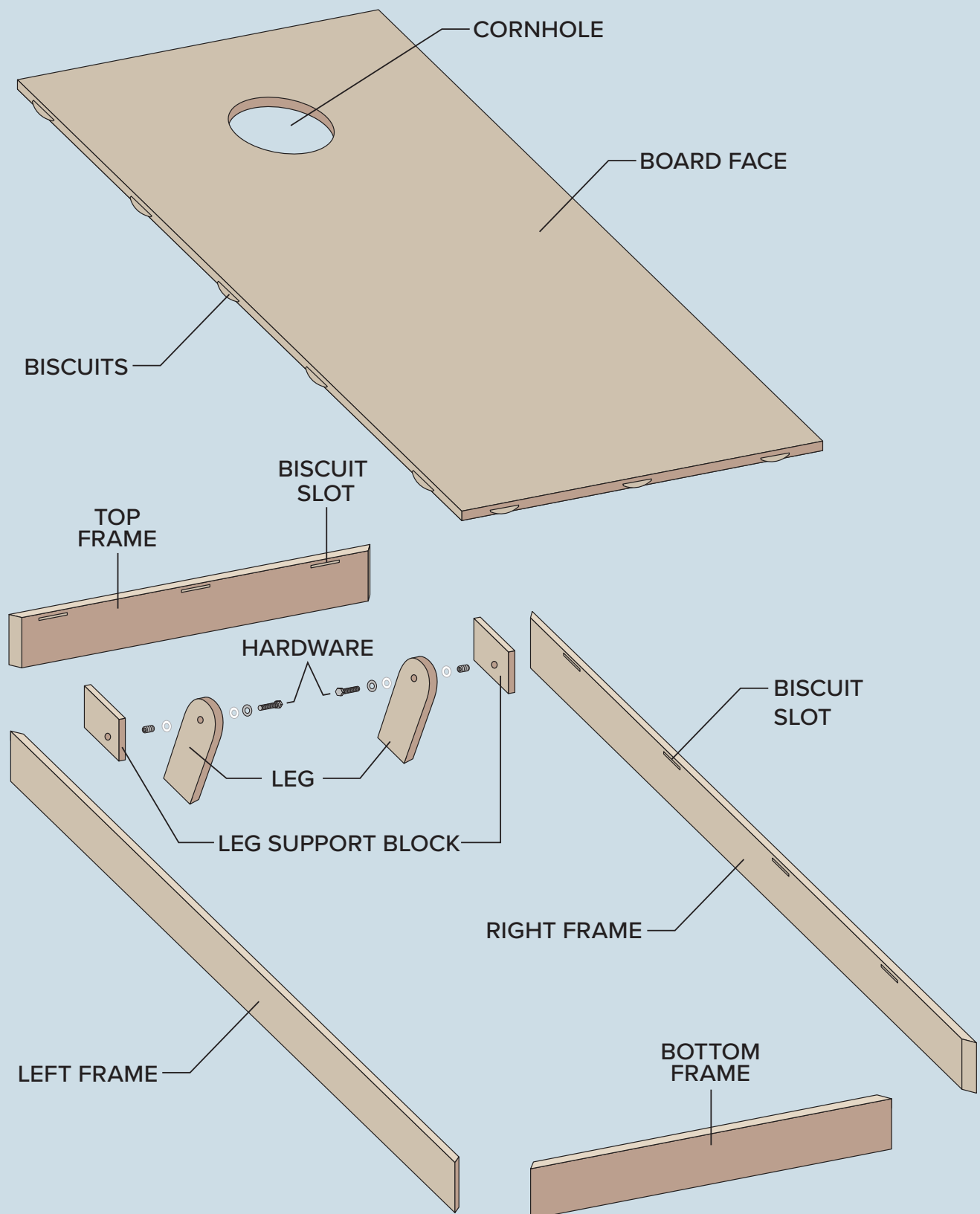

CORNHOLE BOARDS

CUT SHEET

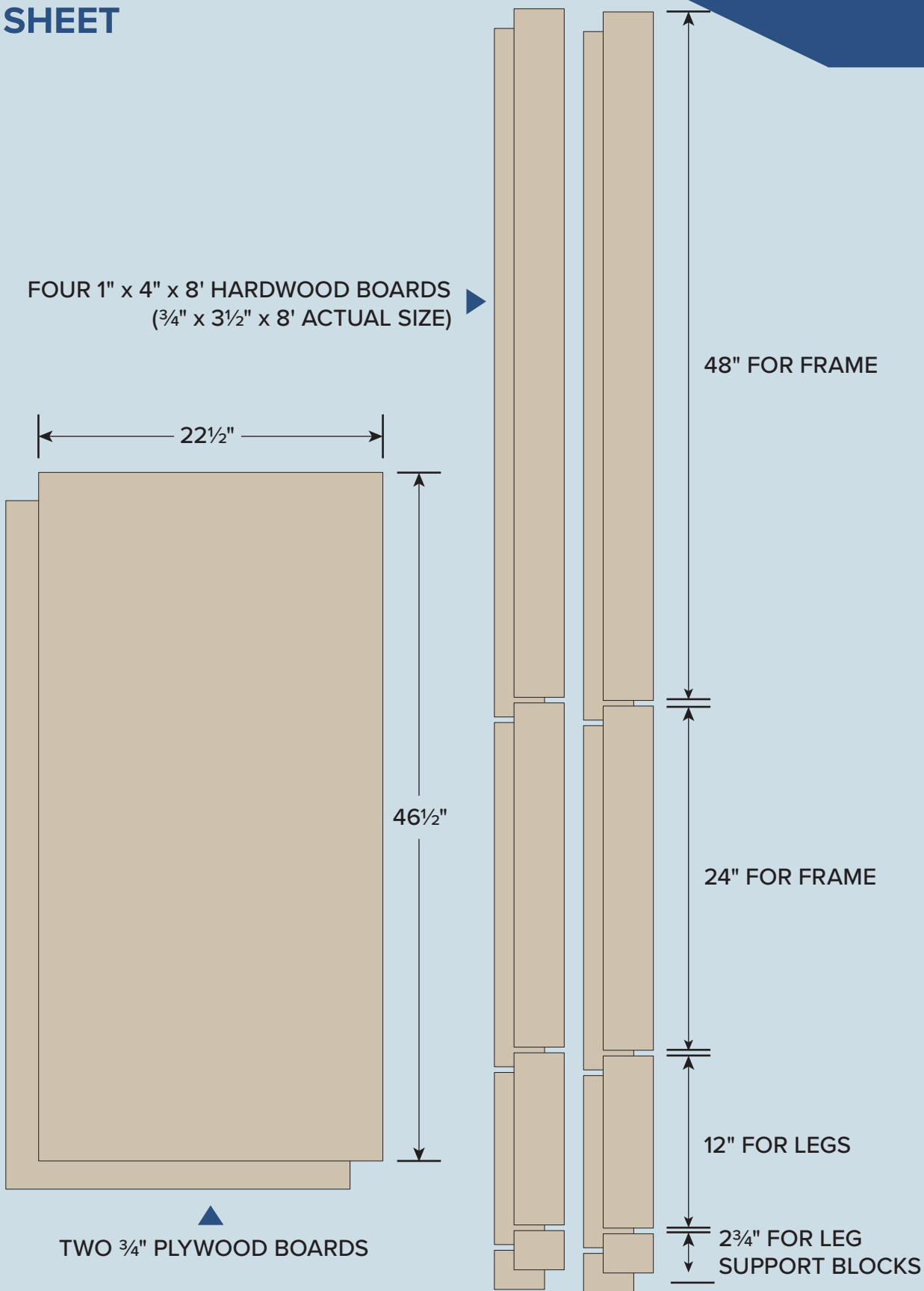

CORNHOLE BOARDS

LIST OF ADDITIONAL MATERIALS

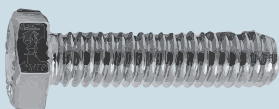

HEX BOLTS
4 @ 5/16"-18 X 1½



THREADED INSERTS
4 @ 5/16"-18

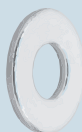

FLAT WASHERS
4 @ 5/16"



THIN NYLON WASHERS
8 @ 5/16"



BISCUITS
28 @ #20

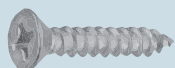

WOOD SCREWS
8 @ #8 1¼"



SUPERGLUE, WOOD GLUE

CORNHOLE BOARDS

BUILD INSTRUCTIONS PAGE 1 OF 7

TOP BOARD CUTTING

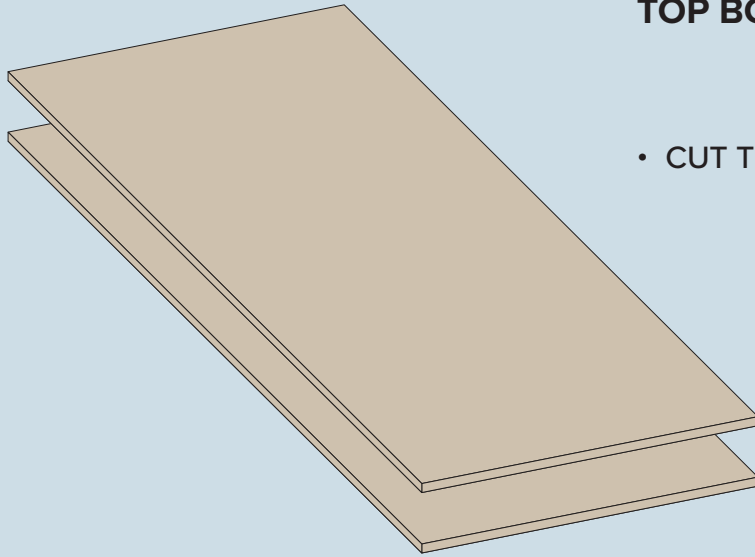

- CUT TWO 22½" X 46½" PLYWOOD BOARDS.

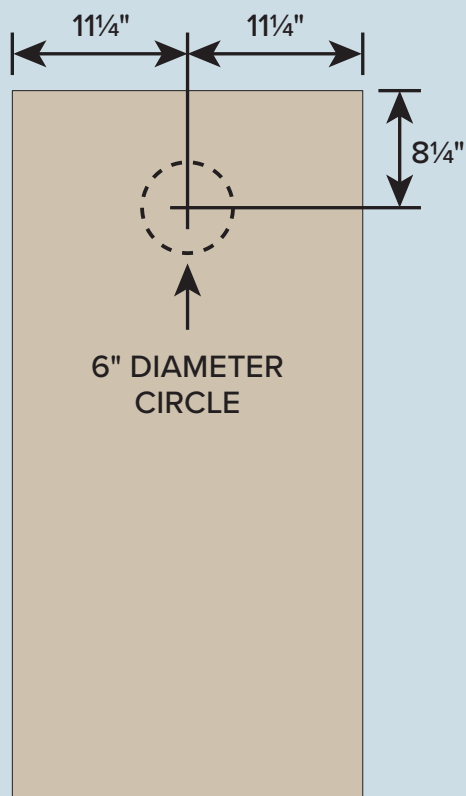

- OFFICIAL CORNHOLE REGULATIONS STATE THAT THE CENTER OF THE 6" HOLE IS 9" FROM THE TOP OF THE BOARD.
- SINCE THE FRAME OF THIS BUILD ADDS ¾" TO ALL SIDES, MEASURE 8¼" FROM THE TOP AND 11¼" FROM THE SIDE TO POSITION THE HOLE CENTER.
- USE COMPASS TO SCRIBE A 6" HOLE.
- DRILL STARTER HOLE WITH LARGE DRILL BIT, CUT HOLE WITH JIGSAW, AND SAND SMOOTH.
- REPEAT WITH SECOND BOARD.

CORNHOLE BOARDS

BUILD INSTRUCTIONS PAGE 2 OF 7

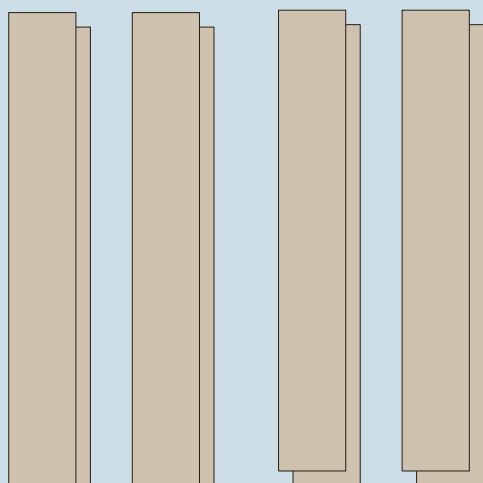

SIDE & LEG CUTTING

- CUT FOUR 48", 24", 12", AND 2 $\frac{3}{4}$ " LENGTHS OF HARDWOOD BOARDS. THIS PRODUCES TWO COMPLETE FRAMES, TWO SETS OF LEGS, AND TWO SETS OF LEG SUPPORT BLOCKS.

PRO TIP: CUT OUTSIDE FRAME BOARDS SLIGHTLY LONGER TO HELP FINAL FIT AROUND BOARD TOP.

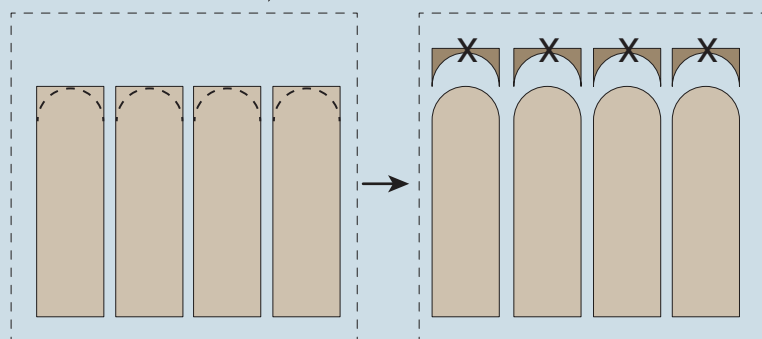
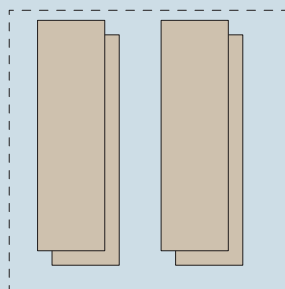

- MAKE HALF-RADIUS CUTS ON THE END OF EACH 12" LEG PIECE. YOU CAN USE A ROLL OF MASKING TAPE TO SCRIBE A GUIDE.

CORNHOLE BOARDS

BUILD INSTRUCTIONS PAGE 3 OF 7

JOINING THE FRAME TO THE TOP

NOTE: 2X THIS STEP

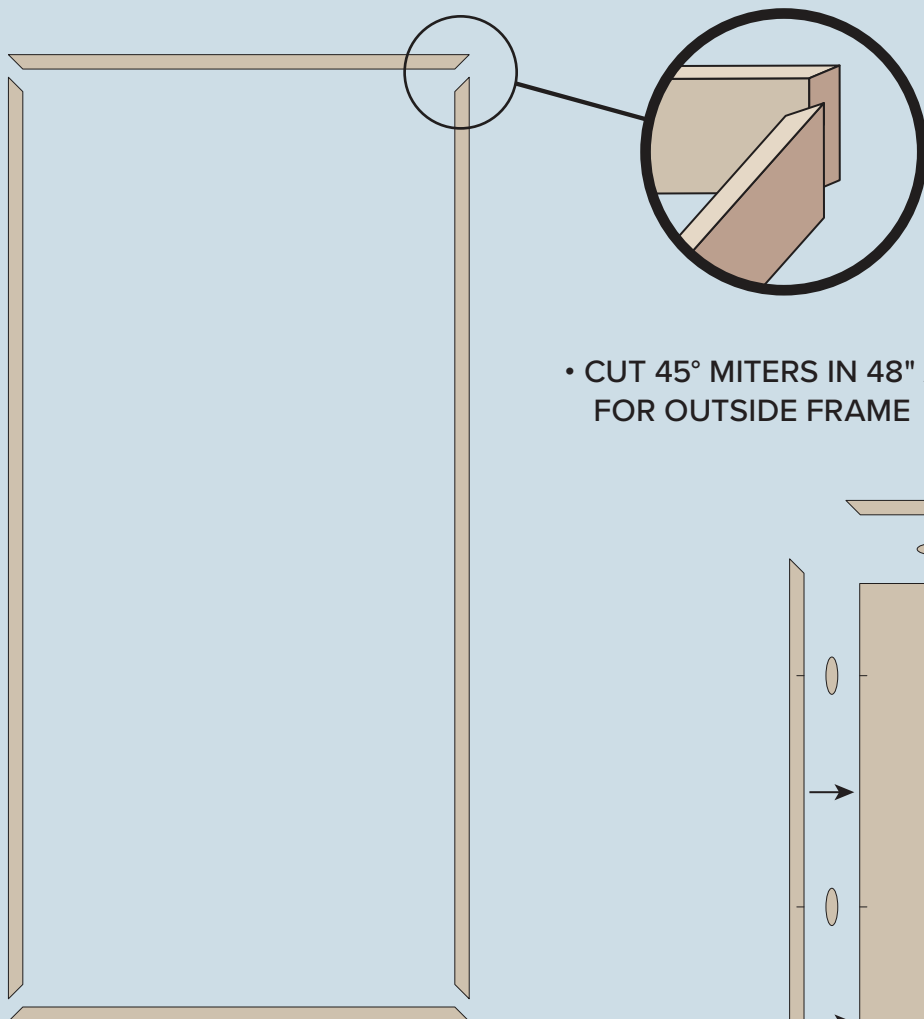

- CUT 45° MITERS IN 48" AND 24" BOARDS FOR OUTSIDE FRAME

- MARK AND CUT BISCUIT SLOTS IN TOP AND FRAME SIDES, ENSURING BOARD TOP IS FLUSH WITH FRAME EDGE.
- USE 3 BISCUITS ON THE TOP AND BOTTOM AND 4 BISCUITS ON THE SIDES.
- DRY FIT ASSEMBLY AND TRIM MITERED EDGES FOR PERFECT CORNERS.
- GLUE BISCUITS AND JOINING EDGES; CLAMP AND LET DRY OVERNIGHT.

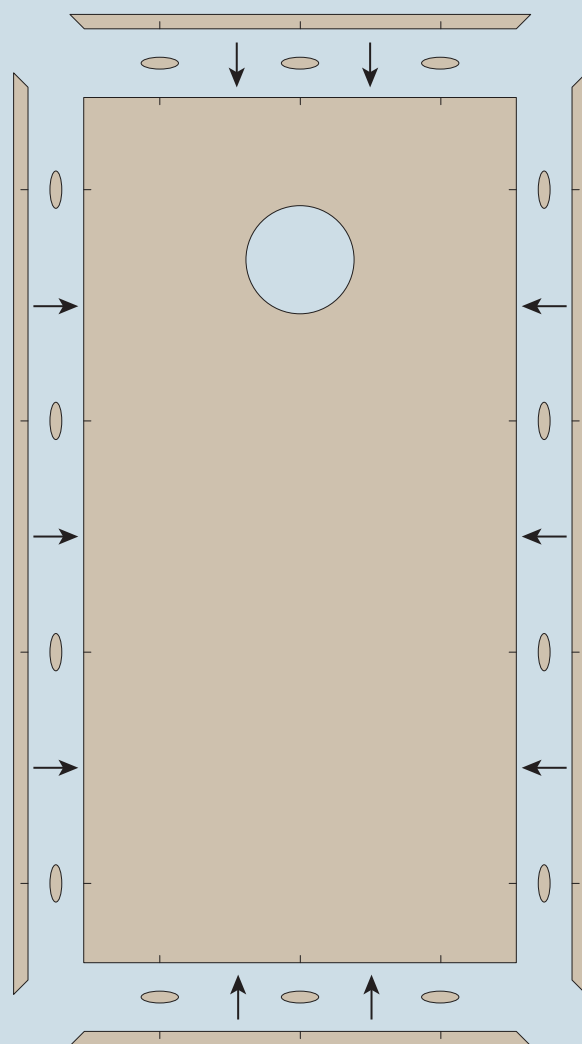

CORNHOLE BOARDS

BUILD INSTRUCTIONS PAGE 4 OF 7

LEGS & LEG SUPPORT BLOCKS

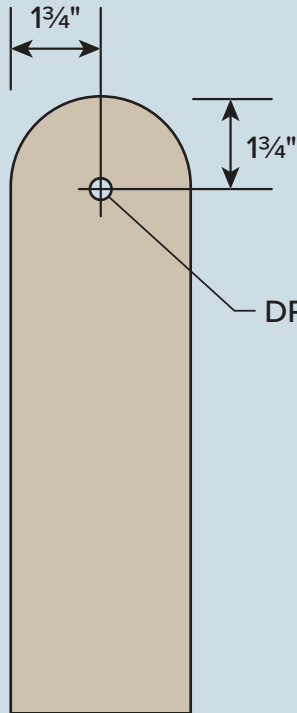

DRILL $\frac{3}{8}$ " HOLE IN CENTER OF CORNER RADIUS OF LEG.

NOTE: 4X THIS STEP

- POSITION LEG SUPPORT BLOCK IN CORNHOLE FRAME CORNER.
- POSITION LEG IN PLACE, ENSURING THERE IS ABOUT $\frac{1}{8}$ " CLEARANCE FROM THE TOP AND TOP END BOARD AS SHOWN. USE A SHIM IF NEEDED.
- ROTATE LEG FROM CLOSED TO OPEN POSITION TO MAKE SURE PIVOT HOLE IS IN CORRECT PLACE.
- MARK PIVOT HOLE. DRILL AND INSTALL THREADED INSERT, SECURING WITH SUPERGLUE.
- REPEAT ON OTHER SIDE.

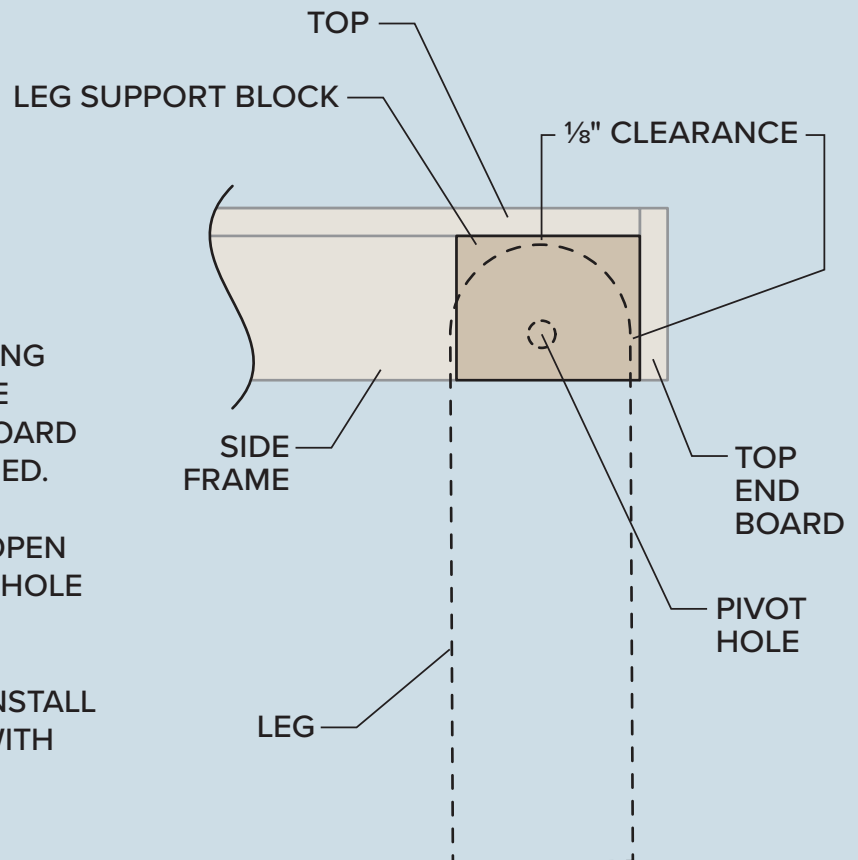

CORNHOLE BOARDS

BUILD INSTRUCTIONS PAGE 5 OF 7

LEGS & LEG SUPPORT BLOCKS, CONTINUED

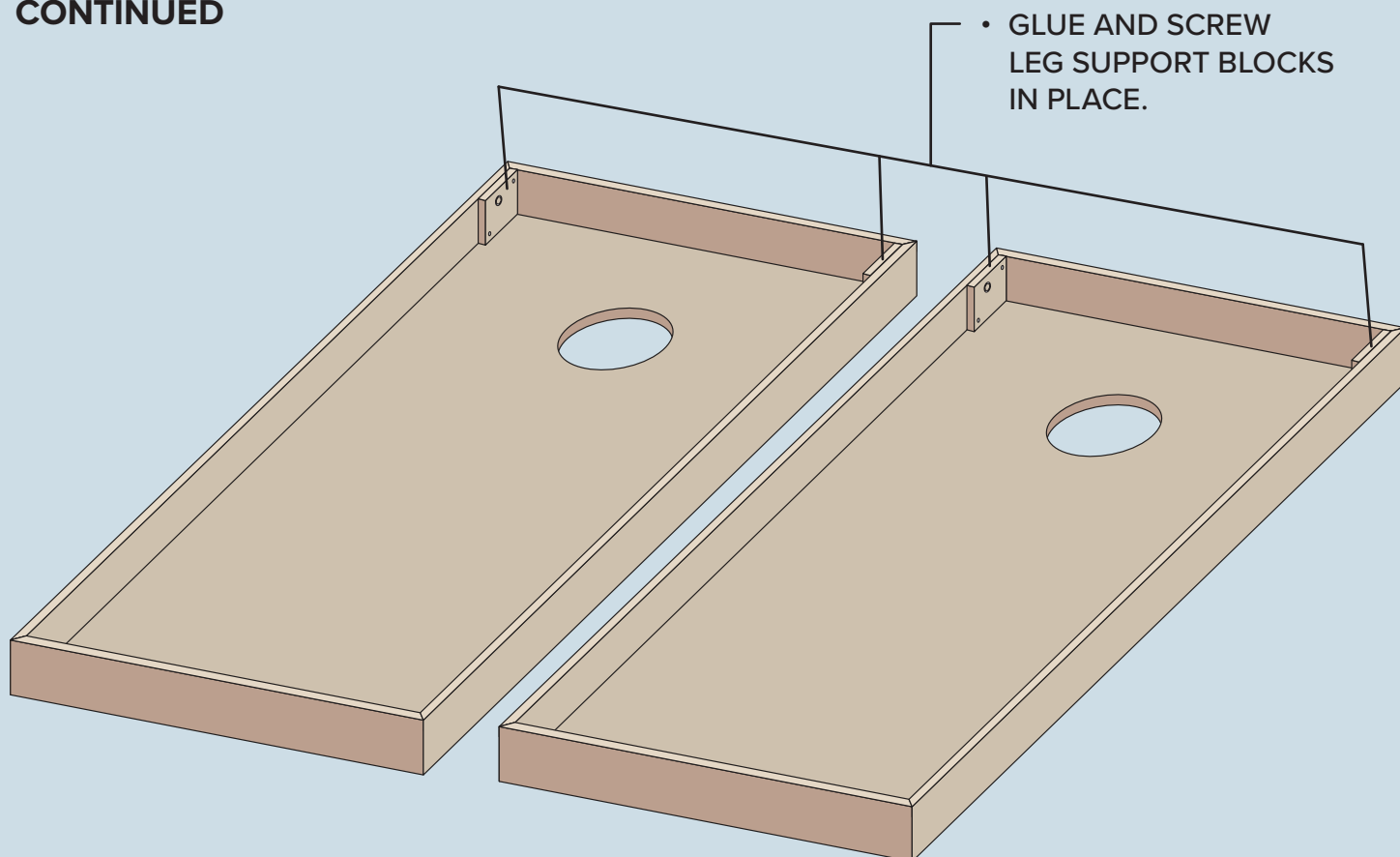

- INSTALL LEGS AS SHOWN.

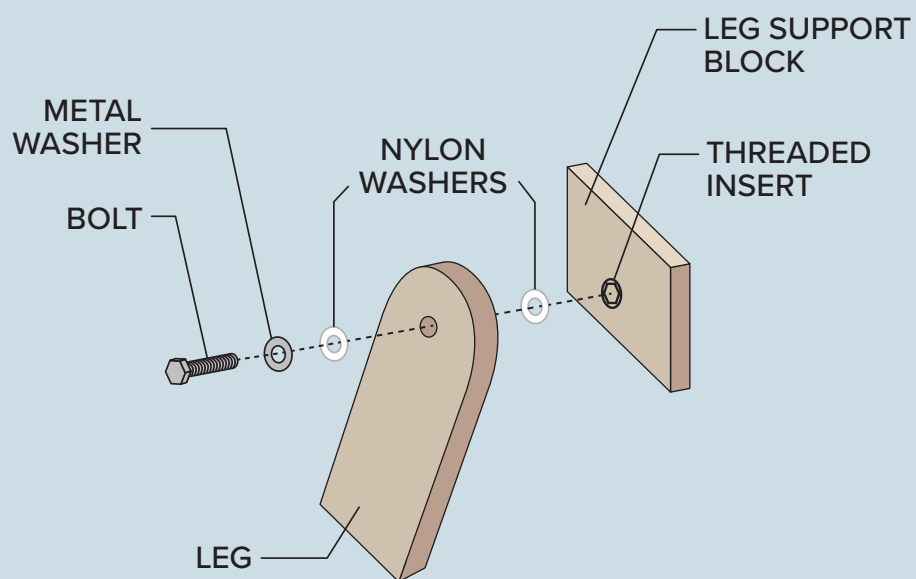

CORNHOLE BOARDS

BUILD INSTRUCTIONS PAGE 6 OF 7

NOTE: 4X THIS STEP

FITTING & CUTTING LEGS

- PLACE BOARD ON TABLE AS SHOWN SO ONE LEG FREELY SWINGS CLOSE TO EDGE OF TABLE, USING BLOCKS OF SCRAP WOOD TO PROP UP TOP EDGE OF CORNHOLE BOARD TO EXACTLY 12" REGULATION HEIGHT.

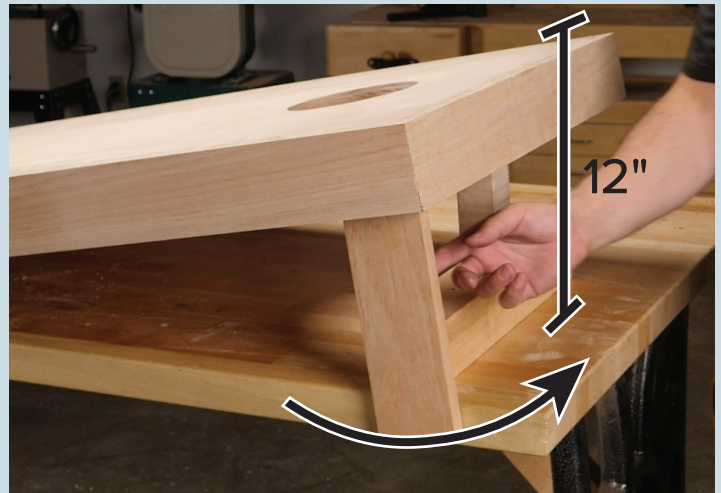

- POSITION LEG SO IT STOPS SECURELY AGAINST THE FRAME, THEN PENCIL A MARK ON THE LEG USING THE TABLE AS A STRAIGHT EDGE.

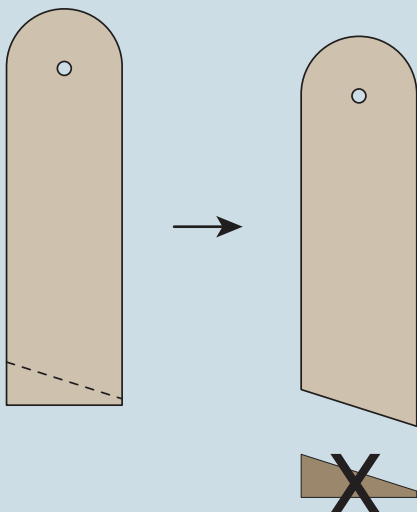

- REMOVE LEGS FROM CORNHOLE BOARD AND CUT LEG PIECES ALONG PENCIL MARK.

CORNHOLE BOARDS

BUILD INSTRUCTIONS PAGE 7 OF 7

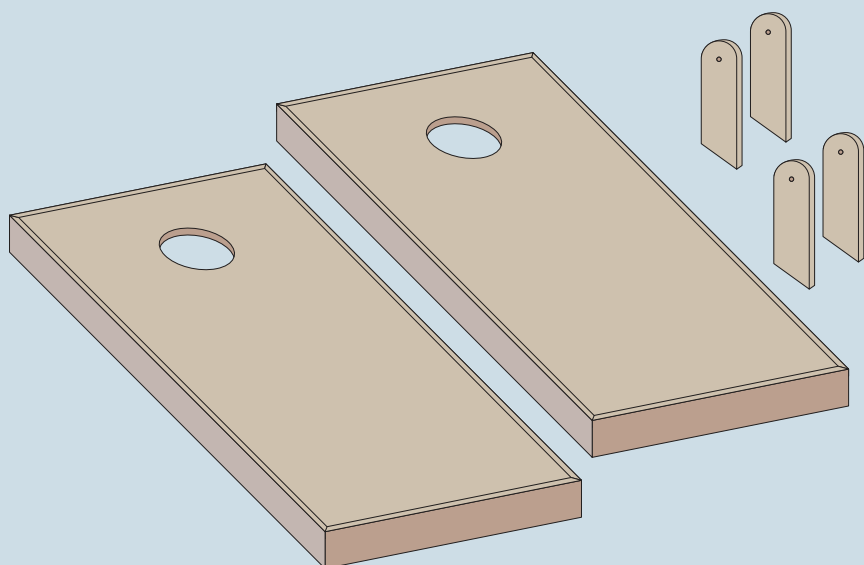

FINISHING & FINAL ASSEMBLY

- SAND AND PREP CORNHOLE BOARDS AND LEGS FOR FINISHING.
- STAIN, PAINT, AND APPLY DECALS OR GRAPHICS TO PERSONALIZE YOUR BOARDS. GET CREATIVE!
- APPLY DURABLE FINISH COAT.
- FOLLOW ALL MANUFACTURERS' INSTRUCTIONS TO ENSURE BEST RESULTS.
- WHEN FULLY DRIED, RE-INSTALL LEGS AND PLAY!

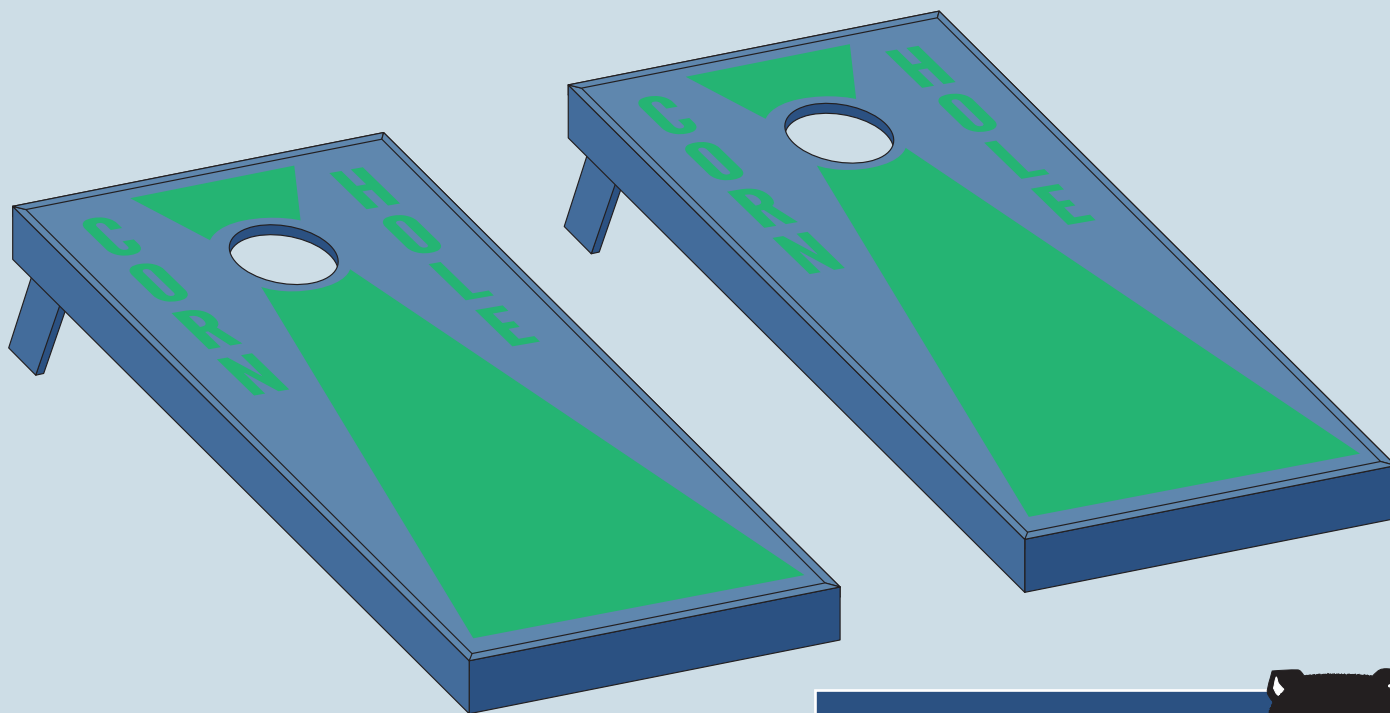

Enjoy your new
CORNHOLE BOARDS!

